

F.A.P. RTE.	SECTION	COUNTY	TOTAL SHEETS	SHEET NO.
348	(0708.1 & 2323.5)B	COOK	47	1
FED. ROAD DIST. NO. 1		ILLINOIS	CONTRACT NO. 60D69	

STATE OF ILLINOIS
DEPARTMENT OF TRANSPORTATION
DIVISION OF HIGHWAYS

**PROPOSED
HIGHWAY PLANS**

**F.A.P. ROUTE 348 (IL ROUTE 43) AT SANITARY & SHIP CANAL
SECTION (0708.1 & 2323.5)B
BRIDGE DECK OVERLAY, BRIDGE JOINT REPAIR
COOK COUNTY
JOB NO. C-91-088-08**

FOR INDEX OF SHEETS, SEE SHEET NO. 2
FOR LIST OF STANDARDS, SEE SHEET NO. 2

IMPROVEMENT LOCATED IN
THE VILLAGE OF FOREST VIEW

S.N. 016-0315 NB
S.N. 016-0991 SB
ADT = 19000 (2009)
POSTED SPEED: 40 MPH

PROJECT LOCATION:

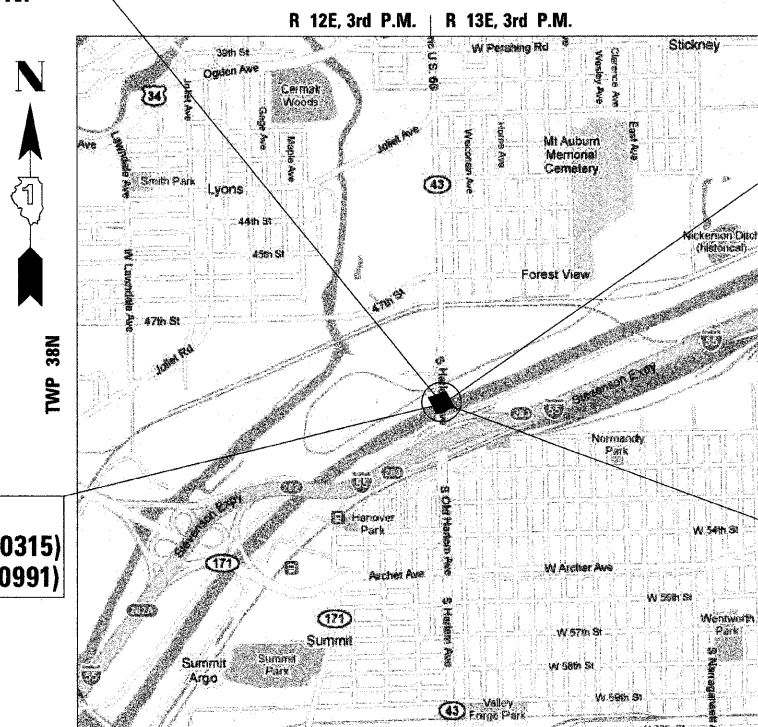

IMPROVEMENT ENDS:
STA. 135 + 17.28 (S.N. 016-0315)
STA. 134 + 66.35 (S.N. 016-0991)

IMPROVEMENT BEGINS:
STA. 130 + 60.78 (S.N. 016-0315)
STA. 130 + 17.67 (S.N. 016-0991)

IL 43 OVER SANITARY & SHIP CANAL
EXISTING S.N. 016-0315 (NB)
EXISTING S.N. 016-0991 (SB)

GRAPHIC SCALES:

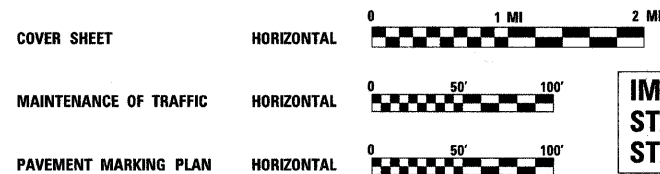

FULL SIZE PLANS HAVE BEEN PREPARED USING STANDARD ENGINEERING SCALES. REDUCED SIZED PLANS WILL NOT CONFORM TO STANDARD SCALES. IN MAKING MEASUREMENTS ON REDUCED PLANS, THE ABOVE SCALES MAY BE USED.

J.U.L.I.E.
JOINT UTILITY LOCATION INFORMATION FOR EXCAVATION
1-800-892-0123
OR 811

PROJECT ENGINEER: MICHELLE A. AQUINO - (847) 705-4606
PROJECT MANAGER: RAJENDRA C. SHAH - (847) 705-4555
CONTRACT NO.: 60D69

GROSS AND NET LENGTH OF IMPROVEMENT = 456.50 FEET = 0.086 MILE (NB)
GROSS AND NET LENGTH OF IMPROVEMENT = 448.68 FEET = 0.085 MILE (SB)



Fred M. Lin 3/30/2010

FRED M. LIN, P.E.
ILLINOIS REGISTERED ENGINEER NO. 062-056704
REGISTRATION EXPIRES NOV. 30, 2011

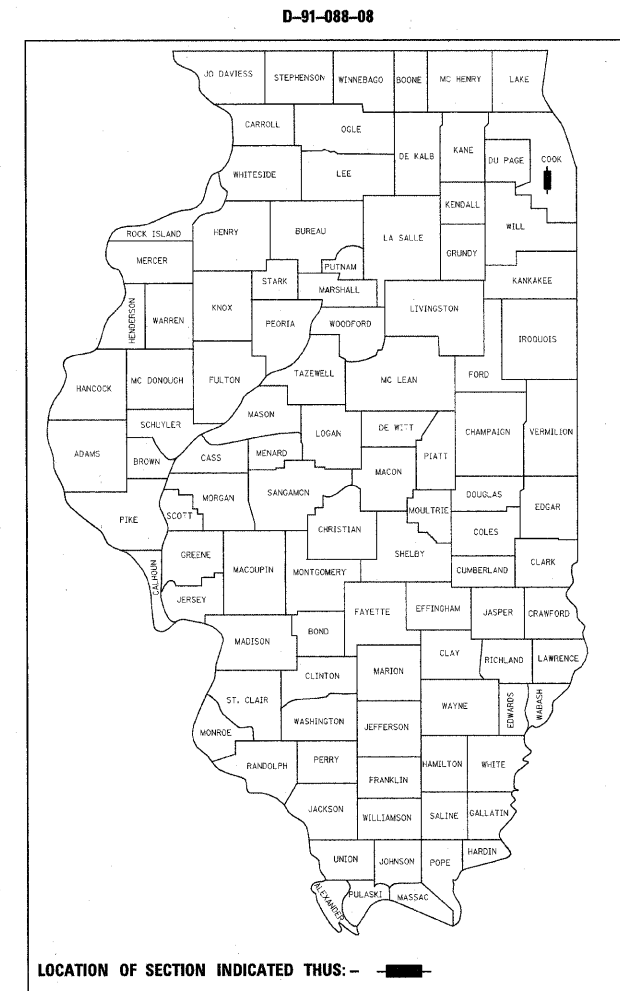

LOCATION OF SECTION INDICATED THUS: - ■ -

PREPARED BY:
LIN ENGINEERING, LTD.
CHATHAM, ILLINOIS 62629
(217) 483-4168

STATE OF ILLINOIS
DEPARTMENT OF TRANSPORTATION
DIVISION OF HIGHWAYS

SUBMITTED APRIL 1, 2010

Diane M. O'Keefe
DEPUTY DIRECTOR OF HIGHWAYS, REGION ENGINEER

May 7 2010
Scott E. Stitt P.E.
ENGINEER OF DESIGN AND ENVIRONMENT

May 7 2010
Christine M. Roedel
DIRECTOR OF HIGHWAYS, CHIEF ENGINEER

PRINTED BY THE AUTHORITY
OF THE STATE OF ILLINOIS