

STATE OF ILLINOIS  
DEPARTMENT OF TRANSPORTATION

**GENERAL NOTES**

Reinforcement bars shall conform to the requirements of ASTM A 706 Gr 60. See Special Provisions.

Reinforcement bars designated (E) shall be epoxy coated.

Prior to pouring the new concrete deck, all heavy or loose rust, loose mill scale, and other loose or potentially detrimental foreign material shall be removed from the surfaces in contact with concrete. Tightly adhered paint may remain unless otherwise noted. Removal shall be accomplished by methods that will not damage the steel and the cost will be included in the pay item covering removal of the existing concrete.

Plan dimensions and details relative to existing plans are subject to nominal construction variations. The Contractor shall field verify existing dimensions and details affecting new construction and make necessary approved adjustments prior to construction or ordering of materials. Such variations shall not be cause for additional compensation for a change in scope of the work, however, the Contractor will be paid for the quantity actually furnished at the unit price bid for the work.

The existing structural steel coating contains lead. The Contractor shall take appropriate precautions to deal with the presence of lead on this project.

All new structural steel shall be shop painted with the inorganic zinc rich primer per AASHTO M300, Type 1. Cost included with Furnishing & Erecting Structural Steel.

All structural steel shall conform to AASHTO Classification M-270 Gr. 36, unless otherwise noted.

Joint openings shall be adjusted according to Article 520.04 of the Standard Specs. when the deck is poured at an ambient temperature other than 50°F.

Cost of removal and re-installation of all members necessary to complete the work as detailed on the plans and as specified in the Special Provisions shall be included with Furnishing and Erecting Structural Steel.

The deck surface shall have its final finish tined according to Article 420.09(e)(1) of the Standard Specifications. Cost included with Concrete Superstructure.

If the analysis submitted to the Contractor for the jacking/ temporary support system to be used shows temporary stiffeners are required to prevent web crippling or buckling, the stiffeners shall be steel and bolted to the web. If stiffeners are not required, hardwood timbers shall be installed tightly between the top and bottom flange to prevent flange rotation.

**TOTAL BILL OF MATERIAL**

ITEM	UNIT	SUPER	SUB	TOTAL
Concrete Removal	Cu. Yd.	55.0	-	55.0
Floor Drain Extension	Each	21	-	21
Concrete Superstructure	Cu. Yd.	55.0	-	55.0
Furnishing and Erecting Structural Steel	Pound	-	1400	1400
Jack and Remove Existing Bearings	Each	-	8	8
Reinforcement Bars, Epoxy Coated	Pound	5580	-	5580
Bar Splacers	Each	60	-	60
Preformed Joint Strip Seal	Foot	304	-	304
Elastomeric Bearing Assembly, Type I	Each	-	8	8
Anchor Bolts, 1"	Each	-	16	16
Concrete Sealer	Sq. Ft.	20949	-	20949
Epoxy Crack Injection	Foot	-	154	154
Bridge Washing 1	Each	1	-	1
Concrete Bridge Deck Scarification (3/8 inch)	Sq. Yd.	1265	-	1265
Polymer Concrete	Cu. Ft.	5.0	-	5.0
Plug Existing Deck Drains	Each	23	-	23
Bridge Deck Thin Polymer Overlay 3/8"	Sq. Yd.	1265	-	1265
Structural Repair of Concrete (Depth Greater Than 5 in.)	Sq. Ft.	-	227	227
Structural Repair of Concrete (Depth Equal To or Less Than 5 in.)	Sq. Ft.	-	255	255
Temporary Shoring and Cribbing	Each	-	1	1

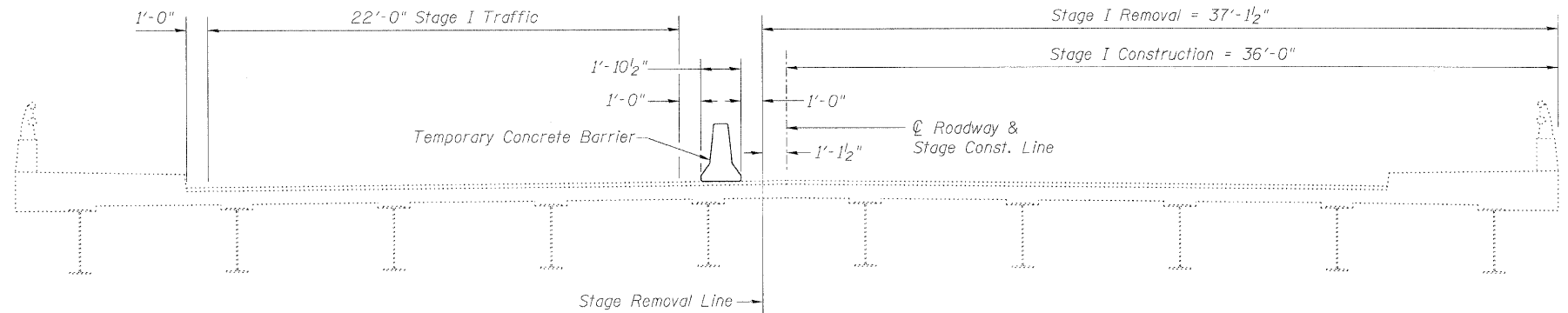

**STAGE I REMOVAL & CONSTRUCTION**  
(Looking North)

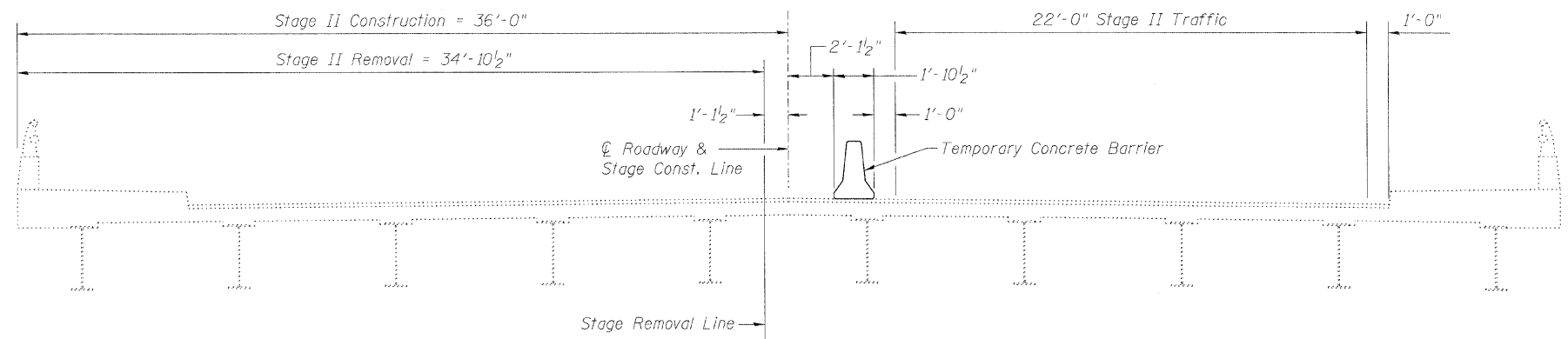

**STAGE II REMOVAL & CONSTRUCTION**  
(Looking North)

**GENERAL NOTES & DETAILS**  
**STRUCTURE NO. 016-0315**

	SHEET NO. 2	F.A.P. RTE. 348	SECTION (0708.1&2323.5)B	COUNTY COOK	TOTAL SHEETS 47	SHEET NO. 13
	17 SHEETS	CONTRACT NO. 60D69			ILLINOIS FED. AID PROJECT	