

STATE OF ILLINOIS
DEPARTMENT OF TRANSPORTATION

NOTES

Refer to S12 of S17 for Sections C-C & D-D, and Bill of Material.
All d(E) and w(E) bar spacings measured parallel to \hat{C} Rdwy.
Protective coat to be applied to top of approach slab.

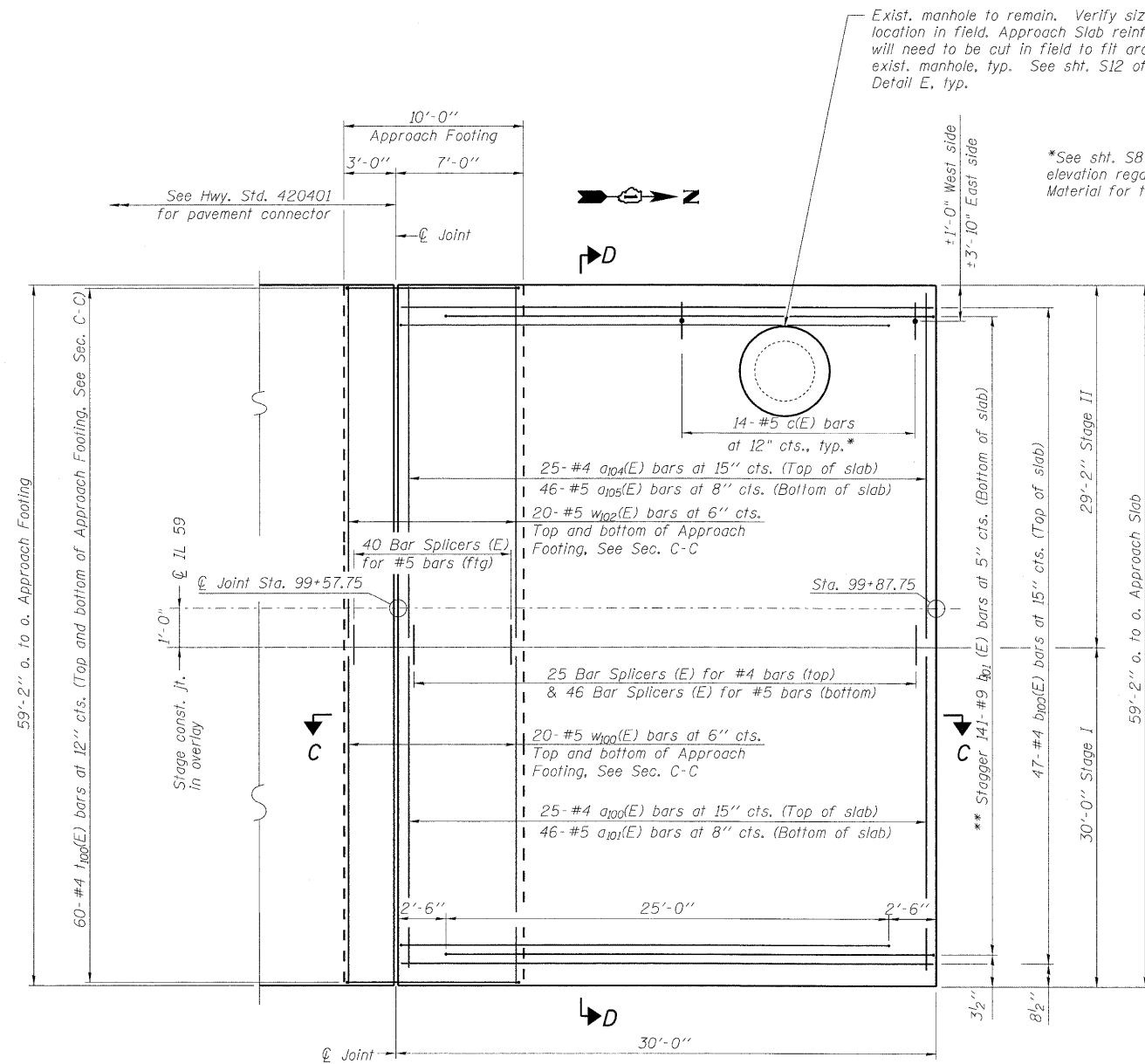

SOUTH APPROACH SLAB PLAN

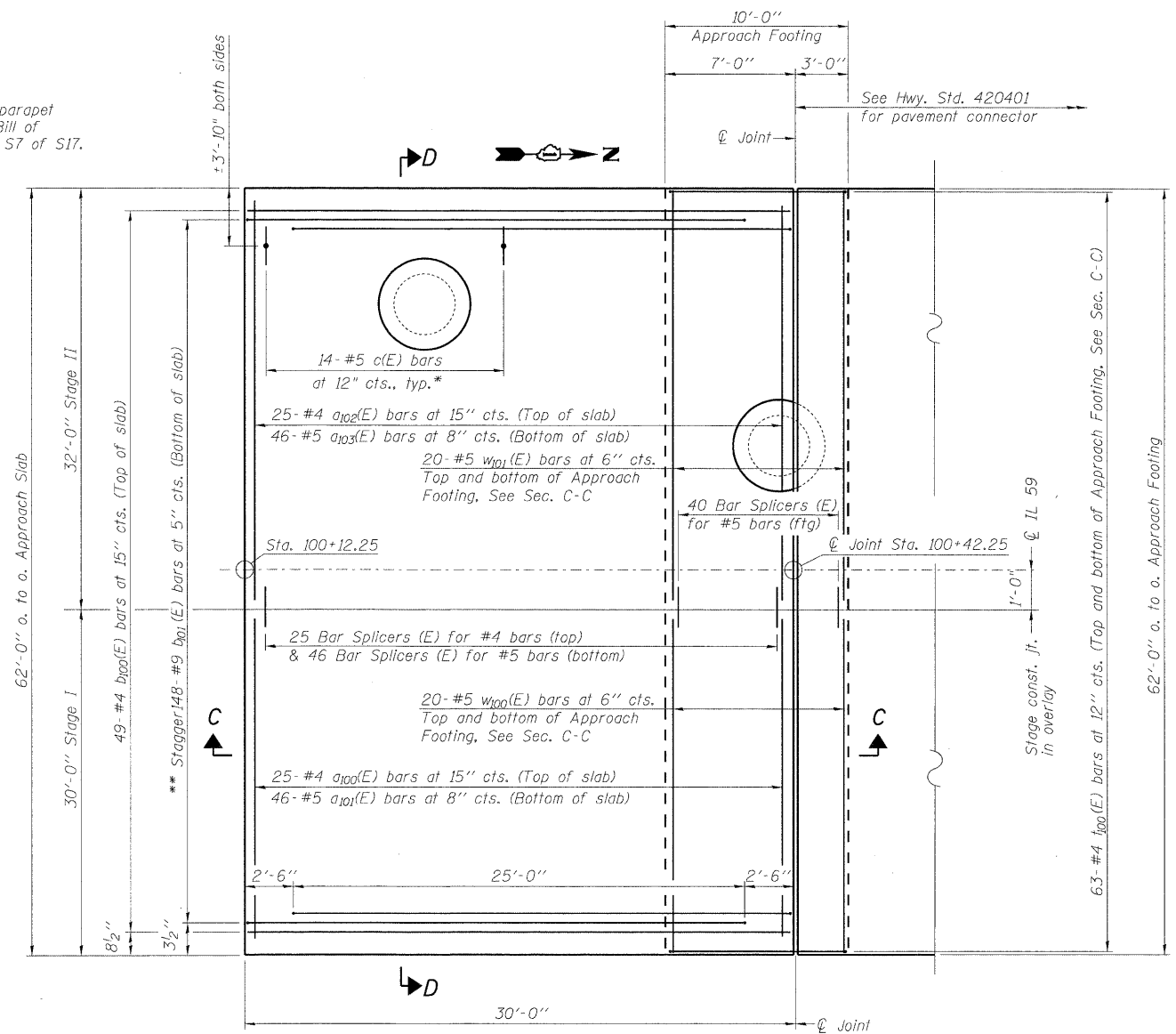

NORTH APPROACH SLAB PLAN

** Tilt #9 b₁₀₁(E) bars as required to maintain clearance.

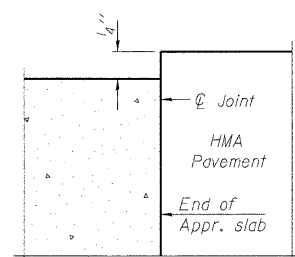

**FLEXIBLE PAVEMENT
DETAIL A**

DESIGNED	SLV
CHECKED	DJB
DRAWN	SLV
CHECKED	DJB

LONGO, INC.
CONSULTING ENGINEERS
1560 WALL ST. SUITE 222
NAPERVILLE, ILLINOIS 60563 PH: (630) 577-9100

(Sheet 1 of 2)
BRIDGE APPROACH SLAB DETAILS
STRUCTURE NO. 049-0152

SHEET NO. S11 OF S17 SHEETS	F.A.P. RTE.	SECTION	COUNTY	TOTAL SHEETS	SHEET NO.
	338	108 B-1	LAKE	40	23
D-91-289-09			CONTRACT NO. 60F92		
FED. ROAD DIST. NO. ILLINOIS FED. AID PROJECT					