

VILLAGE OF EVERGREEN PARK

BEVERLY COUNTRY CLUB

PROJECT ENDS
STA. 46+00

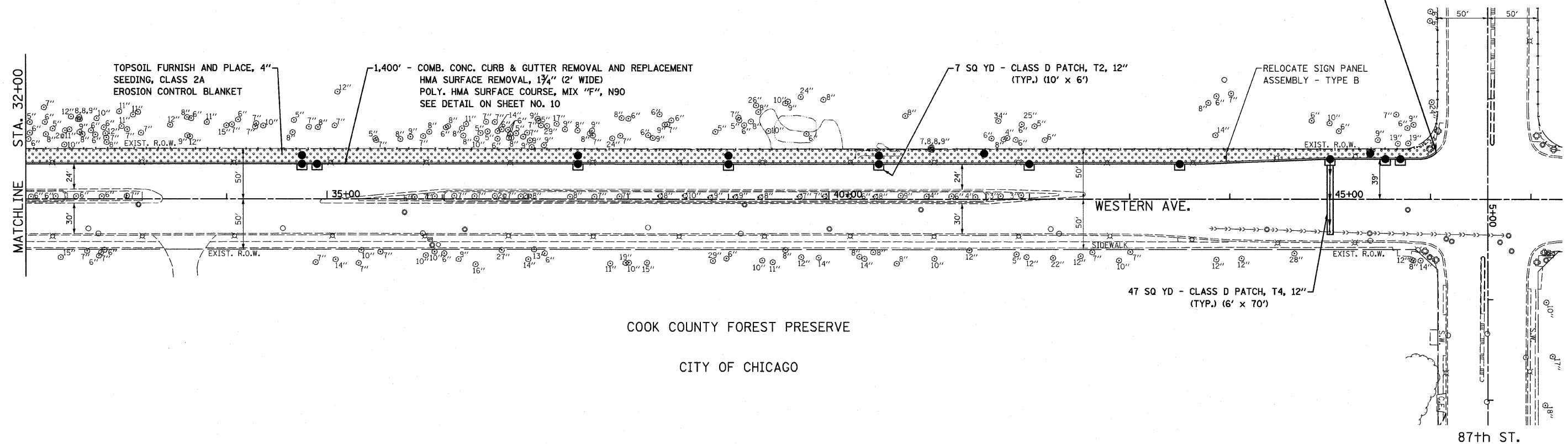

COOK COUNTY FOREST PRESERVE

CITY OF CHICAGO

87th St.



669.95 668.84	EXIST. C PROFILE EXIST. E.O.P. LEFT	669.46 668.47	668.64 668.11	667.86 667.33	668.05 667.56	668.33 667.17	668.03 666.80	667.72 666.50	667.54 666.28	667.21 666.00	666.81 665.67	665.94 665.35	665.54 664.91	665.15 664.57	665.01 664.57	664.61
32+00		33+00	34+00	35+00	36+00	37+00	38+00	39+00	40+00	41+00	42+00	43+00	44+00	45+00	46+00	47+00

FILE NAME = 0160015-shr-plan2.dgn
PLOT DATE = 3/22/2018

CHRISTIAN-ROGE & ASSOCIATES, INC.
ENGINEERS-PLANNERS-SURVEYORS
211 WEST WACKER DRIVE
CHICAGO, ILLINOIS 60606
PHONE: (312)372-2023 FAX: (312)372-5274

DESIGNED - S.J.P.	REVISED -
DRAWN - A.C.S.	REVISED -
CHECKED - S.J.P.	REVISED -
DATE - MARCH 19, 2010	REVISED -

STATE OF ILLINOIS
DEPARTMENT OF TRANSPORTATION

ROADWAY PLAN & PROFILE
WESTERN AVE.
SCALE: 1" = 50'
SHEET NO. 2 OF 2 SHEETS
STA. 32+00 TO STA. 46+00

F.A.P. RTE. 370	SECTION 2009-015 T	COUNTY COOK	TOTAL SHEETS 20	SHEET NO. 6
CONTRACT NO. 60G15				
FED. ROAD DIST. NO. 1 ILLINOIS FED. AID PROJECT				