

FINAL SURVEY	SURVEYED	BY	DATE
NOTE BOOK	PLOTTED		
	TEMPLATE		
	AREAS		
	CHECKED		

ORIGINAL SURVEY	SURVEYED	BY	DATE
NOTE BOOK	PLOTTED		
	TEMPLATE		
	AREAS		
	CHECKED		

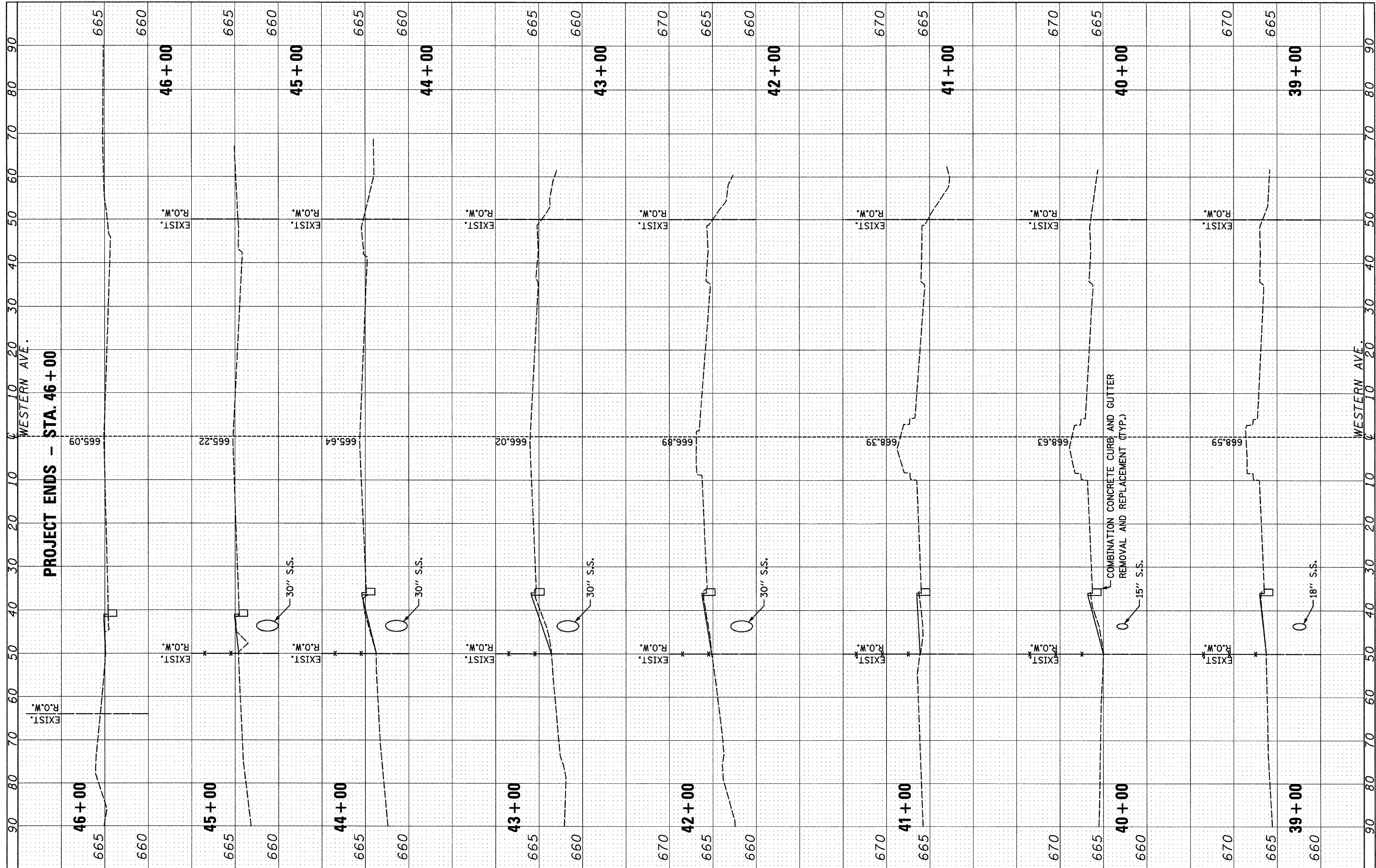

FILE NAME = D168015-shr-xsh.txdgn
 PLOT DATE = 3/22/2010

CHRISTIAN-ROGE & ASSOCIATES, INC.
 ENGINEERS-PLANNERS-SURVEYORS
 211 WEST WACKER DRIVE
 CHICAGO, ILLINOIS 60606
 PHONE: (312)372-2023 FAX: (312)372-5274

DESIGNED - S.J.P.	REVISED -
DRAWN - A.C.S.	REVISED -
CHECKED - S.J.P.	REVISED -
DATE - MARCH 19, 2010	REVISED -

STATE OF ILLINOIS
DEPARTMENT OF TRANSPORTATION

CROSS SECTIONS
WESTERN AVE.

SCALE: NONE SHEET NO. 4 OF 4 SHEETS STA. 39+00 TO STA. 46+00

F.A.P. RTE.	SECTION	COUNTY	TOTAL SHEETS	SHEET NO.
370	2009-015 T	COOK	20	15
CONTRACT NO. 60G15			FED. ROAD DIST. NO. 1 (ILLINOIS) FED. AID PROJECT	