

ROUTE	SECTION	COUNTY	TOTAL SHEETS	SHEET NUMBER
VARIOUS	2009-075 I	VARIOUS	21	1

FOR INDEX OF SHEETS SEE SHEET 2

STATE OF ILLINOIS
DEPARTMENT OF TRANSPORTATION
DIVISION OF HIGHWAYS
DISTRICT ONE
PROPOSED HIGHWAY PLANS

CONTRACT NO. 60H88

D-91-824-09

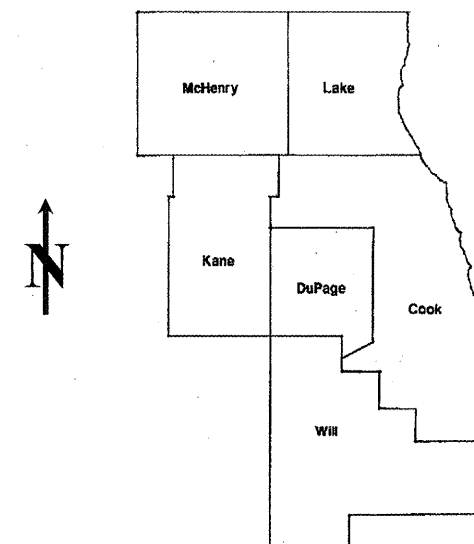

VARIOUS ROUTES
VARIOUS LOCATIONS
SECTION 2009-075 I
NOISEWALL REPAIRS
VARIOUS COUNTIES (DISTRICT WIDE)
C-91-824-09

IMPROVEMENTS ARE LOCATED IN THE VILLAGES OF CLARENDON HILLS, BARTLETT, ITASCA, LANSING, ROSELLE AND ELK GROVE.

PROJECT ENGINEER ROBERT BORO (847) 705-4178
PROJECT MANAGER KEN ENG

CONTRACT NO. 60H88

STATE OF ILLINOIS
DEPARTMENT OF TRANSPORTATION
DIVISION OF HIGHWAYS

SUBMITTED: March 20 2010
Don Okin
 DEPUTY DIRECTOR OF HIGHWAYS, REGION ENGINEER

May 7 2010
Scott E. Stitt, P.E.
 acting ENGINEER OF DESIGN AND ENVIRONMENT

May 7 2010
Christine M. Reedler
 DIRECTOR OF HIGHWAYS, CHIEF ENGINEER

PRINTED BY THE AUTHORITY
OF THE STATE OF ILLINOIS

J.U.L.I.E.: JOINT UTILITY LOCATION
 INFORMATION FOR EXCAVATION
 (800) 892-0123 OR 811

ROUTE	SECTION	COUNTY	TOTAL SHEETS	SHEET NUMBER
VARIOUS	2009-075 I	VARIOUS	21	2

Contract 60H88

INDEX OF SHEETS

STATE STANDARDS

SHEET NO DESCRIPTION

1	TITLE SHEET
2	INDEX OF SHEETS AND STATE STANDARDS
3	GENERAL NOTES
4-5	SUMMARY OF QUANTITIES
6	SCHEDULE OF QUANTITIES
7-10	LOCATION: 1, 2, 3 AND 4
11	LOCATION: 5
12-14	LOCATION: 6 AND 7
15-17	LOCATION: 8, 9, 10 AND 11
18	TRAFFIC CONTROL & PROTECTION FOR SITE ROADS, INTERSECTION AND DRIVEWAYS (TC-10)
19	TRAFFIC CONTROL & PROTECTION OF TURN BAYS (TO REMAIN OPEN TO TRAFFIC) (TC-14)
20	TRAFFIC CONTROL DETAILS FOR FREEWAY SHOULDER CLOSURES AND PARTIAL RAMP CLOSURES (TC-17)
21	ARTERIAL ROAD INFORMATION SIGN (TC-22)

<u>STD NO</u>	<u>DESCRIPTION</u>
701006 -03	OFF-ROAD OPERATIONS, 2L, 2W, 15' TO 24" FROM PAVEMENT EDGE
701101-02	OFF-ROAD OPERATIONS, MULTILANE, 15' TO 24" FROM PAVEMENT EDGE
701301-03	LANE CLOSURE, 2L, 2W, SHORT TIME OPERATIONS
701400 -04	APPROACH TO LANE CLOSURE, FREEWAY/EXPRESSWAY
701401 -05	LANE CLOSURE, FREEWAY/EXPRESSWAY
701411 -06	LANE CLOSURE, MULTILANE, AT ENTRANCE OR EXIT RAMP, FOR SPEEDS \geq 45 MPH
701426 -03	LANE CLOSURE, MULTILANE, INTERMITTENT OR MOVING OPERATION, FOR SPEEDS \geq 45 MPH
701422 -02	LANE CLOSURE, MULTILANE, FOR SPEEDS > 45 TO 55 MPH
701606 -06	URBAN LANE CLOSURE, MULTILANE, 2W WITH MOUNTABLE MEDIAN
701901 -01	TRAFFIC CONTROL DEVICES

ILLINOIS DEPARTMENT OF TRANSPORTATION

INDEX OF SHEETS AND
STATE STANDARDS

ROUTE	SECTION	COUNTY	TOTAL SHEETS	SHEET NUMBER
VARIOUS	2009-075 I	VARIOUS	21	3

Contract 60H88

GENERAL NOTES

BEFORE STARTING ANY EXCAVATION, THE CONTRACTOR SHALL CALL "J.U.L.I.E." AT (800) 892-0123 OR 811. FOR FIELD LOCATIONS OF BURIED ELECTRIC, TELEPHONE AND GAS UTILITIES. 48 HOURS NOTIFICATION IS REQUIRED.

IT SHALL BE THE CONTRACTOR'S RESPONSIBILITY TO VERIFY ALL DIMENSIONS & CONDITIONS EXISTING IN THE FIELD PRIOR TO CONSTRUCTION & ORDERING OF MATERIALS.

THE CONTRACTOR WILL NOT BE ALLOWED TO SET UP A YARD OR FIELD OFFICE ON STATE PROPERTY WITHOUT WRITTEN PERMISSION FROM THE DEPARTMENT.

THE CONTRACTOR SHALL CONTACT THE DISTRICT ONE TRAFFIC CONTROL SUPERVISOR AT (847) 705-4470 FOR ARTERIALS OR (847)705-4151 FOR EXPRESSWAYS. A MINIMUM OF 72 HOURS IN ADVANCE OF BEGINNING WORK.

THE CONTRACTOR SHALL COORDINATE CONSTRUCTION ACTIVITIES WITH UTILITY COMPANIES.

THESE PLANS HAVE BEEN PREPARED FROM FIELD NOTES RECEIVED FROM MAINTENANCE ENGINEERS.

ALL WORK ASSOCIATED WITH THE REMOVAL AND REPLACEMENT OF THE NOISEWALL IS INCIDENTAL TO THE PAY ITEM WOODEN NOISEWALL REMOVAL AND REPLACEMENT.

THE "ARTERIAL ROAD INFORMATION SIGN (TC-22)" IS APPLICABLE ONLY TO ARTERIAL ROADS AND SHALL NOT BE APPLIED TO EXPRESSWAYS.

THE CONTRACTOR SHALL BE REQUIRED TO PROVIDE ACCESS TO ABUTTING PROPERTY AT ALL TIMES DURING THE CONSTRUCTION OF THIS PROJECT.

DO NOT SCALE PLANS FOR CONSTRUCTION DIMENSIONS.

WHEN ARTIFICIAL LIGHTING IS UTILIZED IN NIGHT OPERATIONS, THE CONTRACTOR SHALL EXERCISE THE UTMOST PRECAUTIONS IN PREVENTING ADVERSE VISIBILITY TO THE MOTORING PUBLIC AND ADJOINING RESIDENTIAL AREAS.

IT SHALL BE THE CONTRACTOR'S RESPONSIBILITY TO VERIFY ALL DIMENSIONS AND CONDITIONS EXISTING IN THE FIELD PRIOR TO CONSTRUCTION AND ORDERING OF MATERIALS.

ILLINOIS DEPARTMENT OF TRANSPORTATION

GENERAL NOTES

ROUTE	SECTION	COUNTY	TOTAL SHEETS	SHEET NUMBER
VARIOUS	2009-075 I	VARIOUS	21	4

CONTRACT NO.: 60H88

SUMMARY OF QUANTITIES

CONSTRUCTION TYPE CODE:

CODE NO.	ITEMS	UNITS	URBAN TOTAL QUANTITIES	100% STATE SFTY-2A
67000400	ENGINEER'S FIELD OFFICE, TYPE A	CAL MO	6	6
67100100	MOBILIZATION	L SUM	1	1
70100320	TRAFFIC CONTROL AND PROTECTION, STANDARD 701422	L SUM	1	1
70102625	TRAFFIC CONTROL AND PROTECTION, STANDARD 701606	L SUM	1	1
X0322256	TEMPORARY INFORMATION SIGNING	SQ FT	308.4	308.4
X7011015	TRAFFIC CONTROL AND PROTECTION (EXPRESSWAYS)	L SUM	1	1
X0326916	NOISE ABATEMENT WALL REPAIR, LOCATION 1	L SUM	1	1
X0326917	NOISE ABATEMENT WALL REPAIR, LOCATION 2	L SUM	1	1
X0326918	NOISE ABATEMENT WALL REPAIR, LOCATION 3	L SUM	1	1
X0325702	NIGHTTIME WORK ZONE LIGHTING	L SUM	1	1

MCHD CLAIM #

LOCATION 2: 754240

LOCATION 3: 748679

ILLINOIS DEPARTMENT OF TRANSPORTATION

SUMMARY OF QUANTITIES

Rev.

ROUTE	SECTION	COUNTY	TOTAL SHEETS	SHEET NUMBER
VARIOUS	2009-075 I	VARIOUS	21	5

CONTRACT NO.: 60H88

SUMMARY OF QUANTITIES

CONSTRUCTION TYPE CODE:

CODE NO.	ITEMS	UNITS	TOTAL QUANTITIES	SFTY-2A	
X0326919	NOISE ABATEMENT WALL REPAIR, LOCATION 4	L SUM	1	1	
X0326920	NOISE ABATEMENT WALL REPAIR, LOCATION 5	L SUM	1	1	
X0326921	NOISE ABATEMENT WALL REPAIR, LOCATION 6	L SUM	1	1	
X0326922	NOISE ABATEMENT WALL REPAIR, LOCATION 7	L SUM	1	1	
X0326923	NOISE ABATEMENT WALL REPAIR, LOCATION 8	L SUM	1	1	
X0326924	NOISE ABATEMENT WALL REPAIR, LOCATION 9	L SUM	1	1	
X0326925	NOISE ABATEMENT WALL REPAIR, LOCATION 10	L SUM	1	1	
X0326926	NOISE ABATEMENT WALL REPAIR, LOCATION 11	L SUM	1	1	

MCHD CLAIM #
 LOCATION 5: 754939
 LOCATION 6: 728374 & 754598

ILLINOIS DEPARTMENT OF TRANSPORTATION

SUMMARY OF QUANTITIES

ROUTE	SECTION	COUNTY	TOTAL SHEETS	SHEET NUMBER
VARIOUS	2009-075 I	VARIOUS	21	6

CONTRACT: 60H88

Code No.	Location	1	2	3	4	5	6	7	8	9	10	11
70100320	TRAFFIC CONTROL AND PROTECTION, STANDARD 701422	X	X	X	X							
70102625	TRAFFIC CONTROL AND PROTECTION, STANDARD 701606						X	X				
X7011015	TRAFFIC CONTROL AND PROTECTION (EXPRESSWAYS)					X			X	X	X	X
X0325702	NIGHTTIME WORK ZONE LIGHING										X	X
X0322256	TEMPORARY INFORMATION SIGNING (SQ. FT.)	51.4	51.4	51.4	51.4		51.4	51.4				

ILLINOIS DEPARTMENT OF TRANSPORTATION
SCHEDULE OF QUANTITIES

ROUTE	SECTION	COUNTY	TOTAL SHEETS	SHEET NUMBER
VARIOUS	2009-075 I	VARIOUS	21	7

Contract 60H88

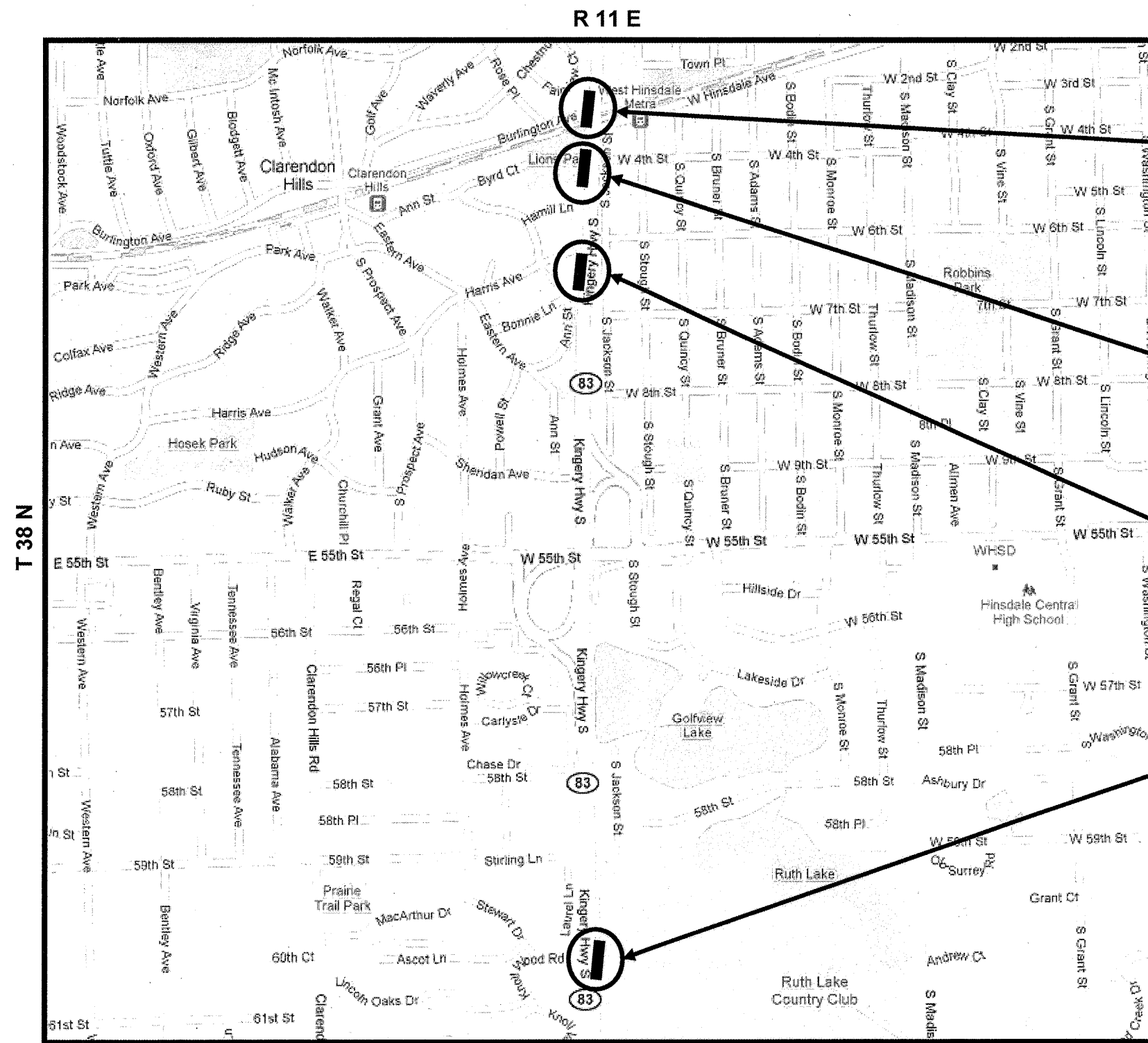

DOWNERS GROVE TOWNSHIP
DuPAGE COUNTY

LOCATION 1: IL 83 (SB), JUST NORTH OF 55th ST. EXIT. RIGHT SIDE (WEST) OVER THE RAILROAD AND ABOVE THE PARK/POOL AREA. VILLAGE OF CLARENDON HILLS

LOCATION 2: IL 83 (SB), JUST NORTH OF 55th ST. EXIT. 1200 FEET NORTH OF 55th STREET ON IL 83. VILLAGE OF CLARENDON HILLS

LOCATION 3: IL 83 (SB), JUST NORTH OF 55th ST. EXIT. 1400 FEET NORTH OF 55th STREET ON IL 83. VILLAGE OF CLARENDON HILLS

LOCATION 4: IL 83 (NB) JUST NORTH OF KNOLL WOOD AT GOLFVIEW LAKE ROAD. PAST 63th STREET, NORTH OF METRA "PARK & RIDE" SIGN. VILLAGE OF CLARENDON HILLS

TRAFFIC DATA:

IL 83: SPEED LIMIT = 55 MPH
2009 ADT = 68,400

ILLINOIS DEPARTMENT OF TRANSPORTATION

LOCATION: 1, 2, 3 AND 4
IL 83

SHEET 1 OF 4

ROUTE VARIOUS	SECTION 2009-075 I	COUNTY VARIOUS	TOTAL SHEETS 21	SHEET NUMBER 8
------------------	-----------------------	-------------------	-----------------------	----------------------

Contract 60H88

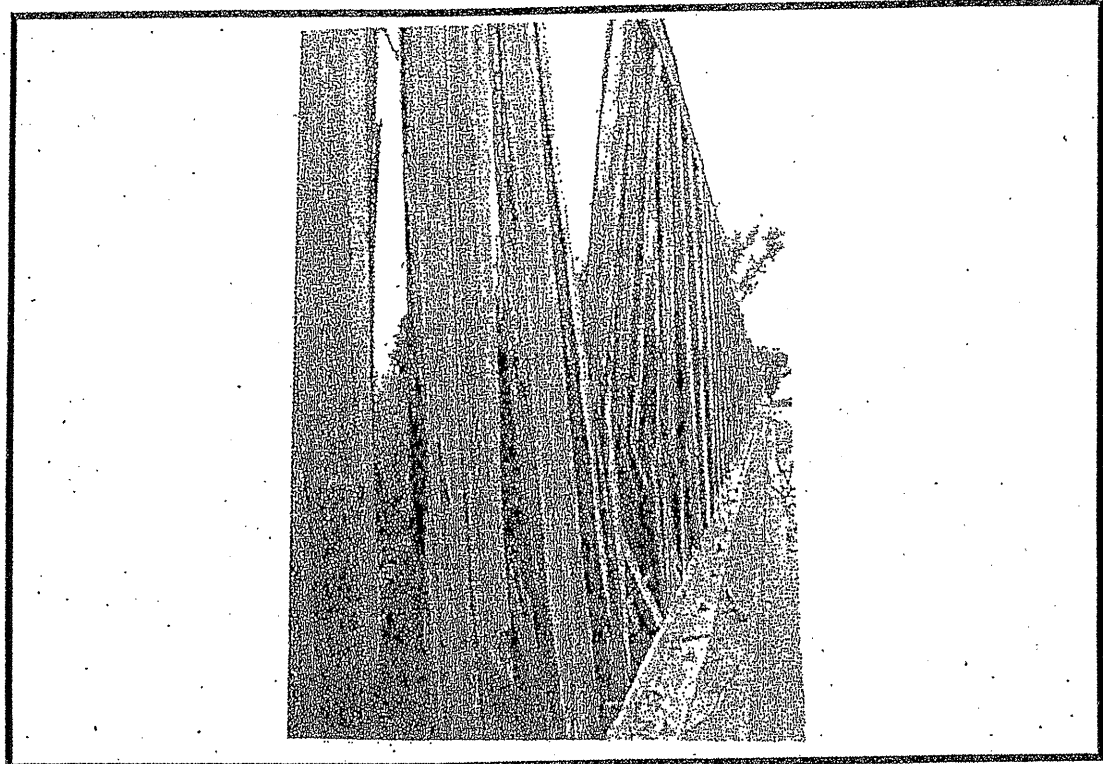

LOCATION: 1
(SOUTHERN YELLOW PINE GLUE-LAMINATED WOODEN WALL)

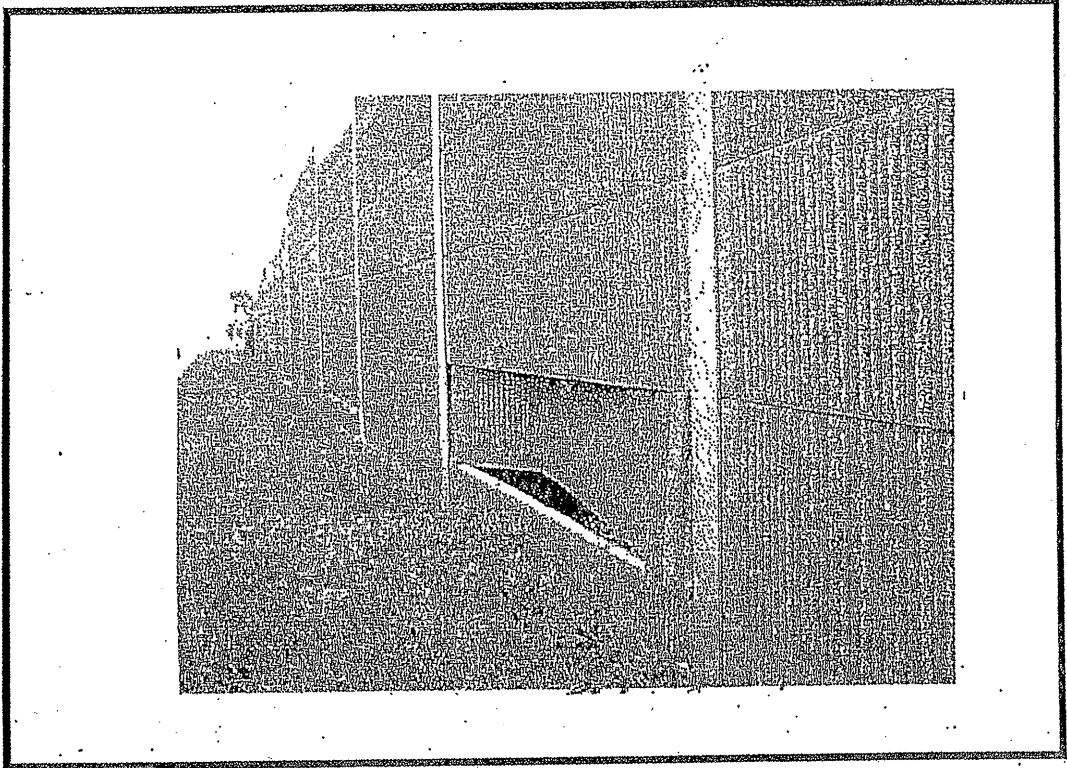

LOCATION: 4
(DURISOL WALL)

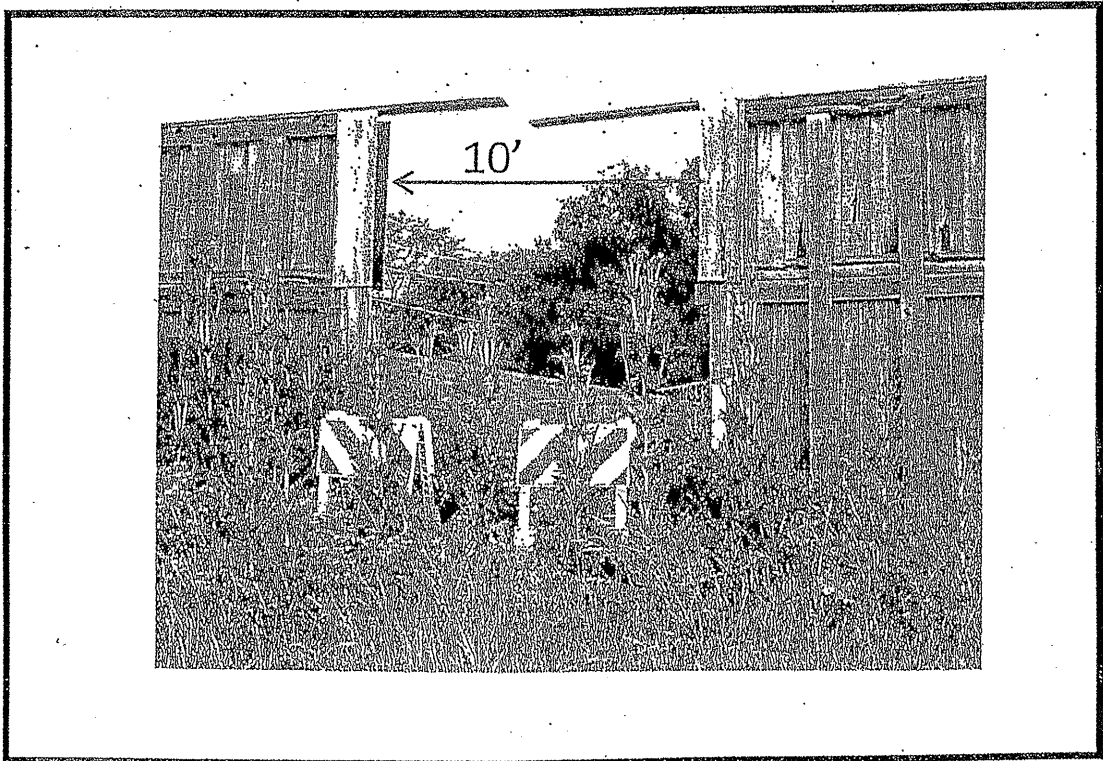

LOCATION: 2
(SOUTHERN YELLOW PINE GLUE-LAMINATED WOODEN WALL)

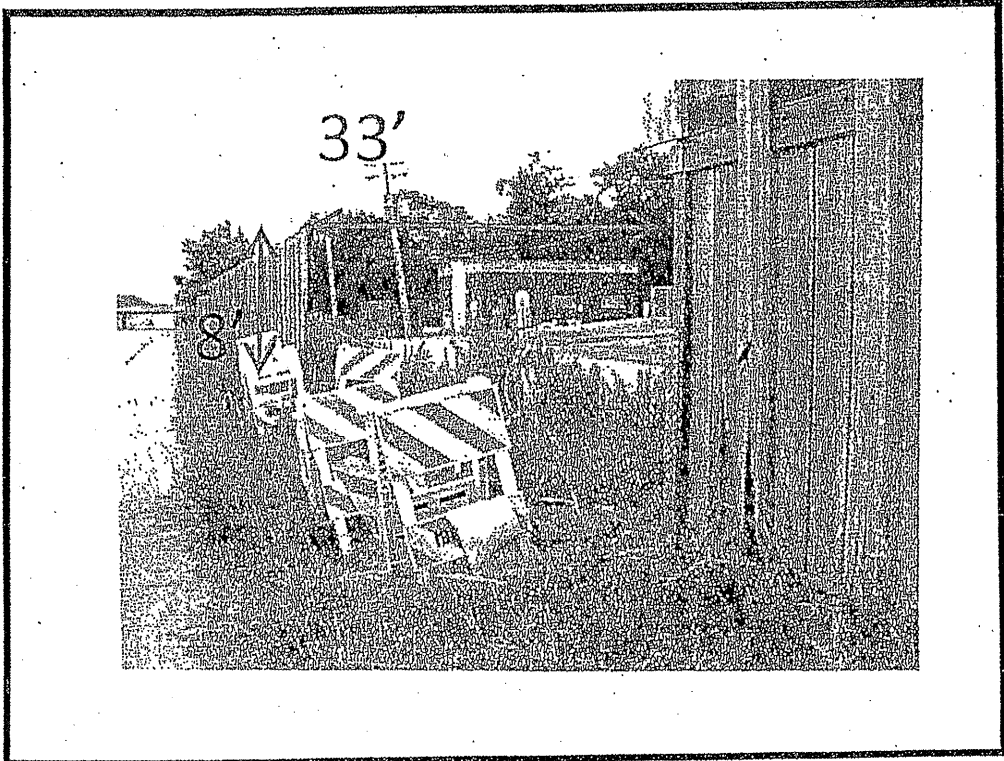

LOCATION: 3
(SOUTHERN YELLOW PINE GLUE-LAMINATED WOODEN WALL)

SHEET 2 OF 4

ILLINOIS DEPARTMENT OF TRANSPORTATION

LOCATION: 1, 2, 3 AND 4
IL 83

ROUTE	SECTION	COUNTY	TOTAL SHEETS	SHEET NUMBER
VARIOUS	2009-0751	VARIOUS	21	9

Contract 60H88

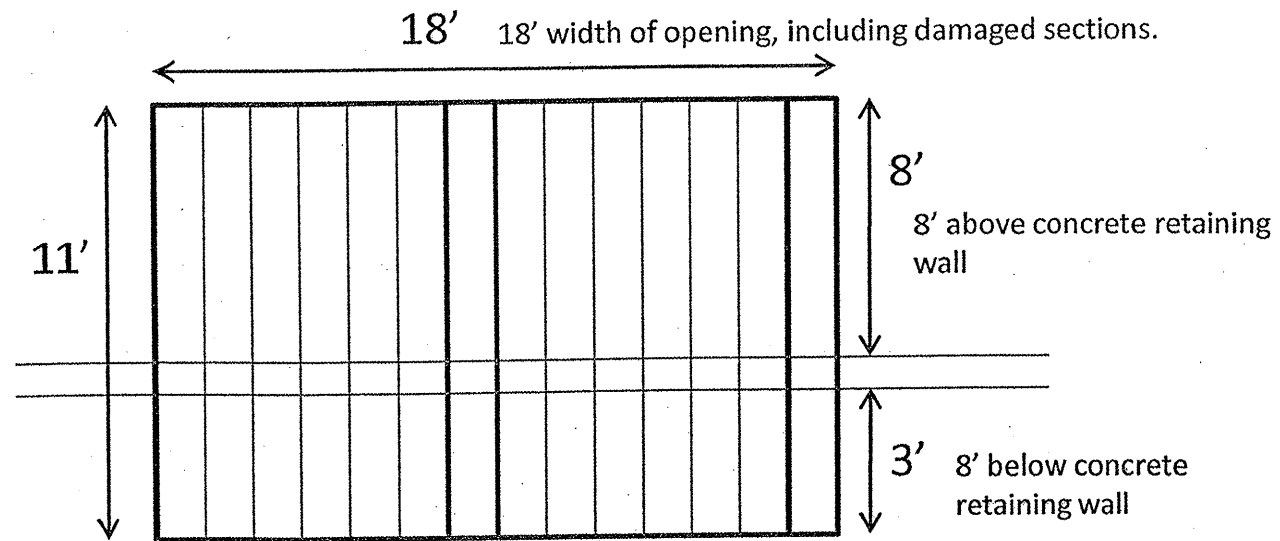

DETAIL LOCATION: 1
(SOUTHERN YELLOW PINE GLUE-LAMINATED WOODEN WALL)

LOCATION 1		
ITEM	UNIT	QUANTITY
Removal of Noise Abatement Wall Panels	SQ.FT.	178
Noise Abatement Wall, Ground Mounted (Laminated Wood)	SQ.FT.	198
FOR INFORMATION ONLY		

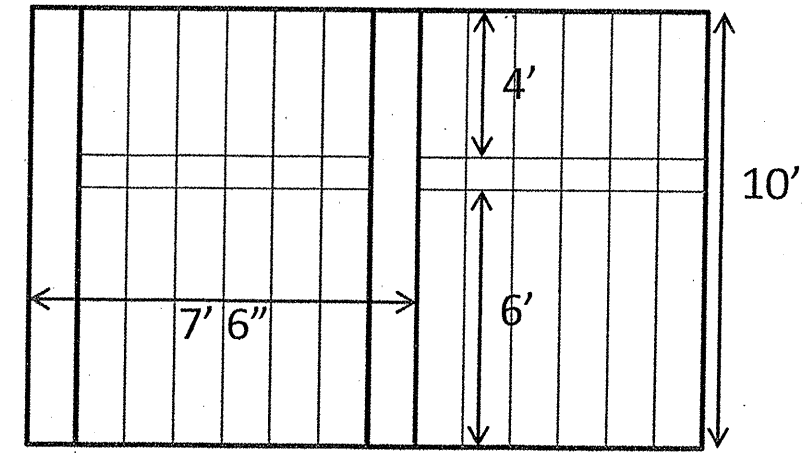

Each wall is comprised of 2 panels. Each panels come in either 4' or 6' heights. They are stacked to create the overall height desired.

DETAIL LOCATION: 2
(SOUTHERN YELLOW PINE GLUE-LAMINATED WOODEN WALL)

LOCATION 2		
ITEM	UNIT	QUANTITY
Noise Abatement Wall, Ground Mounted (Laminated Wood)	SQ.FT.	100
FOR INFORMATION ONLY		

FOR INFORMATION ONLY

SHEET 3 OF 4

ILLINOIS DEPARTMENT OF TRANSPORTATION

LOCATION: 1 AND 2
IL 83

ROUTE	SECTION	COUNTY	TOTAL SHEETS	SHEET NUMBER
VARIOUS	2009-075 I	VARIOUS	21	10

Contract 60H88

Each wall is comprised of 2 panels. Each panels come in either 4' or 6' heights. They are stacked to create the overall height desired. This location has stepped down from 10' to 8'.

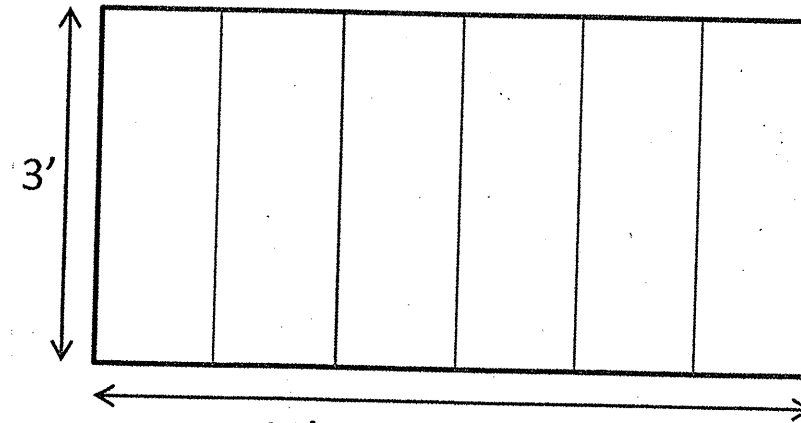
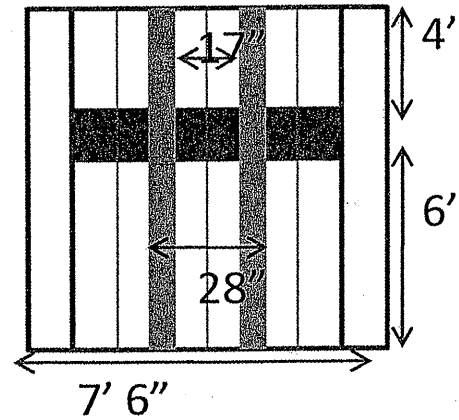

Each panel fits the 15' opening and slide in and seat on top of each other. Color: brown.

14' 10.5" panel size
(15' opening)
DETAIL LOCATION: 4
(DURISOL WALL)

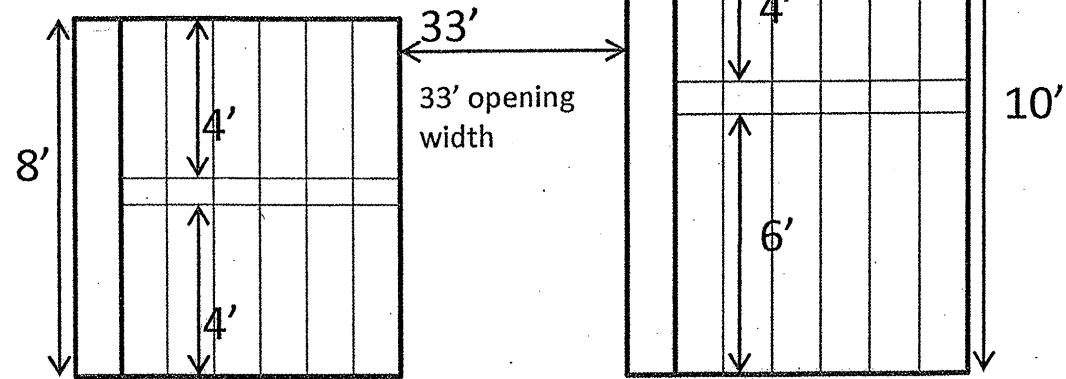

DETAIL LOCATION: 3
(SOUTHERN YELLOW PINE GLUE-LAMINATED WOODEN WALL)

LOCATION 3		
ITEM	UNIT	QUANTITY
Noise Abatement Wall, Ground Mounted (Laminated Wood)	SQ.FT.	297
FOR INFORMATION ONLY		

LOCATION 4		
ITEM	UNIT	QUANTITY
Removal of Noise Abatement Wall Panels	SQ.FT.	90
Noise Abatement Wall, Ground Mounted (Absorptive)	SQ.FT.	90
FOR INFORMATION ONLY		

ILLINOIS DEPARTMENT OF TRANSPORTATION

LOCATION: 3 AND 4
IL 83

FOR INFORMATION ONLY

SHEET 4 OF 4

ROUTE	SECTION	COUNTY	TOTAL SHEETS	SHEET NUMBER
VARIOUS	2009-075 I	VARIOUS	21	11

Contract 60H88

R 15 E

T 36 N

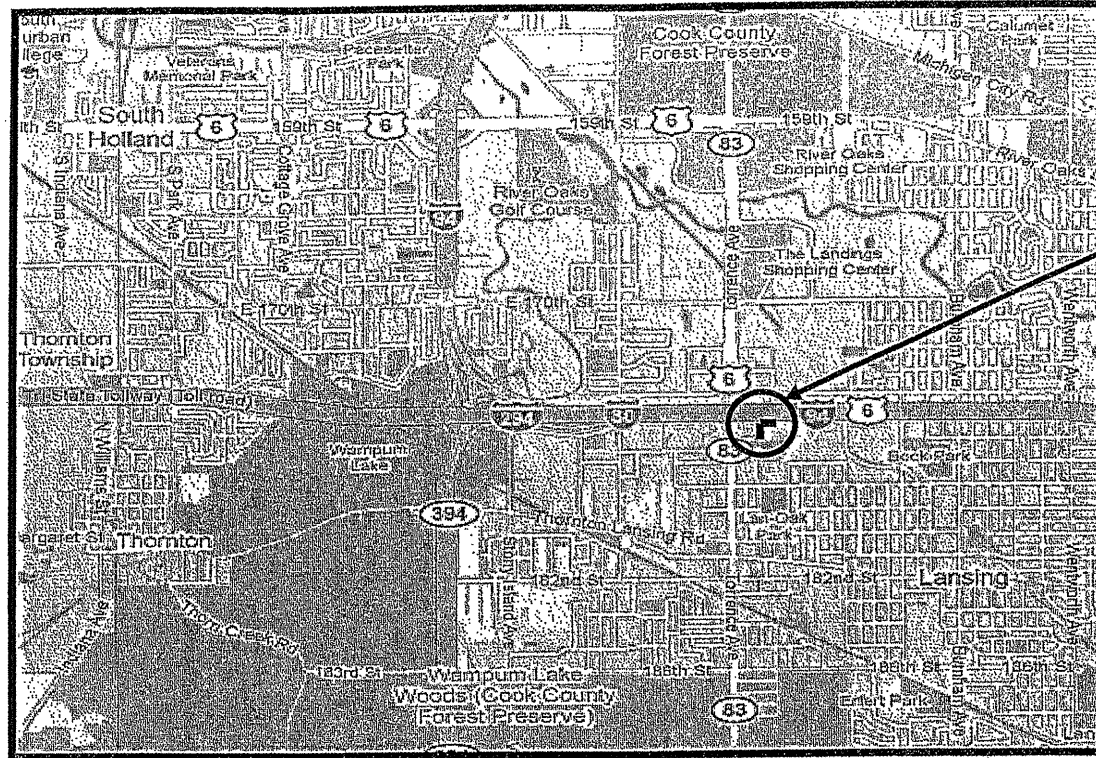

VILLAGE OF LANSING
THORNTON TOWNSHIP
COOK COUNTY



LOCATION 5: I- 80 (EB), AT SE CORNER OF IL 83 (TORRENCE AVE.)
ACCIDENT INVESTIGATION SITE (AIS).

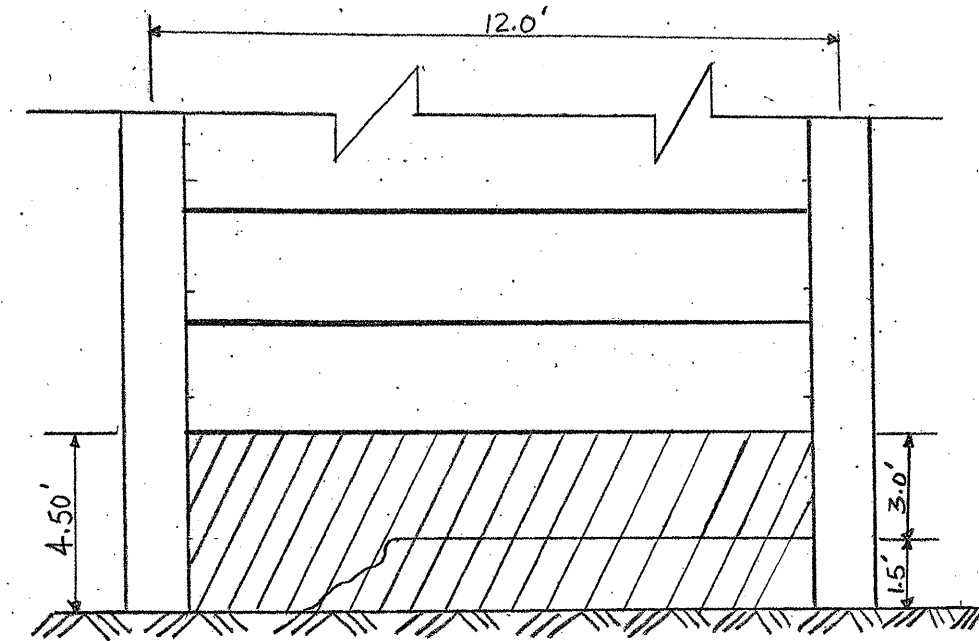

DETAIL

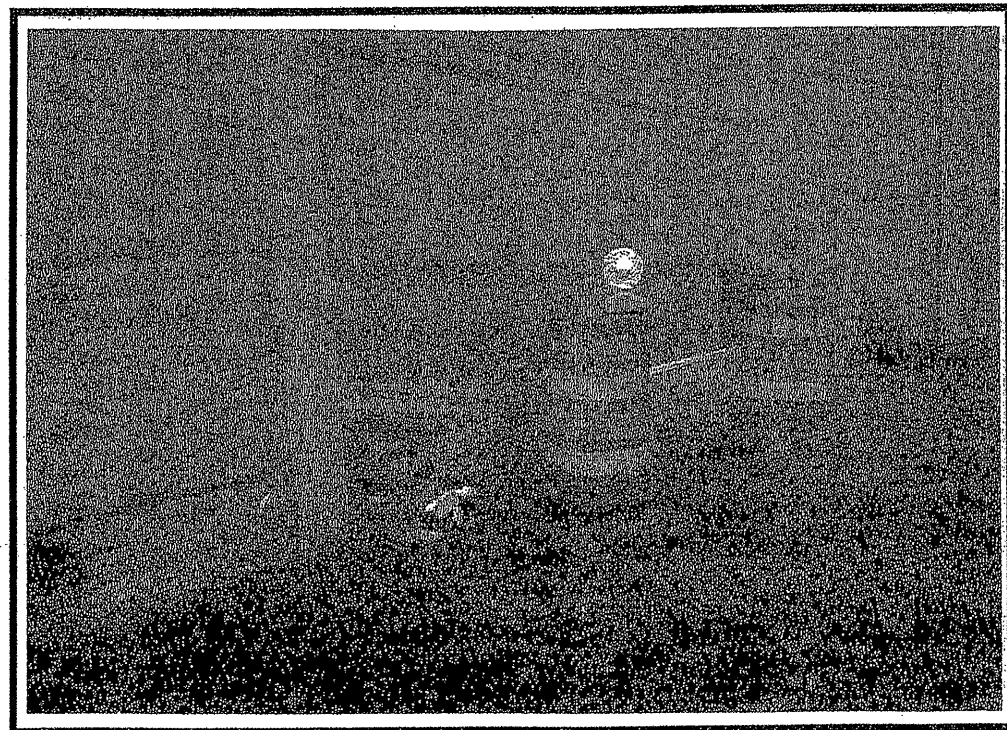

(DURISOL WALL)

TRAFFIC DATA:

I-80: SPEED LIMIT = 55 MPH
2009 ADT = 100,100
IL 83: SPEED LIMIT = 40 MPH
2009 ADT = 30,200

LOCATION 5

ITEM	UNIT	QUANTITY
Removal of Noise Abatement Wall Panels	SQ.FT.	54
Noise Abatement Wall, Ground Mounted (Absorptive)	SQ.FT.	54

FOR INFORMATION ONLY

ILLINOIS DEPARTMENT OF TRANSPORTATION

LOCATION: 5
I-80

ROUTE	SECTION	COUNTY	TOTAL SHEETS	SHEET NUMBER
VARIOUS	2009-075 I	VARIOUS	21	12

Contract 60H88

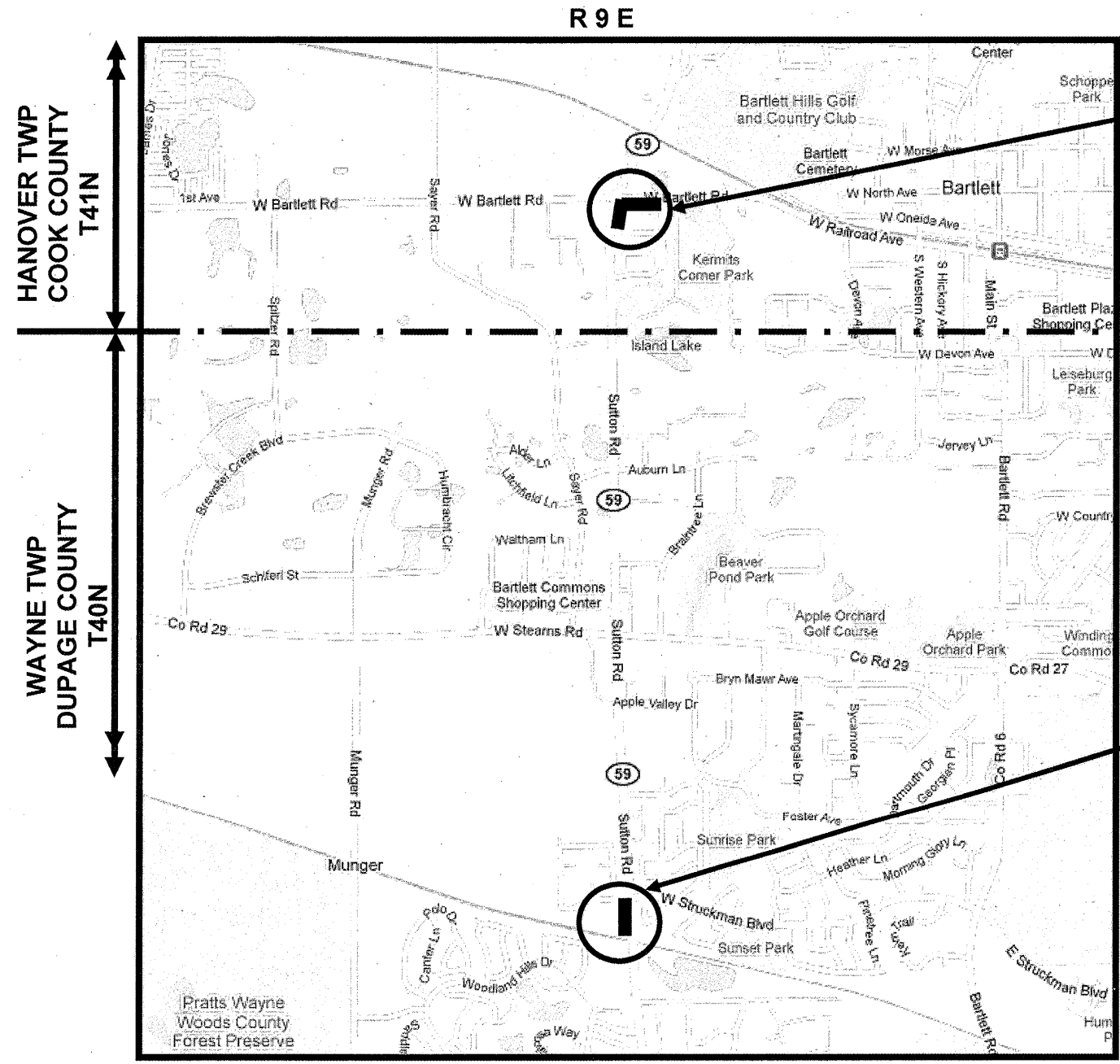

LOCATION 7: IL 59 (NB), WEST BARTLETT ROAD AND THEN EAST ALONG WEST BARTLETT ROAD ON THE SOUTH SIDE ROW LINE.

LOCATION 6: IL 59 (NB) SOUTH OF STRUCKMAN BLVD, WEST SIDE OF IL 59, NORTH OF RAIL ROAD TRACKS. (TWO SECTIONS AT ONE LOCATION).

**VILLAGE OF BARTLETT
HANOVER AND WAYNE TOWNSHIPS
COOK AND DuPAGE COUNTIES**

TRAFFIC DATA:

IL 59: SPEED LIMIT = 45MPH - 55 MPH
2009 ADT = 40,200

ILLINOIS DEPARTMENT OF TRANSPORTATION

LOCATION: 6 AND 7
IL 59

SHEET 1 OF 3

ROUTE	SECTION	COUNTY	TOTAL SHEETS	SHEET NUMBER
VARIOUS	2009-075 I	VARIOUS	21	13

Contract 60H88

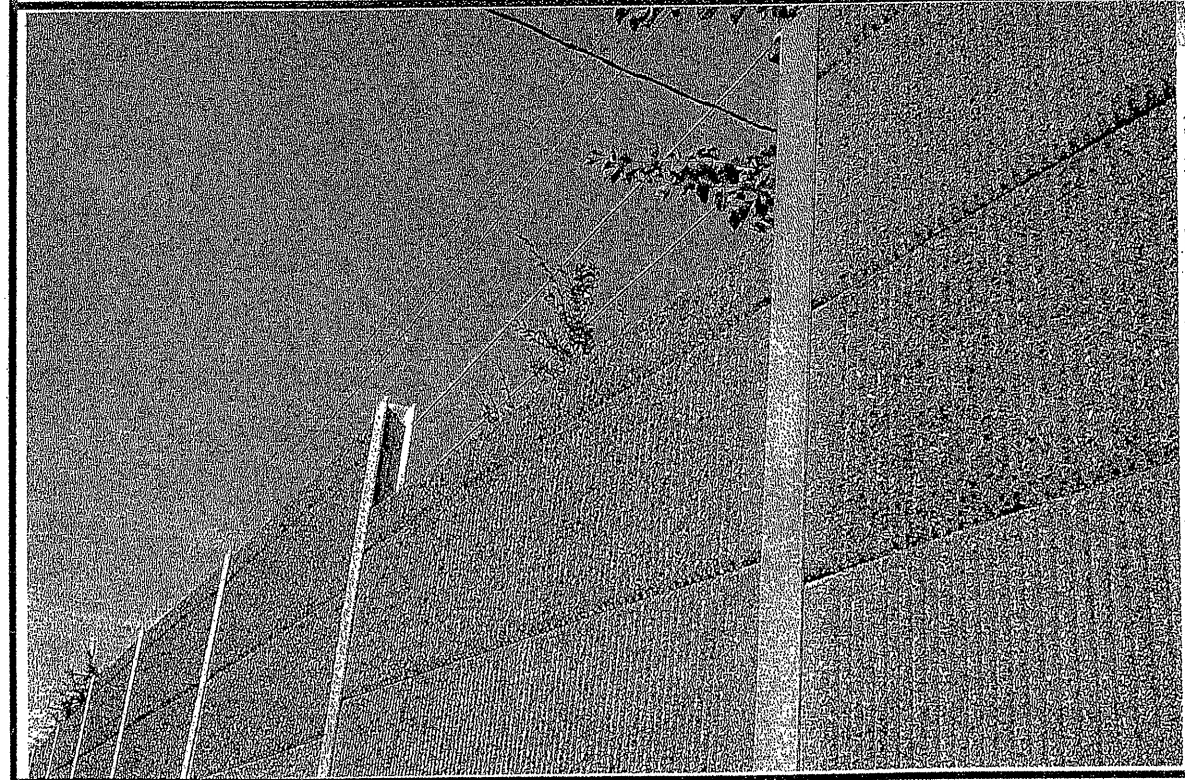
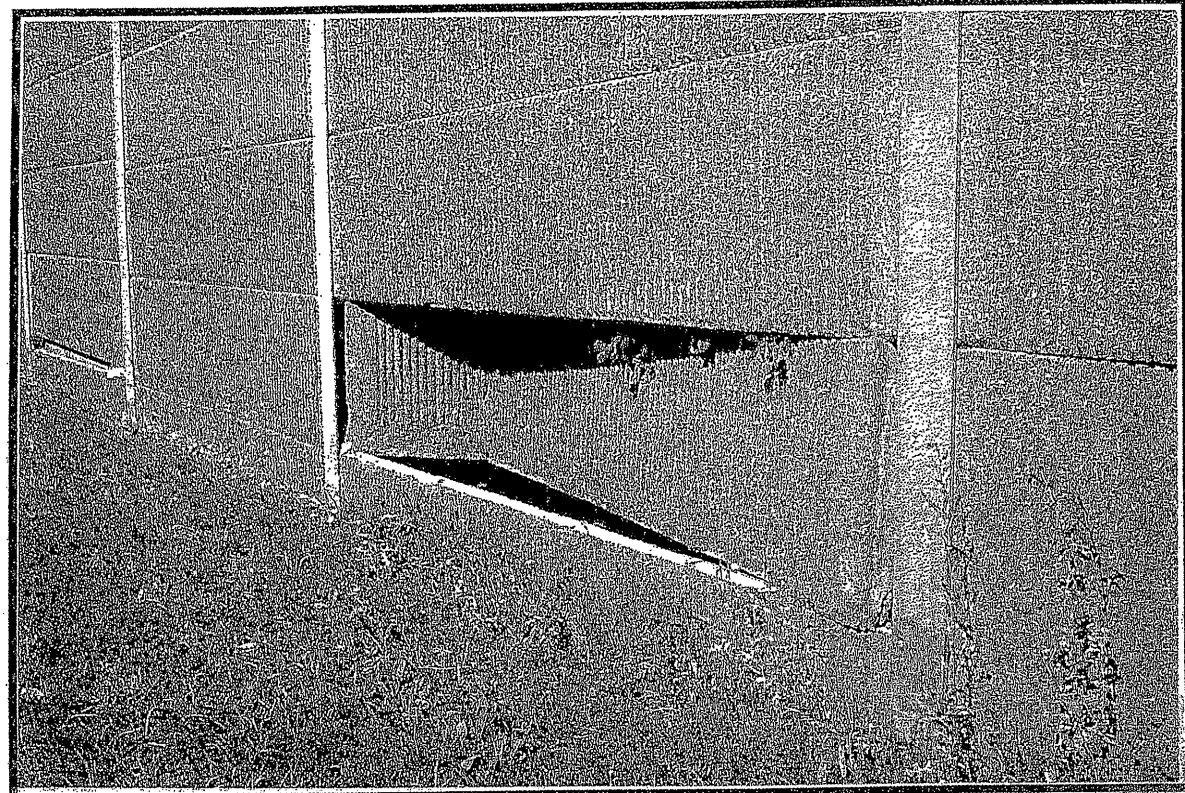

LOCATION: 6
(DURISOL WALL)

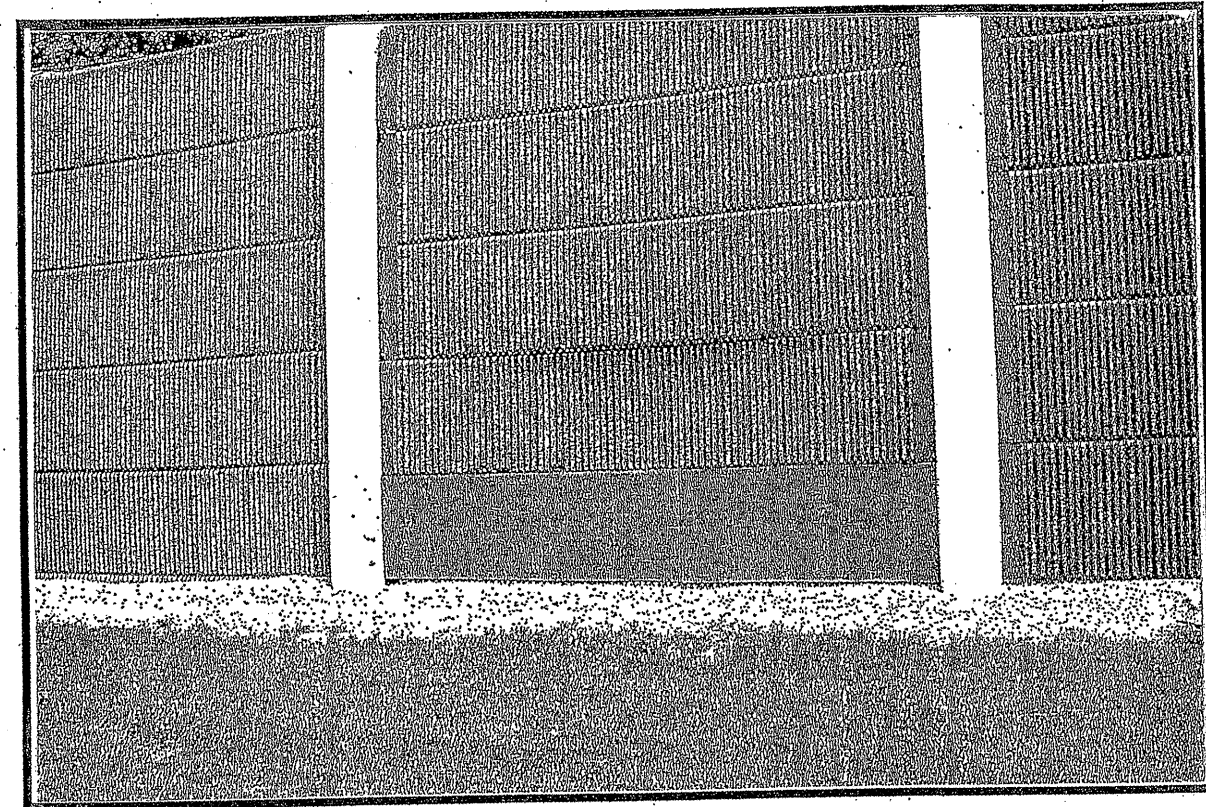

LOCATION: 7
(DURISOL WALL)

ILLINOIS DEPARTMENT OF TRANSPORTATION

LOCATION: 6 AND 7
IL 59

SHEET 2 OF 3

ROUTE	SECTION	COUNTY	TOTAL SHEETS	SHEET NUMBER
VARIOUS	2009-075 I	VARIOUS	21	14

Contract 60H88

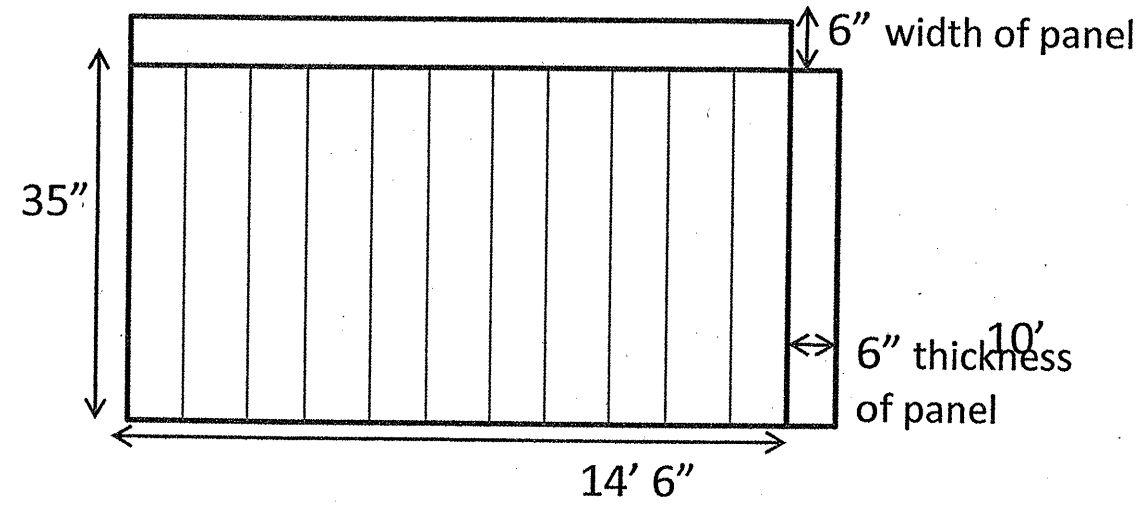

Wall is comprised of a series of panels, stacked on top. Wall height ranges from 12' to 17' in height. The beginning of the wall is stepped up to full 17' height in the middle.

**DETAIL LOCATION: 6
(DURISOL WALL)**

LOCATION 6

ITEM	UNIT	QUANTITY
Removal of Noise Abatement Wall Panels	SQ.FT.	90
Noise Abatement Wall, Ground Mounted (Absorptive)	SQ.FT.	90
FOR INFORMATION ONLY		

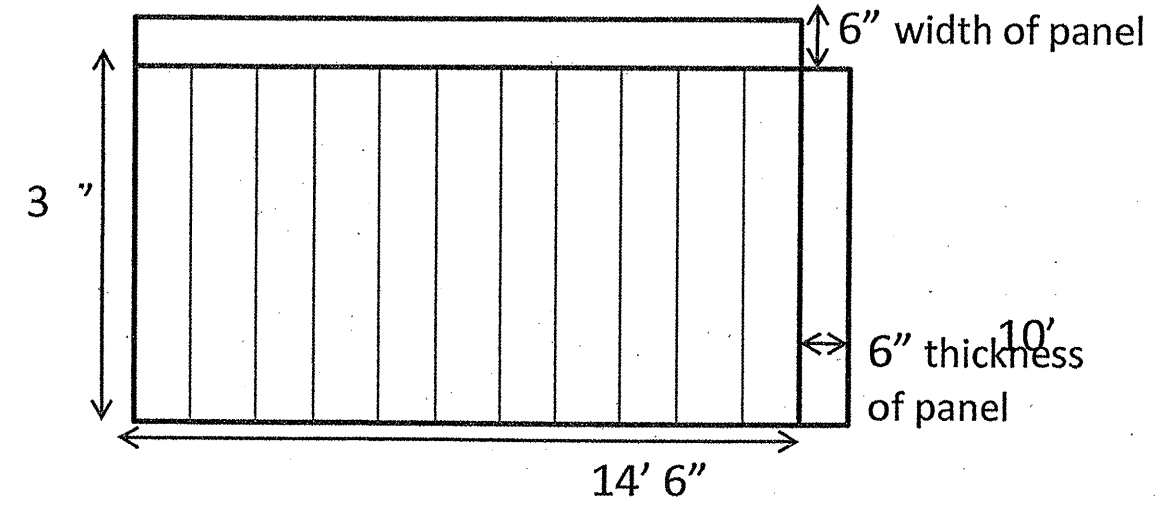

Vertical Displacement / Alignment Notice The Edge Of The Panels Exposure Relative To The Steel "H" Post. Looks Like a Post Spacing Problem During The Construction / Erection Of The Noisewall.

**DETAIL LOCATION: 7
(DURISOL WALL)**

LOCATION 7

ITEM	UNIT	QUANTITY
Removal of Noise Abatement Wall Panels	SQ.FT.	45
Noise Abatement Wall, Ground Mounted (Absorptive)	SQ.FT.	45
FOR INFORMATION ONLY		

FOR INFORMATION ONLY

SHEET 3 OF 3

ILLINOIS DEPARTMENT OF TRANSPORTATION

LOCATION: 6 AND 7
IL 59

ROUTE	SECTION	COUNTY	TOTAL SHEETS	SHEET NUMBER
VARIOUS	2009-075 I	VARIOUS	21	15

Contract 60H88

LOCATION 8: ELGIN O'HARE EXPRESSWAY (EB), AT MEACHAM CREEK, APPROX. 0.15 MILE (800 FT.) WEST OF PLUM GROVE ROAD BRIDGE. VILLAGE OF ROSELLE

LOCATION 9: ELGIN O'HARE EXPRESSWAY (EB), (END OF WALL) APPROX. 0.30 MILE (1500 FT.) EAST OF PLUM GROVE ROAD BRIDGE. VILLAGE OF ROSELLE

LOCATION 10: ELGIN O'HARE EXPRESSWAY (WB), WEST OF MEACHAM/MEDINA ROAD EXIT RAMP, AT LIGHT POLE 1B1, MILE MARKER 1127. VILLAGE OF ITASCA

LOCATION 11: ELGIN O'HARE EXPRESSWAY (WB), WEST OF MEACHAM/MEDINA ROAD ENTRANCE RAMP, JUST EAST OF EAST ABUTMENT, (SN 022-0222) ELK GROVE VILLAGE

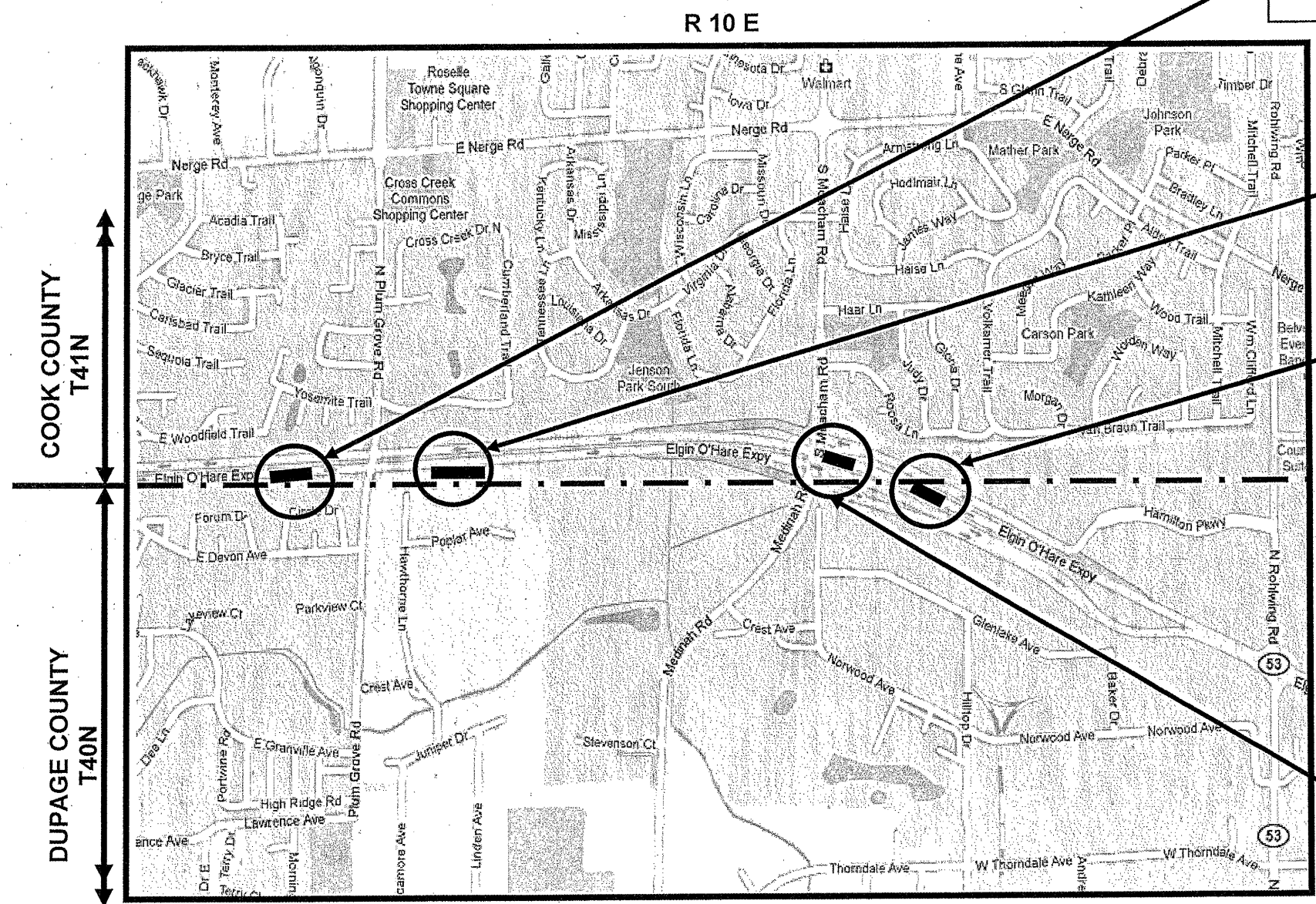

SCHAUMBURG AND BLOOMINGDALE TOWNSHIPS
COOK AND DUPAGE COUNTIES

TRAFFIC DATA:
ELGIN O'HARE EXPWY: SPEED LIMIT = 45MPH - 55 MPH
2008 ADT = 80,100

SHEET 1 OF 3

ILLINOIS DEPARTMENT OF TRANSPORTATION

LOCATION: 8, 9, 10, AND 11
ELGIN O'HARE EXPWY

ROUTE	SECTION	COUNTY	TOTAL SHEETS	SHEET NUMBER
VARIOUS	2009-075 I	VARIOUS	21	16

Contract 60H88

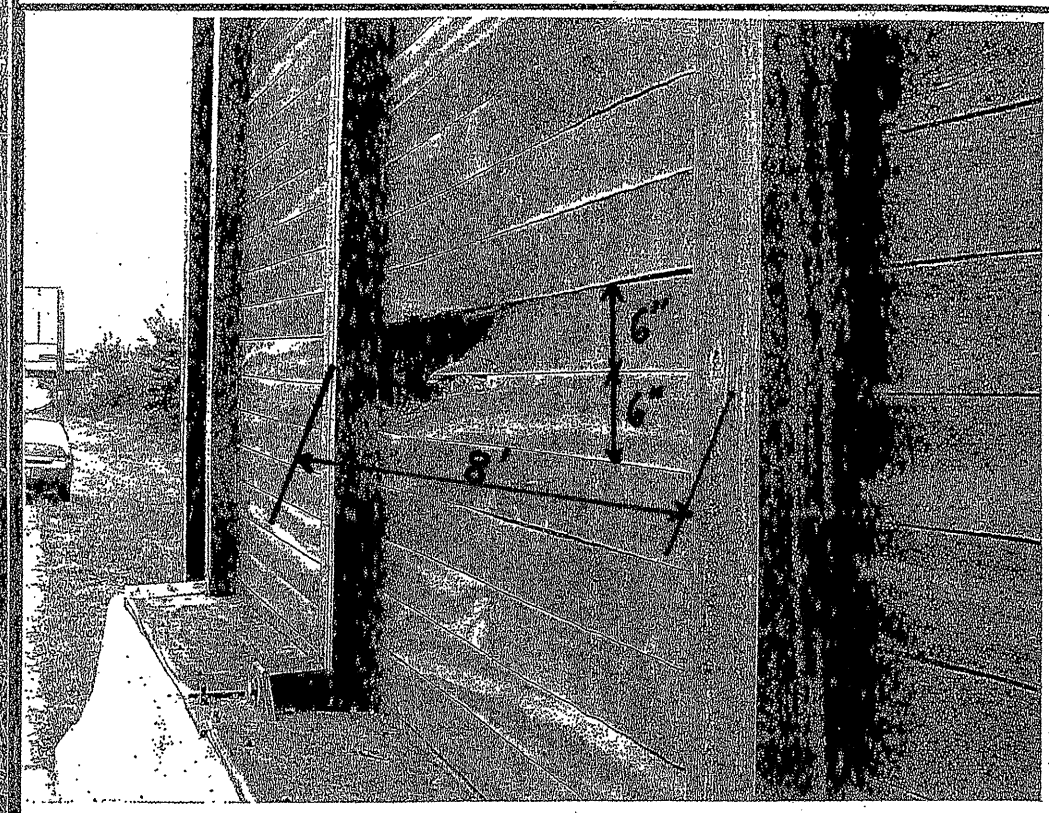
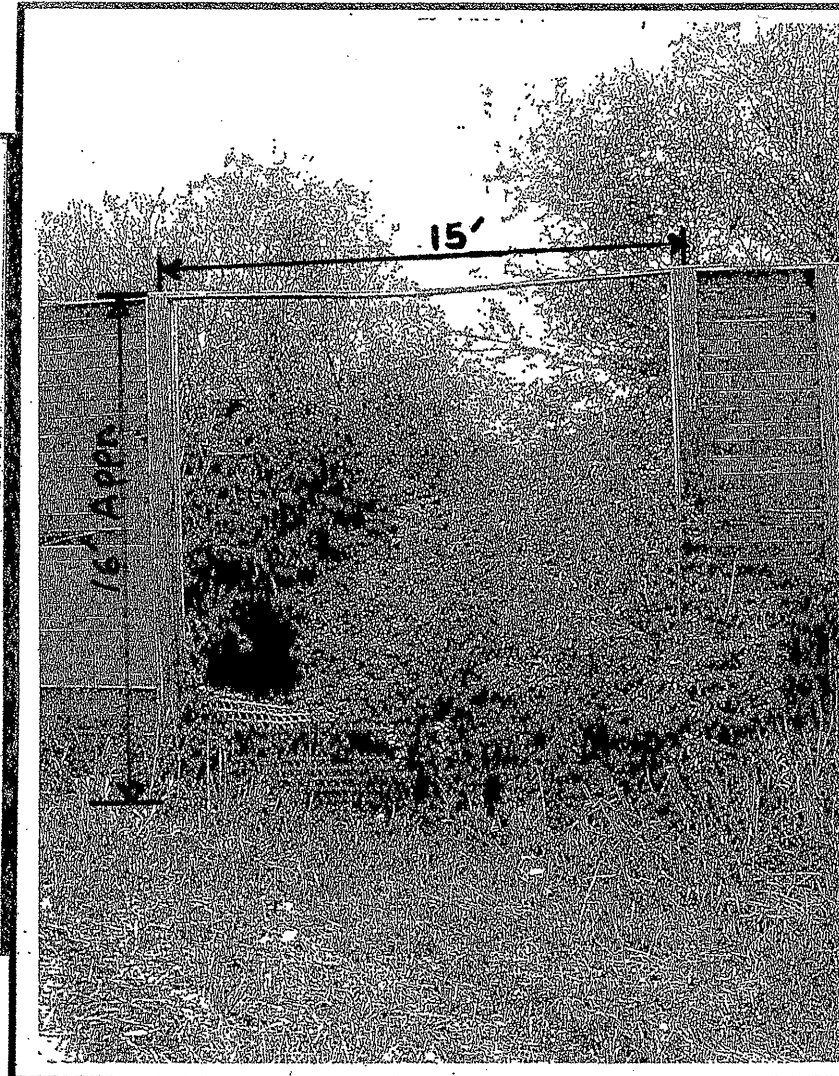

LOCATION: 8
(BONGOSSI POST/BONALIN PANEL WOODEN WALL)

LOCATION 8		
ITEM	UNIT	QUANTITY
Removal of Noise Abatement Wall Panels	SQ.FT.	6.40
Noise Abatement Wall, Ground Mounted (Hard Wood)	SQ.FT.	273
FOR INFORMATION ONLY		

ILLINOIS DEPARTMENT OF TRANSPORTATION

LOCATION: 8,
ELGIN O'HARE EXPWY

SHEET 2 OF 3

ROUTE VARIOUS	SECTION 2009-0751	COUNTY VARIOUS	TOTAL SHEETS 21	SHEET NUMBER 17
------------------	----------------------	-------------------	--------------------	--------------------

Contract 60H88

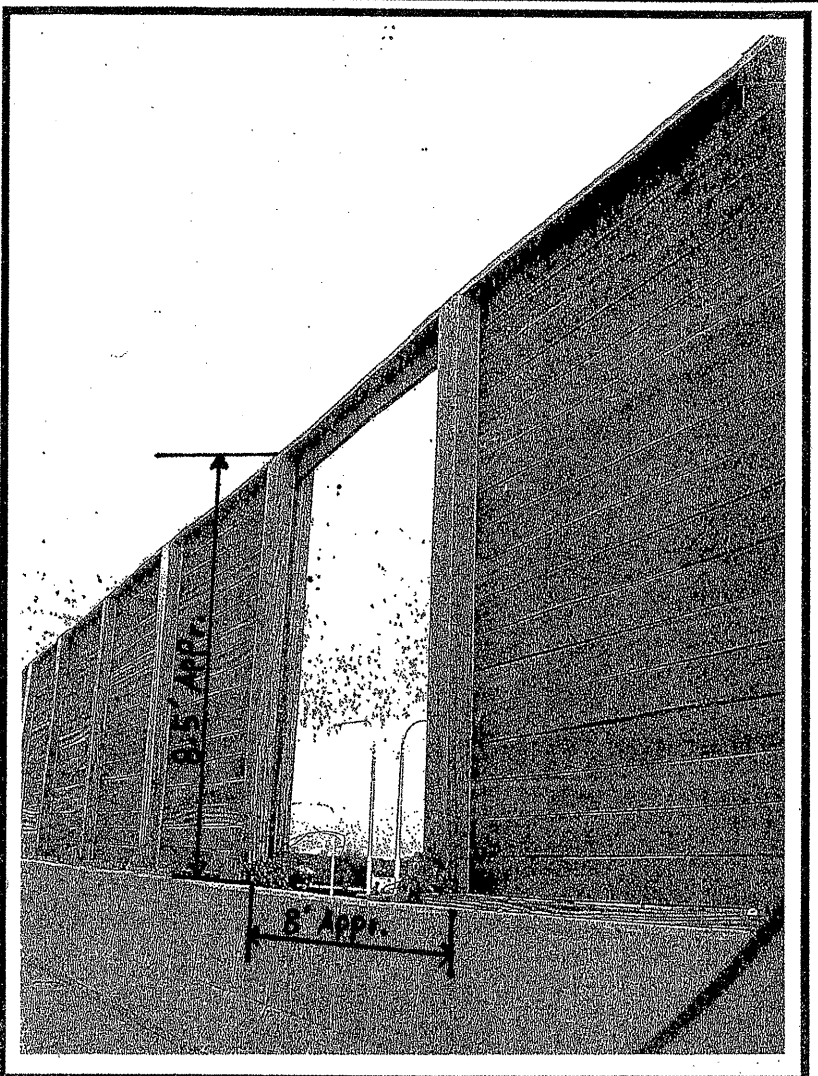
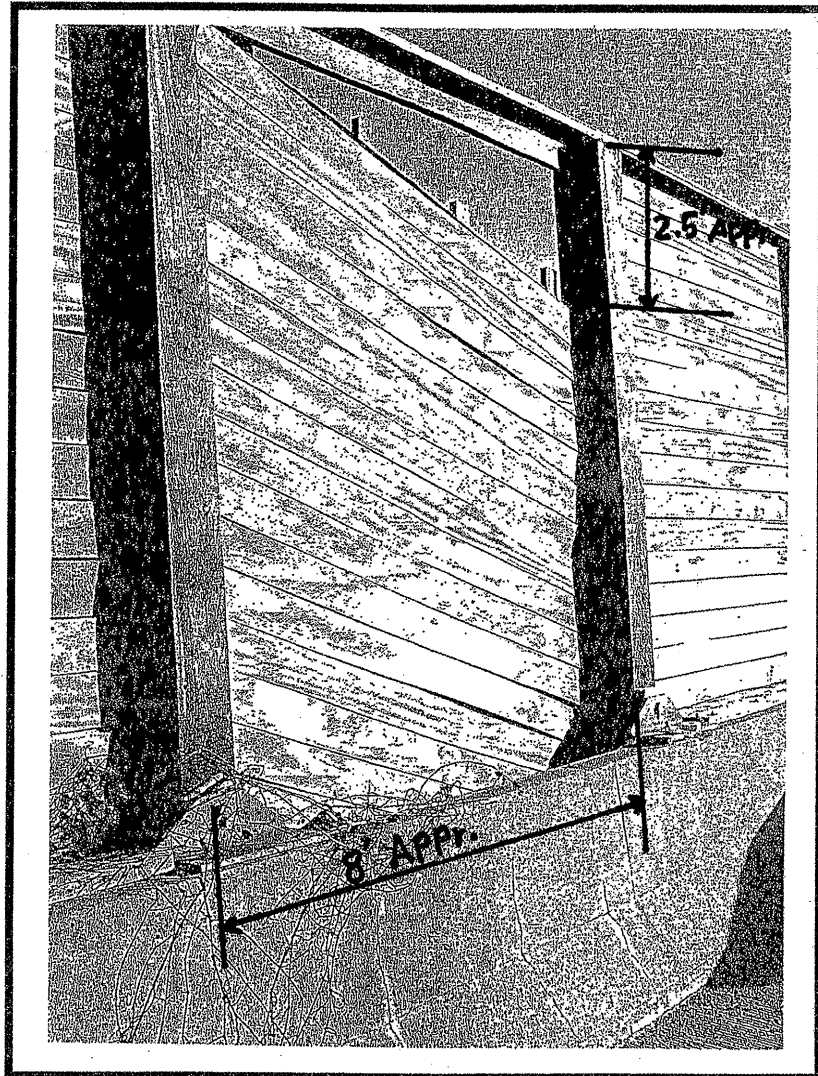
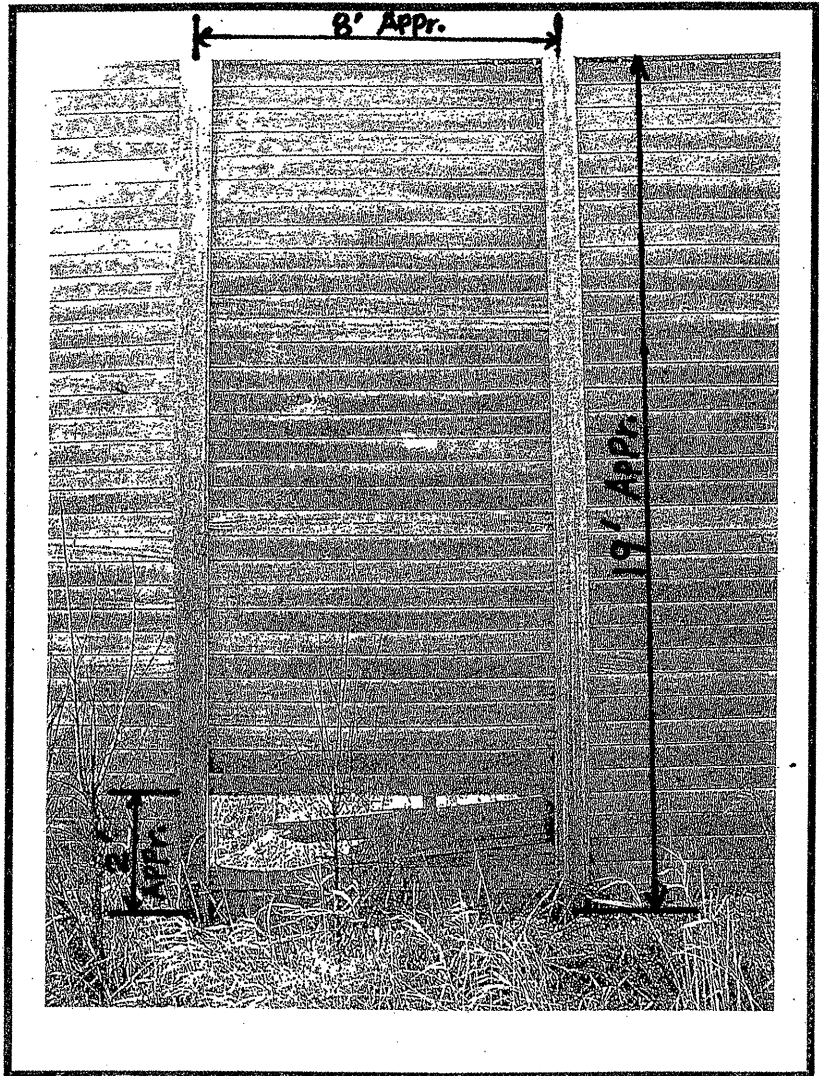

LOCATION: 9
(BONGOSSI POST/BONALIN PANEL WOODEN WALL)

LOCATION: 10
(BONGOSSI POST/BONALIN PANEL WOODEN WALL)

LOCATION: 11
(BONGOSSI POST/BONALIN PANEL WOODEN WALL)

LOCATION 9		
ITEM	UNIT	QUANTITY
Removal of Noise Abatement Wall Panels	SQ.FT.	120
Noise Abatement Wall, Ground Mounted (Hard Wood)	SQ.FT.	152
FOR INFORMATION ONLY		

LOCATION 10		
ITEM	UNIT	QUANTITY
Noise Abatement Wall, Ground Mounted (Hard Wood)	SQ.FT.	20
FOR INFORMATION ONLY		

LOCATION 11		
ITEM	UNIT	QUANTITY
Noise Abatement Wall, Ground Mounted (Hard Wood)	SQ.FT.	68
FOR INFORMATION ONLY		

SHEET 3 OF 3

ILLINOIS DEPARTMENT OF TRANSPORTATION

LOCATION: 9, 10 and 11
ELGIN O'HARE EXPWY

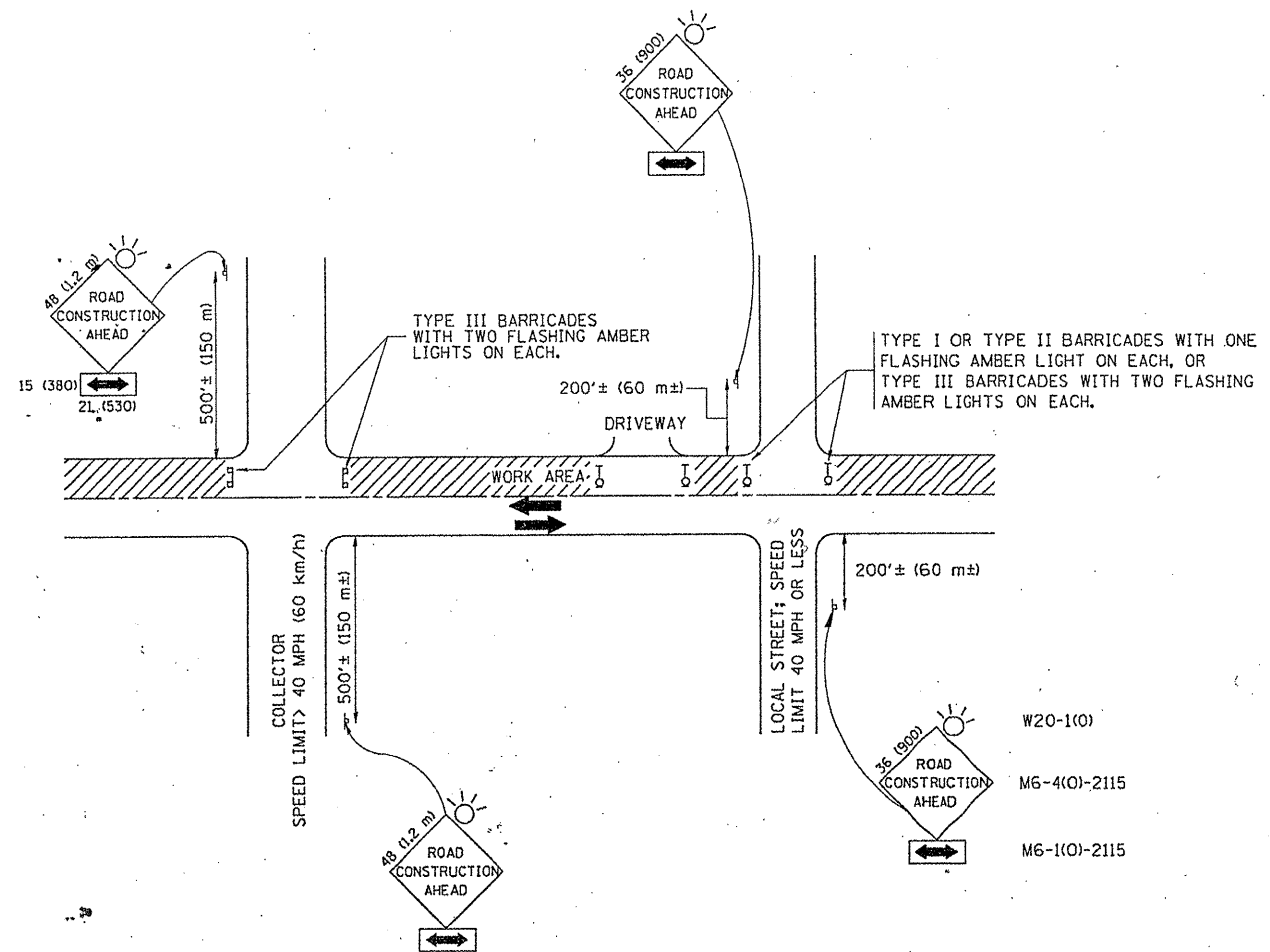

TRAFFIC CONTROL AND PROTECTION FOR SIDE ROADS, INTERSECTIONS, AND DRIVEWAYS

NOTES:

- A. FOR NO LANE RESTRICTION ON THE SIDE ROAD OR DRIVEWAYS**
- SIDE ROAD WITH A SPEED LIMIT OF 40 MPH (60 km/h) OR LESS AS SHOWN ON THE DRAWING AND AS DIRECTED BY THE ENGINEER:
 - ONE **ROAD CONSTRUCTION AHEAD** SIGN 36 x 36 (900x900) WITH A FLASHER AND FLAG MOUNTED ON IT APPROXIMATELY 200' (60 m) IN ADVANCE OF THE MAIN ROUTE.
 - THE CLOSED PORTION OF THE MAIN ROUTE SHALL BE PROTECTED BY BLOCKING WITH TYPE I, TYPE II OR TYPE III BARRICADES, 1/3 OF THE CROSS SECTION OF THE CLOSED PORTION.
 - SIDE ROAD WITH A SPEED LIMIT GREATER THAN 40 MPH (60 km/h) AS SHOWN ON THE DRAWING AND AS DIRECTED BY THE ENGINEER:
 - ONE **ROAD CONSTRUCTION AHEAD** SIGN 48 x 48 (1.2 m x 1.2 m) WITH A FLASHER MOUNTED ON IT APPROXIMATELY 500' (150 m) IN ADVANCE OF THE MAIN ROUTE.
 - THE CLOSED PORTION OF THE MAIN ROUTE SHALL BE PROTECTED BY BLOCKING WITH TYPE III BARRICADES, 1/2 OF THE CROSS SECTION OF THE CLOSED PORTION.
 - WHEN THE SIDE ROAD LIES BETWEEN THE BEGINNING OF THE MAINLINE SIGNING AND THE WORK ZONE, A SINGLE HEADED ARROW (M6-1) SHALL BE USED IN LIEU OF THE DOUBLE HEADED ARROW (M6-4).
- B. FOR A LANE CLOSURE ON A SIDE ROAD OR DRIVEWAY:**
- USE APPLICABLE PORTIONS OF THE TYPICAL APPLICATION OF TRAFFIC CONTROL DEVICES (STD. 701501, STD. 701606 OR THE APPROPRIATE STANDARD). THE SPACING OF SIGNS AND BARRICADES SHALL BE ADJUSTED FOR FIELD CONDITIONS AS DIRECTED BY THE ENGINEER. THE DIRECTIONAL ARROW SHALL BE COVERED OR REMOVED WHEN NO LONGER CONSISTENT WITH THE SIDE ROAD LANE CLOSURE.
- C. ADVANCE WARNING SIGNS ARE TO BE OMITTED ON DRIVEWAY UNLESS OTHERWISE NOTED.**
- D. THE TRAFFIC CONTROL AND PROTECTION FOR SIDE ROADS, INTERSECTIONS, AND DRIVEWAYS SHALL BE INCIDENTAL TO THE COST OF SPECIFIED TRAFFIC CONTROL STANDARDS OR ITEMS.**

All dimensions are in millimeters (inches) unless otherwise shown.

FILE NAME =	USER NAME = hmondanah	DESIGNED - LHA	REVISED - J. OBERLE 10-18-95
et:\px_wor-k\PIWIDOT\HAMOANAH\d0176891\Di	Seddgn	DRAWN -	REVISED - A. HOUSEH 03-06-96
	PLOT SCALE = 103.1218 "/ IN.	CHECKED -	REVISED - A. HOUSEH 10-15-96
	PLOT DATE = 4/15/2010	DATE - 06-89	REVISED - T. RAMMACHER 01-06-00

**STATE OF ILLINOIS
DEPARTMENT OF TRANSPORTATION**

**TRAFFIC CONTROL AND PROTECTION FOR
SIDE ROADS, INTERSECTIONS, AND DRIVEWAYS**

SCALE: NONE SHEET NO. 1 OF 1 SHEETS STA. TO STA.

F.A. RTE.	SECTION	COUNTY	TOTAL SHEETS	SHEET NO.
VARIOUS	2009-075 1	VARIOUS	21	18
TC-10			CONTRACT NO. 60H88	
FED. ROAD DIST. NO. 1 ILLINOIS FED. AID PROJECT				

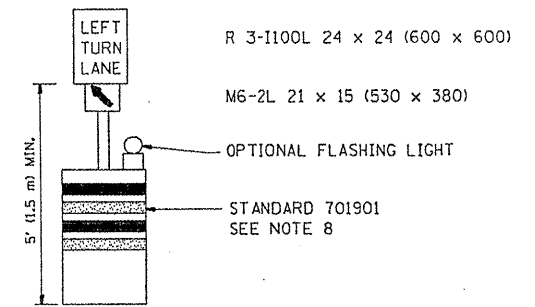
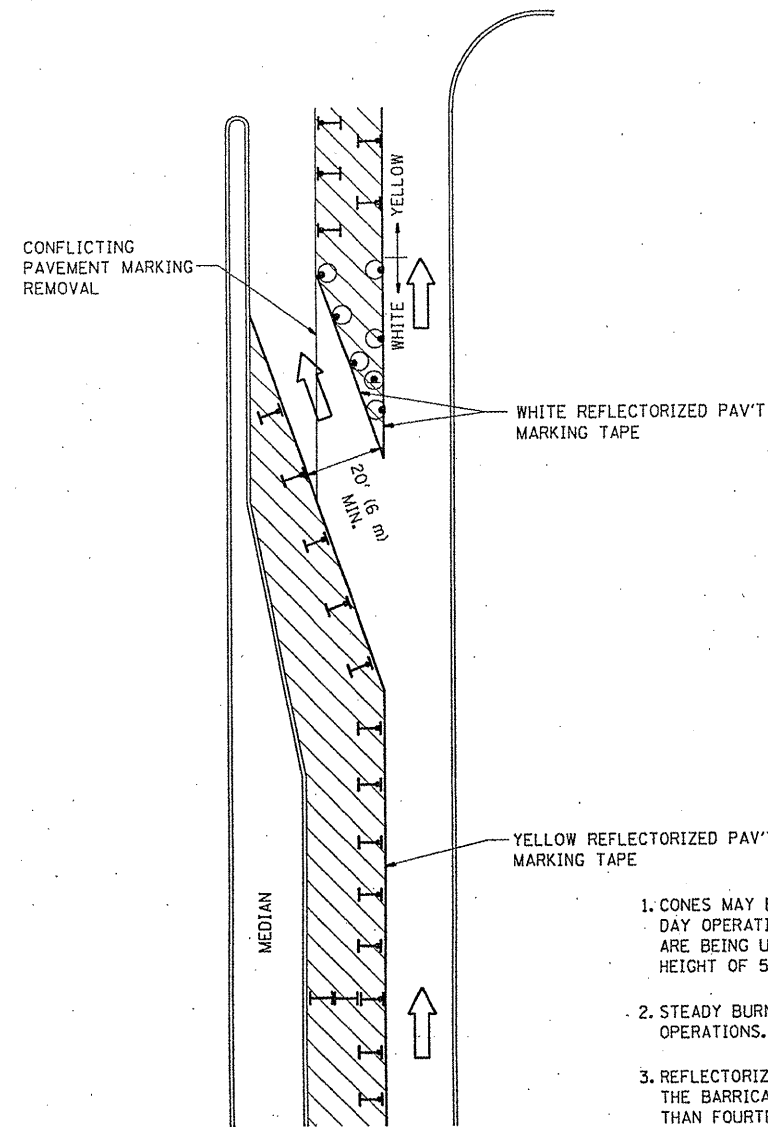



GENERAL NOTES

1. CONES MAY BE SUBSTITUTED FOR BARRICADES OR DRUMS AT HALF THE SPACING DURING DAY OPERATIONS. CONES SHALL BE A MINIMUM OF 28 (710) IN HEIGHT. WHEN CONES ARE BEING USED, THE "LEFT TURN LANE" SIGN MAY BE SKID MOUNTED AT A MINIMUM HEIGHT OF 5' (1.5 m).
2. STEADY BURNING LIGHTS WILL NOT BE REQUIRED ON BARRICADES OR DRUMS FOR DAY OPERATIONS. ALL LIGHTS SHALL BE MONODIRECTIONAL.
3. REFLECTORIZED TEMPORARY PAVEMENT MARKING TAPE SHALL BE PLACED THROUGHOUT THE BARRICADED AREA OF EACH TURN BAY WHERE THE CLOSURE TIME IS GREATER THAN FOURTEEN DAYS.
4. THIS APPLICATION ALSO APPLIES WHEN WORK IS BEING PERFORMED IN THE RIGHT LANE(S) AND THE RIGHT TURN BAY IS TO REMAIN OPEN. UNDER THIS CONDITION, "RIGHT TURN LANE" R3-100 24 x 24 (600 x 600) AND M6-2R 21 x 15 (530 x 380) SHALL BE USED.
5. THESE CONTROLS SHALL SUPPLEMENT MAINLINE TRAFFIC CONTROL FOR LANE CLOSURES.
6. LONGITUDINAL DIMENSIONS MAY BE ADJUSTED TO FIT FIELD CONDITIONS.
7. FORM OPER 725 IS REQUIRED.
8. IF A DRUM OR TYPE II BARRICADE WITH AN ATTACHED SIGN PANEL WHICH MEETS NCHRP 350 REQUIREMENTS IS NOT AVAILABLE, THE SIGNS SHALL BE MOUNTED, ABOVE THE BARRICADES, ON SEPARATE SIGNS SUPPORTS THAT MEET NCHR 350 PREQUIREMENTS.
9. TRAFFIC CONTROL AND PROTECTION AT TURN BAYS (TO REMAIN OPEN TO TRAFFIC) SHALL BE INCLUDED IN THE COST SPECIFIED TRAFFIC CONTROL STANDARDS OR ITEMS.

All dimensions are in inches (millimeters) unless otherwise shown.

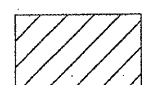
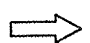
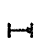
LEGEND

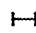
-  WORK AREA
-  LANE OPEN TO TRAFFIC
-  TYPE I OR II BARRICADE WITH STEADY BURN LIGHT
-  DRUM WITH STEADY BURN LIGHT
-  DRUM WITH SIGN (WITH OPTIONAL FLASHING LIGHT) SEE DETAIL
-  TYPE I OR II CHECK BARRICADE WITH FLASHING LIGHT

FILE NAME =	USER NAME = hmdaneh	REVISED - T. RAMMACHER 09-08-94	REVISED - R. BORO 09-14-09
Plot Scale = 1/8" = 1' / IN.	Plot Date = 4/19/2010	REVISED - A. HOUSEH 11-07-95	REVISED -
		REVISED - A. HOUSEH 10-12-96	REVISED -
		REVISED - T. RAMMACHER 01-06-00	REVISED -

**STATE OF ILLINOIS
DEPARTMENT OF TRANSPORTATION**

TRAFFIC CONTROL AND PROTECTION AT TURN BAYS (TO REMAIN OPEN TO TRAFFIC)			
SCALE: NONE	SHEET NO. 1 OF 1 SHEETS	STA.	TO STA.

F.A. RTE.	SECTION	COUNTY	TOTAL SHEETS	SHEET NO.
VARIOUS	2009-075 1	VARIOUS	21	19
TC-14			CONTRACT NO. 60H88	
FED. ROAD DIST. NO. 1 ILLINOIS FED. AID PROJECT				

PARTIAL RAMP CLOSURE DETAILS

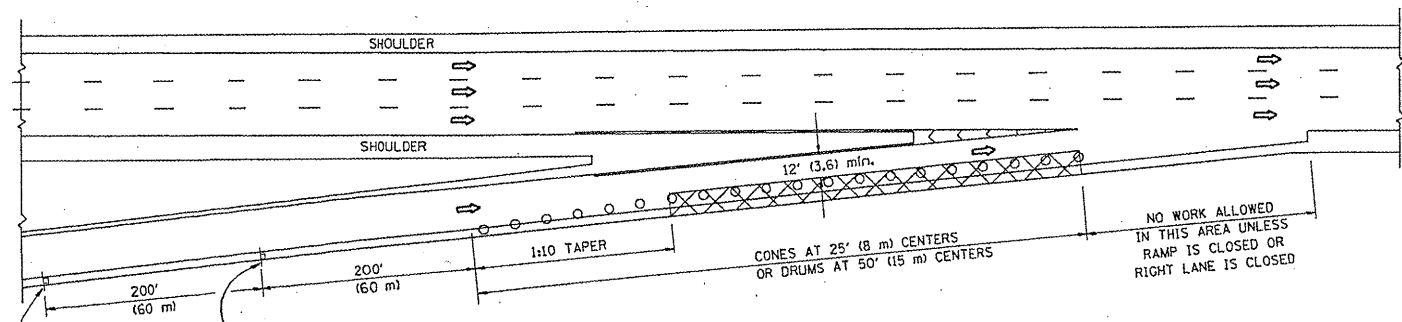

TYPICAL ENTRANCE RAMP

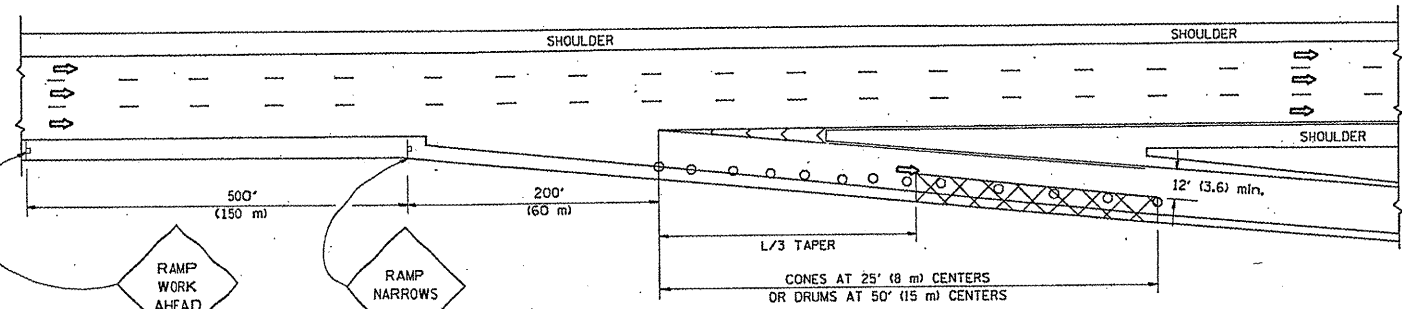

TYPICAL EXIT RAMP

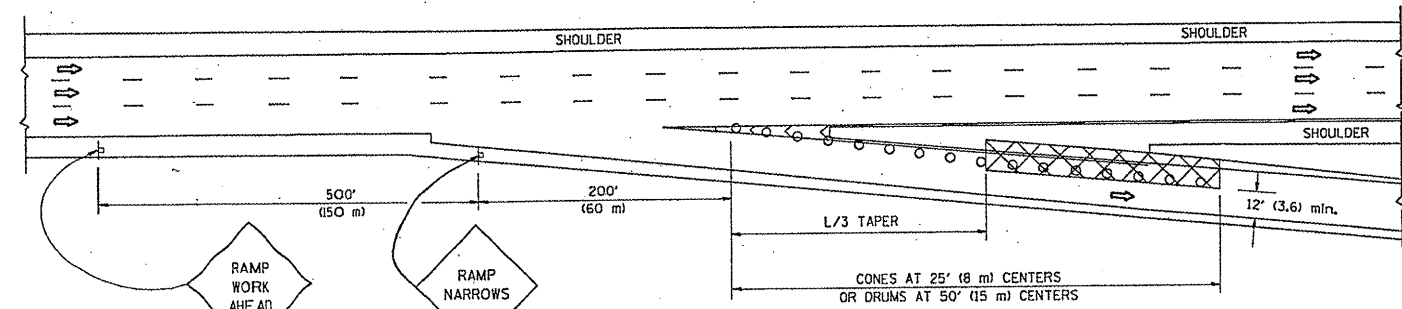

TYPICAL EXIT RAMP

SYMBOLS

- ACTIVE WORK AREA
- SIGN ON PORTABLE OR PERMANENT SUPPORT
- FLAGGER WITH CONTROL SIGN
- TYPE II BARRICADE, DRUM OR VERTICAL BARRICADE WITH STEADY BURN MONO-DIRECTIONAL LIGHT
- CONE, DRUM OR BARRICADE

GENERAL NOTES

1. THE "L" DISTANCE EQUALS:

SPEED LIMIT	FORMULAS
45 mph (80 km/h) OR GREATER:	METRIC: $L = 0.65(WKS)$ ENGLISH: $L = (WKS)$
	W = WIDTH OF OFFSET IN FEET (METERS)
	S = NORMAL POSTED SPEED MPH (KM/H)
2. PLASTIC DRUMS WITH HIGH PERFORMANCE REFLECTIVE SHEETING AND STEADY BURNING LIGHTS ARE REQUIRED FOR ALL NIGHTTIME CLOSURES.
3. ALL SIGNS SHALL BE POST MOUNTED IF THE CLOSURE TIME EXCEEDS FOUR DAYS.
4. FLASHING LIGHTS SHALL BE USED DURING THE HOURS OF DARKNESS AND SHALL BE INSTALLED ABOVE THE FIRST TWO SETS OF SIGNS.

SHOULDER CLOSURE DETAILS

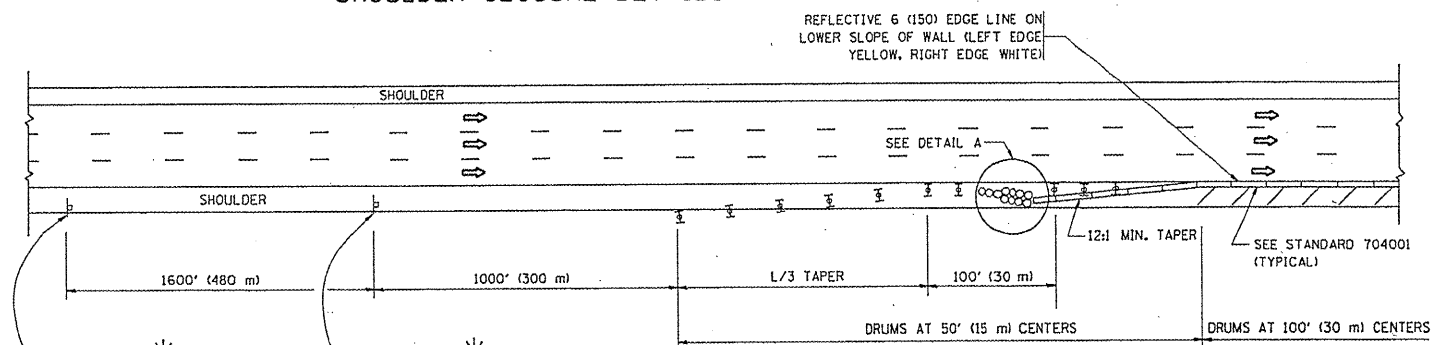

PERMANENT SHOULDER CLOSURE

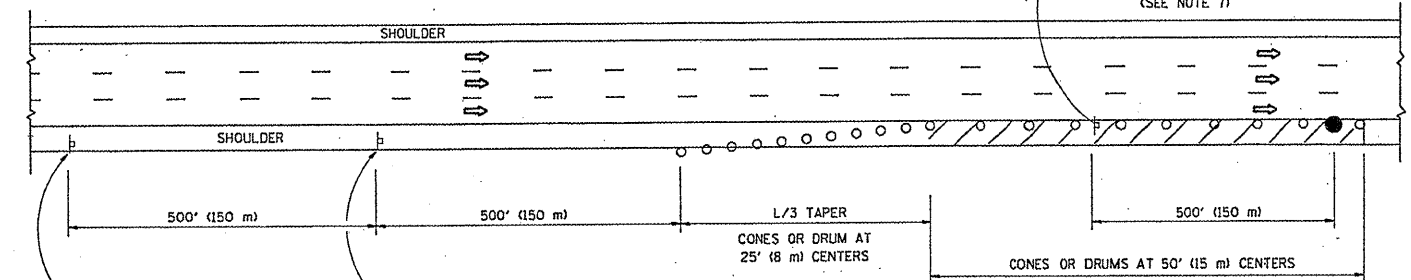

DAYTIME SHOULDER CLOSURE

THIS DETAIL IS USED WHERE:

1. VEHICLES, EQUIPMENT, WORKERS OR THEIR ACTIVITIES ENCRDACH IN AN AREA CLOSER THAN 15' (4.5 m) TO THE EDGE OF PAVEMENT FOR A PERIOD IN EXCESS OF 15 MINUTES.

ARRAY DESIGN PER MANUFACTURER TO BE NCHRP 350 COMPLIANT.

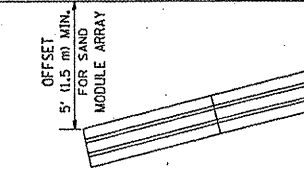

DETAIL "A" IMPACT ATTENUATOR, TEMPORARY (SEE NOTE 5)

ALL DIMENSIONS ARE IN INCHES (MILLIMETERS) UNLESS OTHERWISE SHOWN.

FILE NAME =	USER NAME = hamdanah	DESIGNED -	REVISED - 04-03
Std.dgn		DRAWN - D.W.S.	REVISED - J.A.F. 12-06
		CHECKED -	REVISED - S.P.B. 01-07
PLOT SCALE = 1/8" = 1'-0"		DATE - 11-96	REVISED - S.P.B. 12-09
PLOT DATE = 4/15/2018			

STATE OF ILLINOIS
DEPARTMENT OF TRANSPORTATION

TRAFFIC CONTROL DETAILS FOR FREEWAY			
SHOULDER CLOSURES AND PARTIAL RAMP CLOSURES			
SCALE: NONE	SHEET NO. 1 OF 1 SHEETS	STA.	TO STA.

F.A. RTE.	SECTION	COUNTY	TOTAL SHEETS	SHEET NO.
VARIOUS	2009-075 I	VARIOUS	21	20
TC-17			CONTRACT NO. 60H88	
FED. ROAD DIST. NO. 1 ILLINOIS FED. AID PROJECT				

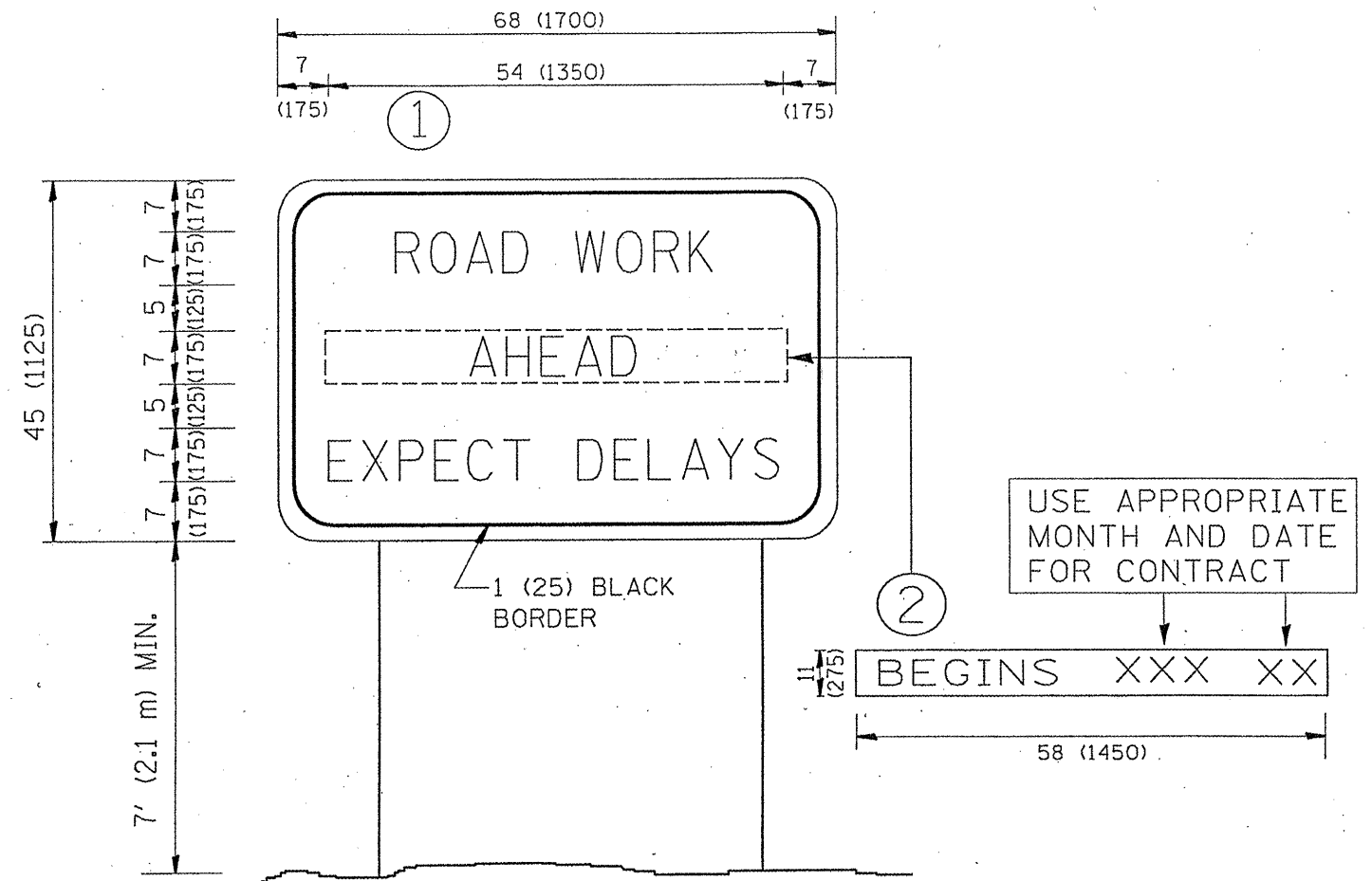

NOTES:

1. USE BLACK LETTERING ON ORANGE BACKGROUND.
2. ERECT SIGNS IN ADVANCE OF THE LOCATION FOR THE "ROAD CONSTRUCTION AHEAD" SIGN AT LOCATIONS AS DIRECTED BY THE ENGINEER.
3. ERECT SIGN ① WITH INSTALLED PANEL ② ONE WEEK PRIOR TO THE START OF CONSTRUCTION.
4. REMOVE PANEL ② SOON AFTER THE START OF CONSTRUCTION.
5. SEE SPECIAL PROVISION FOR "TEMPORARY INFORMATION SIGNING" FOR ADDITIONAL INFORMATION.
6. ONE SIGN ASSEMBLY EQUALS 25.70 SQ. FT. (2.3 SQ. M.)
7. SHALL BE PAID FOR AS TEMPORARY INFORMATION SIGNING.

ALL DIMENSIONS ARE IN INCHES (MILLIMETERS)
UNLESS OTHERWISE SHOWN.

FILE NAME =	USER NAME = hamdanah	DESIGNED -	REVISED - R. MIRS 09-15-97
c:\p\work\PM1DOT\HAMDANAH\d0176891\015	Std.dgn	DRAWN -	REVISED - R. MIRS 12-11-97
	PLOT SCALE = 1/8" = 1' / IN.	CHECKED -	REVISED - T. RAMMACHER 02-02-99
	PLOT DATE = 4/15/2010	DATE -	REVISED - C. JUJUS 01-31-07

**STATE OF ILLINOIS
DEPARTMENT OF TRANSPORTATION**

**ARTERIAL ROAD
INFORMATION SIGN**

SCALE: NONE SHEET NO. 1 OF 1 SHEETS STA. TO STA.

F.A. RTE.	SECTION	COUNTY	TOTAL SHEETS	SHEET NO.
VARIOUS	2009-075 I	VARIOUS	21	21
TC-22			CONTRACT NO. 60H88	
FED. ROAD DIST. NO. 1 [ILLINOIS] FED. AID PROJECT				