

MATCHLINE STA. 1261+50.00

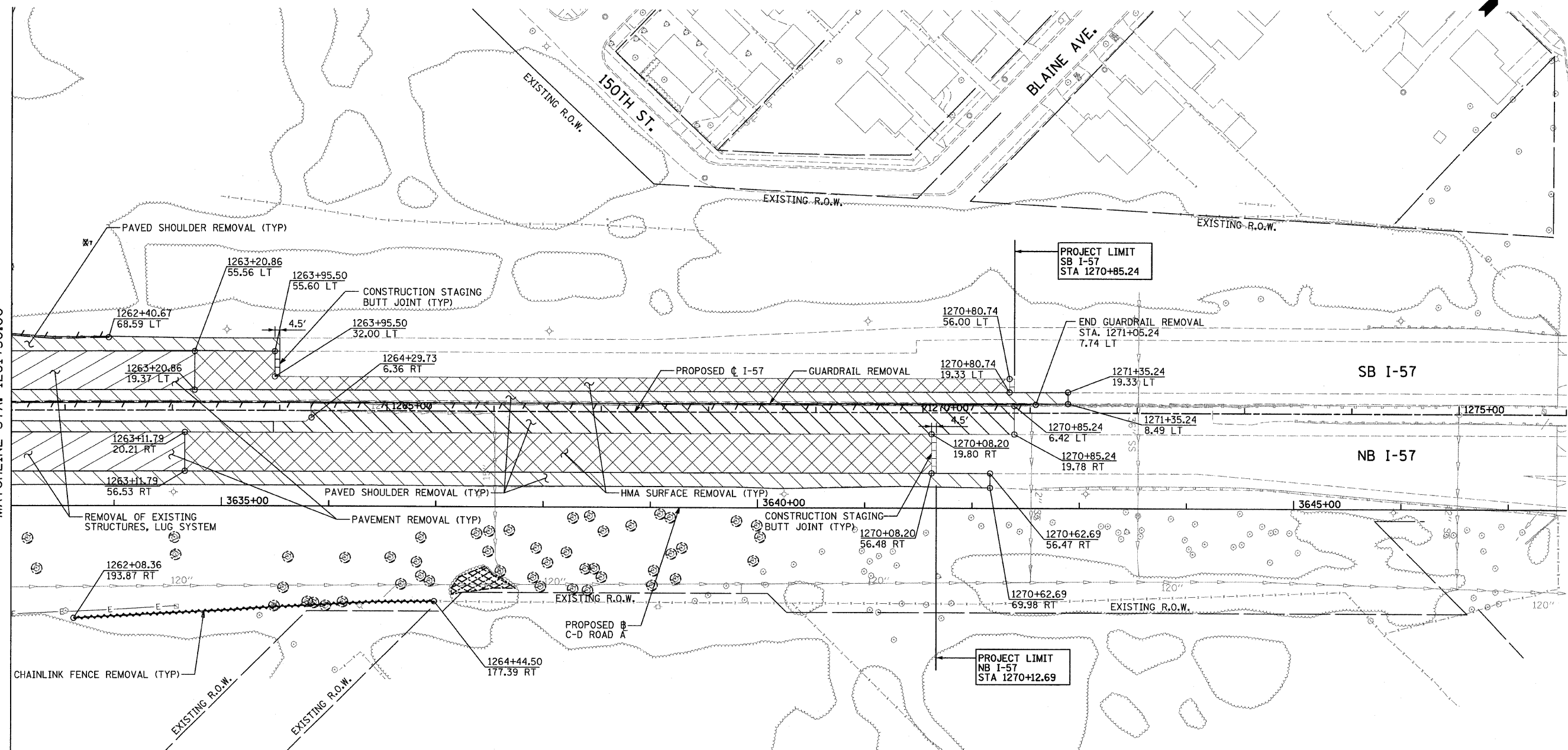

**LEGEND:**

- |  |   |  |  |
|--|---|--|--|
|  | PAVED SHOULDER REMOVAL                          |  | TREE REMOVAL (ACRES)                     |
|  | HOT-MIX ASPHALT SURFACE REMOVAL, 2" (SEE PLANS) |  | GUARDRAIL REMOVAL                        |
|  | PAVEMENT REMOVAL                                |  | CHAIN LINK FENCE REMOVAL                 |
|  | BUTT JOINT                                      |  | COMB CONC CURB & GUTTER REMOVAL          |
|  | TREE REMOVAL (UNITS) (NO UNIT SHOWN = <6)       |  | CONCRETE MEDIAN BARRIER AND BASE REMOVAL |
|  |   |  | LIMITS OF CONSTRUCTION                   |

**NOTE:**

TREES DEPICTED AS ⊗ WERE IDENTIFIED IN AERIAL SURVEY. UNIT DIAMETER WAS NOT IDENTIFIED. THOSE HAVE BEEN QUANTIFIED AS 0.0018 AC PER TREE LOCATION.

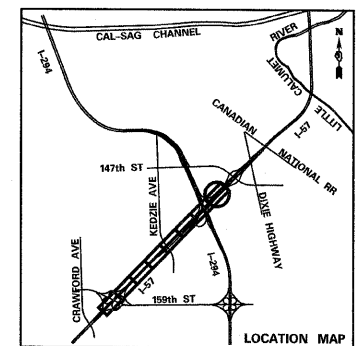

<b>TYLIN INTERNATIONAL</b>	USER NAME =	DESIGNED - CAC	REVISED - 4/29/2010	<b>STATE OF ILLINOIS DEPARTMENT OF TRANSPORTATION</b>	<b>I-57 AT I-294 INTERCHANGE PROJECT REMOVAL PLANS</b>			F.A.I. RTE. =	SECTION =	COUNTY =	TOTAL SHEETS =	SHEET NO. =
	PLOT SCALE =	DRAWN - CAC	REVISED -		57	1414.2B	COOK	516	39			
	PLOT DATE =	CHECKED - JDF	REVISED -		SCALE: 1"=50'    SHEET NO. 8 OF 8 SHEETS    STA. 1261+50 TO STA. 1276+00			CONTRACT NO. 60J27				
		DATE - 3/18/2010	REVISED -		FED. ROAD DIST. NO.    ILLINOIS FED. AID PROJECT							