

PLAN	SURVEYED	BY	DATE
NOTE BOOK	PLOTTED		
NO.	BY		
	DATE		

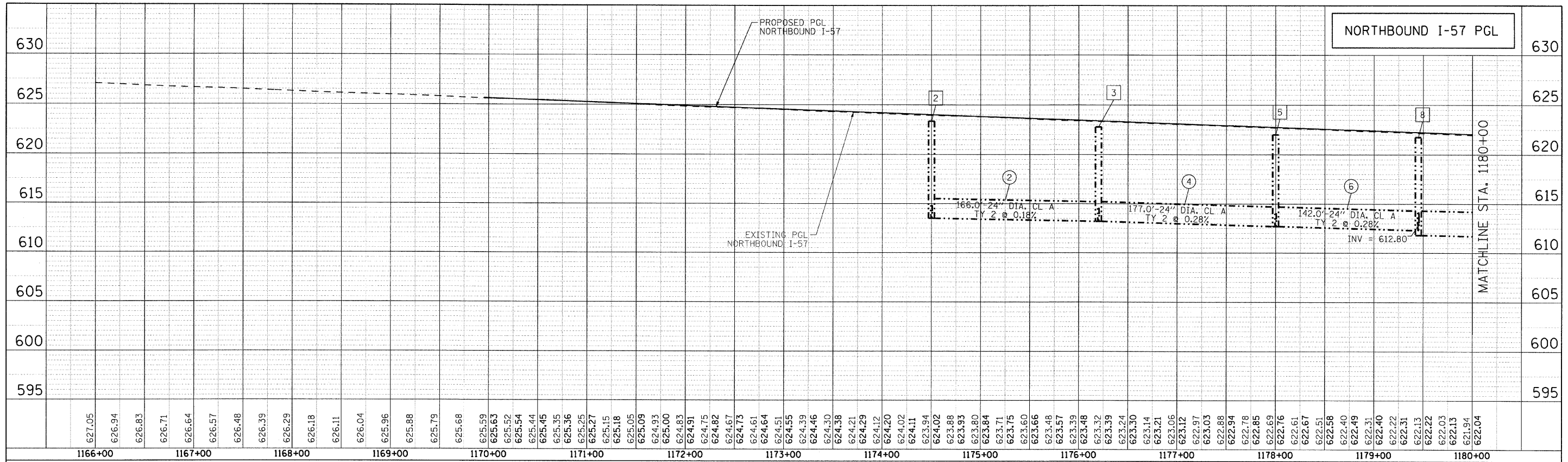

--- PROPOSED STORM SEWER (MEDIAN)
 --- PROPOSED STORM SEWER RIGHT SIDE

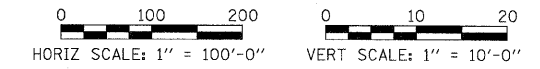

PROFILE	SURVEYED	BY	DATE
NOTE BOOK	PLOTTED		
NO.	BY		
	DATE		

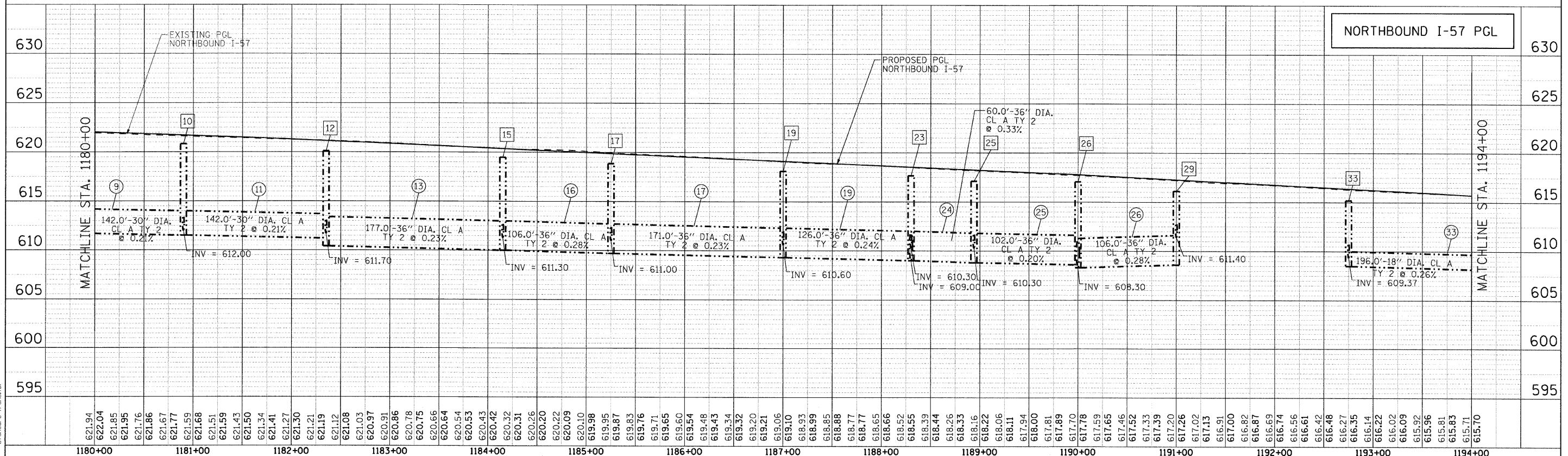

SEC GROUP, INC.
 COMPANY NAME
 CLIENT CONTACT: ILLINOIS DEPARTMENT OF TRANSPORTATION
 DATE PLOTTED: 4/23/2010 10:00:22 AM
 FILE NAME: P1_57NB.prfch01.dgn
 PLOT DRIVER: pdfcut
 PEN TABLE: standard-trans.tbl

		USER NAME = JAttanase FILE NAME = P1_57NB.prfch01.dgn PLOT SCALE = 1:50 PLOT DATE = 4/23/2010	DESIGNED - A. JAIN DRAWN - J. ATTANASE CHECKED - T. HAMILTON DATE - 4/23/10	REVISED - 4/29/2010 REVISED - REVISED - REVISED -	STATE OF ILLINOIS DEPARTMENT OF TRANSPORTATION		I-294 AT I-57 INTERCHANGE PROJECT PROPOSED DRAINAGE PROFILE - NB I-57		F.A.I. RTE. 57 SECTION 1414.2B COUNTY COOK TOTAL SHEETS 516 SHEET NO. 146	CONTRACT NO. 60J27 FED. ROAD DIST. NO. ILLINOIS FED. AID PROJECT
--	--	--	--	--	---	--	--	--	---	--

SCALE: 1"=50' SHEET NO. 1 OF 4 SHEETS STA. 1182+29.80 TO STA. 1194+00.00