

STATE OF ILLINOIS  
DEPARTMENT OF TRANSPORTATION

Notes:  
See sheet 33 of 62 for Sections C-C & D-D and Views E-E and F-F.  
 $a_{95}(E)$  and  $a_{96}(E)$  bar spacings measured along  $\text{C.Rdwy.}$   
Bars indicated thus 20x3-#5 etc. indicates 20 lines of bars with three lengths per line.

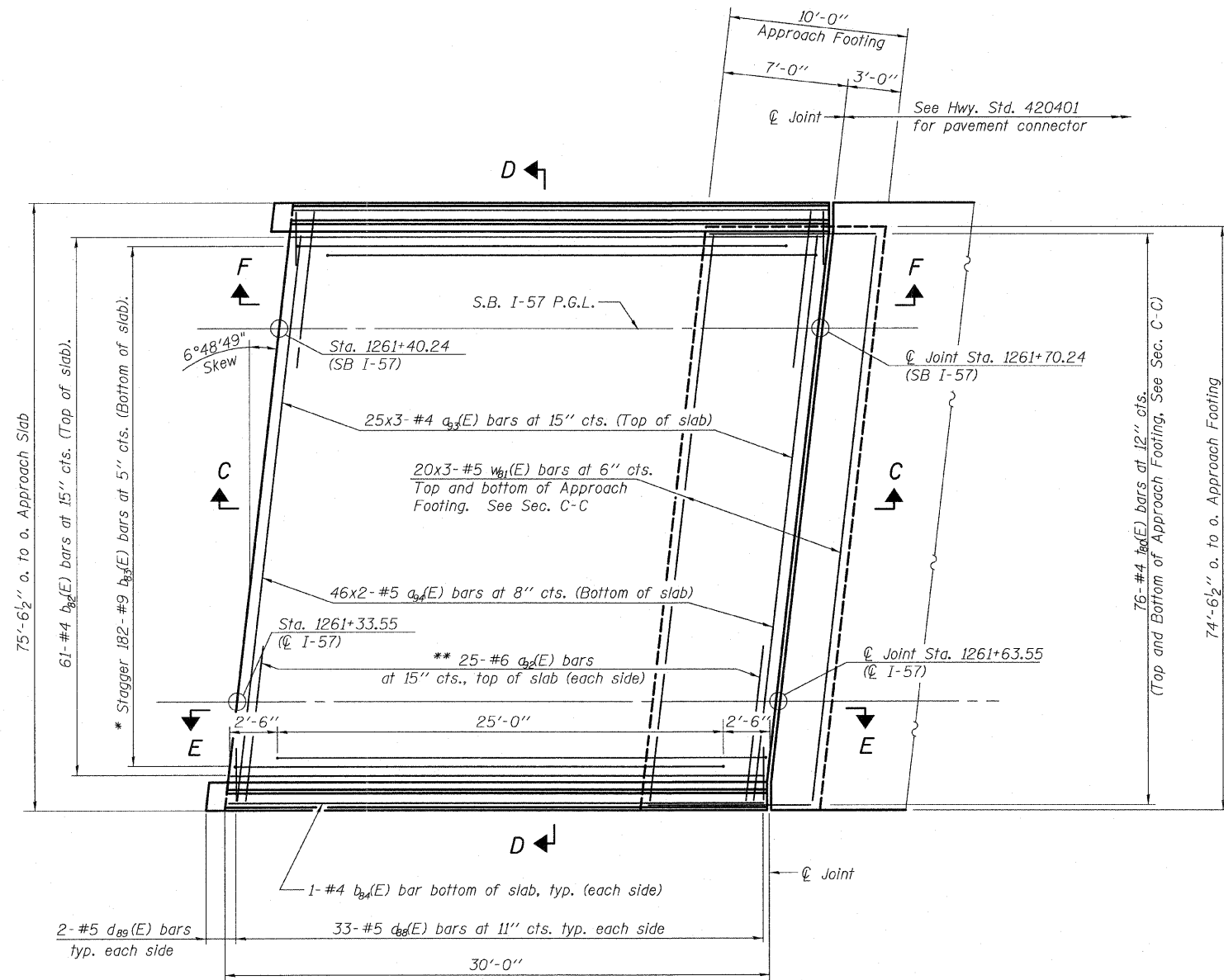

**PLAN**

\* Tilt #9  $b_{93}(E)$  bars as required to maintain clearance.  
\*\* Space between  $a_{93}(E)$  bars, typ. each parapet.

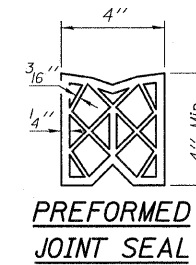

\*\*\* Cost included with Concrete Superstructure.

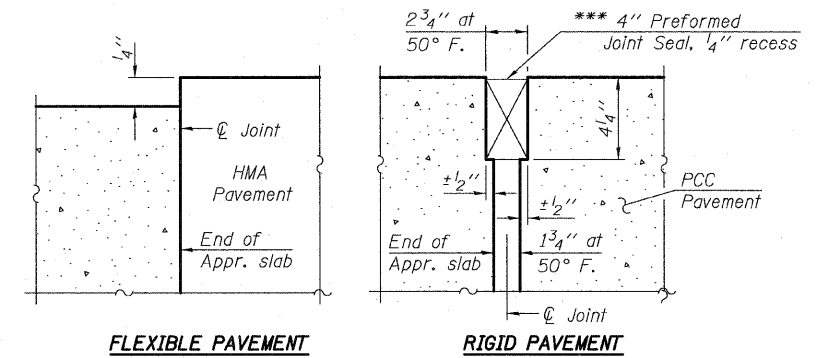

**Minimum Bar Laps**

#4 Bar 2'-11"  
#5 Bar 3'-3"

**EAST APPROACH SLAB SB I-57 - 1**  
**STRUCTURE NO. 016-1252**

**TYLIN INTERNATIONAL**

DESIGNED -	MRB	REVISIONS	
CHECKED -	AMD	NAME	DATE
DRAWN -	MRB		
CHECKED -	LS,SP,PDF		
DATE -	03/18/10		

SHEET NO. 32	F.A.I. RTE.	SECTION	COUNTY	TOTAL SHEETS	SHEET NO.
	57	1414.2B	COOK	516	345
62 SHEETS	CONTRACT NO. 60J27				
FED. ROAD DIST. NO. 1   ILLINOIS   FED. AID PROJECT					

P:\602540\57-294\STRUCTURAL\I-57 OVER RAMP.BX.F.incl. submittal.03-17-2010\F.incl. submittal.03172010\0161252-60J27-032-E-APPR5.dgn 9:54:24 AM