

DETAIL "A"

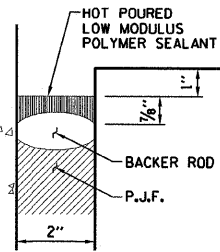

DETAIL "AA"

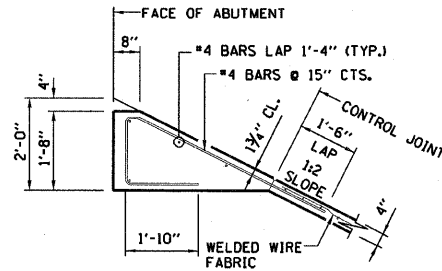

DETAIL "B"

NOTE:

SEALANT, BACKER ROD AND PJ.F. SHALL MEET THE REQUIREMENTS OF SECTIONS 1050 AND 1051 OF THE IDOT STANDARD SPECIFICATIONS.

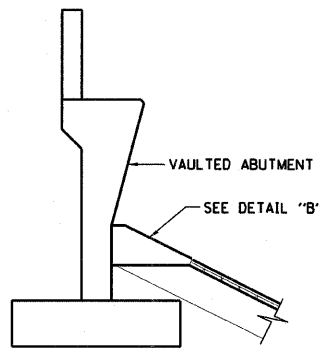

AT VAULTED ABUTMENT

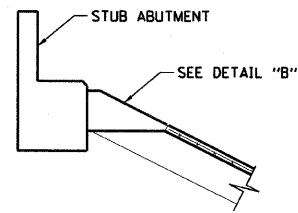

AT STUB ABUTMENT

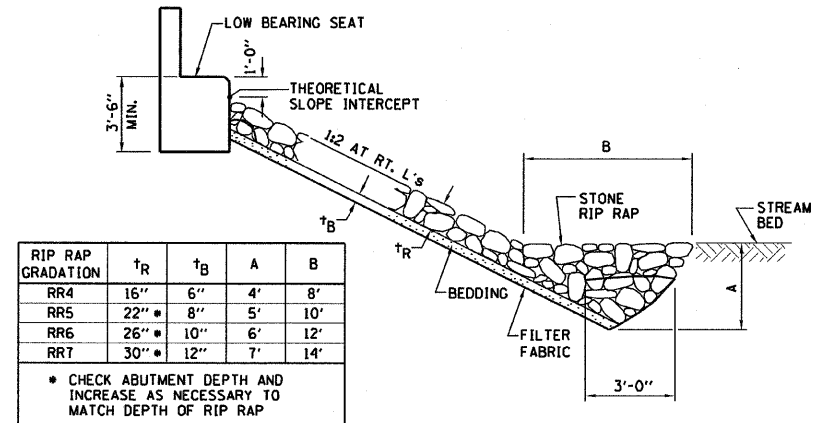

RIP RAP GRADATION	t <sub>R</sub>	t <sub>B</sub>	A	B
RR4	16"	6"	4'	8'
RR5	22"	8"	5'	10'
RR6	26"	10"	6'	12'
RR7	30"	12"	7'	14'

\* CHECK ABUTMENT DEPTH AND INCREASE AS NECESSARY TO MATCH DEPTH OF RIP RAP

STONE RIPRAP FOR TOLLWAY BRIDGES OVER WATERWAYS

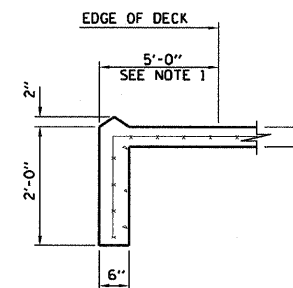

SECTION A-A

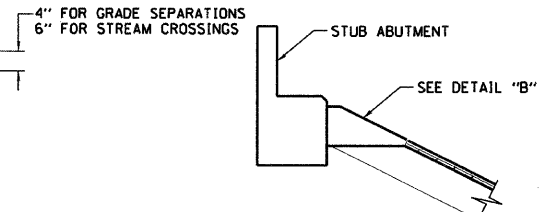

AT STUB ABUTMENT

NOTE:

SEE ROADWAY PLANS FOR DIMENSION "X" MEASURED NORMAL TO E.P.

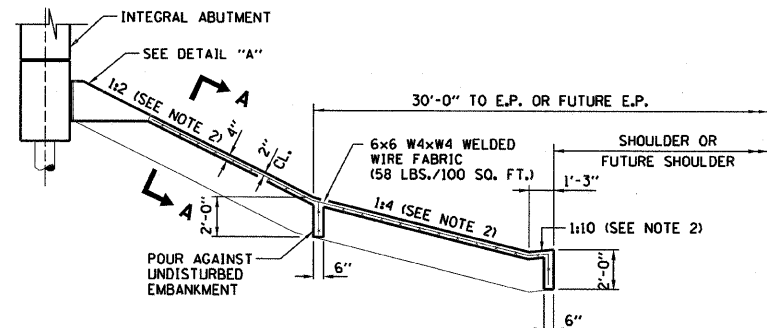

AT INTEGRAL ABUTMENT

SLOPE WALLS FOR BRIDGES OVER TOLLWAY

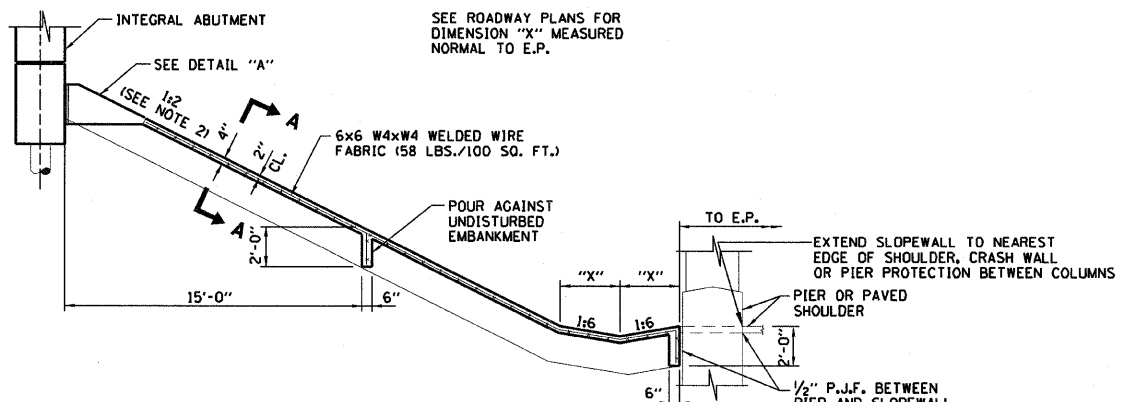

AT INTEGRAL ABUTMENT

TOLLWAY BRIDGES OVER CROSSROADS

NOTES:

- DIMENSIONS SHALL BE 2'-0" IF DECK DRAINS ARE NOT PROVIDED.
- DIMENSIONS MARKED THUS ARE MEASURED NORMAL TO E.P.
- ALL SLOPES ARE EXPRESSED AS UNITS OF VERTICAL DISPLACEMENT TO UNITS OF HORIZONTAL DISPLACEMENT (V:H).

APPROVED *Paul Kovacs* CHIEF ENGINEER DATE 6-1-2009

**Illinois Tollway**  
Open Roads for a Faster Future

DATE	REVISIONS
6-1-2009	REVISED NOTES

SLOPEWALL DETAILS

STANDARD G2-01