

DATE	
BY	
SURVEYED	
PLOTTED	
NOTE BOOK	
AREAS CHECKED	
NO.	

DATE	
BY	
SURVEYED	
PLOTTED	
NOTE BOOK	
AREAS CHECKED	
NO.	

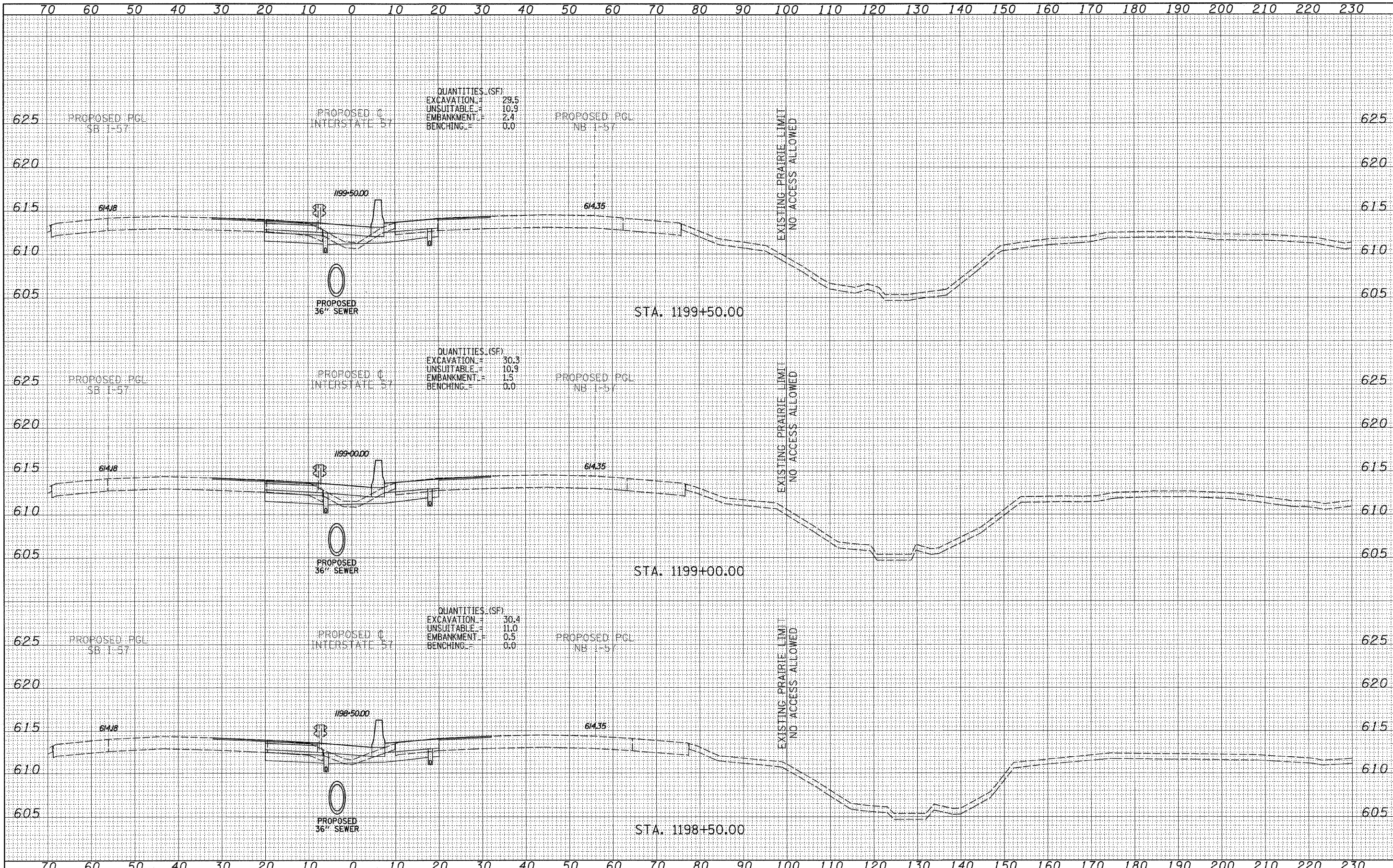

QUANTITIES (SF)
 EXCAVATION = 29.5
 UNSUITABLE = 10.9
 EMBANKMENT = 2.4
 BENCHING = 0.0

QUANTITIES (SF)
 EXCAVATION = 30.3
 UNSUITABLE = 10.9
 EMBANKMENT = 1.5
 BENCHING = 0.0

QUANTITIES (SF)
 EXCAVATION = 30.4
 UNSUITABLE = 11.0
 EMBANKMENT = 0.5
 BENCHING = 0.0

TYLIN INTERNATIONAL

USER NAME =	DESIGNED - JDF	REVISED -
PLLOT SCALE =	DRAWN - JDF	REVISED -
PLLOT DATE =	CHECKED - JPM	REVISED -
	DATE - 3/18/2010	REVISED -

STATE OF ILLINOIS
 DEPARTMENT OF TRANSPORTATION

I-57 AT I-294 INTERCHANGE PROJECT
 PROPOSED I-57 CROSS SECTIONS
 SCALE: 1" = 10' H
 SHEET NO. OF SHEETS STA. 1198+50.00 TO STA. 1199+50.00

F.A.I. RTE.	SECTION	COUNTY	TOTAL SHEETS	SHEET NO.
57	1414.2B	COOK	516	439
CONTRACT NO. 60J27				
FED. ROAD DIST. NO. ILLINOIS FED. AID PROJECT				