

FINAL SURVEY	SURVEYED	BY	DATE
NOTE BOOK	PLOTTED		
NO.	TEMPLATE		
	AREAS CHECKED		

ORIGINAL SURVEY	SURVEYED	BY	DATE
NOTE BOOK	PLOTTED		
NO.	TEMPLATE		
	AREAS CHECKED		

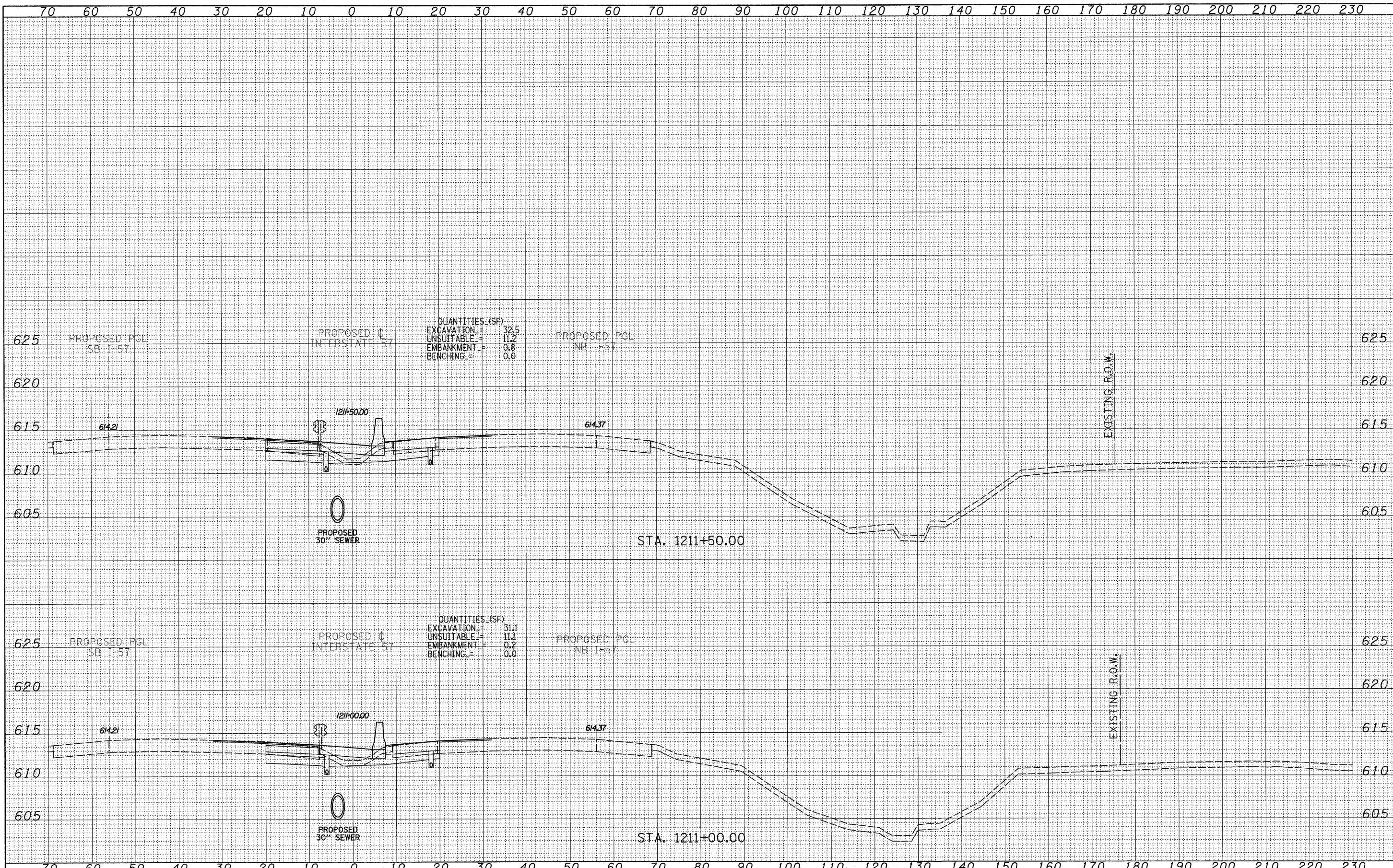

QUANTITIES (SF)

EXCAVATION	=	32.5
UNSUITABLE	=	11.2
EMBANKMENT	=	0.8
BENCHING	=	0.0

QUANTITIES (SF)

EXCAVATION	=	31.1
UNSUITABLE	=	11.1
EMBANKMENT	=	0.2
BENCHING	=	0.0

TYLIN INTERNATIONAL

USER NAME =	DESIGNED - JDF	REVISED -
PLLOT SCALE =	DRAWN - JDF	REVISED -
PLLOT DATE =	CHECKED - JPM	REVISED -
	DATE - 3/18/2010	REVISED -

STATE OF ILLINOIS  
DEPARTMENT OF TRANSPORTATION

I-57 AT I-294 INTERCHANGE PROJECT  
PROPOSED I-57 CROSS SECTIONS

SCALE: 1" = 10' V, 1" = 10' H

SHEET NO.	OF	SHEETS	STA. 1211+00.00	TO	STA. 1211+50.00
-----------	----	--------	-----------------	----	-----------------

F.A.I. RTE.	SECTION	COUNTY	TOTAL SHEETS	SHEET NO.
57	1414.2B	COOK	516	448
FED. ROAD DIST. NO.	ILLINOIS FED. AID PROJECT	CONTRACT NO.	60J27	