

FINAL SURVEY SURVEYED PLOTTED NOTE BOOK NO. DATE

ORIGINAL SURVEY SURVEYED PLOTTED NOTE BOOK NO. DATE

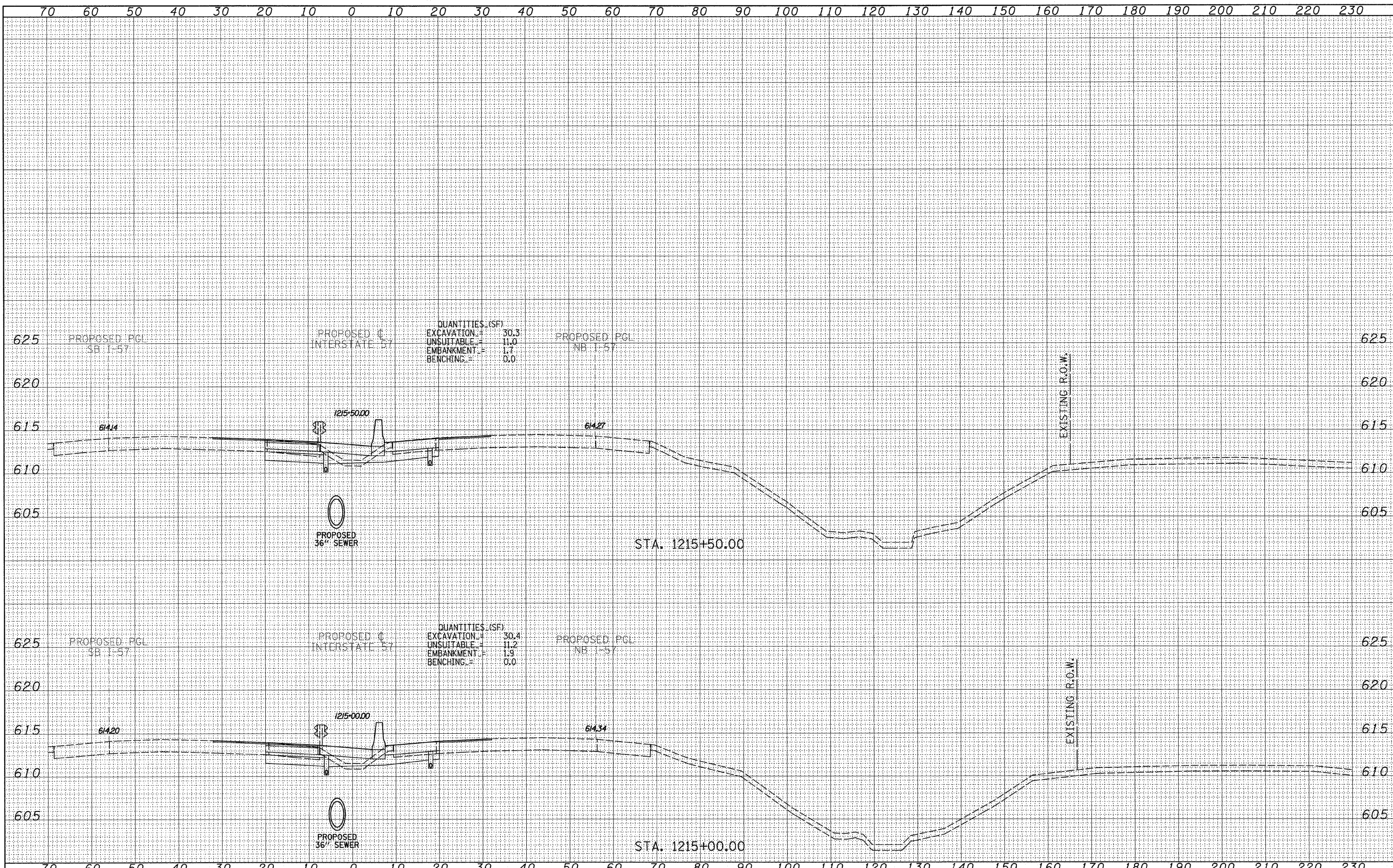

TYLIN INTERNATIONAL

USER NAME =
 PLOT SCALE =
 PLOT DATE =

DESIGNED - JDF
 DRAWN - JDF
 CHECKED - JPM
 DATE - 3/18/2010

REVISED -
 REVISED -
 REVISED -
 REVISED -

STATE OF ILLINOIS
 DEPARTMENT OF TRANSPORTATION

I-57 AT I-294 INTERCHANGE PROJECT
 PROPOSED I-57 CROSS SECTIONS
 SCALE: 1" = 10' V, 1" = 100' H
 SHEET NO. OF SHEETS STA. 1215+00.00 TO STA. 1215+50.00

F.A.I. RTE.	SECTION	COUNTY	TOTAL SHEETS	SHEET NO.
57	1414.2B	COOK	516	452
FED. ROAD DIST. NO.			ILLINOIS FED. AID PROJECT	
			CONTRACT NO. 60J27	