

FINAL SURVEY	SURVEYED	BY	DATE
NOTE BOOK NO.	PLOTTED		
AREAS CHECKED	TEMP. DATE		
	NO.		

ORIGINAL SURVEY	SURVEYED	BY	DATE
NOTE BOOK NO.	PLOTTED		
AREAS CHECKED	TEMP. DATE		
	NO.		

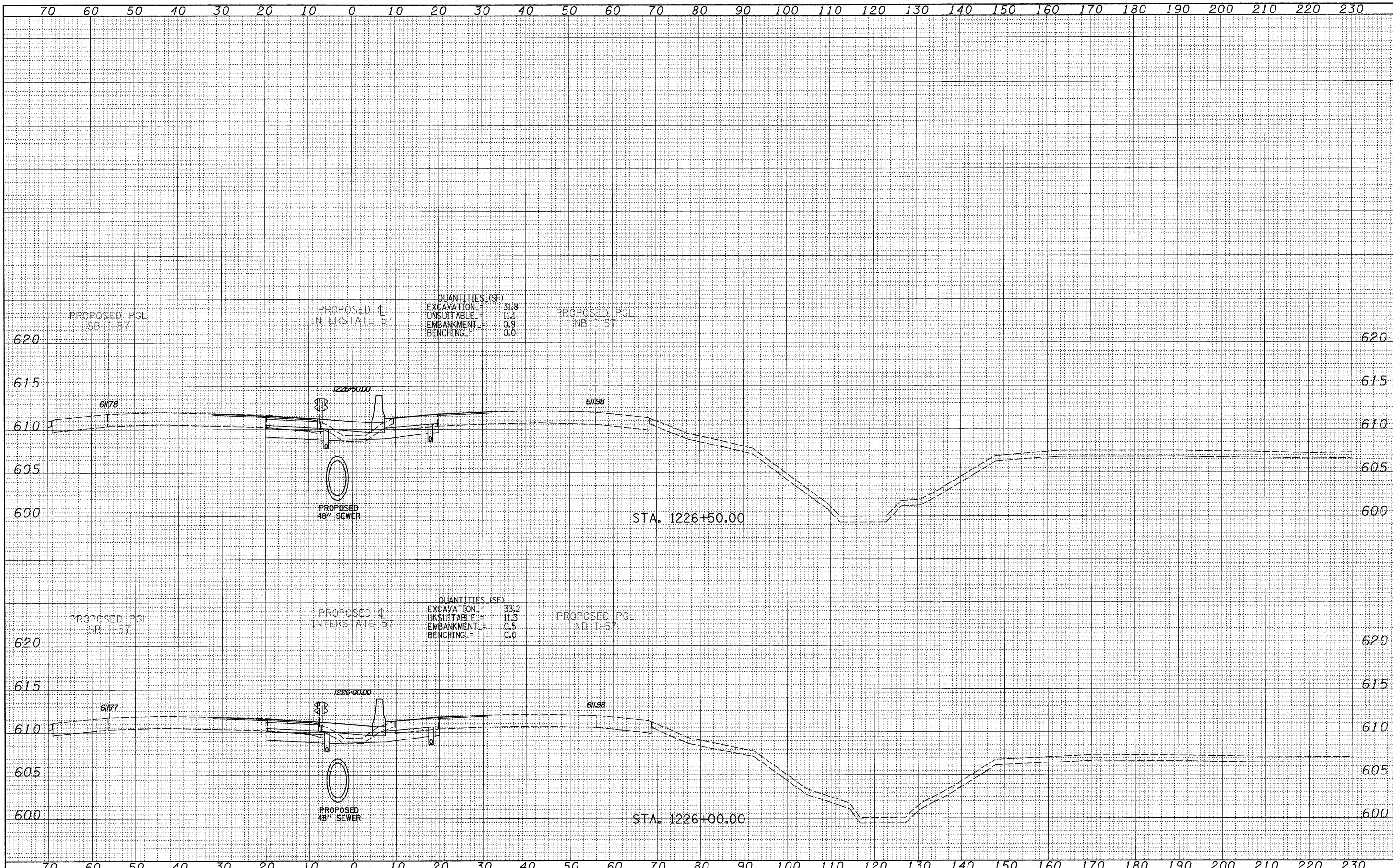

QUANTITIES (SF)
 EXCAVATION = 31.8
 UNSUITABLE = 11.1
 EMBANKMENT = 0.9
 BENCHING = 0.0

QUANTITIES (SF)
 EXCAVATION = 33.2
 UNSUITABLE = 11.3
 EMBANKMENT = 0.5
 BENCHING = 0.0

TYLIN INTERNATIONAL

USER NAME =	DESIGNED - JDF	REVISED -
PLLOT SCALE =	DRAWN - JDF	REVISED -
PLLOT DATE =	CHECKED - JPM	REVISED -
	DATE - 3/18/2010	REVISED -

**STATE OF ILLINOIS
 DEPARTMENT OF TRANSPORTATION**

**I-57 AT I-294 INTERCHANGE PROJECT
 PROPOSED I-57 CROSS SECTIONS**
 SCALE: 1" = 10' H
 SHEET NO. OF SHEETS STA. 1226+00.00 TO STA. 1226+50.00

F.A.I. RTE.	SECTION	COUNTY	TOTAL SHEETS	SHEET NO.
57	1414.2B	COOK	516	462
FED. ROAD DIST. NO. ILLINOIS FED. AID PROJECT			CONTRACT NO. 60J27	