

FINAL SURVEY	SURVEYED	DATE
NOTE BOOK	PLOTTED	BY
NO.	TEMPLATE	
	AREAS CHECKED	

ORIGINAL SURVEY	SURVEYED	DATE
NOTE BOOK	PLOTTED	BY
NO.	TEMPLATE	
	AREAS CHECKED	

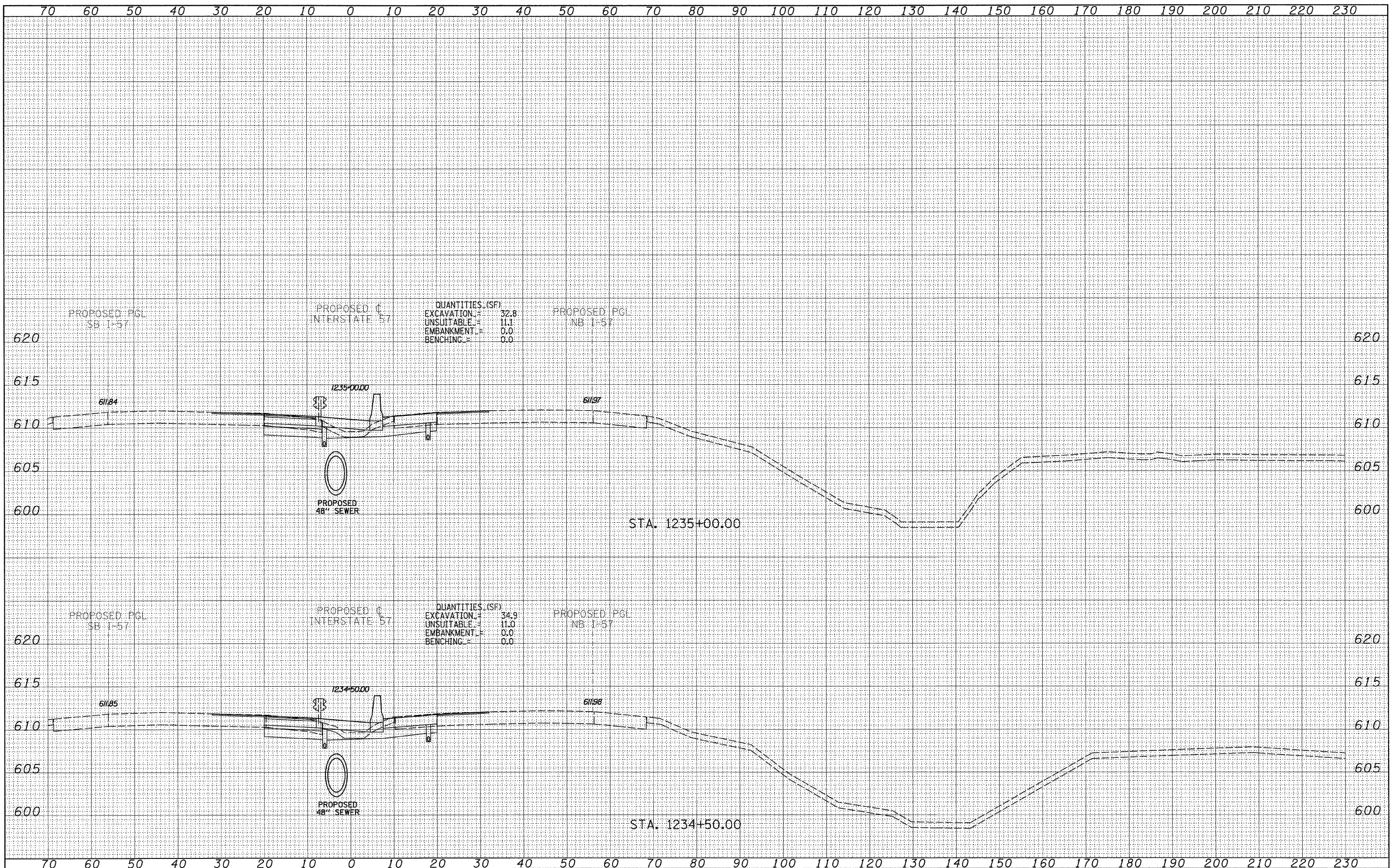

QUANTITIES (SF)

EXCAVATION	=	32.8
UNSUITABLE	=	11.1
EMBANKMENT	=	0.0
BENCHING	=	0.0

QUANTITIES (SF)

EXCAVATION	=	34.9
UNSUITABLE	=	11.0
EMBANKMENT	=	0.0
BENCHING	=	0.0

**TYLIN INTERNATIONAL**

USER NAME =	DESIGNED - JDF	REVISED -
PLLOT SCALE =	DRAWN - JDF	REVISED -
PLLOT DATE =	CHECKED - JPM	REVISED -
	DATE - 3/18/2010	REVISED -

**STATE OF ILLINOIS  
DEPARTMENT OF TRANSPORTATION**

<b>I-57 AT I-294 INTERCHANGE PROJECT PROPOSED I-57 CROSS SECTIONS</b>			
SCALE: 1" = 10' V, 1" = 100' H	SHEET NO.	OF SHEETS	STA. 1234+50.00 TO STA. 1235+00.00

F.A.I. RTE. 57	SECTION 1414.2B	COUNTY COOK	TOTAL SHEETS 516	SHEET NO. 471
FED. ROAD DIST. NO. ILLINOIS FED. AID PROJECT			CONTRACT NO. 60J27	