

FINAL SURVEY	BY	DATE
SURVEYED		
PLotted		
NOTE BOOK		
AREAS CHECKED		
NO.		

ORIGINAL SURVEY	BY	DATE
SURVEYED		
PLotted		
NOTE BOOK		
AREAS CHECKED		
NO.		

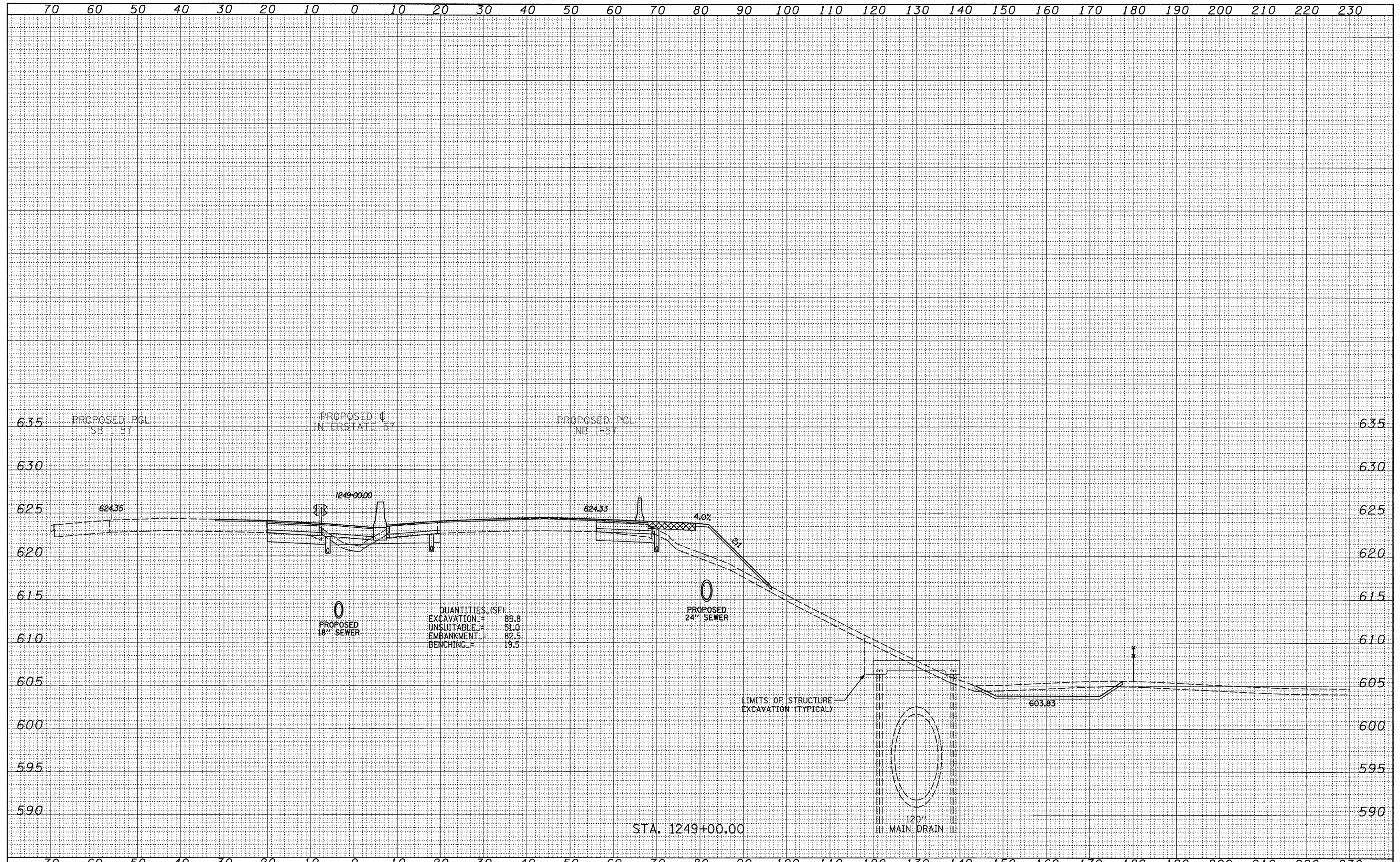

QUANTITIES (SF)  
 EXCAVATION = 89.8  
 UNSUITABLE = 51.0  
 EMBANKMENT = 82.5  
 BENCHING = 19.5

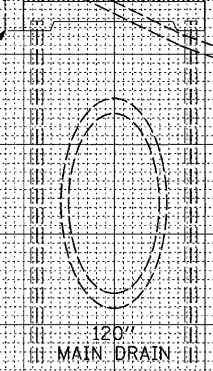

**TYLIN INTERNATIONAL**

USER NAME =	DESIGNED - JDF	REVISED - 4/29/2010
PLotted SCALE =	DRAWN - JDF	REVISED -
PLotted DATE =	CHECKED - JPM	REVISED -
	DATE - 3/18/2010	REVISED -

**STATE OF ILLINOIS  
 DEPARTMENT OF TRANSPORTATION**

**I-57 AT I-294 INTERCHANGE PROJECT  
 PROPOSED I-57 CROSS SECTIONS**  
 SCALE: 1" = 10' H  
 SHEET NO. OF SHEETS STA. 1249+00.00 TO STA. 1249+00.00

F.A.I. RTE.	SECTION	COUNTY	TOTAL SHEETS	SHEET NO.
57	1414.2B	COOK	516	489
FED. ROAD DIST. NO. ILLINOIS FED. AID PROJECT			CONTRACT NO. 60J27	

P:\602540(57-294)\Road\PI.157 BR\PI.57XS\_SHT\_R.dgn