

DATE	
BY	
FINAL SURVEY	
NO. OF SHEETS	
NOTE BOOK	
AREAS CHECKED	
NO.	

DATE	
BY	
ORIGINAL SURVEY	
NO. OF SHEETS	
NOTE BOOK	
AREAS CHECKED	
NO.	

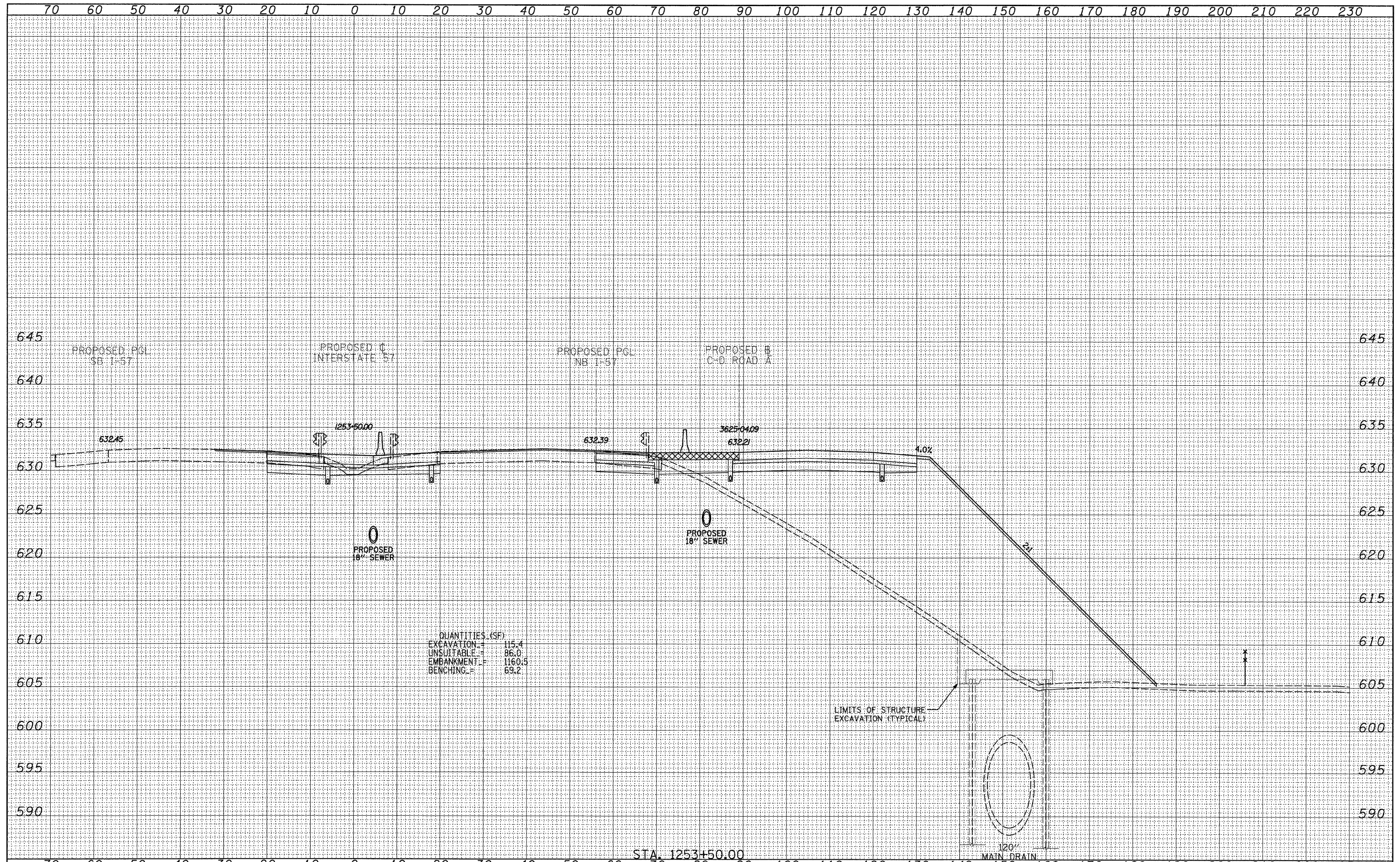

<b>TYLIN INTERNATIONAL</b> USER NAME = PLOT SCALE = PLOT DATE =	DESIGNED - JDF	REVISED - 4/29/2010	<b>STATE OF ILLINOIS</b> <b>DEPARTMENT OF TRANSPORTATION</b>	<b>I-57 AT I-294 INTERCHANGE PROJECT</b> <b>PROPOSED I-57 CROSS SECTIONS</b>		F.A.I. RTE. 57	SECTION 1414.2B	COUNTY COOK	TOTAL SHEETS 516	SHEET NO. 498
	DRAWN - JDF	REVISED -		SCALE: 1" = 50' V	SHEET NO. OF SHEETS	STA. 1253+50.00 TO STA. 1253+50.00	FED. ROAD DIST. NO.	ILLINOIS FED. AID PROJECT	CONTRACT NO. 60J27	
	CHECKED - JPM	REVISED -								
	DATE - 3/18/2010	REVISED -								