

ROUTE	SECTION	COUNTY	TOTAL SHEETS	SHEET NUMBER
VARIOUS	2010-021PP	LAKE	* 25	* 1

**STATE OF ILLINOIS**  
**DEPARTMENT OF TRANSPORTATION**  
**DIVISION OF HIGHWAYS**  
**DISTRICT ONE**  
**PROPOSED HIGHWAY PLANS**

**CONTRACT NO. 60K40**

D-91-479-10

FOR INDEX OF SHEETS SEE SHEET 2

VARIOUS ROUTES  
 SECTION: 2010-021PP  
 VARIOUS LOCATIONS IN LAKE COUNTY  
 PCC PAVEMENT PATCHING

C-91-479-10

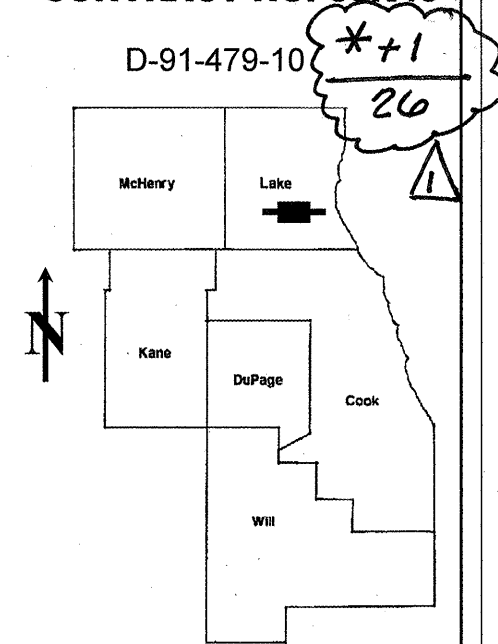

LOCATION OF IMPROVEMENT INDICATED THUS:

DISTRICT ONE - DESIGN - PLAN PREPARATION ENGINEER:  
 KEN ENG / (847) 705-4247

**CONTRACT NO. 60K40**

<b>STATE OF ILLINOIS</b> <b>DEPARTMENT OF TRANSPORTATION</b> <b>DIVISION OF HIGHWAYS</b>
SUBMITTED: <u>March 22 2010</u>  DEPUTY DIRECTOR OF HIGHWAYS, REGION ENGINEER
<u>May 7 2010</u> <u>Scott E. Stitt, P.E.</u> acting ENGINEER OF DESIGN AND ENVIRONMENT
<u>May 7 2010</u> <u>Christine M. Reed/er</u> DIRECTOR, DIVISION OF HIGHWAYS

**PRINTED BY THE AUTHORITY**  
**OF THE STATE OF ILLINOIS**

**J.U.L.I.E.: JOINT UTILITY LOCATION**  
**INFORMATION FOR EXCAVATION**  
 (312) 744-7000

Rev. 5-25-10