

WESTBOUND PETERSON RD. TEMPORARY DETOUR

DETOUR LEGEND

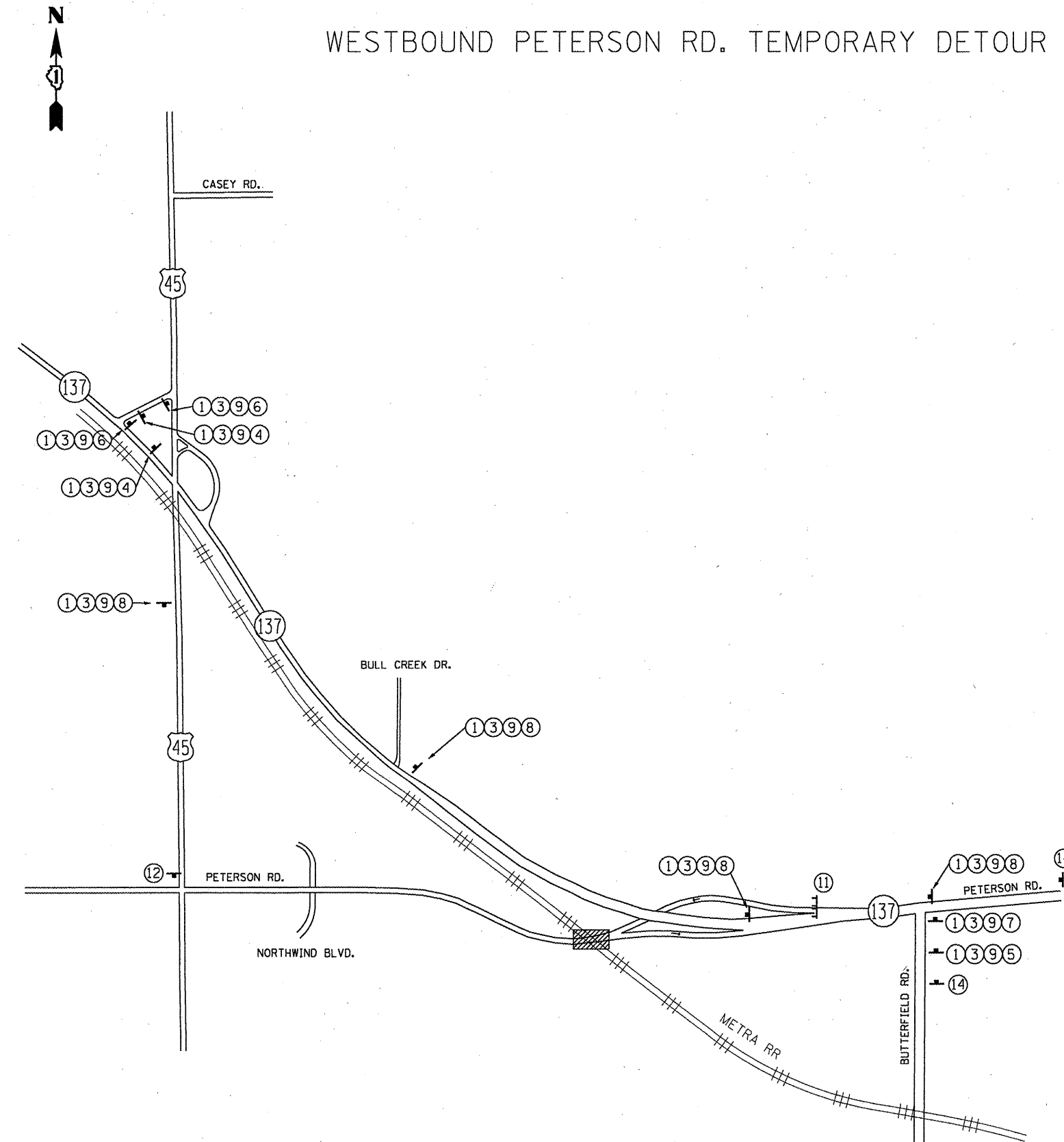

- | | | | | | |
|---|-----------------------------------|--|---|--------------------------|-------------|
| ① | DETOUR | (M1-7-219) | ⑫ | END
DETOUR | M4-8A-3618 |
| ② | EAST | (M3-2-219) | ⑬ | ROAD
CLOSED
AHEAD | C24-14-4848 |
| ③ | WEST | (M3-4-219) | ⑭ | ROAD
CLOSED
AHEAD | C24-13-4848 |
| ④ | ↗ | (M5-1R-2115) | ⑮ | ROAD
CLOSED
500 FT | C24-12-4848 |
| ⑤ | ↖ | (M5-1L-2115) | | | |
| ⑥ | → | (M6-1R-2115) | | | |
| ⑦ | ← | (M6-1L-2115) | | | |
| ⑧ | ↑ | (M6-1L-2115) | | | |
| ⑨ | PETERSON
ROAD | | | | |
| ⑩ | ROAD CLOSED
TO
THRU TRAFFIC | R11-4-6030 (WITH 2 TYPE III BARICADES) | | | |
| ⑪ | ROAD CLOSED | R11-2-4830 (WITH 2 TYPE III BARICADES) | | | |
- WORK AREA (WESTBOUND LANE)

NOTES:

SEE TYPICAL MARKINGS FOR CLOSING STATE HIGHWAYS DETAIL (TC-21) FOR SIGN SPACING.

EXACT SIGN LOCATIONS TO BE APPROVED BY THE ENGINEER.

FILE NAME =	USER NAME = wilgreendp	DESIGNED -	REVISED -	STATE OF ILLINOIS DEPARTMENT OF TRANSPORTATION	TEMPORARY DETOUR PLAN PETERSON RD. RAMP (WESTBOUND)	F.A. RTE.	SECTION	COUNTY	TOTAL SHEETS	SHEET NO.	
ca:\prr_work\PWIDOT\WILGREENDP\d0183633\Design.dgn		DRAWN -	REVISED -			VAR.	2010-021PP	L.K. & MCH.	25	8	
PLOT SCALE = 100.0000' / IN.		CHECKED -	REVISED -			CONTRACT NO. 60K40					
PLOT DATE = 4/12/2010		DATE -	REVISED -			FED. ROAD DIST. NO. 1 ILLINOIS FED. AID PROJECT					
					SCALE:	SHEET NO. OF SHEETS STA.		TO STA.			