

EASTBOUND PETERSON RD. TEMPORARY DETOUR

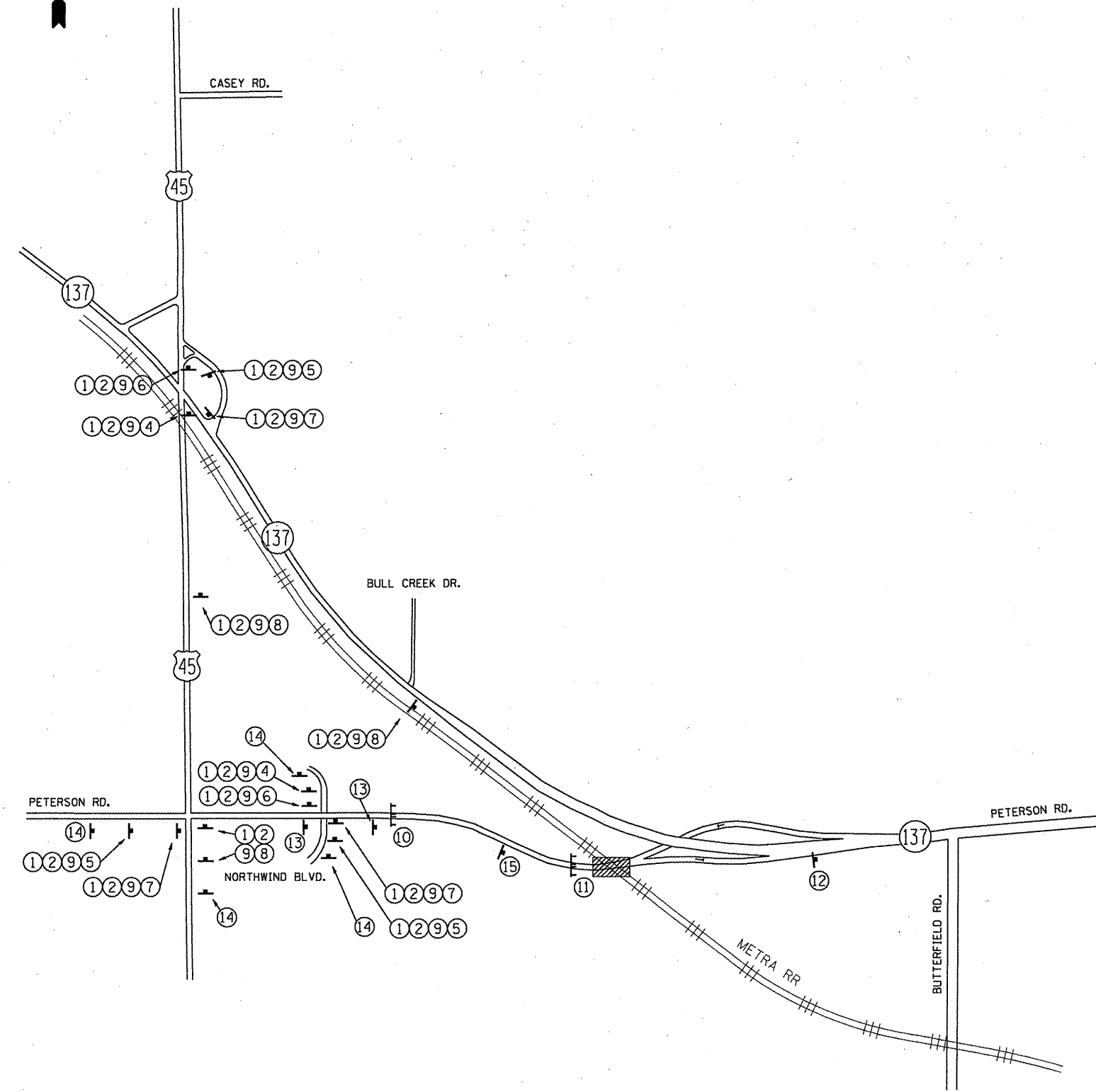

DETOUR LEGEND

- ① [DETOUR] (M1-7-219)
- ② [EAST] (M3-2-219)
- ③ [WEST] (M3-4-219)
- ④ [RIGHT TURN] (M5-1R-2115)
- ⑤ [LEFT TURN] (M5-1L-2115)
- ⑥ [RIGHT ARROW] (M6-1R-2115)
- ⑦ [LEFT ARROW] (M6-1L-2115)
- ⑧ [UP ARROW] (M6-1L-2115)
- ⑨ [PETERSON ROAD]
- ⑩ [ROAD CLOSED TO THRU TRAFFIC] R11-4-6030 (WITH 2 TYPE III BARICADES)
- ⑪ [ROAD CLOSED] R11-2-4830 (WITH 2 TYPE III BARICADES)
- ⑫ [END DETOUR] M4-8A-3618
- ⑬ [ROAD CLOSED AHEAD] C24-14-4848
- ⑭ [DETOUR AHEAD] C24-13-4848
- ⑮ [ROAD CLOSED 500 FT] C24-12-4848
- [Hatched Box] WORK AREA (EASTBOUND LANE)

NOTES:
 SEE TYPICAL MARKINGS FOR CLOSING STATE HIGHWAYS DETAIL (TC-21) FOR SIGN SPACING.
 EXACT SIGN LOCATIONS TO BE APPROVED BY THE ENGINEER.

FILE NAME =	USER NAME = wjgreendp	DESIGNED -	REVISED -	STATE OF ILLINOIS DEPARTMENT OF TRANSPORTATION	TEMPORARY DETOUR PLAN PETERSON RD. RAMP (EASTBOUND)	F.A. RTE.	SECTION	COUNTY	TOTAL SHEETS	SHEET NO.	
ca:\pwwork\pwwidot\wilgreendp\d0183633\d0183633.dgn		DRAWN -	REVISED -			VAR.	2010-021PP	L.K. & MCH.	25	9	
PLOT SCALE = 100.0000' / IN.		CHECKED -	REVISED -			CONTRACT NO. 60K40					
PLOT DATE = 4/12/2010		DATE -	REVISED -			SCALE:	SHEET NO. OF SHEETS	STA. TO STA.	FED. ROAD DIST. NO. 1 ILLINOIS FED. AID PROJECT		