

ROUTE	SECTION	COUNTY	TOTAL SHEETS	SHEET NUMBER
VARIOUS	2010-023 BP	VARIOUS	93	9

CONTRACT NO. 60K48

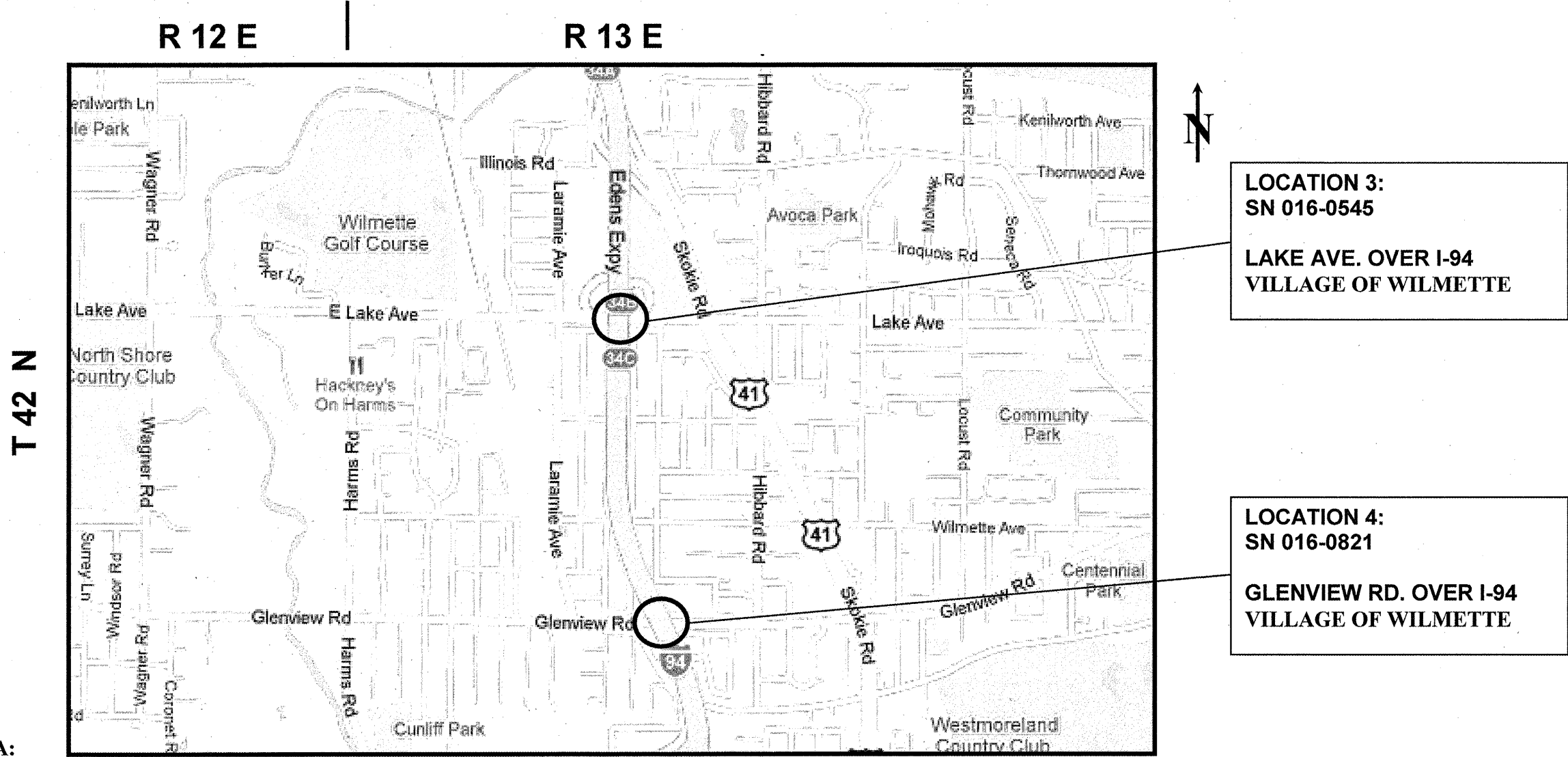

LOCATION 3:
SN 016-0545
LAKE AVE. OVER I-94
VILLAGE OF WILMETTE

LOCATION 4:
SN 016-0821
GLENVIEW RD. OVER I-94
VILLAGE OF WILMETTE

TRAFFIC DATA:

LAKE AVE.:

2006 ADT = 23,300
POSTED SPEED LIMIT = 35 MPH

GLENVIEW RD.:

2006 ADT = 11,100
POSTED SPEED LIMIT = 35 MPH

I-94 (EDEN EXPRESSWAY)

2008 ADT = 149,700
POSTED SPEED LIMIT = 55 MPH

NEW TRIER TOWNSHIP
COOK COUNTY

ILLINOIS DEPARTMENT OF
TRANSPORTATION

LOCATION MAP

LOCATION 3: SN 016-0545
LOCATION 4: SN 016-0821