

ROUTE	SECTION	COUNTY	TOTAL SHEETS	SHEET NUMBER
VARIOUS	2010-023 BP	VARIOUS	93	12

CONTRACT NO. 60K48

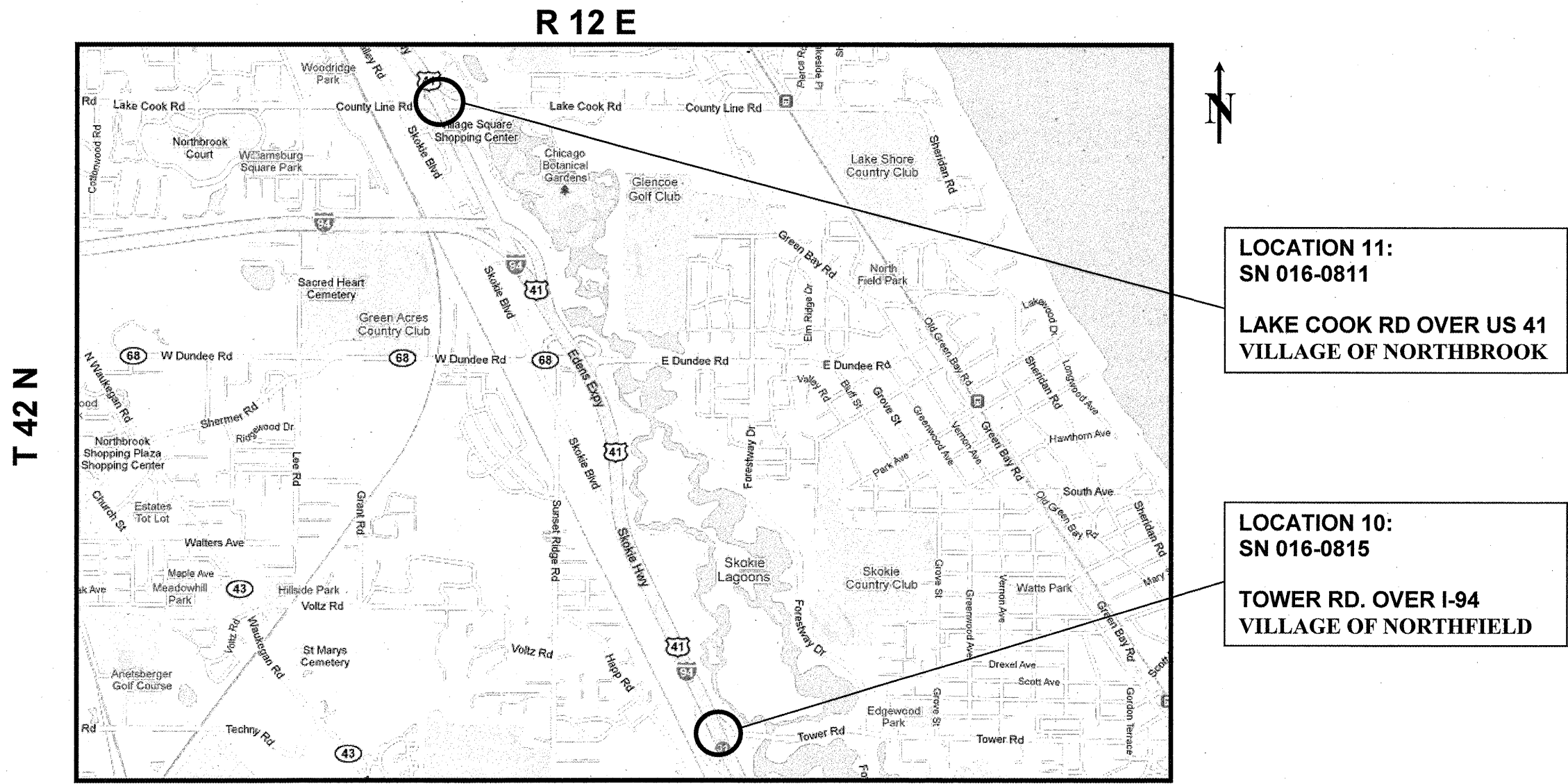

LOCATION 11:
SN 016-0811
LAKE COOK RD OVER US 41
VILLAGE OF NORTHBROOK

LOCATION 10:
SN 016-0815
TOWER RD. OVER I-94
VILLAGE OF NORTHFIELD

NORTHFIELD TOWNSHIP
COOK COUNTY

TRAFFIC DATA:

LAKE COOK RD.:

2006 ADT = 31,300
POSTED SPEED LIMIT = 35 MPH

TOWER RD.:

2006 ADT = 8,600
POSTED SPEED LIMIT = 35 MPH

I-94 (EDEN EXPRESSWAY)

2008 ADT = 147,100
POSTED SPEED LIMIT = 50-55 MPH

ILLINOIS DEPARTMENT OF
TRANSPORTATION

LOCATION MAP

LOCATION 10: SN 016-0815
LOCATION 11: SN 016-0811