

ROUTE	SECTION	COUNTY	TOTAL SHEETS	SHEET NUMBER
VARIOUS	2010-023 BP	VARIOUS	93	15

CONTRACT NO. 60K48

R 12 E

T 42 N

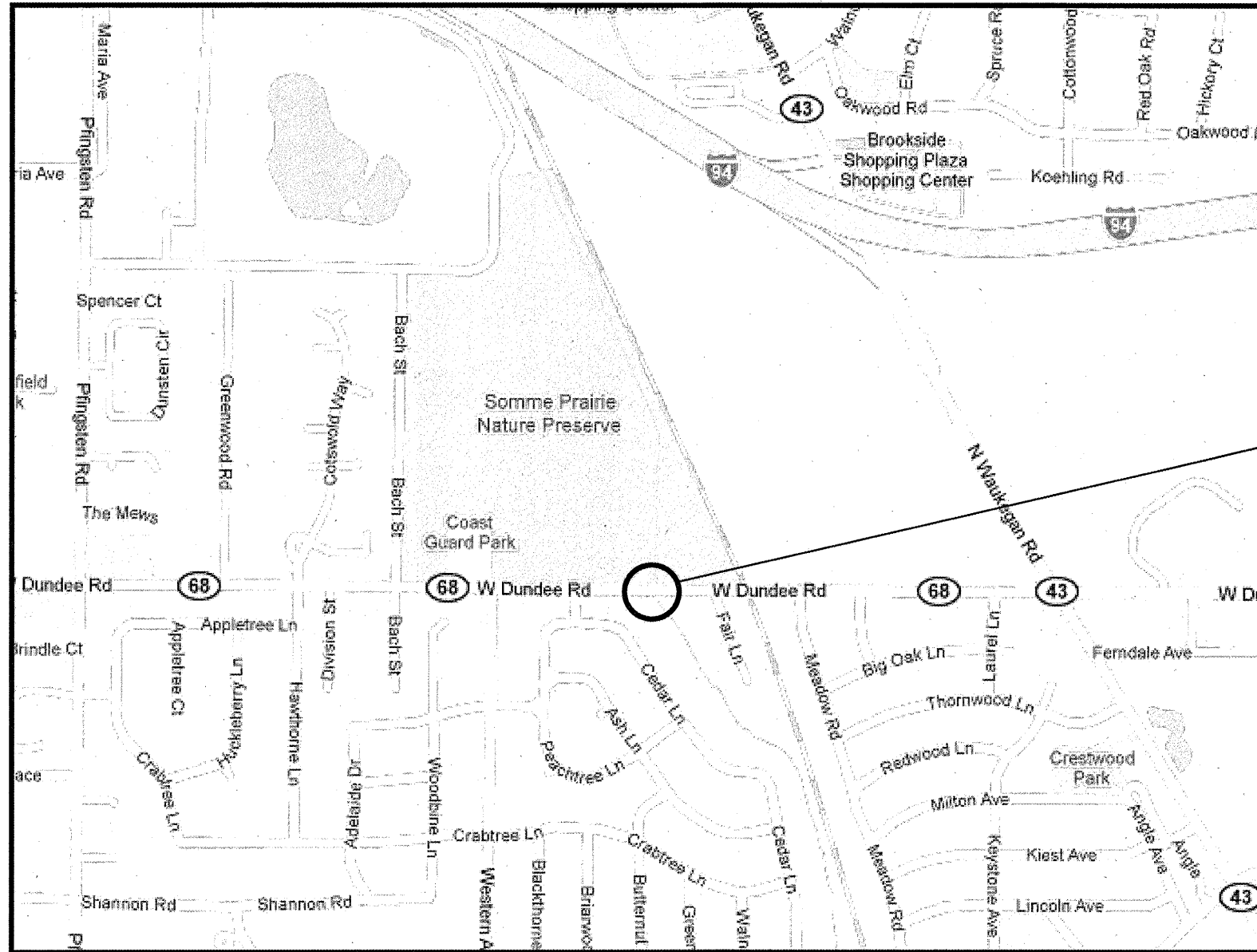

LOCATION 16:
SN 016-0528
IL 68 (DUNDEE RD.) OVER W. FORK N. Br.
CHICAGO RIVER
VILLAGE OF NORTHBROOK

TRAFFIC DATA:

IL 68 (DUNDEE RD.):

2009 ADT = 32,900
 POSTED SPEED LIMIT = 45 MPH

NORTHFIELD TOWNSHIP
COOK COUNTY

ILLINOIS DEPARTMENT OF
TRANSPORTATION

LOCATION MAP

LOCATION 16: SN 016-0528