

ROUTE	SECTION	COUNTY	TOTAL SHEETS	SHEET NUMBER
VARIOUS	2010-023 BP	VARIOUS	93	23

CONTRACT NO. 60K48

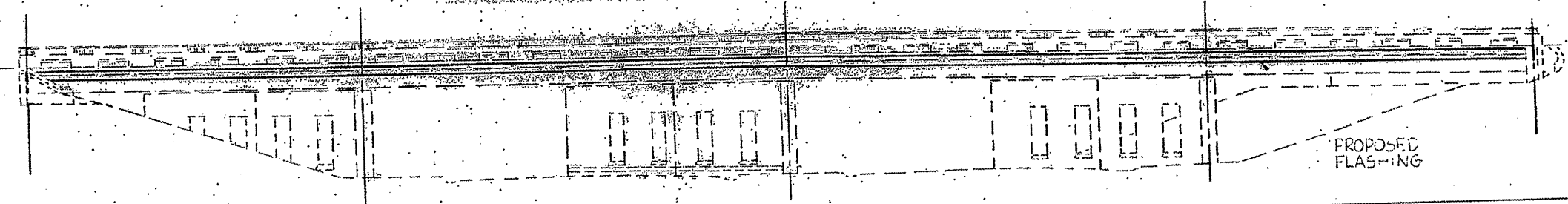
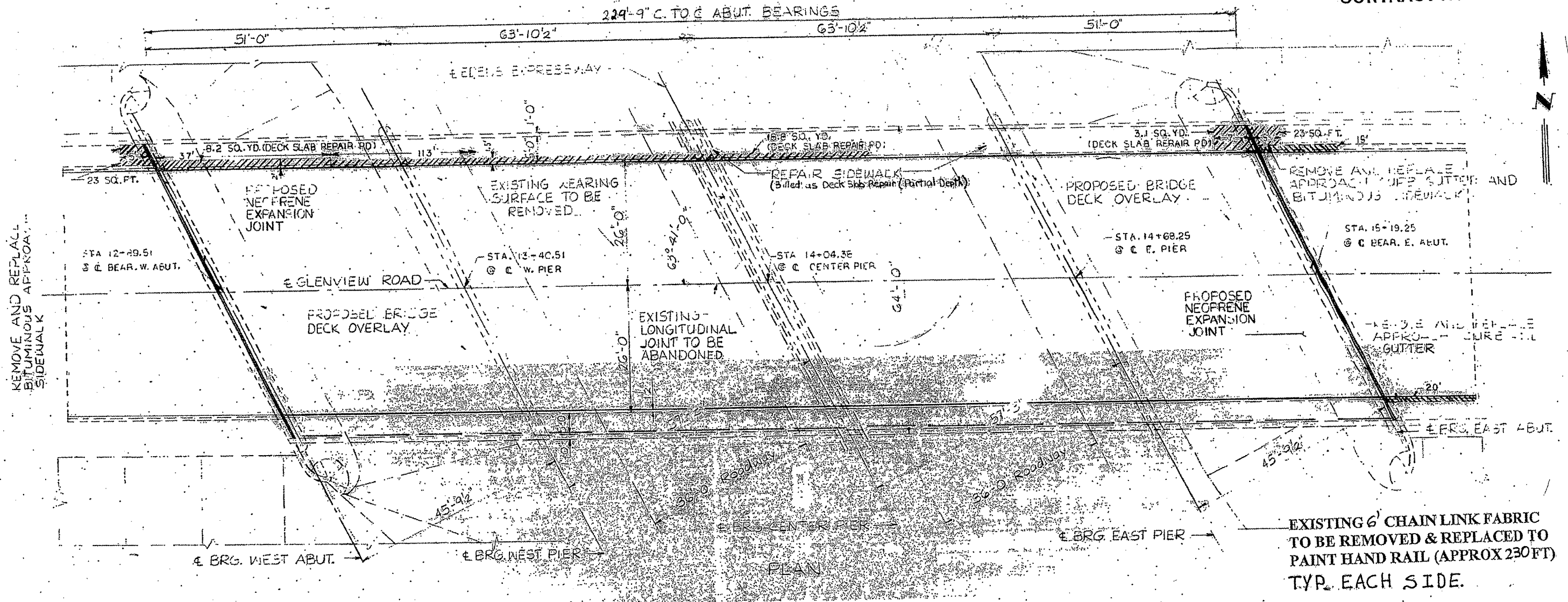

EXISTING 6' CHAIN LINK FABRIC TO BE REMOVED & REPLACED TO PAINT HAND RAIL (APPROX 230 FT) TYP. EACH SIDE.

GLENVIEW
 EXISTING STRUCTURE NO. 016-0821 AT STA. 14+04.36 BUILT IN 1949 FEDERAL-AID HIGHWAY F.A. ROUTE 99
 PROJECT U.I. 146(40) ILENS EXPRESSWAY SECTION 267-0808 I-150
 EXISTING WEARING SURFACE AND LONGITUDINAL JOINTS TO BE REMOVED. EXISTING EXPANSION DEVICES TO BE
 REMOVED AND REPLACED WITH NEOPRENE. EXISTING DECK TO BE REPAIRED AND OVERLAIN WITH BRIDGE DECK CONCRETE
 OVERLAY AS PER SPEC. NEW DRAIN PLATES TO BE PLACED. NEW DIAPHRAGMS TO BE PLACED. EXISTING
 PIERS TO BE REPAIRED. EXISTING BEARINGS TO BE REALIGNED AND PAINTED.
 TWO-WAY TRAFFIC SHALL BE MAINTAINED BY UTILIZING STAGE CONSTRUCTION.

ILLINOIS DEPARTMENT OF
 TRANSPORTATION
 EXISTING BRIDGE PLAN
 LOCATION 4: SN 016-0821
 GLENVIEW RD. OVER I-94

SH. 1 of 4