

**TRAFFIC SIGNAL LEGEND**

	PROPOSED	EXISTING
DETECTOR LOOP		
SIGNAL HEAD		
G.S. CONDUIT IN TRENCH OR PUSHED		
SIGNAL HEAD WITH BACKPLATE		
RACEWAY FOR MAGNETIC DETECTOR, TYPE I OR II		
VEHICLE DETECTOR, NON-COMPENSATED MAGNETIC TYPE		

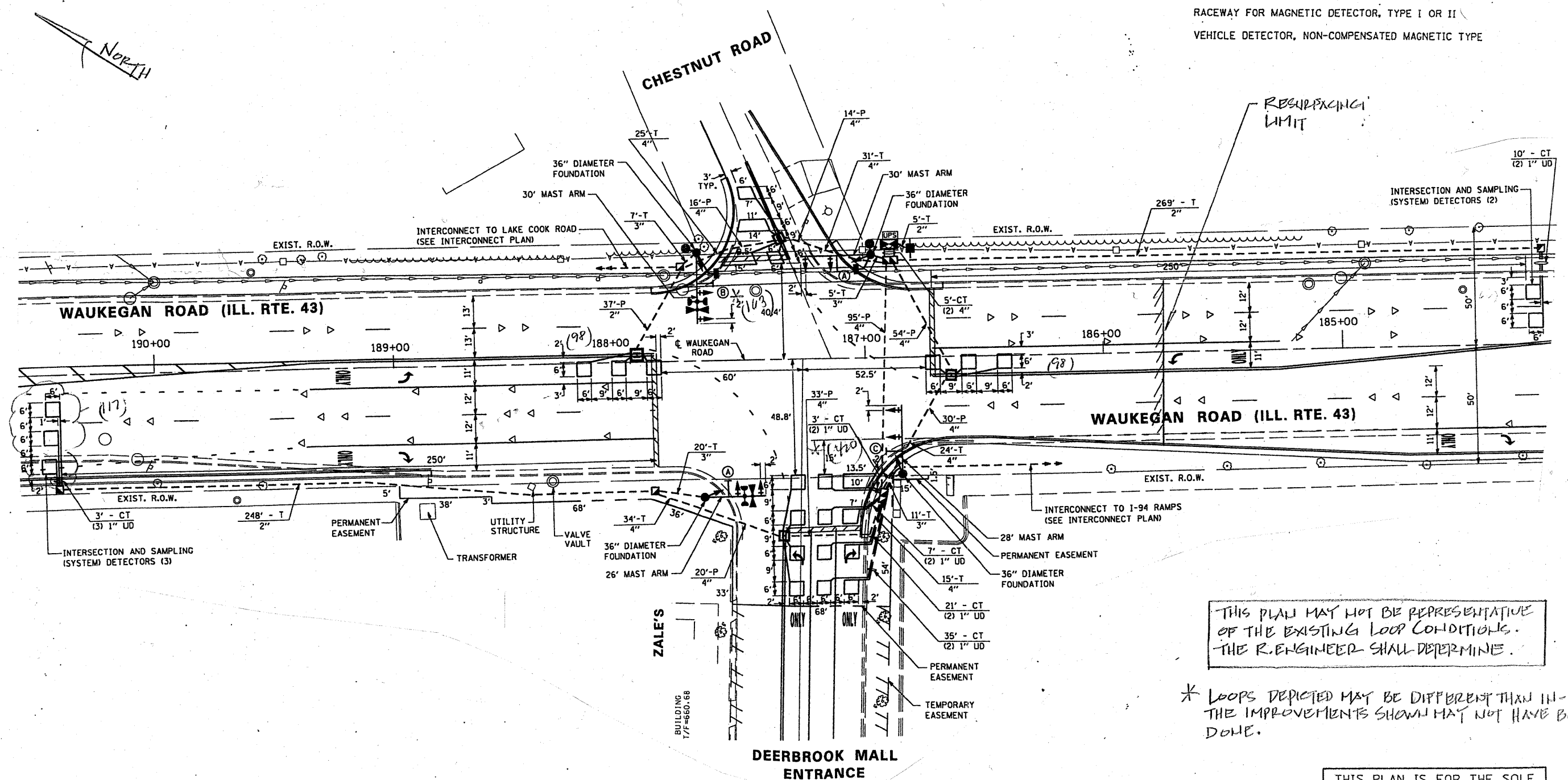

THIS PLAN MAY NOT BE REPRESENTATIVE OF THE EXISTING LOOP CONDITIONS. THE R. ENGINEER SHALL DETERMINE.

\* LOOPS DEPICTED MAY BE DIFFERENT THAN IN-FIELD THE IMPROVEMENTS SHOWN MAY NOT HAVE BEEN DONE.

THIS PLAN IS FOR THE SOLE PURPOSE OF DETECTOR LOOP REPLACEMENTS ONLY

REPLACE ALL DETECTOR LOOPS AS SHOWN (WITHIN THE RESURFACING LIMITS)

CODE	QUANTITY	UNIT	ITEM
86600600	396	FOOT	DETECTOR LOOP, REPLACEMENT

FILE NAME =	USER NAME = konthaphixayba	DESIGNED - BCK	REVISED -
ca:\pw_work\PM\DOT\KANTHAPHIXAYBA\01126	4\tr\office\legend_v7.dgn	DRAWN - BCK	REVISED -
	PLOT SCALE = 3/4" = 1' IN.	CHECKED - DAD	REVISED -
	PLOT DATE = 4/3/2009	DATE -	REVISED -

**STATE OF ILLINOIS  
DEPARTMENT OF TRANSPORTATION**

DISTRICT ONE - DETECTOR LOOP REPLACEMENT  
ILL. RTE. 43 @ CHESTNUT RD.

F.A.P. RTE.	SECTION	COUNTY	TOTAL SHEETS	SHEET NO.
348	3271 B-RS-3	COOK	19	8
CONTRACT # 60K71			CONTRACT NO.	
FED. ROAD DIST. NO. ILLINOIS FED. AID PROJECT				