

| ROUTE | SECTION | COUNTY | TOTAL SHEETS | SHEET NUMBER |
|---------|-------------|--------|--------------|--------------|
| VARIOUS | 2010-036 RS | COOK | 6 | 4 |

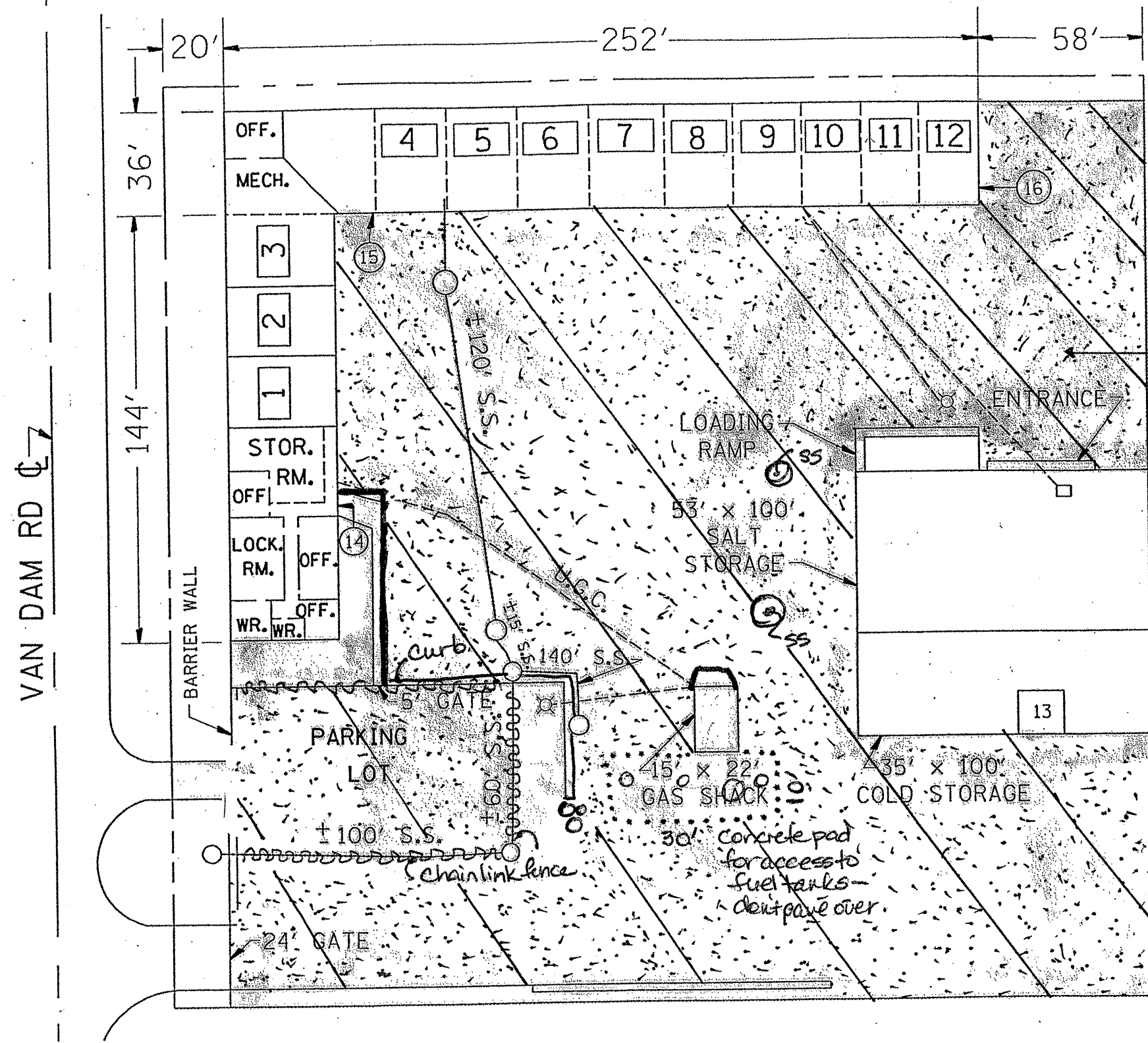

2 1/4" HMA SURFACE REMOVAL
 1 1/2" HMA SURFACE COURSE, MIX "D", N70
 3/4" POLYMERIZED LEVELING BINDER (MM), IL-4.75, N50

NOTE:
 CONTRACTOR SHALL MILL FIRST BEFORE PATCHING

ILLINOIS DEPARTMENT OF
 TRANSPORTATION

BISHOP FORD TEAM SECTION