

ROUTE	SECTION	COUNTY	TOTAL SHEETS	SHEET NUMBER
VARIOUS	2010-036 RS	COOK	6	1

CONTRACT NO.: 60K92

D-91-620-10

FOR INDEX OF SHEETS SEE SHEET 2

STATE OF ILLINOIS  
DEPARTMENT OF TRANSPORTATION  
DIVISION OF HIGHWAYS  
DISTRICT ONE

**PROPOSED HIGHWAY PLANS**

ROUTE: VARIOUS  
BISHOP FORD YARD & SOUTH SIDE SIGN SHOP  
SECTION: 2010-036 RS  
MAINTENANCE PARKING LOT PAVING  
COOK COUNTY  
C-91-620-10

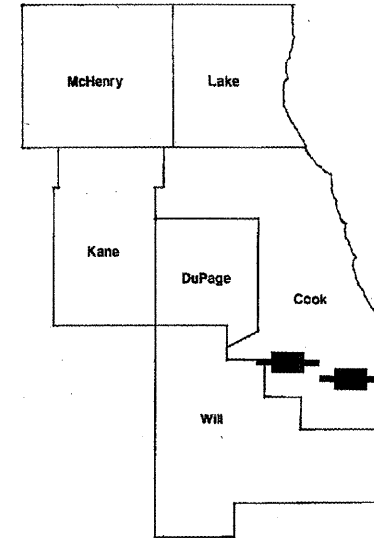

IMPROVEMENT IS LOCATED IN THE CITY OF MARKHAM AND THE VILLAGE OF SOUTH HOLLAND

R 13 E | R 14 E

IMPROVEMENT LOCATION:  
SOUTH SIDE SIGN SHOP

IMPROVEMENT LOCATION:  
BISHOP FORD TEAM SECTION

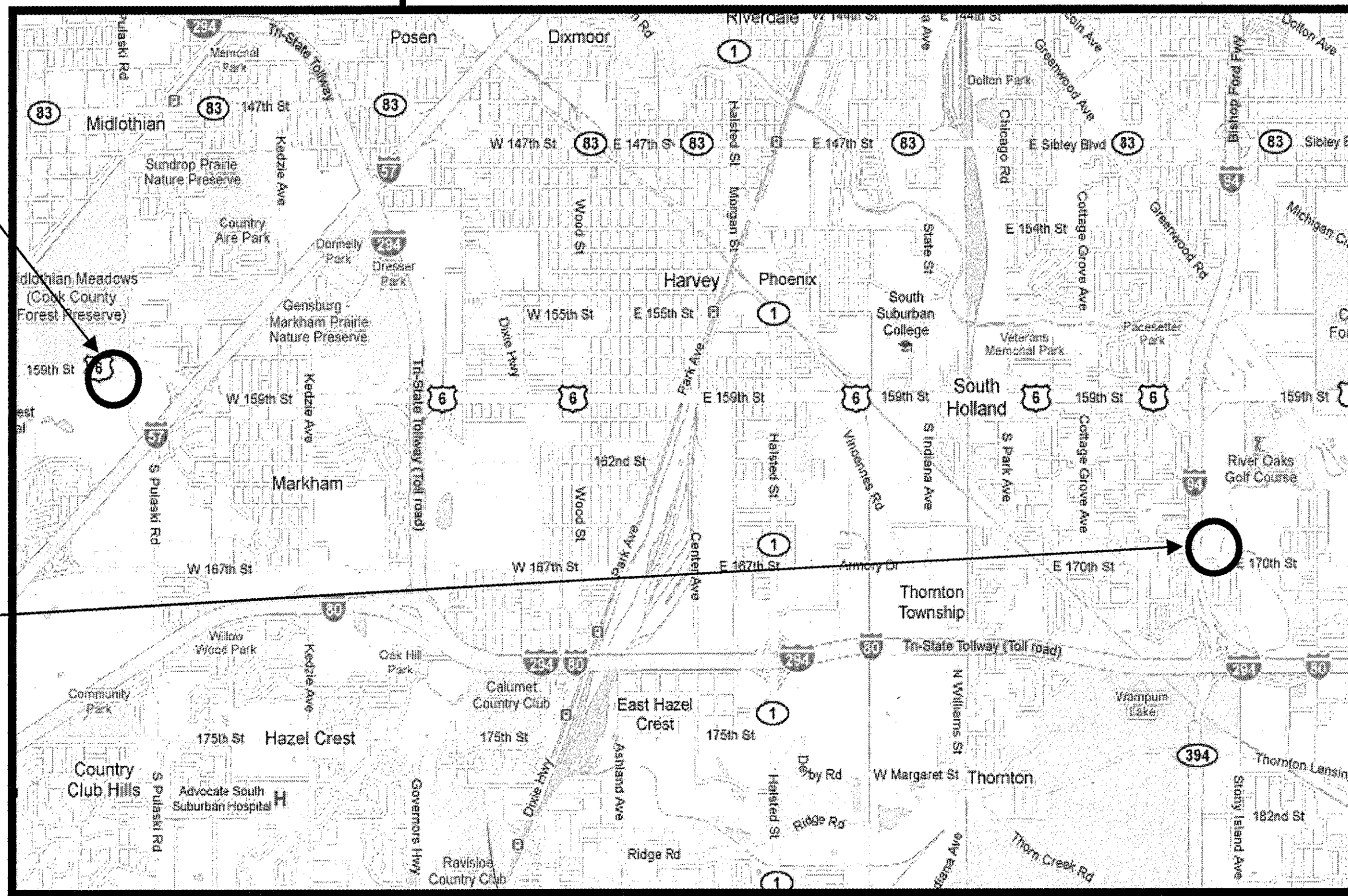

LOCATION OF IMPROVEMENT INDICATED THUS:



DISTRICT ONE - PLAN PREPARATION ENGINEER:  
KEN ENG/R. BORO (847) 705-4178

STATE OF ILLINOIS  
DEPARTMENT OF TRANSPORTATION  
DIVISION OF HIGHWAYS

SUBMITTED: APRIL 15, 2010  
*Diana M. O'Keefe*  
DEPUTY DIRECTOR OF HIGHWAYS, REGION ENGINEER

May 7 2010  
*Scott E. Stitt, P.E.*  
acting ENGINEER OF DESIGN AND ENVIRONMENT

May 7 2010  
*Christine M. Reed*  
DIRECTOR OF HIGHWAYS, CHIEF ENGINEER

**PRINTED BY THE AUTHORITY  
OF THE STATE OF ILLINOIS**

J.U.L.I.E.  
JOINT UTILITY LOCATION INFORMATION FOR  
EXCAVATION: (800) 892-0123 OR 811

**CONTRACT NO. 60K92**

**BREMEN & THORNTON  
TOWNSHIP**

ROUTE	SECTION	COUNTY	TOTAL SHEETS	SHEET NUMBER
VARIOUS	2010-036 RS	COOK	6	2

CONTRACT NO.:60K92

**INDEX OF SHEETS**

1. TITLE SHEET
2. INDEX OF SHEETS AND GENERAL NOTES
3. SUMMARY OF QUANTITIES
4. BISHOP FORD TEAM SECTION PLAN
5. SOUTH SIDE SIGN SHOP PLAN
6. PAVEMENT PATCHING FOR HMA SURFACED PAVEMENT

**GENERAL NOTES**

BEFORE STARTING ANY EXCAVATION, THE CONTRACTOR SHALL CALL "J.U.L.I.E." AT (800) 892-0123 OR 811 FOR FIELD LOCATIONS OF BURIED ELECTRIC, TELEPHONE AND GAS UTILITIES. (48 HOUR NOTIFICATION IS REQUIRED).

THE CONTRACTOR SHALL COORDINATE CONSTRUCTION ACTIVITIES WITH THE BISHOP FORD TEAM SECTION TECHNICIAN ALBERTO ARROYO AT 708-331-4339 AND THE SOUTH SIDE SIGN SHOP TECHNICIAN DAVE SMITH AT 708-597-9800 FOR WORK TO BE DONE AT THE RESPECTIVE YARD.

NO HEAVY EQUIPEMENT SHALL BE ALLOWED ON MILLED OR WORK ZONE AREA..

THE CONTRACTOR WILL NOT BE ALLOWED TO SET UP A YARD OR FIELD OFFICE ON STATE PROPERTY WITHOUT WRITTEN PERMISSION FROM THE DEPARTMENT.

THESE PLANS HAVE BEEN PREPARED FROM NOTES RECEIVED FROM BUREAU OF MAINTENANCE.

DO NOT SCALE PLANS FOR CONSTRUCTION DIMENSIONS.

IT SHALL BE THE CONTRACTOR'S RESPONSIBILITY TO VERIFY ALL DIMENSIONS AND CONDITIONS EXISTING IN THE FIELD PRIOR TO CONSTRUCTION AND ORDERING OF MATERIALS.

ALL PAVEMENT PATCHING LOCATIONS WILL BE DETERMINED IN THE FIELD BY THE ENGINEER.

THE CONTRACTOR SHALL BE REQUIRED TO PROVIDE ACCESS TO ABUTTING PROPERTY AT ALL TIMES DURING THE CONSTRUCTION OF THIS PROJECT.

**HMA MIXTURE REQUIREMENTS**

MIXTURE TYPE	AIR VOIDS @ Ndes
<b>PAVEMENT RESURFACING</b>	
HOT-MIX ASPHALT SURFACE COURSE, MIX "D", N70 (IL 9.5 mm)	4% @ 70 GYR.
POLYMERIZED LEVELING BINDER (MACHINE METHOD), IL-4.75, N50	4% @ 50 GYR.
<b>PATCHING</b>	
CLASS D PATCHES (HMA BINDER IL-19 mm)	4% @ 70 GYR.

- THE UNIT WEIGHT USED TO CALCULATE HOT-MIX ASPHALT SURFACE MIXTURES IS 112 LBS/SQ YD/IN.
- THE AC TYPE FOR POLYMERIZED HMA MIXES SHALL BE SBS/SBR PG 70-22 AND FOR NON-POLYMERIZED HMA THE AC TYPE SHALL BE PG 64-22 UNLESS MODIFIED BY DISTRICT ON SPECIAL PROVISIONS. FOR "PERCENT OF RAP" SEE DISTRICT ONE SPECIAL PROVISIONS.

ILLINOIS DEPARTMENT OF TRANSPORTATION  
**INDEX OF SHEETS  
STATE STANDARDS  
GENERAL NOTES**

URBAN  
100% STATE

ROUTE	SECTION	COUNTY	TOTAL SHEETS	SHEET NUMBER
VARIOUS	2010-036 RS	COOK	6	3

CONTRACT NO.: 60K92

CONSTRUCTION CODE TYPE: 1000		COOK CO.	
CODE NO.	ITEMS	UNITS	TOTAL QUANTITIES
40600200	BITUMINOUS MATERIALS (PRIME COAT)	TON	7.8
40600300	AGGREGATE (PRIME COAT)	TON	39
40600400	MIXTURE FOR CRACK, JOINTS AND FLANGEWAYS	TON	15
40600826	POLYMERIZED LEVELING BINDER (MACHINE METHOD), IL-4.75, N50	TON	405
40603340	HOT-MIX ASPHALT SURFACE COURSE, MIX "D", N70	TON	825
44000158	HOT-MIX ASPHALT SURFACE REMOVAL, 2 1/4"	SQ YD	9819
44201692	CLASS D PATCHES, TYPE II, 4 INCH	SQ YD	175
67100100	MOBILIZATION	L SUM	1

ILLINOIS DEPARTMENT OF TRANSPORTATION

SUMMARY OF QUANTITIES

ROUTE	SECTION	COUNTY	TOTAL SHEETS	SHEET NUMBER
VARIOUS	2010-036 RS	COOK	6	4

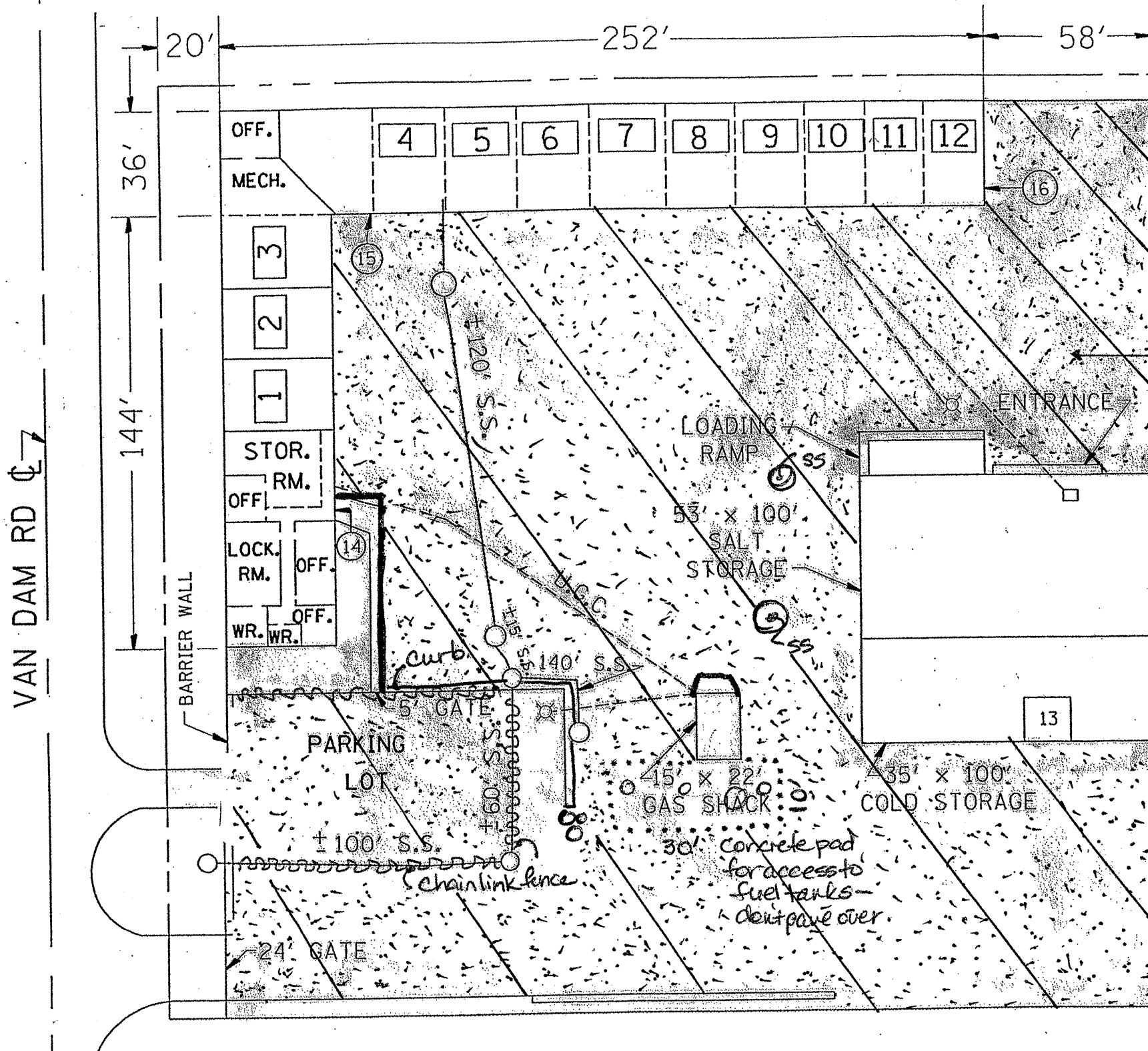

2 1/4" HMA SURFACE REMOVAL  
 1 1/2" HMA SURFACE COURSE, MIX "D", N70  
 3/4" POLYMERIZED LEVELING BINDER (MM), IL-4.75, N50

NOTE:  
 CONTRACTOR SHALL MILL FIRST BEFORE PATCHING

ILLINOIS DEPARTMENT OF  
 TRANSPORTATION

BISHOP FORD TEAM SECTION

ROUTE	SECTION	COUNTY	TOTAL SHEETS	SHEET NUMBER
VARIOUS	2010-036 RS	COOK	6	5

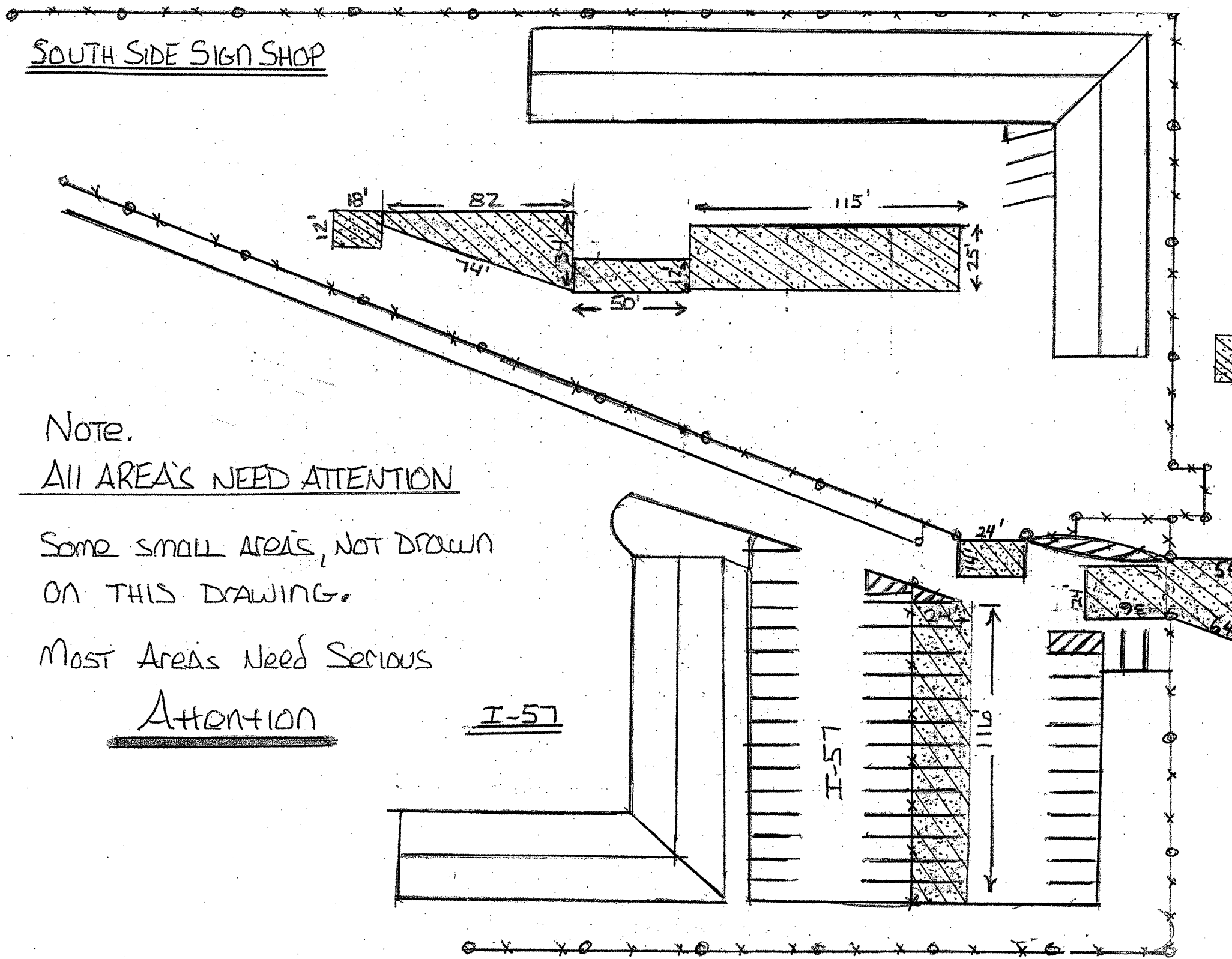

LEGEND

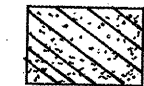

2 1/4" HMA SURFACE REMOVAL  
 1 1/2" HMA SURFACE COURSE, MIX "D", N70  
 3/4" POLYMERIZED LEVELING BINDER (MM),  
 IL-4.75, N50

Note.  
All AREA'S NEED ATTENTION  
 Some small areas, NOT DRAWN  
 ON THIS DRAWING.  
 Most Areas Need Serious  
Attention

NOTE:  
 CONTRACTOR SHALL MILL FIRST BEFORE PATCHING

ILLINOIS DEPARTMENT OF  
 TRANSPORTATION  
 SOUTH SIDE SIGN SHOP

F.A. RTE.	SECTION	COUNTY	TOTAL SHEETS	SHEET NO.
VAR 2010-0765	COOK		6	6
STA.	TO STA.			
FED. ROAD DIST. NO. 1 ILLINOIS FED. AID PROJECT				

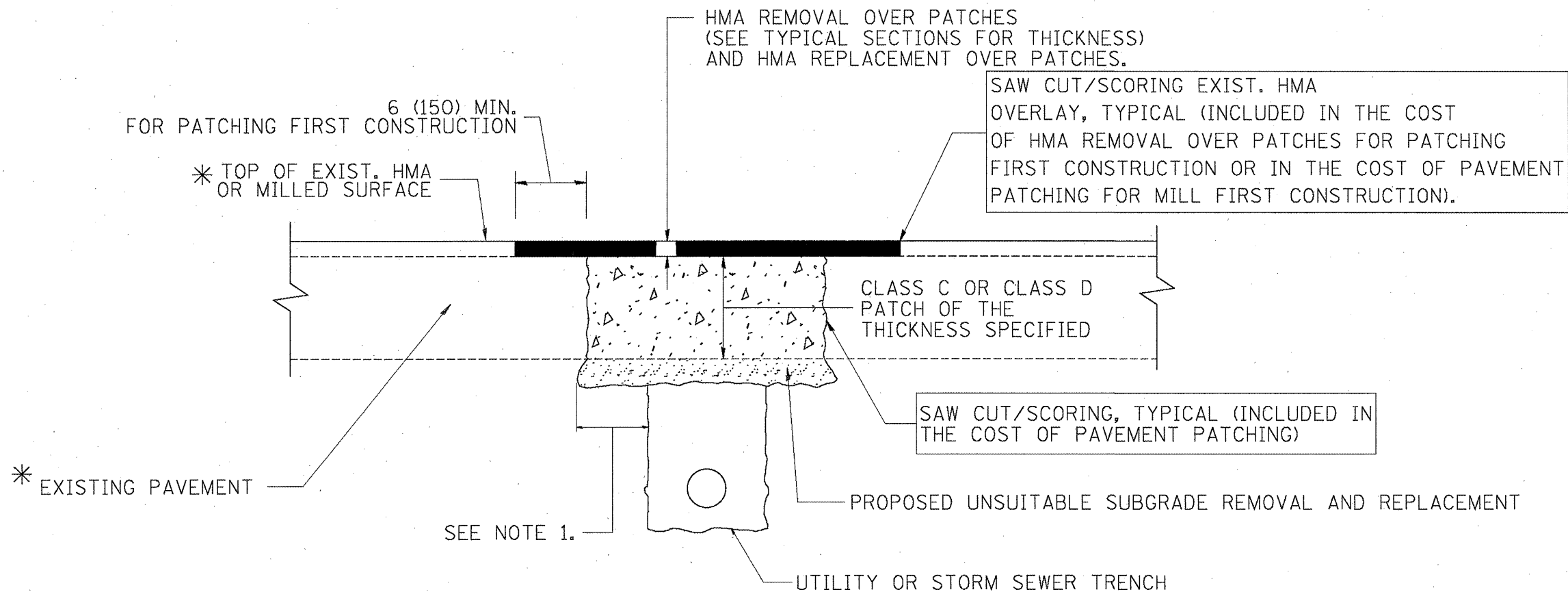

\* SEE TYPICAL SECTIONS FOR THICKNESS AND MATERIALS

NOTES:

1. THE WIDTH OF THE FULL DEPTH PATCH OVER A TRENCH SHALL BE 12 (300) WIDER ON EACH SIDE OF THE TRENCH.
2. FOR METHOD OF MEASUREMENT AND BASIS OF PAYMENT, SEE RECURRING SPECIAL PROVISION "PATCHING WITH HOT-MIX ASPHALT OVERLAY REMOVAL".

SEQUENCE OF CONSTRUCTION (PATCHING FIRST)

1. REMOVE THE EXISTING HMA MATERIAL OVER THE AREA TO BE PATCHED.
2. REMOVE AND REPLACE WITH CLASS C OR D PATCH.
3. REPLACE HMA MATERIAL OVER THE AREA TO BE PATCHED.

SEQUENCE OF CONSTRUCTION (MILLING FIRST)

1. MILL HMA FIRST IF THERE IS AT LEAST 4 1/2 INCHES OR MORE OF HMA MATERIAL ON TOP OF THE EXISTING PAVEMENT OR IF THE PAVEMENT IS FULL DEPTH HMA. A MINIMUM OF 2 INCHES OF HMA MATERIAL SHALL BE IN PLACE AFTER MILLING.
2. REMOVE AND REPLACE WITH FULL DEPTH CLASS D PATCHES TO TOP OF MILLED SURFACE.

ALL DIMENSIONS ARE IN INCHES (MILLIMETERS) UNLESS OTHERWISE SHOWN.

REVISIONS	
NAME	DATE
R. SHAH	01/14/95
R. SHAH	03/23/95
R. SHAH	04/24/95
A. HOUSEH	03/15/96
A. ABBAS	03/21/97
A. ABBAS	01/20/98
ART ABBAS	04/27/98
R. BORO	01/01/07
R. BORO	09/04/07
K. ENG	10/27/08

ILLINOIS DEPARTMENT OF TRANSPORTATION

PAVEMENT PATCHING FOR HMA SURFACED PAVEMENT

SCALE: VERT. NONE  
HORIZ. NONE

DRAWN BY  
CHECKED BY  
BD400-04 (BD-22)

PLOT DATE: 10/27/2008  
 FILE NAME: c:\pavement\stand\04\08\bd22.dgn  
 USER: keng  
 PLOTTER: HP DesignJet 2400