

ROUTE	SECTION	COUNTY	TOTAL SHEETS	SHEET NUMBER
VARIOUS	2010-037 RS	WILL	5	1

CONTRACT NO.: 60K93

D-91-621-10

FOR INDEX OF SHEETS SEE SHEET 2

STATE OF ILLINOIS  
DEPARTMENT OF TRANSPORTATION  
DIVISION OF HIGHWAYS  
DISTRICT ONE

**PROPOSED HIGHWAY PLANS**

ROUTE: VARIOUS  
JOLIET MAINTENANCE YARD  
SECTION: 2010-037 RS  
MAINTENANCE PARKING LOT PAVING  
WILL COUNTY  
C-91-621-10

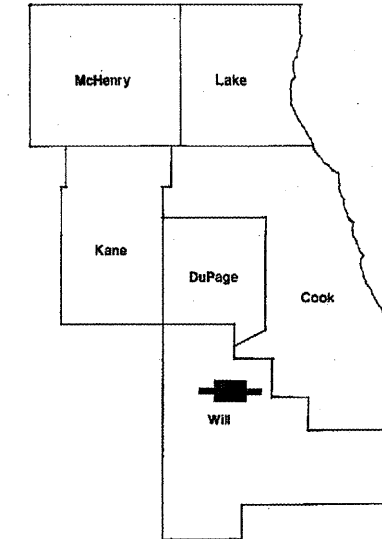

LOCATION OF IMPROVEMENT INDICATED THUS:



STATE OF ILLINOIS  
DEPARTMENT OF TRANSPORTATION  
DIVISION OF HIGHWAYS

SUBMITTED: April 15, 2010  
*Diana M. O'Keefe*  
DEPUTY DIRECTOR OF HIGHWAYS, REGION ENGINEER

May 7, 2010  
*Scott E. Stitt, P.E.*  
acting ENGINEER OF DESIGN AND ENVIRONMENT

May 7, 2010  
*Christine M. Reed*  
DIRECTOR OF HIGHWAYS, CHIEF ENGINEER

**PRINTED BY THE AUTHORITY  
OF THE STATE OF ILLINOIS**

J.U.L.I.E.  
JOINT UTILITY LOCATION INFORMATION FOR  
EXCAVATION: (800) 892-0123 OR 811

IMPROVEMENT IS LOCATED IN THE  
CITY OF LOCKPORT

IMPROVEMENT LOCATION:  
JOLIET MAINTENANCE YARD

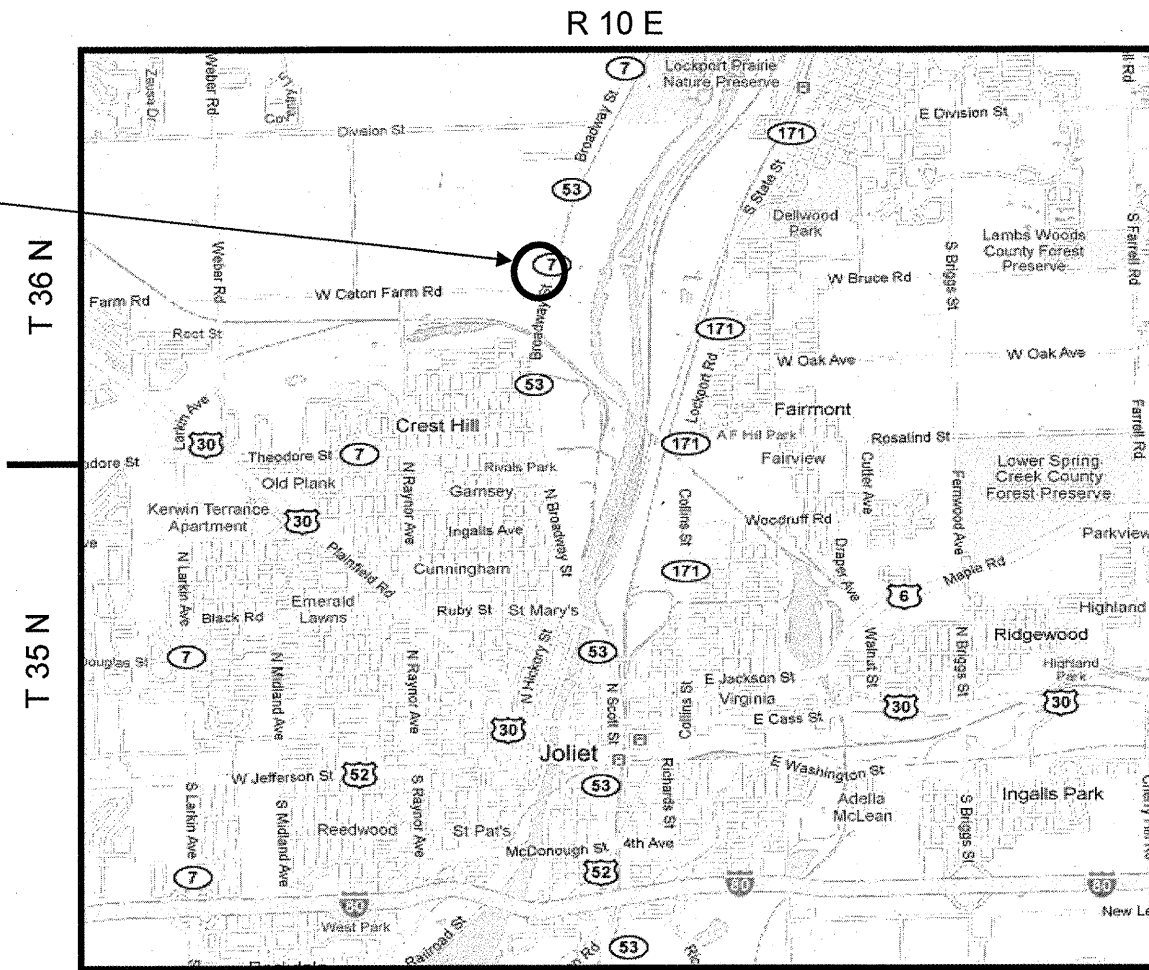

LOCKPORT TOWNSHIP

CONTRACT NO. 60K93

DISTRICT ONE - PLAN PREPARATION ENGINEER:  
KEN ENG/ R. BORO (847) 705-4178