

ROUTE	SECTION	COUNTY	TOTAL SHEETS	SHEET NUMBER
VARIOUS	2010-038 RS	COOK & DuPAGE	6	5

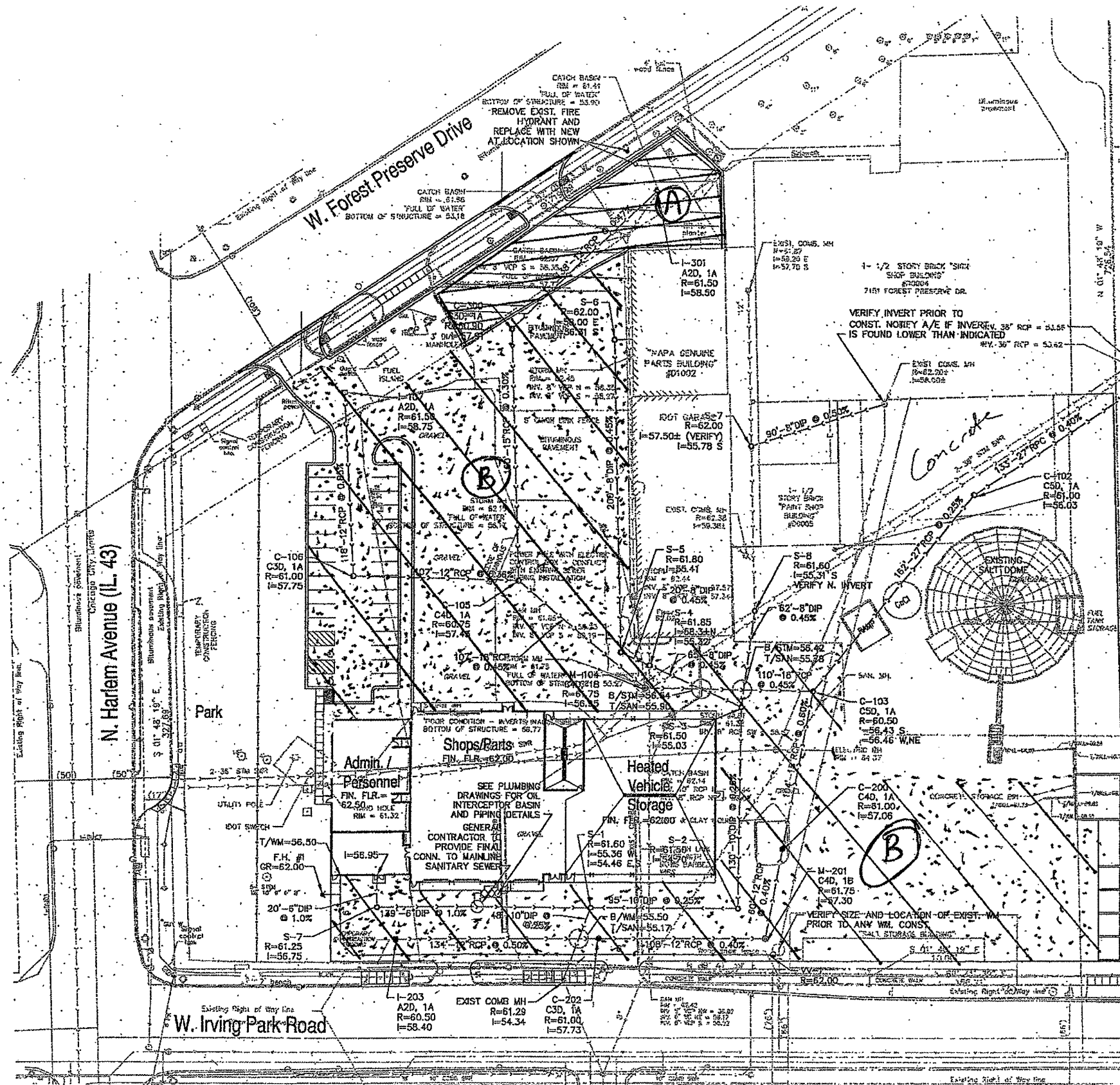
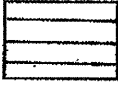
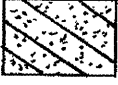

LEGEND

- (A)  2 1/4" HMA SURFACE REMOVAL
1 1/2" HMA SURFACE COURSE, MIX "D", N70
3/4" LEVELING BINDER (MM), N70
- (B)  HOT-MIX ASPHALT PAVEMENT (FULL DEPTH), 6"

NOTE:

CONTRACTOR SHALL MILL FIRST BEFORE PATCHING

ILLINOIS DEPARTMENT OF
TRANSPORTATION

NORTHSIDE TEAM SECTION