

F.A.I. RTE.	SECTION	COUNTY	TOTAL SHEETS	SHEET NO.
57	2222.3B	COOK	77	18
STA. 12+06.00		TO STA.16+17.11		
FED. ROAD DIST. NO.		ILLINOIS	FED. AID PROJECT	

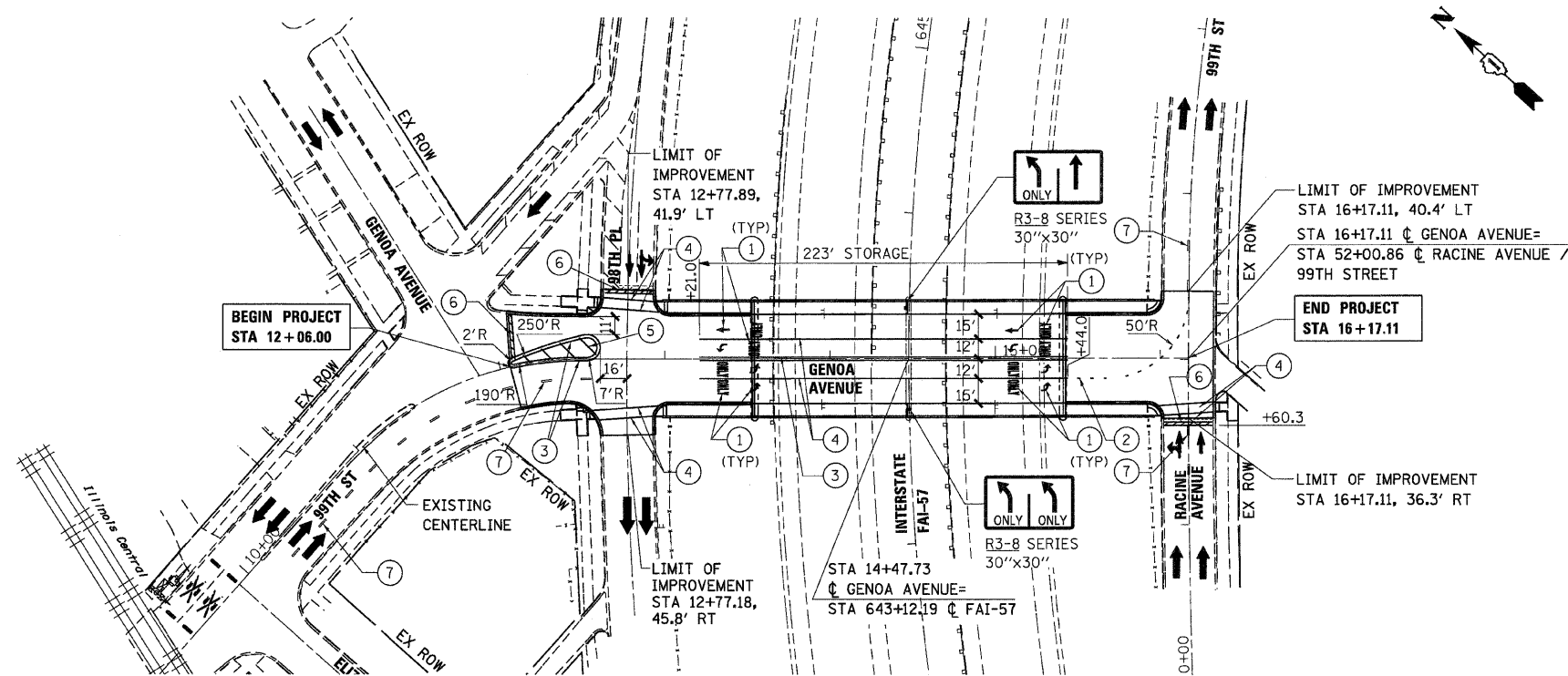

LEGEND:

- ① POLYUREA PAVEMENT MARKING - LETTERS AND SYMBOLS
- ② POLYUREA PAVEMENT MARKING - LINE 4", WHITE, SKIP DASH - 6' SKIP - 2' DASH
- ③ POLYUREA PAVEMENT MARKING - LINE 4", DOUBLE YELLOW
- ④ POLYUREA PAVEMENT MARKING - LINE 6", WHITE
- ⑤ POLYUREA PAVEMENT MARKING - LINE 12", YELLOW
- ⑥ POLYUREA PAVEMENT MARKING - LINE 24", WHITE
- ⑦ POLYUREA PAVEMENT MARKING - LINE 4", WHITE SKIP DASH, 18' SKIP - 6' DASH

NOTES:

- 1. SEE DISTRICT ONE STANDARD 'CITY OF CHICAGO TYPICAL PAVEMENT MARKINGS' FOR ADDITIONAL INFORMATION.

PLOT DATE = Thursday, March 04, 2010
 FILE NAME = S:\J-CARD\01-CH\A\18-586-01.dgn
 PLOT SCALE = 80%
 USER NAME = 3639



REVISIONS	
NAME	DATE

ILLINOIS DEPARTMENT OF TRANSPORTATION

**SIGNING /PAVEMENT MARKING PLAN
GENOA AVENUE OVER FAI-57**

SCALE: VERT. 1"=50'
 HORIZ. 1"=50'
 DATE: 3/1/2010

DRAWN BY: E.D.
 CHECKED BY: A.A.C.