

CODE	QUANTITY	UNIT	ITEM
88600600	376	FOOT	DETECTOR LOOP REPLACEMENT

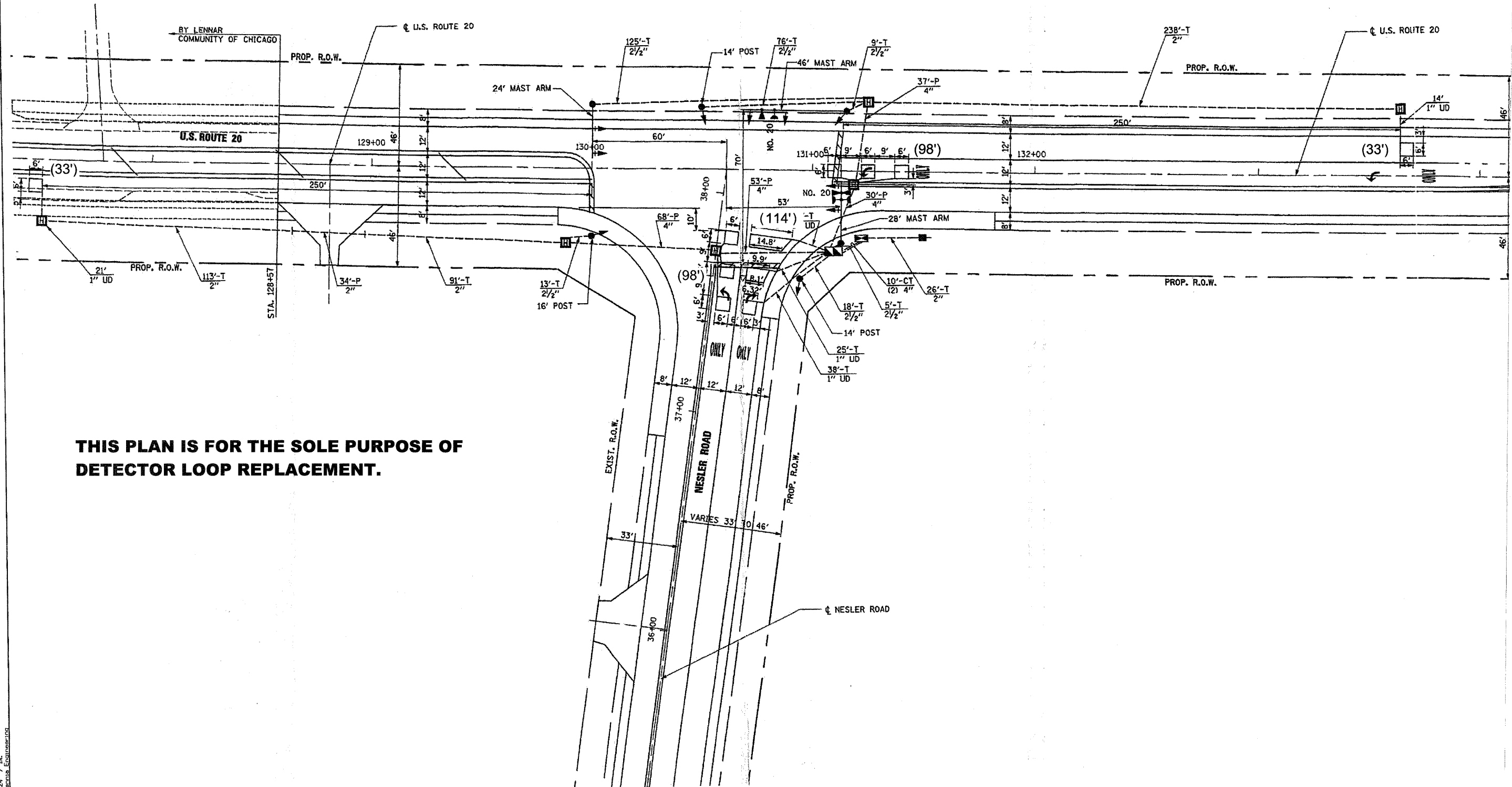

**THIS PLAN IS FOR THE SOLE PURPOSE OF
DETECTOR LOOP REPLACEMENT.**

FILE NAME = P:\2009\MEB\9006_Ver-Var-Phil\CADD\W05_US20_Shts\Border_US20.dgn
 PLOT SCALE = 1/8" = 1'-0"
 PLOT DATE = 12/9/2009



200 32ND Street, Suite 216, Lombard, IL 60148
 630.785.8110 voice, 630.839.2566 fax
 WWW.MPS-IL.COM
MILLENNIA PROFESSIONAL SERVICES

DESIGNED - TVN	REVISED -
DRAWN - TVN	REVISED -
CHECKED - RPD	REVISED -
DATE - 12/9/2009	REVISED -

STATE OF ILLINOIS
DEPARTMENT OF TRANSPORTATION

US ROUTE 20 AT
NESSLER ROAD
 SCALE: - SHEET NO. OF SHEETS STA. TO STA.

F.A.P. RTE.	SECTION	COUNTY	TOTAL SHEETS	SHEET NO.
345	8WRS-2	KANE	72	42
FED. ROAD DIST. NO. 1 [ILLINOIS] FED. AID PROJECT			CONTRACT NO. 62529	

P:\2009\MEB\9006_Ver-Var-Phil\CADD\W05_US20_Shts\Border_US20.dgn