

F.A.P. RTE.	SECTION	COUNTY	TOTAL SHEETS	SHEET NO.
345	8WRS-2	KANE	72	45
STA. 99+00.00		TO STA. 114+00.00		
FED. ROAD DIST. NO.	ILLINOIS	FED. AID PROJECT		

FOR INFORMATION ONLY

EXIST. CURVE 1
 PI STA. = 99+98.57
 $\Delta = 14^\circ 12' 29''$ (RT)
 $D = 3^\circ 54' 13''$
 $R = 1,467.81'$
 $T = 182.93'$
 $L = 363.98'$
 $E = 11.36'$
 $e = \dots$
 $T.R. = \dots$
 $S.E. RUN = \dots$
 $P.C. STA. = 98+15.64$
 $P.T. STA. = 101+79.62$

PROP. CURVE C2
 PI STA. = 100+34.16
 $\Delta = 12^\circ 13' 05''$ (RT)
 $D = 1^\circ 08' 45''$
 $R = 5,000.00'$
 $T = 535.14'$
 $L = 1,066.22'$
 $E = 28.56'$
 $e = 0.022$
 $T.R. = 150'$
 $S.E. RUN = 165'$
 $P.C. STA. = 94+97.22$
 $P.T. STA. = 105+63.45$

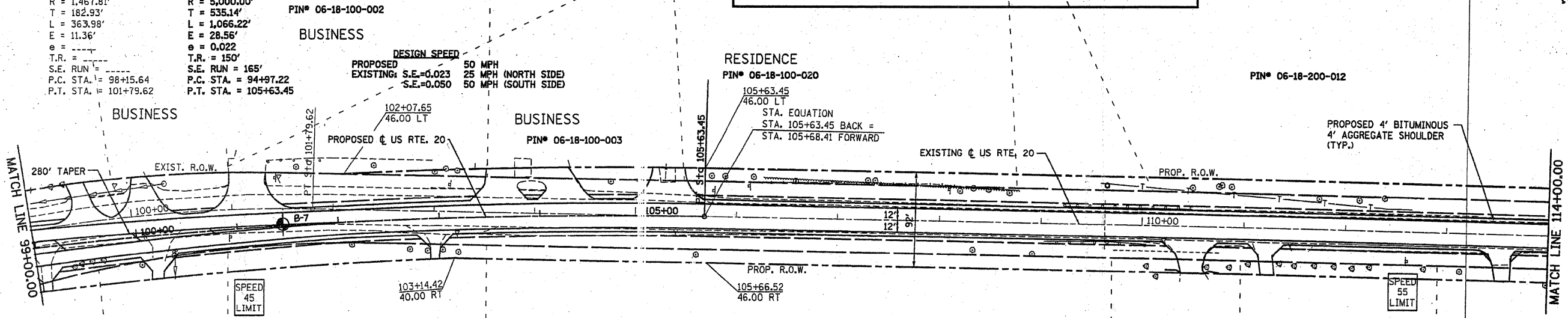

RESIDENCE PIN# 06-18-100-010 RESIDENCE PIN# 06-18-100-011 BUSINESS PIN# 06-18-100-002 BUSINESS PIN# 06-18-100-003 RESIDENCE PIN# 06-18-100-020 BUSINESS PIN# 06-18-200-012

RESIDENCE PIN# 06-18-100-013 BUSINESS PIN# 06-18-100-019 RESIDENCE PIN# 06-18-100-018 RESIDENCE PIN# 06-18-200-005

← PROPOSED RECONSTRUCTION PROPOSED WIDENING/RESURFACING →

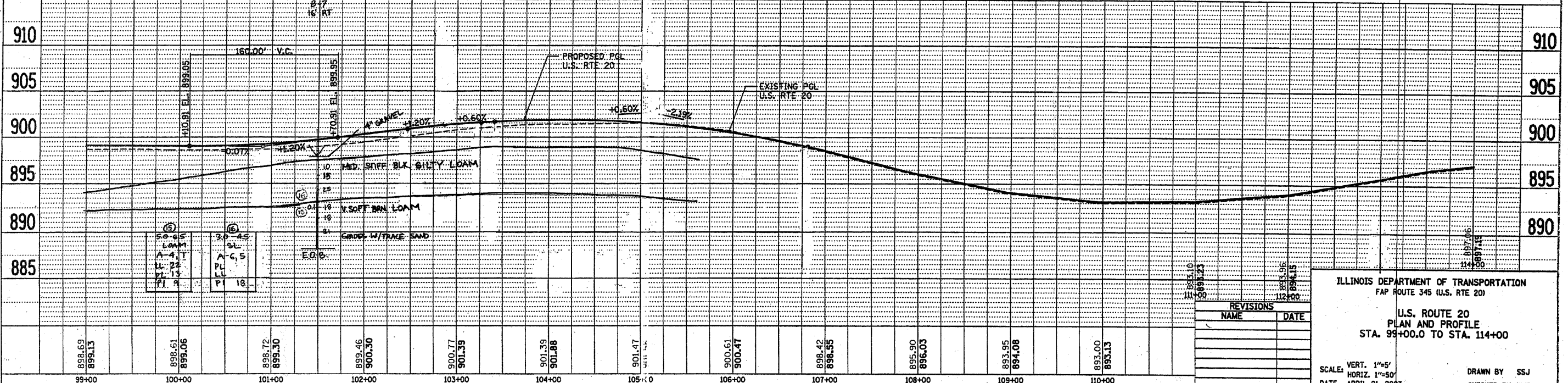

DATE	
BY	
PLAN	
NO. OF SHEETS	
NO. OF SHEETS CHECKED	
NO. OF SHEETS NOT CHECKED	
NO. OF SHEETS FILED	

DATE	
BY	
PROFILE	
NO. OF SHEETS	
NO. OF SHEETS CHECKED	
NO. OF SHEETS NOT CHECKED	
NO. OF SHEETS FILED	

REVISIONS	
NAME	DATE

ILLINOIS DEPARTMENT OF TRANSPORTATION
 FAP ROUTE 345 (U.S. RTE 20)

U.S. ROUTE 20
 PLAN AND PROFILE
 STA. 99+00.0 TO STA. 114+00

SCALE: VERT. 1"=5'
 HORIZ. 1"=50'
 DATE APRIL 21, 2003

DRAWN BY SSS
 CHECKED BY KWB