

F.A.P. RTE.	SECTION	COUNTY	TOTAL SHEETS	SHEET NO.
345	8WRS-2	KANE	72	46

STA.	TO STA.
114+00.00	129+00.00

FED. ROAD DIST. NO.	ILLINOIS	FED. AID PROJECT

FOR INFORMATION ONLY

EXIST. CURVE 4
 PI STA. = 126+65.78
 Δ = 1° 19' 17" (LT)
 D = 0° 11' 26"
 R = 30,058.10'
 T = 346.66'
 L = 693.29'
 E = 2.00'
 e = ---
 $T.R.$ = ---
 $S.E. RUN$ = ---
 $P.C. STA.$ = 123+19.12
 $P.T. STA.$ = 130+12.41

BUSINESS
 PIN# 06-18-200-016

RESIDENCE
 PIN# 06-18-200-008

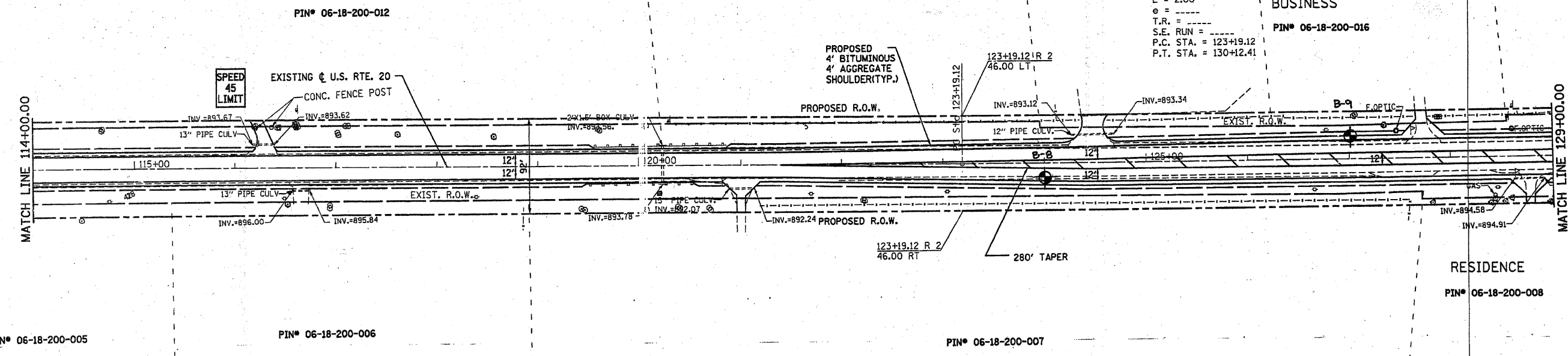

DATE	BY

DATE	BY

DATE	BY

DATE	BY

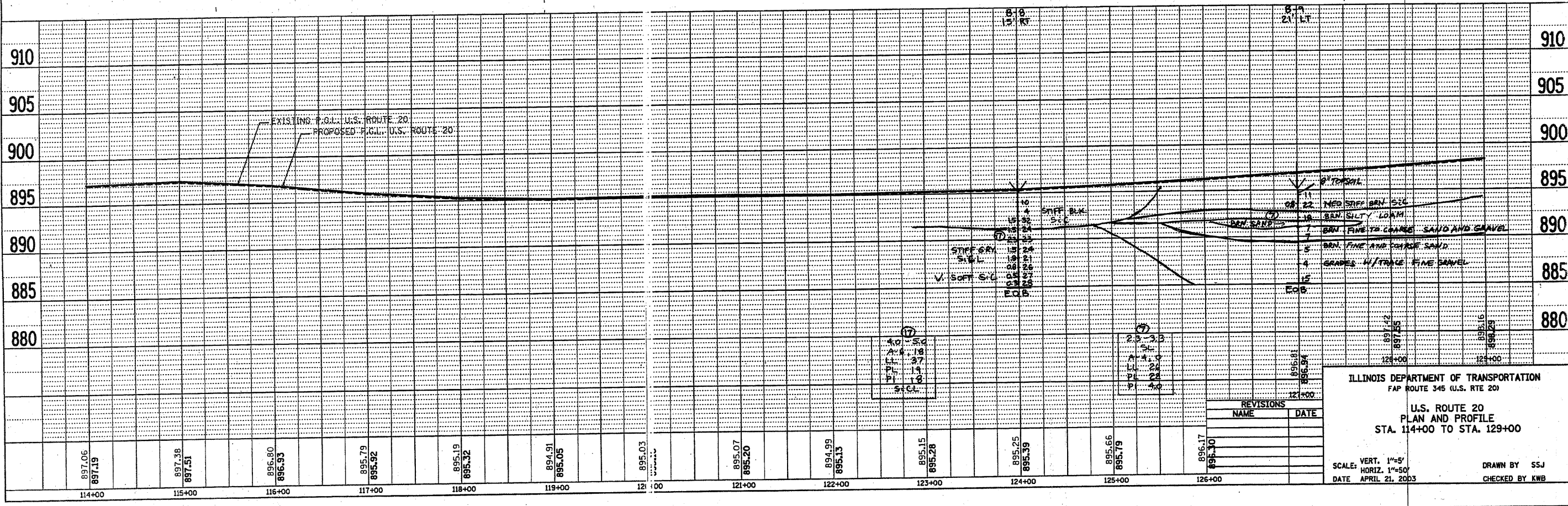

ILLINOIS DEPARTMENT OF TRANSPORTATION
 FAP ROUTE 345 (U.S. RTE 20)
**U.S. ROUTE 20
 PLAN AND PROFILE**
 STA. 114+00 TO STA. 129+00

SCALE: VERT. 1"=5'
 HORIZ. 1"=50'
 DATE: APRIL 21, 2003

DRAWN BY: SSJ
 CHECKED BY: KWB