

PROVIDE TEMPORARY INFORMATION SIGNS AT THE LOCATIONS DESIGNATED BY THE ENGINEER. SEE TC-22 ARTERIAL INFORMATION SIGN DETAIL.

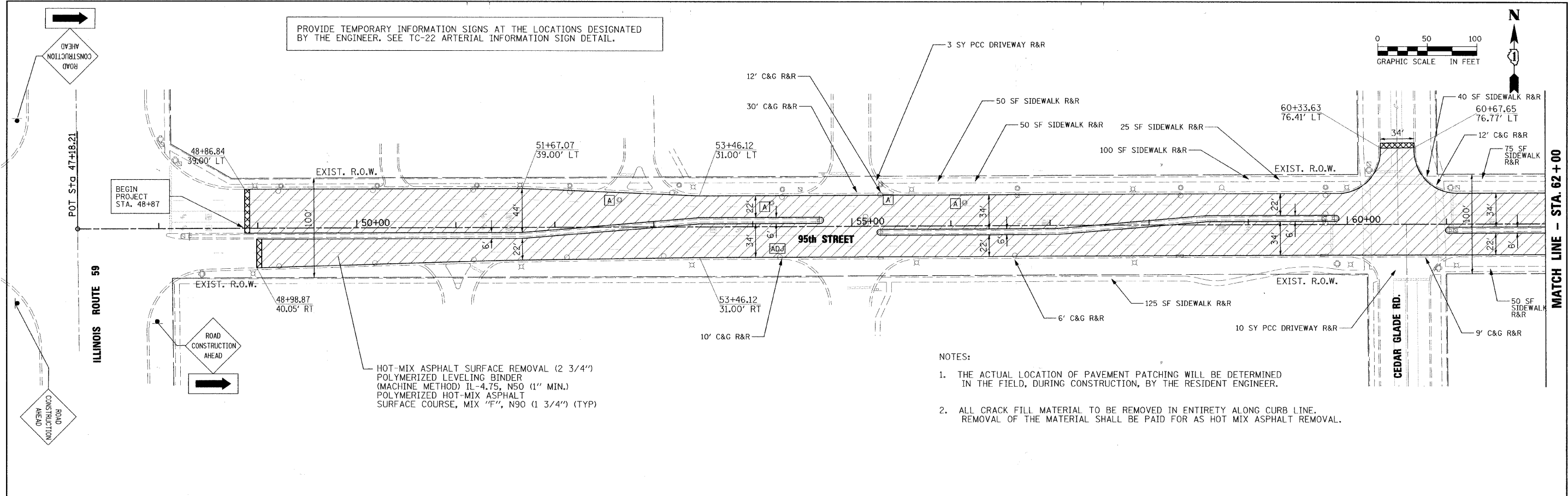

HOT-MIX ASPHALT SURFACE REMOVAL (2 3/4")
 POLYMERIZED LEVELING BINDER
 (MACHINE METHOD) IL-4.75, N50 (1" MIN.)
 POLYMERIZED HOT-MIX ASPHALT
 SURFACE COURSE, MIX "F", N90 (1 3/4") (TYP)

- NOTES:
1. THE ACTUAL LOCATION OF PAVEMENT PATCHING WILL BE DETERMINED IN THE FIELD, DURING CONSTRUCTION, BY THE RESIDENT ENGINEER.
 2. ALL CRACK FILL MATERIAL TO BE REMOVED IN ENTIRETY ALONG CURB LINE. REMOVAL OF THE MATERIAL SHALL BE PAID FOR AS HOT MIX ASPHALT REMOVAL.

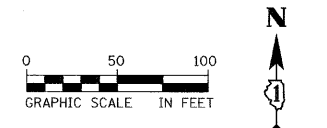
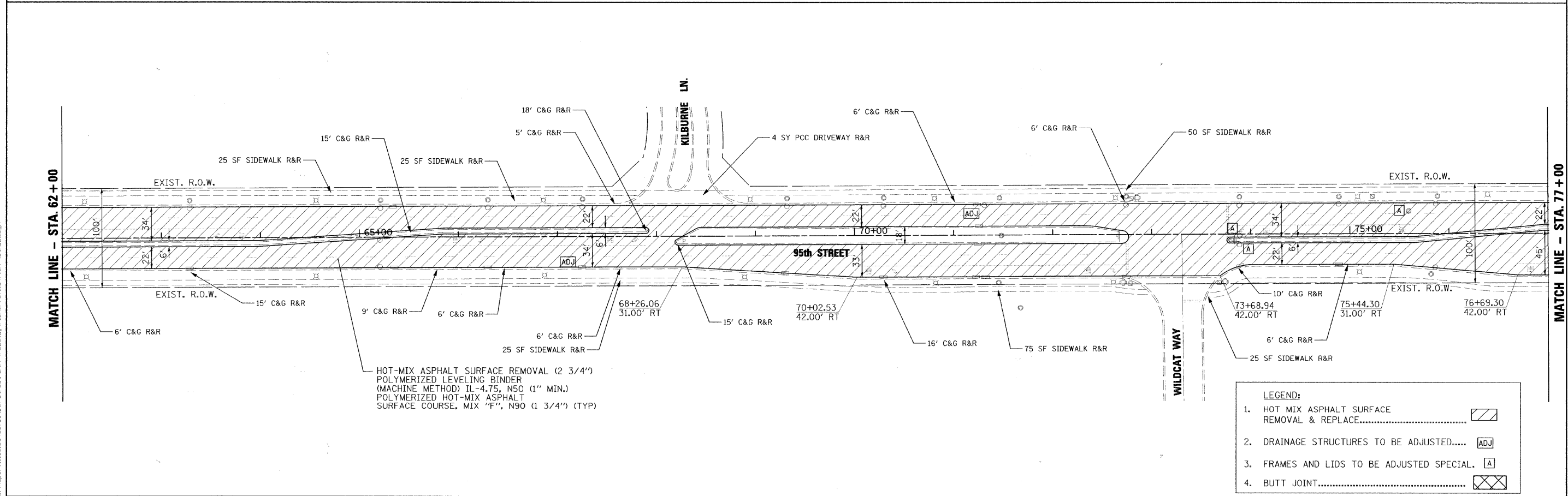

HOT-MIX ASPHALT SURFACE REMOVAL (2 3/4")
 POLYMERIZED LEVELING BINDER
 (MACHINE METHOD) IL-4.75, N50 (1" MIN.)
 POLYMERIZED HOT-MIX ASPHALT
 SURFACE COURSE, MIX "F", N90 (1 3/4") (TYP)

LEGEND:

1. HOT MIX ASPHALT SURFACE REMOVAL & REPLACE.....	
2. DRAINAGE STRUCTURES TO BE ADJUSTED.....	ADJ
3. FRAMES AND LIDS TO BE ADJUSTED SPECIAL.	A
4. BUTT JOINT.....	

FILE NAME = D:\Maperville_12345678_35th_Street_LAPP_Roadway_V10-8-Prj\F1a\F1a-95thRd.dgn



USER NAME = #USER#
 PLOT SCALE = 50.0000' / IN.
 PLOT DATE = 4/5/2010 1:15:31 PM

DESIGNED - KM
 DRAWN - KM
 CHECKED - MHL
 DATE - 3/1/10

REVISED -
 REVISED -
 REVISED -
 REVISED -

STATE OF ILLINOIS
 DEPARTMENT OF TRANSPORTATION

PROPOSED ROADWAY PLAN
 SCALE: 1" = 50 ft SHEET NO. 1 OF 4 SHEETS STA. 48+87.00 TO STA. 77+00.00

F.A.U. RTE.	SECTION	COUNTY	TOTAL SHEETS	SHEET NO.
1644	09-00142-00-RS	WILL	22	5
FED. ROAD DIST. NO. 1 [ILLINOIS] FED. AID PROJECT			CONTRACT NO. 63244	