

STAGE 1A

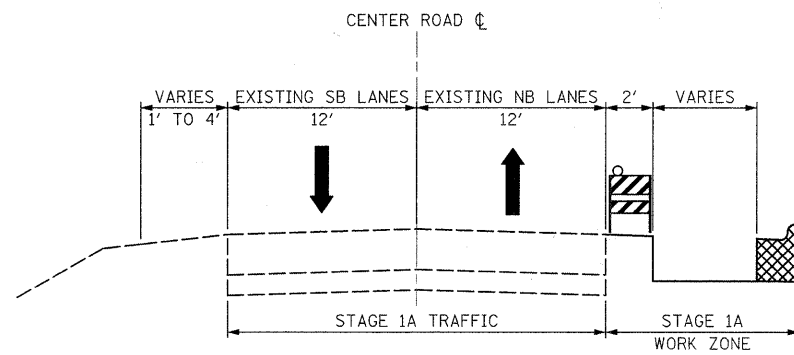

DURING STAGE 1A, BOTH NORTHBOUND (NB) AND SOUTHBOUND (SB) LANES SHALL REMAIN OPEN TO TRAFFIC. THE CONTRACTOR WILL BE ABLE TO INSTALL CURB AND GUTTER, WHERE APPLICABLE, SIDEWALK, DRAINAGE STRUCTURES AND SEWER LATERALS.

HIGHWAY STANDARDS: 701001-02, 701006-03, 701011-02, 701301-03, 701336-05, 701901-01

STAGE 1B

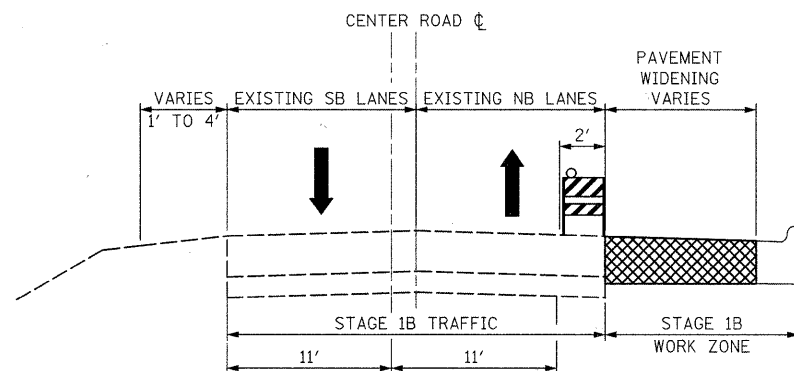

DURING STAGE 1B, THE NORTHBOUND AND SOUTHBOUND TRAFFIC LANE WIDTH SHALL BE REDUCED TO 11 FEET WHERE NECESSARY. THE CONTRACTOR WILL BE ABLE TO EXCAVATE AND PLACE SUBBASE, BASE, AND BINDER COURSES FOR THE PAVEMENT WIDENING AND GRADE THE PARKWAYS AS REQUIRED. THE CONTRACTOR SHALL CLOSE THE NB TRAVEL LANES, AS APPROVED BY THE ENGINEER, TO GRIND THE EXISTING PAVEMENT AND PATCH TO THE REQUIRED DEPTH AS NECESSARY. THE REQUIRED GRINDING DEPTH WILL BE ACHIEVED BY HMA SURFACE REMOVAL - VARIABLE DEPTH. DURING DAY TIME OPERATIONS FLAGGERS SHALL BE USED TO CONTROL TRAFFIC IN LOCATIONS WHERE THE TRAFFIC WIDTH IS LESS THAN 20 FEET AT ANY TIME. THE CONTRACTOR SHALL ENSURE THAT TWO LANES SHALL BE PROVIDED AT ALL TIMES AT NIGHT.

HIGHWAY STANDARDS: 701001-02, 701006-03, 701011-02, 701301-03, 701501-05, 701901-01

STAGE 2A

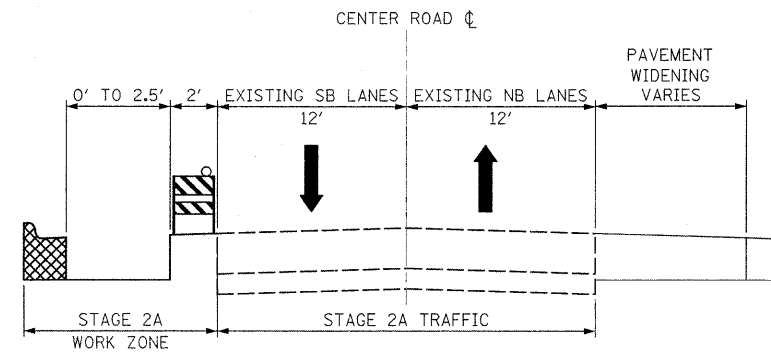

DURING STAGE 2A, BOTH NORTHBOUND (NB) AND SOUTHBOUND (SB) LANES SHALL REMAIN OPEN TO TRAFFIC. THE CONTRACTOR WILL BE ABLE TO INSTALL CURB AND GUTTER, WHERE APPLICABLE, SIDEWALK, DRAINAGE STRUCTURES AND SEWER LATERALS.

HIGHWAY STANDARDS: 701001-02, 701006-03, 701011-02, 701301-03, 701801-04, 701336-05, 701901-01

STAGE 2B

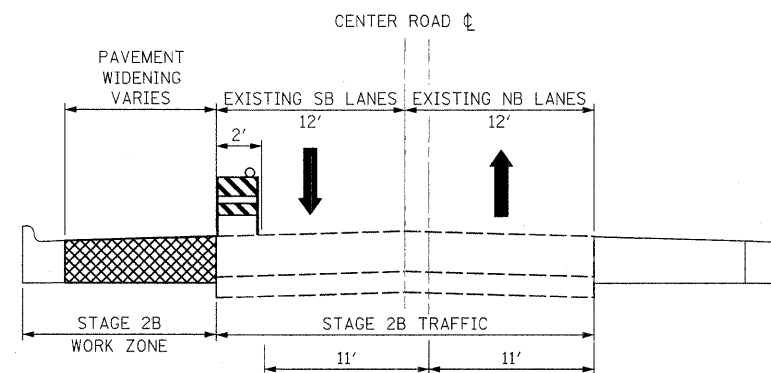

DURING STAGE 2B, THE NORTHBOUND AND SOUTHBOUND TRAFFIC LANE WIDTHS SHALL BE REDUCED TO 11 FEET WHERE NECESSARY. THE CONTRACTOR WILL BE ABLE TO EXCAVATE AND PLACE SUBBASE, BASE, AND BINDER COURSES FOR THE PAVEMENT WIDENING AND GRADE PARKWAYS AS REQUIRED. THE CONTRACTOR SHALL CLOSE THE SB TRAVEL LANES, AS APPROVED BY THE ENGINEER, TO GRIND THE EXISTING PAVEMENT AND PATCH TO THE REQUIRED DEPTH AS NECESSARY. THE REQUIRED GRINDING DEPTH WILL BE ACHIEVED BY HMA SURFACE REMOVAL - VARIABLE DEPTH. DURING DAY TIME OPERATIONS FLAGGERS SHALL BE USED TO CONTROL TRAFFIC IN LOCATIONS WHERE THE TRAFFIC WIDTH IS LESS THAN 20 FEET AT ANY TIME. THE CONTRACTOR SHALL ENSURE THAT TWO LANES SHALL BE PROVIDED AT ALL TIMES AT NIGHT.

HIGHWAY STANDARDS: 701001-02, 701006-03, 701011-02, 701301-03, 701501-05, 701801-04, 701901-01

GENERAL NOTES

- ONE LANE OF TRAFFIC IN EACH DIRECTION SHALL BE MAINTAINED AT ALL TIMES.
- THE MAXIMUM ALLOWABLE LANE DROP DIFFERENTIAL ALLOWED WILL BE 2".
- DETOURS ARE NOT ANTICIPATED BUT WILL BE ALLOWED IF APPROVED BY THE VILLAGE OF FRANKFORT. THEIR COST WILL BE INCLUDED IN THE TRAFFIC CONTROL AND PROTECTION PAY ITEM. CENTER ROAD DETOURS SHALL BE INSTALLED ACCORDING TO THE LATEST MANUAL ON UNIFORM TRAFFIC CONTROL DEVICES MANUAL AND APPLICABLE IDOT HIGHWAY STANDARDS.
- SIDE ROAD ACCESS MUST BE MAINTAINED DURING CONSTRUCTION. TEMPORARY PAVEMENT QUANTITY IS INCLUDED TO RE-ESTABLISH CROSS TRAFFIC FOLLOWING THE GRINDING OPERATION. TEMPORARY RAMPS AND A SUITABLE DRIVING SURFACE SHALL BE PROVIDED FOR CROSS TRAFFIC IMMEDIATELY FOLLOWING GRINDING ACROSS AN INTERSECTION.
- ANY SIDEWALK CLOSURES REQUIRED ALONG THE PROJECT CORRIDOR SHALL BE DONE ACCORDING TO THE LATEST REVISION OF HIGHWAY STANDARDS.
- THE CONTRACTOR WILL BE REQUIRED TO SUBMIT DETAILED WORK SCHEDULES FOR EACH LOCATION ALONG THE PROJECT CORRIDOR. THE SCHEDULES SHALL BE APPROVED BY THE VILLAGE OF FRANKFORT AND THE ENGINEER PRIOR TO THE CONTRACTOR STARTING WORK IN ANY AREA.
- WEEKLY PROGRESS MEETINGS SHALL BE HELD BY THE CONTRACTOR TO UPDATE THE VILLAGE AND RESIDENTS.

FILE NAME = s:\j\16280-6559\6228-084\micro\Sheet1.mxd



1170 SOUTH HOUBOLT ROAD
JOLIET, ILLINOIS 60431
(815) 744-4200

USER NAME = adam	DESIGNED -	REVISED -
PLOT SCALE = 50.0000' / IN.	DRAWN -	REVISED -
PLOT DATE = 3/31/22	CHECKED -	REVISED -
	DATE -	REVISED -

STATE OF ILLINOIS
DEPARTMENT OF TRANSPORTATION

SUGGESTED STAGES OF CONSTRUCTION

SCALE: AS SHOWN SHEET NO. OF SHEETS STA. TO STA.

F.A.U. RTE.	SECTION	COUNTY	TOTAL SHEETS	SHEET NO.
3759	04-00038-00-WR	WILL	165	35
CONTRACT NO. 63248				

FED. ROAD DIST. NO. ILLINOIS FED. AID PROJECT