

SILVER LAKE ROAD

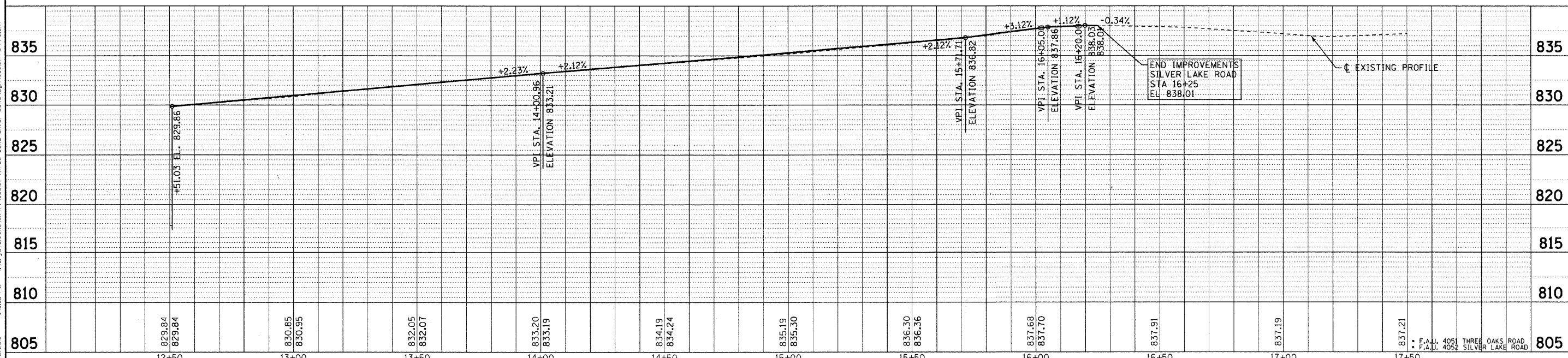

COPYRIGHT © 2010 BY BAXTER & WOODMAN, INC.
 STATE OF ILLINOIS - PROFESSIONAL DESIGN FIRM
 265 POND
 3/27/2010
 I:\Crystal\Lenox\ARRA\060197-Three Oaks Silver Lake\pp6.dwg
 I:\Crystal\Lenox\ARRA\060197-Three Oaks Silver Lake\pp6.dwg



DESIGNED - MWP/DSH	REVISED - 01-04-10 PER IDOT
DRAWN - MAC	REVISED - 03-01-10 PER IDOT
CHECKED - RWL	REVISED -
DATE - 03-01-10	FILE - 060197-P2-PP6.shx

VILLAGE OF CARY, ILLINOIS THREE OAKS ROAD AND SILVER LAKE ROAD ARRA INTERSECTION IMPROVEMENTS

**PLAN & PROFILE
SILVER LAKE ROAD**

SCALE: H: 1"=20' V: 1"=5'

STA. 12+50 TO STA. 17+50

F.A.U. RTE.	SECTION	COUNTY	TOTAL SHEETS	SHEET NO.
	09-00058-00-CH	MCHENRY	53	16
C-91-511-10			CONTRACT NO. 63381	
FED. ROAD DIST. NO. 1 ILLINOIS			FED. AID PROJECT: ARA-9003(635)	