

COPYRIGHT © 2009 BY BAYTER & WOODMAN, INC.
 STATE OF ILLINOIS - PROFESSIONAL DESIGN FIRM
 2650 N. WILSON AVENUE, SUITE 100, DEERFIELD, IL 60015
 847.940.1000 FAX 847.940.1001
 3/2/2010 4:50:46 PM
 U:\C\CrystalLake\ARRA\6057-Three Oaks Silver Lake.dgn\6057-P2-AS-SilverLake.dgn

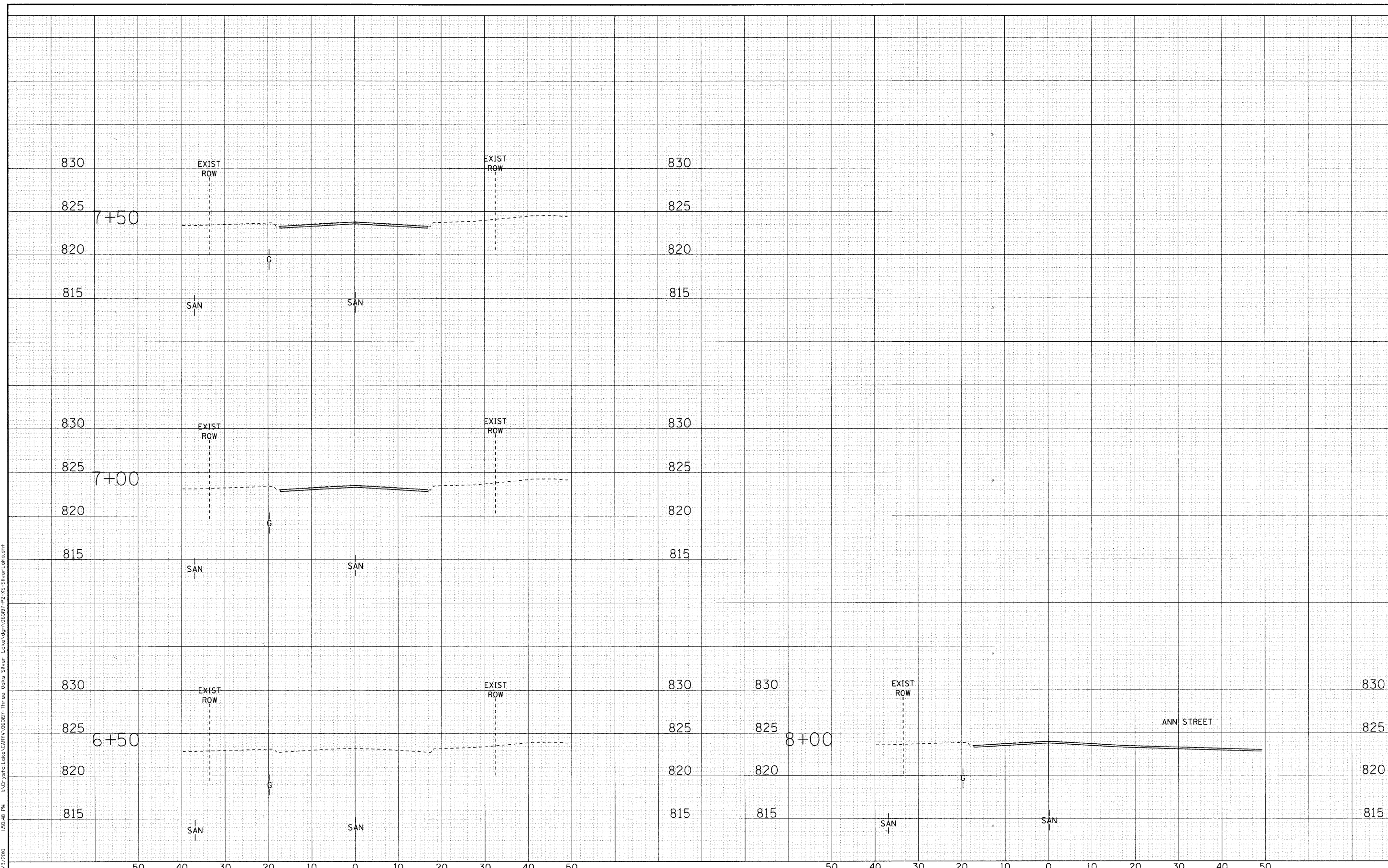

DESIGNED - MWP/DSH	REVISED - 03-01-10 PER IDOT
DRAWN - MAC	REVISED -
CHECKED - RWL	REVISED -
DATE - 03-01-10	REVISED -

VILLAGE OF CARY, ILLINOIS
THREE OAKS ROAD AND SILVER LAKE ROAD
ARRA INTERSECTION IMPROVEMENTS

CROSS SECTIONS
SILVER LAKE ROAD
 SCALE: H: 1"=10' V: 1"=5'
 STA. 6+50 TO STA. 8+00

F.A.U. RTE.	SECTION	COUNTY	TOTAL SHEETS	SHEET NO.
•	09-00058-00-CH	McHENRY	53	50
	C-91-511-10		CONTRACT NO. 63381	
FED. ROAD DIST. NO.		ILLINOIS FED. AID PROJECT ARA-900316351		

• F.A.U. 4051 THREE OAKS ROAD • F.A.U. 4052 SILVER LAKE ROAD