

REMOVAL PLAN

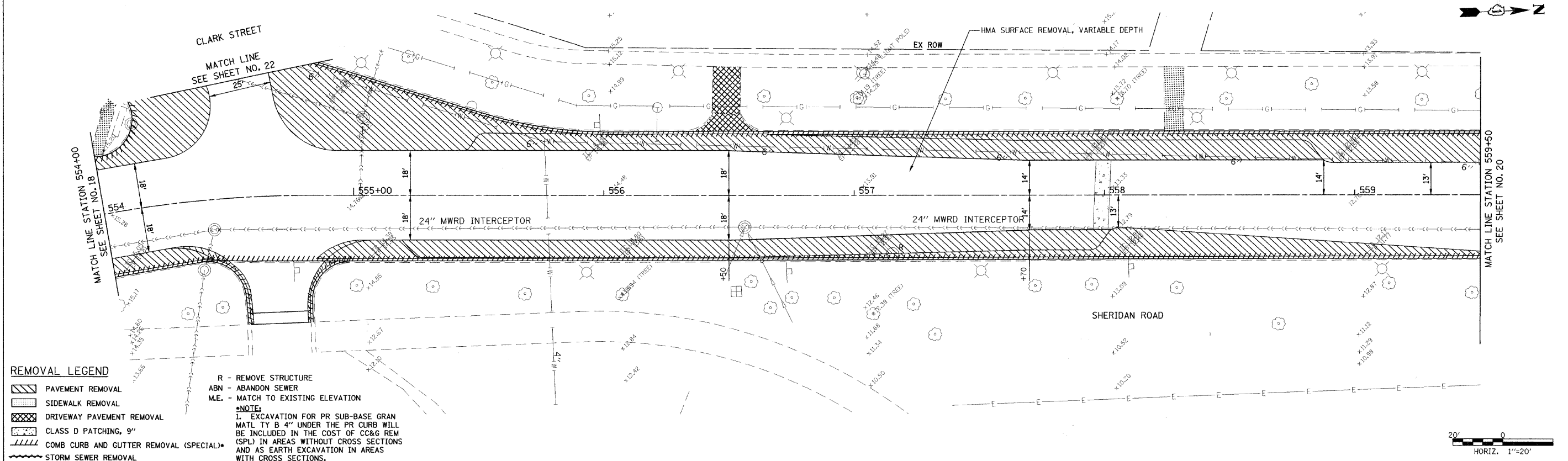

REMOVAL LEGEND

- PAVEMENT REMOVAL
- SIDEWALK REMOVAL
- DRIVEWAY PAVEMENT REMOVAL
- CLASS D PATCHING, 9"
- COMB CURB AND GUTTER REMOVAL (SPECIAL)
- STORM SEWER REMOVAL

R - REMOVE STRUCTURE
 ABN - ABANDON SEWER
 M.E. - MATCH TO EXISTING ELEVATION

NOTE:
 1. EXCAVATION FOR PR SUB-BASE GRAN MATL TY B 4" UNDER THE PR CURB WILL BE INCLUDED IN THE COST OF CC&G REM (SPL) IN AREAS WITHOUT CROSS SECTIONS AND AS EARTH EXCAVATION IN AREAS WITH CROSS SECTIONS.

PROP. CURVE SHER3-5
 PI STA. = 554+44.12
 $\Delta = 9^\circ 46' 33''$ (RT)
 $D = 12^\circ 43' 57''$
 $R = 450.00'$
 $T = 38.48'$
 $L = 76.78'$
 $E = 1.64'$
 $e = \dots$
 $T.R. = \dots$
 $S.E. RUN = \dots$
 $P.C. STA = 554+05.63$
 $P.T. STA = 554+82.41$

- NOTE:
 1. 5' TRANSITION FROM B-6.12 C&G TO MATCH EX TO BE PAID FOR AS COMB CONC C&G TY B-6.12 (SPECIAL)
 2. SEE PAVING DETAILS FOR MILLING DEPTHS AND HMA LEVEL BINDER AND BINDER DEPTHS (SHEETS 40 AND 41)
 3. INSTALL STRIP REFLECTIVE CRACK CONTROL TREATMENT ALONG EXISTING LONGITUDINAL PAVEMENT JOINTS

IMPROVEMENT PLAN

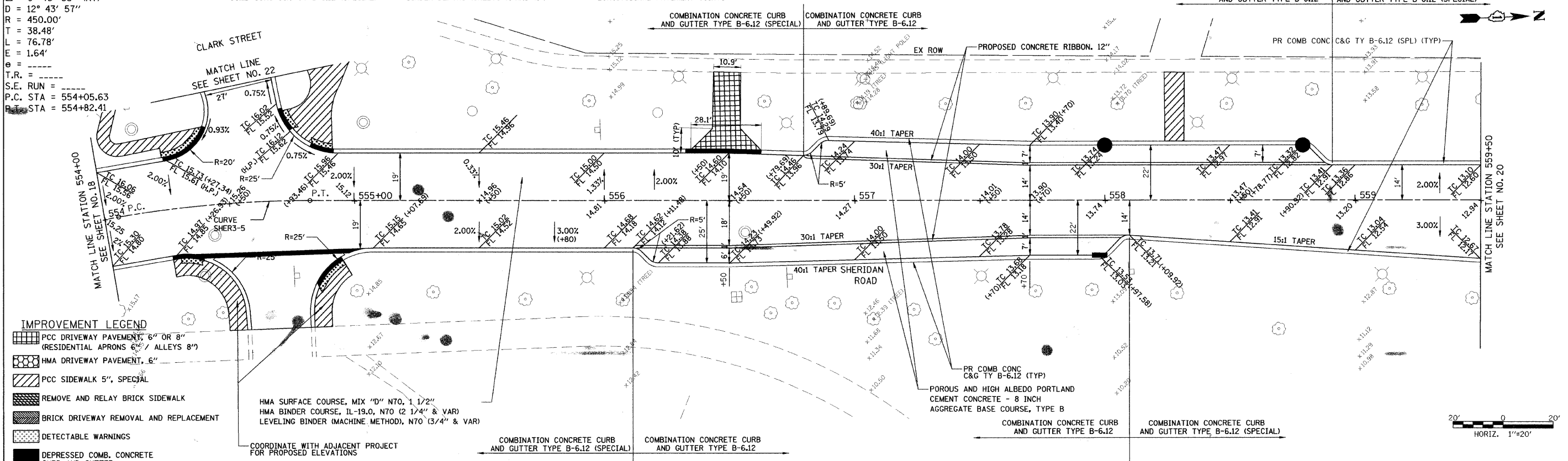

IMPROVEMENT LEGEND

- PCC DRIVEWAY PAVEMENT, 6" OR 8" (RESIDENTIAL APRONS 6" / ALLEYS 8")
- HMA DRIVEWAY PAVEMENT, 6"
- PCC SIDEWALK 5", SPECIAL
- REMOVE AND RELAY BRICK SIDEWALK
- BRICK DRIVEWAY REMOVAL AND REPLACEMENT
- DETECTABLE WARNINGS
- DEPRESSED COMB. CONCRETE CURB AND GUTTER

HMA SURFACE COURSE, MIX "D" N70, 1 1/2"
 HMA BINDER COURSE, 1L-19.0, N70 (2 1/4" & VAR)
 LEVELING BINDER (MACHINE METHOD), N70 (3/4" & VAR)

COORDINATE WITH ADJACENT PROJECT FOR PROPOSED ELEVATIONS

STATE OF ILLINOIS
 DEPARTMENT OF TRANSPORTATION

SHERIDAN ROAD / FOREST AVENUE
 REMOVAL AND IMPROVEMENT PLAN

| | | | | | | | | | | |
|----------------------|--------------------|-------------------|-----------|---|--|--------------------|------------------------|-------------|-----------------|--------------|
| FILE NAME = #FILEL# | USER NAME = #USER# | DESIGNED - CEC | REVISED - | STATSTATE OF ILLINOIS DEPARTMENT OF TRANSPORTATION | SCALE: SHEET NO. 7 OF 10 SHEETS STA. TO STA. | F.A.U. RTE. 2865 | SECTION 08-00250-02-PV | COUNTY COOK | TOTAL SHEETS 79 | SHEET NO. 19 |
| | | DRAWN - NFT | REVISED - | | | CONTRACT NO. 63417 | | | | |
| PLOT SCALE = #SCALE# | | CHECKED - DWB | REVISED - | | | | | | | |
| PLOT DATE = #DATE# | | DATE - 04/09/2010 | REVISED - | | | | | | | |

