

HORIZONTAL CONTROL POINTS						
CP NO.	NORTHING (Y)	EASTING (X)	DESCRIPTION	ELEV.	STATION	OFFSET
CP 1010	1,911,684.57	1,101,344.87	CP-REBAR	653.28	11+50.06	1.03' RT
CP 1009	1,911,569.24	1,101,652.41	CP-XCUT	649.59	14+90.66	33.21' LT
CP 1008	1,911,475.36	1,102,149.81	CP-XCUT	648.39	20+11.07	35.42' RT
CP 1007	1,911,558.95	1,102,530.70	CP-XCUT	654.92	23+94.30	36.68' LT
CP 1006	1,911,503.19	1,102,982.85	CP-XCUT	649.30	28+44.57	32.65' RT
CP 1005	1,911,585.79	1,103,562.18	CP-XCUT	645.25	34+26.12	32.50' LT
CP 2573	1,911,529.79	1,104,010.98	CP-REBAR	643.46	38+73.04	36.97' RT
CP 1004	1,911,524.13	1,104,031.12	CP-XCUT	643.82	38+93.00	43.23' RT
CP 6271	1,911,536.02	1,104,097.69	CP-XCUT	644.66	39+59.90	33.35' RT
CP 1003	1,911,618.54	1,104,668.39	CP-XCUT	643.43	45+32.82	31.97' LT
CP 1002	1,911,755.16	1,105,184.55	CP-XCUT	643.24	51+10.96	40.79' RT
CP 1001	1,911,839.99	1,105,700.13	CP-XCUT	642.47	56+30.52	26.80' LT
CP 1000	1,911,865.73	1,106,478.56	CP-XCUT	643.23	64+09.38	26.75' LT

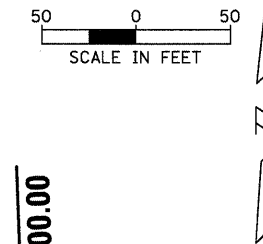

MATCH LINE 40 + 00.00

MATCH LINE 54 + 00.00

MATCH LINE 54 + 00.00

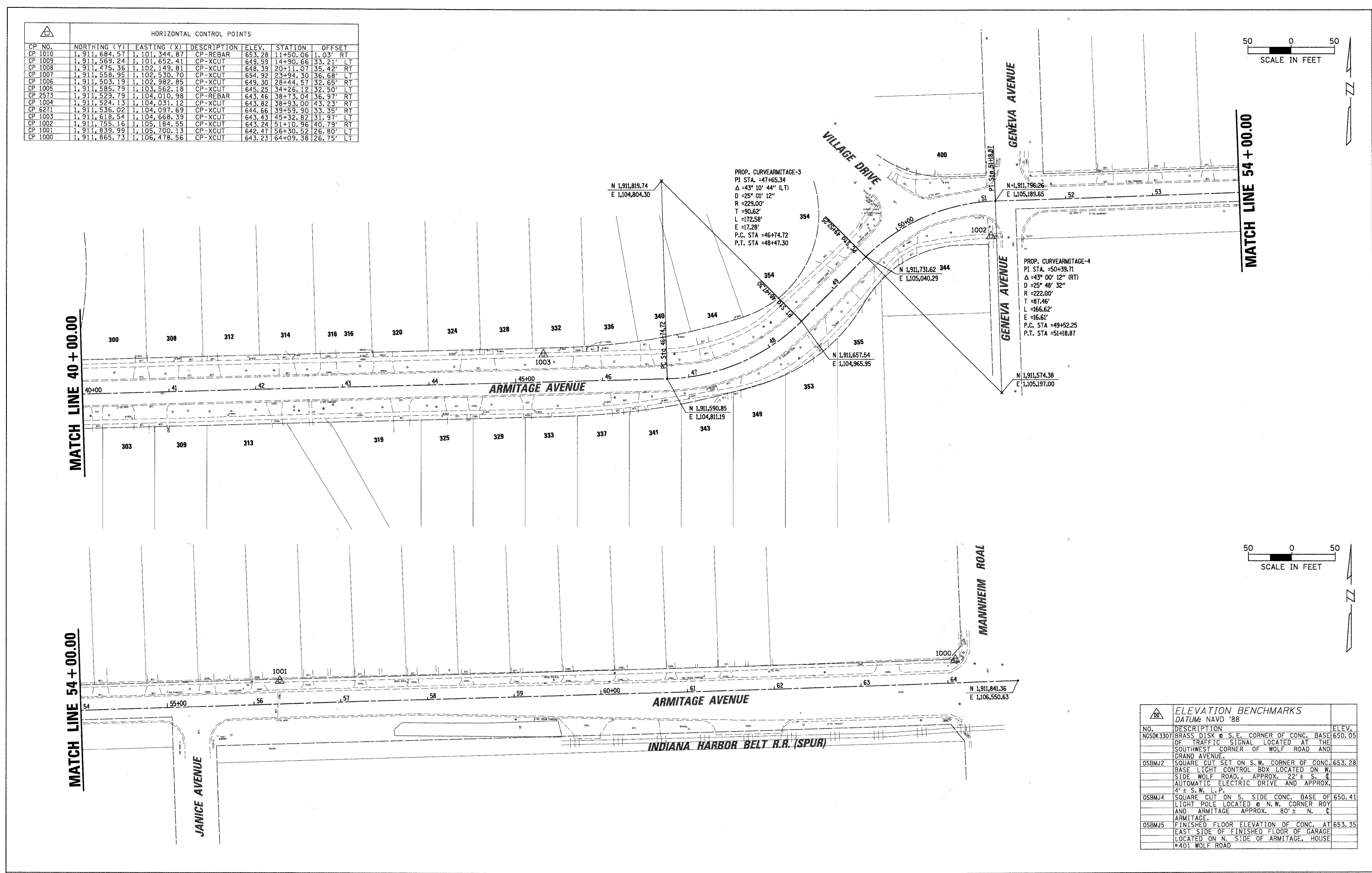
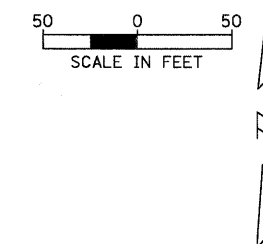

PROP. CURVE ARMITAGE-3
 PI STA. = 47+65.34
 $\Delta = 43^\circ 10' 44''$ (LT)
 $D = 25^\circ 01' 12''$
 $R = 229.00'$
 $T = 90.62'$
 $L = 172.58'$
 $E = 17.28'$
 P.C. STA = 46+74.72
 P.T. STA = 48+47.30

PROP. CURVE ARMITAGE-4
 PI STA. = 50+39.71
 $\Delta = 43^\circ 00' 12''$ (RT)
 $D = 25^\circ 48' 32''$
 $R = 222.00'$
 $T = 87.46'$
 $L = 166.62'$
 $E = 16.61'$
 P.C. STA = 49+52.25
 P.T. STA = 51+18.87

ELEVATION BENCHMARKS		
DATUM: NAVD '88		
NO.	DESCRIPTION	ELEV.
NGSOK3307	BRASS DISK @ S.E. CORNER OF CONC. BASE OF TRAFFIC SIGNAL LOCATED AT THE SOUTHWEST CORNER OF WOLF ROAD AND GRAND AVENUE.	650.05
OSBMJ2	SQUARE CUT SET ON S.W. CORNER OF CONC. BASE LIGHT CONTROL BOX LOCATED ON W. SIDE WOLF ROAD, APPROX. 22' ± S. OF AUTOMATIC ELECTRIC DRIVE AND APPROX. 4' ± S.W. L.P.	653.28
OSBMJ4	SQUARE CUT ON S. SIDE CONC. BASE OF LIGHT POLE LOCATED @ N.W. CORNER ROY AND ARMITAGE APPROX. 80' ± N. OF ARMITAGE.	650.41
OSBMJ5	FINISHED FLOOR ELEVATION OF CONC. AT EAST SIDE OF FINISHED FLOOR OF GARAGE LOCATED ON N. SIDE OF ARMITAGE, HOUSE #401 WOLF ROAD	653.35