

PROJECT STAGING & LOCAL ACCESS

1. ACCESS MUST BE MAINTAINED AT ALL TIMES TO AT LEAST ONE OF THE FOLLOWING PARKING LOCATIONS FOR THE PUBLIC LIBRARY:
 - A. ON STREET PARKING ON BROADWAY
 - B. PARKING LOT FACILITIES
2. THE TRENCHES FOR STORM SEWER LATERALS SHALL BE BACKFILLED TO THE TOP OF THE EXISTING PAVEMENT TO PROVIDE LOCAL ACCESS.
3. THE CONTRACTOR SHALL BE RESPONSIBLE FOR BAGGING ALL REGULATORY SIGNS THAT ARE NOT APPLICABLE DURING CONSTRUCTION.
4. TEMPORARY STONE RAMPS SHALL BE PROVIDED TO ALL DRIVEWAYS WITHIN THE LIMITS OF THE RECONSTRUCTION (TO BE PAID FOR UNDER THE ITEM: AGGREGATE SURFACE COURSE, TYPE B).

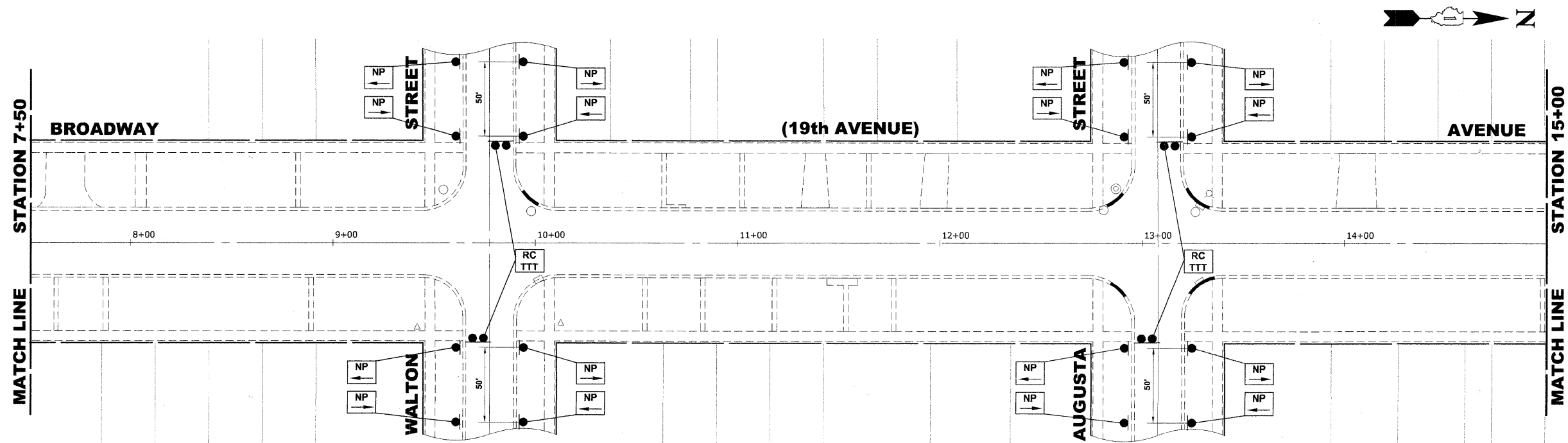

Drawing file: W:\Projects\60090001 - Broadway Ave Reconstruction\BROADWAY_MISS.dwg Mar 29, 2010 - 11:35am



9811 Broadway Road
Waukegan, IL 60087-2786
Phone: 815-494-2786
Fax: 815-494-2722

USER NAME -	DESIGNED - WOP	REVISED -
PLOT SCALE -	DRAWN - MK/LEV/DMM	REVISED -
PLOT DATE -	CHECKED - WOP	REVISED -
	DATE - 3-29-10	REVISED -

**STATE OF ILLINOIS
DEPARTMENT OF TRANSPORTATION**

LOCAL ACCESS SIGNING PLAN

SCALE: 1" = 30' SHEET NO. 1 OF 2 SHEETS STA. 1+02 TO STA. 15+00

ROUTE NO.	SECTION	COUNTY	TOTAL SHEETS	SHEET NO.
2406	09-00114-00-FP	COOK	33	9
FIELD BOOK NO. 1588/AERIALS/LL		CONTRACT NO. 63455		
FED. ROAD DIST. NO. 1 ILLINOIS		FED. AID PROJECT ARA-M-9003 (516)		

E.H.E. PROJECT NO. 600-09-00101