

IMPROVEMENT BEGINS
STATION 1+02

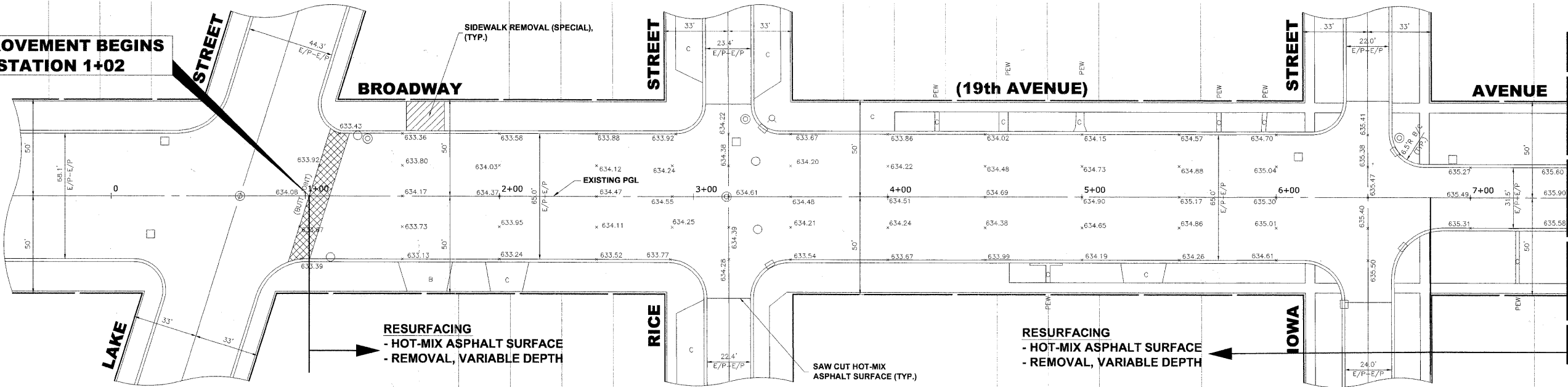

IMPROVEMENT BEGINS
STATION 1+02

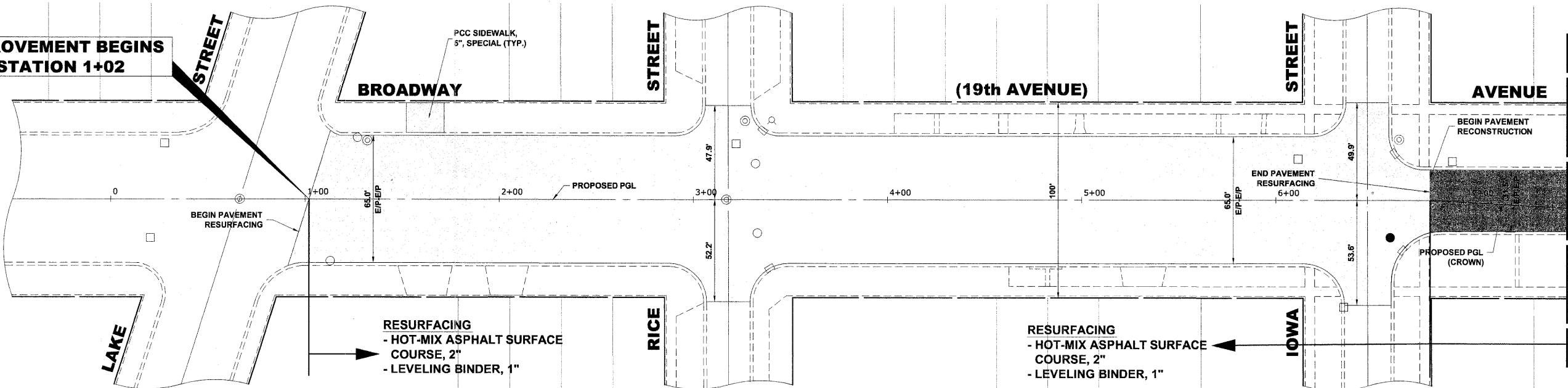

Drawing File: \\K:\Projects\0909001 - Broadway Ave Reconstruction\BROADWAY AVE_BROADWAY AVE.dwg Mar 29, 2010 - 11:30am

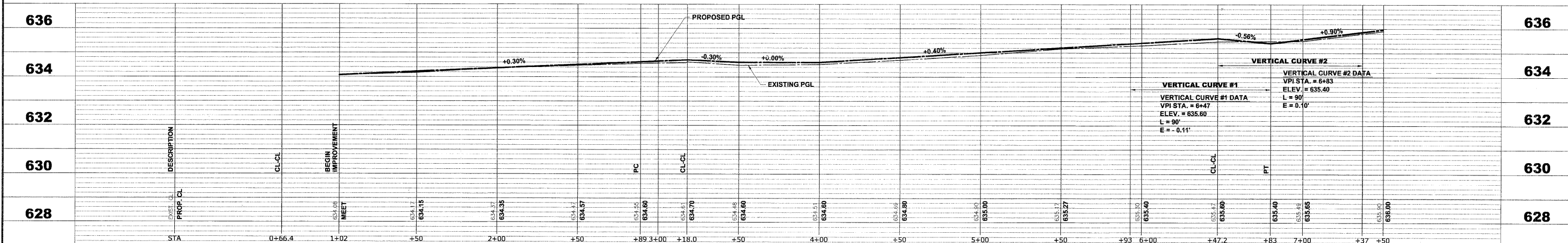

HANCOCK ENGINEERING
Civil Engineers
Municipal Consultants
Established 1911

USER NAME -	DESIGNED - WOP	REVISED -
PLOT SCALE -	DRAWN - MK/LEV/DMM	REVISED -
PLOT DATE -	CHECKED - WOP	REVISED -
	DATE - 3-29-10	REVISED -

**STATE OF ILLINOIS
DEPARTMENT OF TRANSPORTATION**

**BROADWAY AVENUE (19th AVENUE)
PAVING PLAN AND PROFILE**

SCALE: 1"=30'H. & 1"=2'V. SHEET NO. 1 OF 4 SHEETS STA. 1+02 TO STA. 7+50

ROUTE NO. 2406	SECTION 09-00114-00-FP	COUNTY COOK	TOTAL SHEETS 33	SHEET NO. 11
FIELD BOOK NO. 1588/AERIALS/LL		CONTRACT NO. 63455		
FED. ROAD DIST. NO. 1 ILLINOIS		FED. AID PROJECT ARA-M-9003 (516)		

E.H.E. PROJECT NO. 600-09-00101