

**IMPROVEMENT BEGINS
STATION 36+24**

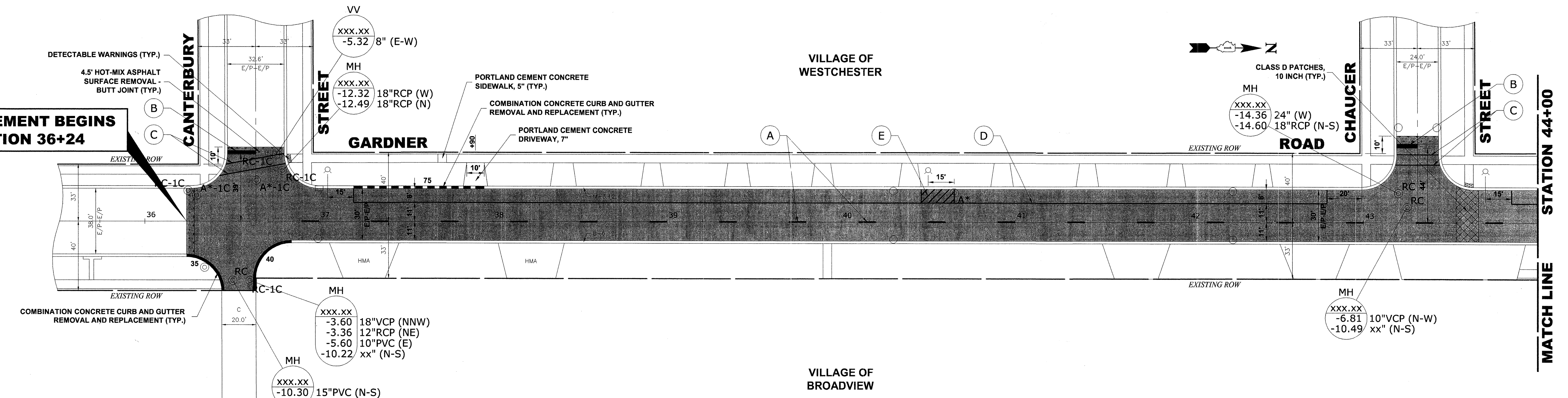

PAVEMENT MARKING LEGEND	
ITEM DESCRIPTION	SYMBOL
THERMOPLASTIC PAVEMENT MARKING LINE 4", CENTER LINE, YELLOW	(A)
THERMOPLASTIC PAVEMENT MARKING LINE 24", STOP BAR, WHITE	(B)
THERMOPLASTIC PAVEMENT MARKING LINE 6", CROSS WALK, WHITE	(C)
THERMOPLASTIC PAVEMENT MARKING LINE 4", PARALLEL PARKING LINE, WHITE	(D)
THERMOPLASTIC PAVEMENT MARKING LINE 4" (@ 3' O.C.), NO PARKING AREA, YELLOW	(E)

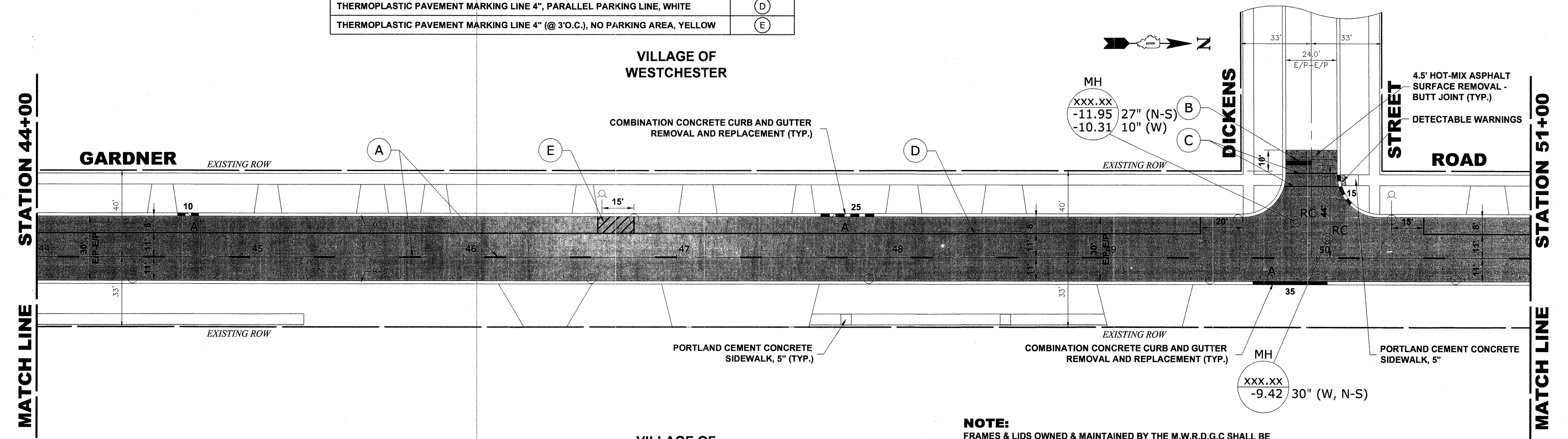

NOTE:
FRAMES & LIDS OWNED & MAINTAINED BY THE M.W.R.D.G.C SHALL BE ADJUSTED (OR RECONSTRUCTED IF NECESSARY) BY THE M.W.R.D.G.C. THE CONTRACTOR SHALL BE RESPONSIBLE FOR COORDINATING THIS WORK WITH THE M.W.R.D.G.C. SO AS TO NOT INTERFERE WITH OR DELAY THE PAVING OPERATIONS.

Drawing file: W:\Projects\83809245 - Gardner Rd Resurf (LAPP)\Gardner Rd LAPP.dwg Mar 29, 2010 - 3:03pm



USER NAME --	DESIGNED -- TG	REVISED --
PLOT SCALE --	DRAWN -- TG	REVISED --
PLOT DATE --	CHECKED -- DT	REVISED --
	DATE -- 03/26/10	REVISED --

**STATE OF ILLINOIS
DEPARTMENT OF TRANSPORTATION**

GARDNER ROAD PAVING PLAN
SCALE: 1" = 30'
SHEET NO. 1 OF 2 SHEETS
STA. 36+24 TO STA. 51+00

P.A.U. RTE.	SECTION	COUNTY	TOTAL SHEETS	SHEET NO.
1005	09-00075-00-RS	COOK	11	5
CONTRACT NO. 63458			FED. ROAD DIST. NO. 1 ILLINOIS	
			FED. AID PROJECT M-9003(578)	