

NOTES:

- 1) PRESTAGE MEDIAN SHOULDER REPAIR WORK SHALL CONSIST OF HMA SURFACE REMOVAL 2", BRIDGE APPROACH SHOULDER REMOVAL AND HMA SHOULDER REMOVAL AT LOCATIONS AS DIRECTED BY ENGINEER, PLACEMENT OF HMA SHOULDER 8" AND PLACEMENT OF SURFACE COURSE MIX "C", N50, 2".
- 2) PRESTAGE WORK SHALL BE DONE UTILIZING DAILY LANE CLOSURE STANDARD 701406, "LANE CLOSURE, FREEWAY/EXPRESSWAY, DAY OPERATIONS ONLY," UNLESS OTHERWISE DIRECTED BY THE ENGINEER.

* TO CLOSE RAMP "F" USE STANDARD 701451

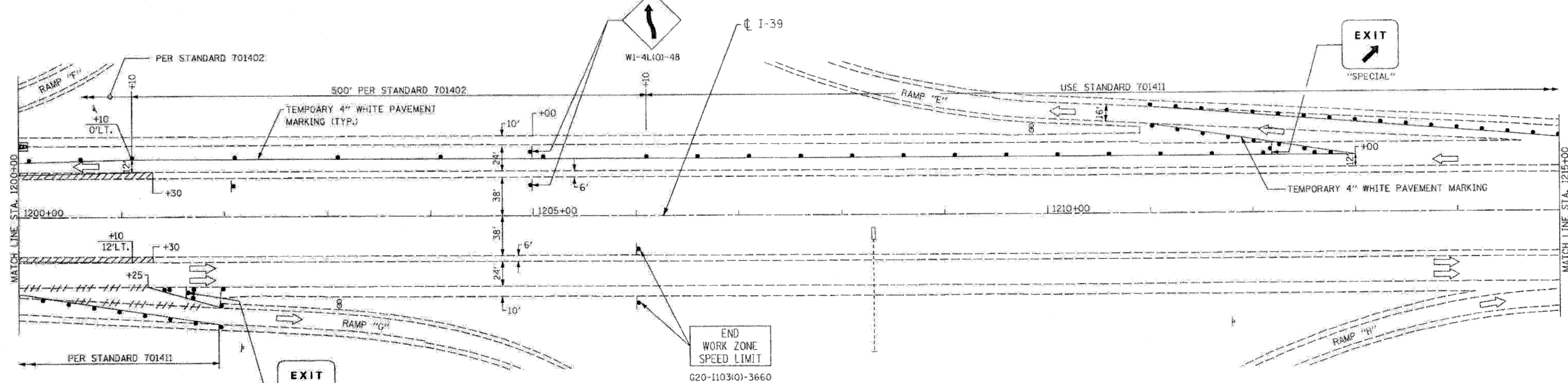
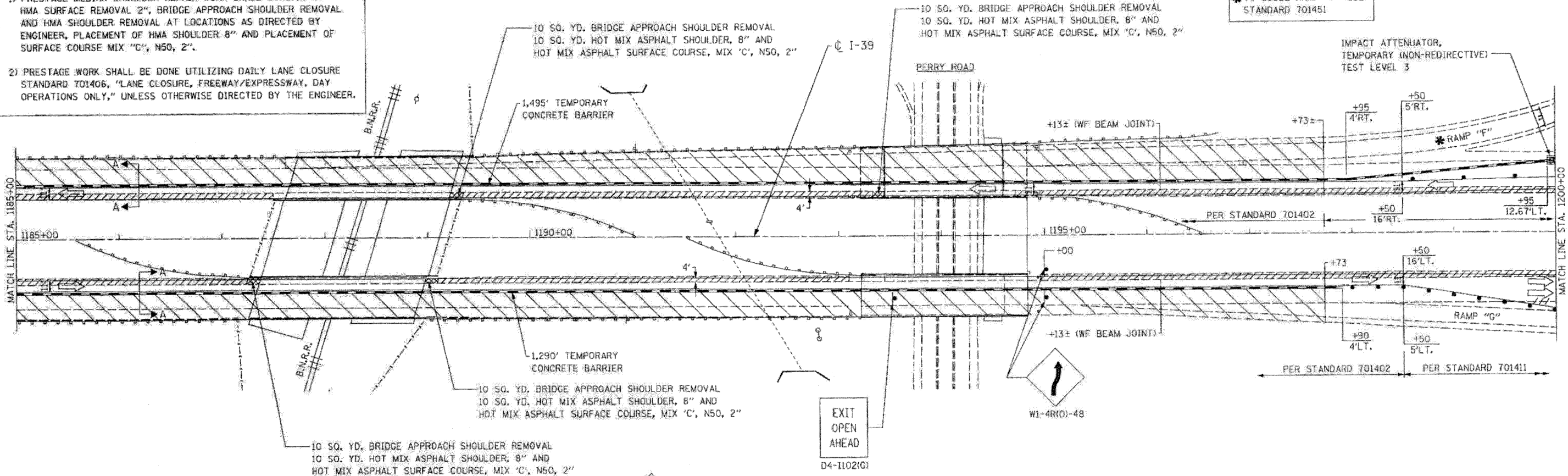

- NOTE:**
1. FOR SECTION A-A SEE SHT. NO. MOT-04.
 2. FOR LEGEND SEE SHT. NO. MOT-04.

DATE	
BY	
FINISHED	
SURVEY	
NOTED	
AREAS	
CHECKED	

DATE	
BY	
FINISHED	
SURVEY	
NOTED	
AREAS	
CHECKED	

FILE NAME: 0264E97-sht-ctgimg05.dgn
 PLOT DATE: 3/29/2010
 PLOT SCALE: 1/8" = 1'-0"

CHRISTIAN-ROGE & ASSOCIATES, INC.
 ENGINEERS-PLANNERS-SURVEYORS
 211 WEST WACKER DRIVE
 CHICAGO, ILLINOIS 60606
 PHONE: (312)372-2023 FAX: (312)372-5274

DESIGNED - E.M.	REVISED -
DRAWN - B.K.	REVISED -
CHECKED - M.P.	REVISED -
DATE - MARCH 2010	REVISED -

**STATE OF ILLINOIS
 DEPARTMENT OF TRANSPORTATION**

**TRAFFIC CONTROL AND PROTECTION
 I-39 - STA. 1185+00 TO STA. 1215+00
 STAGE I**

SCALE:	SHEET NO. OF SHEETS	STA.	TQ STA.
--------	---------------------	------	---------

F.A.I. RTE.	SECTION	COUNTY	TOTAL SHEETS	SHEET NO.
39	(103-1, 103-2)RS	LEE	313	84
FED. ROAD DIST. NO. 1 ILLINOIS FED. AID PROJECT				
CONTRACT NO. 64E97				