

STATE OF ILLINOIS  
DEPARTMENT OF TRANSPORTATION

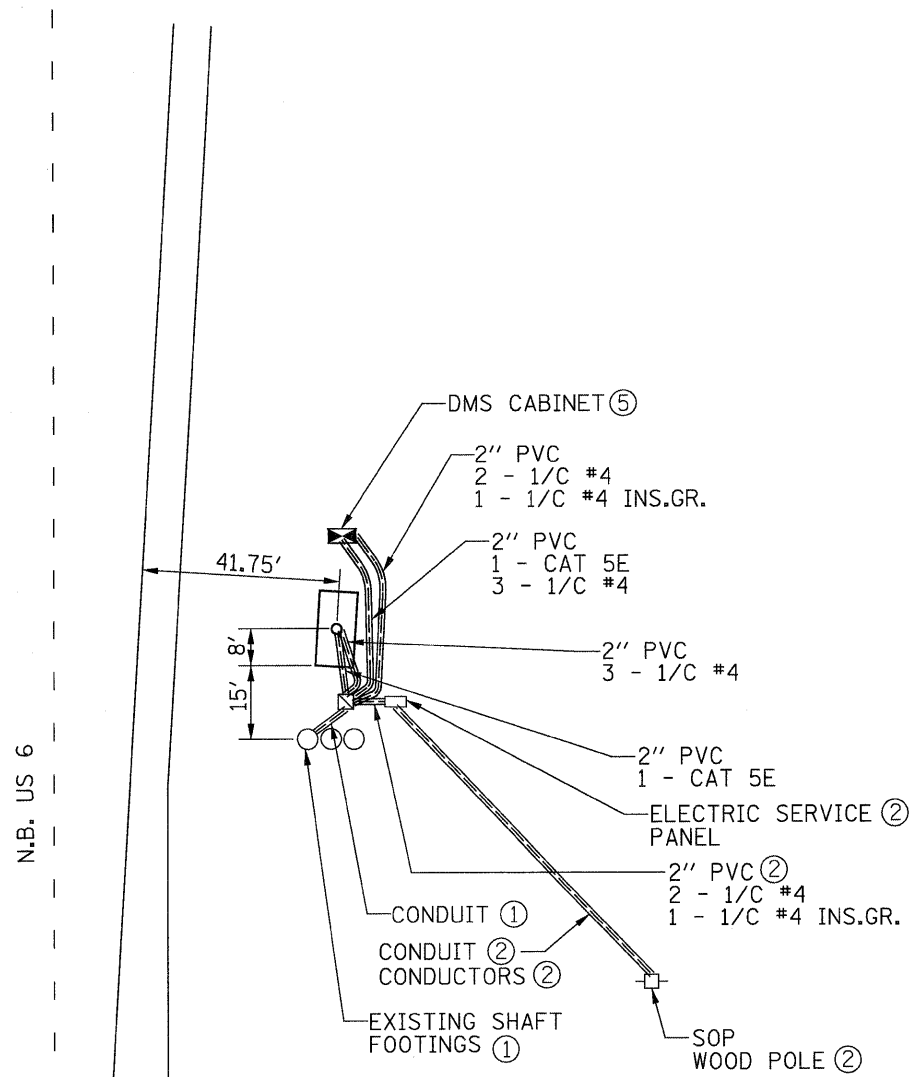

SCALE: 1"=20'



NOTES:

ALL ITEMS ARE FURNISHED AND INSTALLED UNLESS NOTED OTHERWISE.

- ① REMOVE
- ② INPLACE
- ③ SALVAGE
- ④ INSTALL SALVAGED
- ⑤ F & I CONCRETE FOUNDATION  
INSTALL CABINET



*George M. Stuempfig*  
3/8/10

DESIGNED - S. POSKA	2010
CHECKED - G. STUEMPFIG	EXAMINED
DRAWN - M. BRESSLER	PASSED
CHECKED - G. STUEMPFIG	ENGINEER OF BRIDGES AND STRUCTURES

SITE 406  
N.B. US 6 (700' N. OF 6TH AVE/AIRPORT ENTRANCE)

SHEET NO. 13 SHEETS 23	F.A. RTE.	SECTION	COUNTY	TOTAL SHEETS	SHEET NO.
	74+280	D2.IT MESSAGE SIGN	ROCK ISLAND	23	13
CONTRACT NO. 64F86					
ILLINOIS FED. AID PROJECT C92-061-10					