

STATE OF ILLINOIS
DEPARTMENT OF TRANSPORTATION

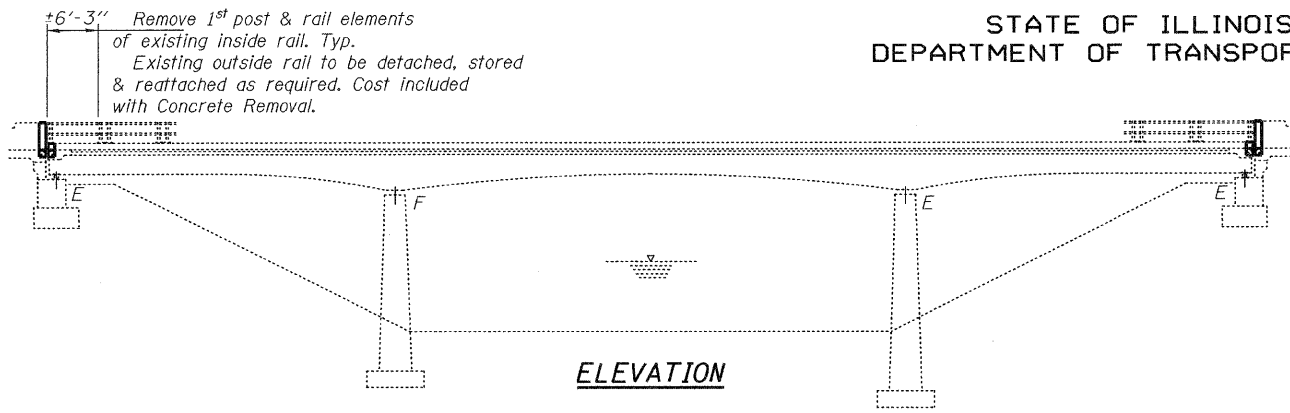

ELEVATION

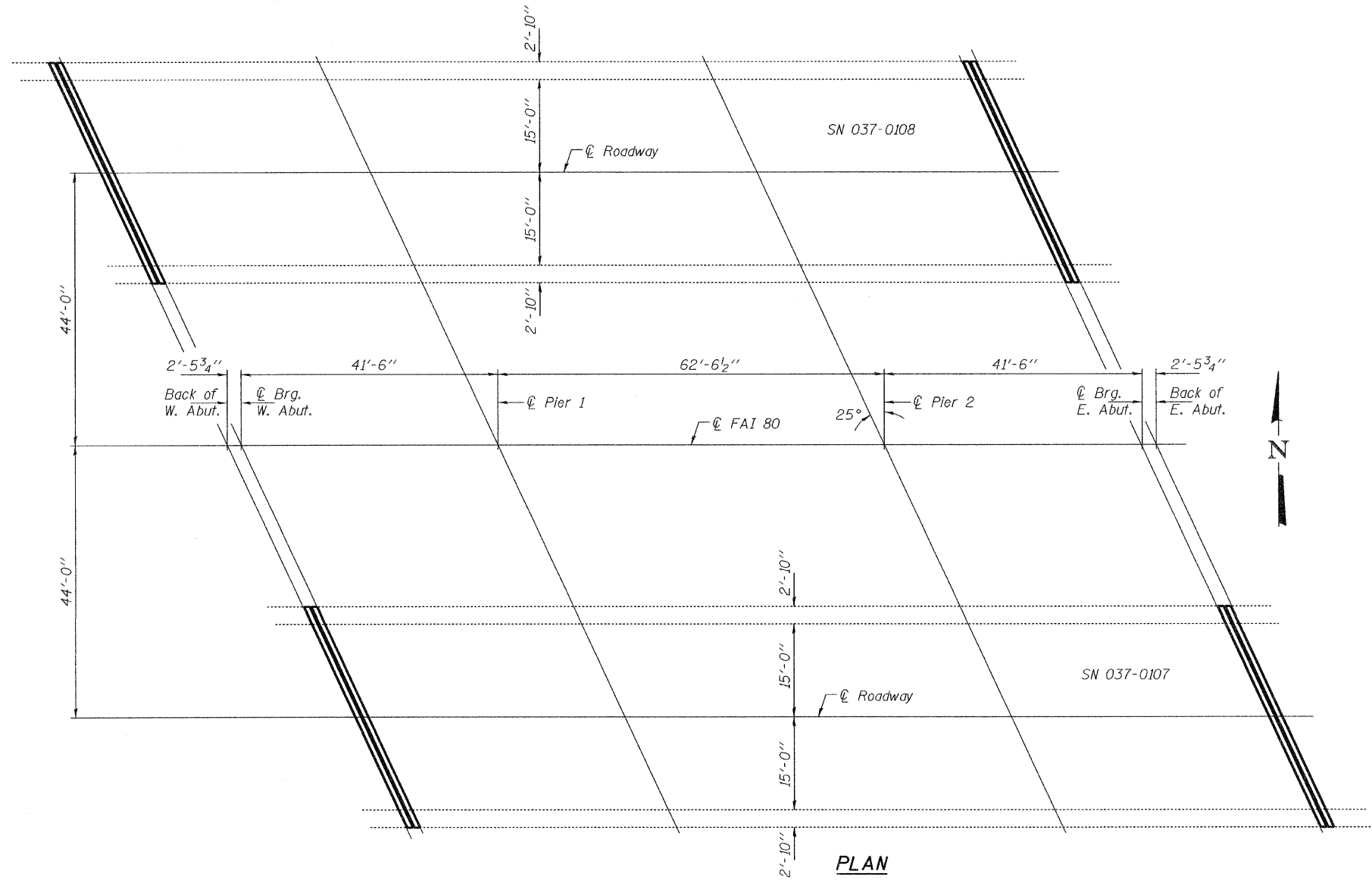

PLAN

GENERAL NOTES

Existing reinforcement bars extending into the removal area shall be cleaned, straightened and incorporated into the new construction. Any reinforcement bars that are damaged during concrete removal shall be replaced with an approved bar splicer or anchorage system. Cost included with Concrete Removal.

Joint openings shall be adjusted according to Article 520.04 of the Std. Specs. when the deck is poured at an ambient temperature other than 50° F.

Reinforcement bars shall conform to the requirements of ASTM A 706 Gr 60. See Special Provisions.

Reinforcement bars designated (E) shall be epoxy coated.

Plan dimensions and details relative to existing plans are subject to nominal construction variations. The Contractor shall field verify existing dimensions and details affecting new construction and make necessary approved adjustments prior to construction or ordering of materials. Such variations shall not be cause for additional compensation for a change in scope of the work, however, the Contractor will be paid for the quantity actually furnished at the unit price bid for the work.

The deck surface shall have its final finish tined according to Article 420.09(e)(1) of the Standard Specifications. Cost included with Concrete Superstructure.

The Contractor shall use extreme care during concrete removal so as not to damage the concrete beams.

TOTAL BILL OF MATERIAL

ITEM	UNIT	QUANTITY
Concrete Removal	Cu. Yd.	11.0
Concrete Superstructure	Cu. Yd.	11.0
Preformed Joint Strip Seal	Foot	165
Reinforcement Bars, Epoxy Coated	Pound	2040
Bar Splicers	Each	32
* Protective Coat	Sq. Yd.	30

* On new concrete only

PLAN AND ELEVATION
FAI 80 OVER MINERAL CREEK,
SN 037-0107 (EB) & 0108 (WB)

DESIGNED	<i>Jim J. Ford</i>
CHECKED	<i>Alvin T. Holloway</i>
DRAWN	<i>baliva</i>
CHECKED	<i>IJL ATH</i>

APRIL 27, 2010
EXAMINED *[Signature]*
ENGINEER OF STRUCTURAL SERVICES
PASSED *[Signature]*
ENGINEER OF BRIDGES AND STRUCTURES



EXPIRES 11-30-2010

SHEET NO. 1 5 SHEETS	F.A.I. RTE.	SECTION	COUNTY	TOTAL SHEETS	SHEET NO.
	80	(37-2B-2)M	HENRY	11	6
			CONTRACT NO. 64G23		
ILLINOIS FED. AID PROJECT					