

INDEX OF SHEETS

1. COVER SHEET
2. GENERAL NOTES
3. SUMMARY OF QUANTITIES
4. TYPICAL SECTIONS - FAI 55
5. TYPICAL SECTIONS - IL 17
6. PATCHING SCHEDULE - I-55 NB
7. PATCHING SCHEDULE - I-55 SB
8. PATCHING SCHEDULE - IL 17
9. PAVEMENT MARKING SCHEDULE - I-55
10. PAVEMENT MARKING SCHEDULE - IL 17
11. TRAFFIC CONTROL AND PROTECTION, STANDARD 701400 (SPECIAL)
12. TRAFFIC CONTROL AND PROTECTION, STANDARD 701401 (SPECIAL)
13. CLASS A PATCHING DETAILS WITHOUT HMA OVERLAY
14. CLASS A PATCHING DETAILS WITH HMA OVERLAY
15. CLASS B PATCHING DETAILS
16. TYPICAL PAVEMENT MARKINGS

STANDARDS

- 000001-05 STANDARD SYMBOLS, ABBREVIATIONS AND PATTERNS
- 001001-02 AREAS OF REINFORCEMENT BARS
- 001006 DECIMAL OF AN INCH AND OF A FOOT
- 420001-07 PAVEMENT JOINTS
- 420701-02 PAVEMENT FABRIC
- 421001-02 BAR REINFORCEMENT FOR CRC PAVEMENT
- 701001-02 OFF-ROAD OPERATIONS 2L, 2W, MORE THAN 15' (4.5 m) AWAY
- 701006-03 OFF-ROAD OPERATIONS 2L, 2W, 15' (4.5 m) TO 24" (600 mm) FROM PAVEMENT EDGE
- 701101-02 OFF-ROAD OPERATIONS MULTILANE, 15' (4.5 m) TO 24" (600 mm) FROM PAVEMENT EDGE
- 701106-02 OFF-ROAD OPERATIONS, MULTILANE, MORE THAN 15' (4.5 m) AWAY
- 701201-03 LANE CLOSURE, 2L, 2W, DAY ONLY, FOR SPEEDS ≥ 45 MPH
- 701301-03 LANE CLOSURE, 2L, 2W, SHORT TIME OPERATIONS
- 701336-05 LANE CLOSURE, 2L, 2W, WORK AREAS IN SERIES, FOR SPEEDS ≥ 45 MPH
- 701411-06 LANE CLOSURE, MULTILANE, AT ENTRANCE OR EXIT RAMP FOR SPEEDS ≥ 45 MPH
- 701426-03 LANE CLOSURE, MULTILANE INTERMITTENT OR MOVING OPERATION, FOR SPEEDS ≥ 45 MPH
- 701901-01 TRAFFIC CONTROL DEVICES

J.U.L.I.E.
JOINT UTILITY LOCATION INFORMATION FOR EXCAVATION
1-800-892-0123
OR 811

PROJECT ENGINEER: JOE KANNEL
UNIT CHIEF: RON WOODSHANK
TOWNSHIPS: VARIOUS
CONTRACT NO. 66A30

STATE OF ILLINOIS
DEPARTMENT OF TRANSPORTATION
DIVISION OF HIGHWAYS
PROPOSED
HIGHWAY PLANS
FAI ROUTE 55 (I-55)
SECTION D3 PATCHING 2011-1

PAVEMENT PATCHING
LIVINGSTON COUNTY
C-93-115-10

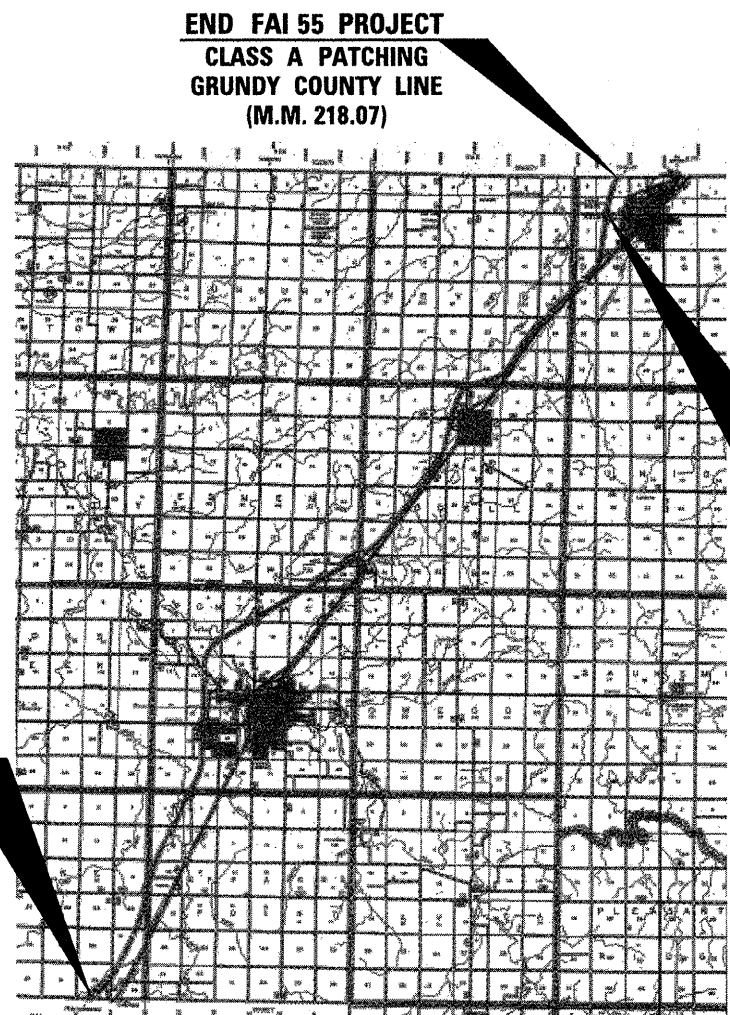

IL 17 PROJECT
CLASS B PATCHING
L.M. 0.00 TO L.M. 0.65
(IL 17 OVER I-55)

| F.A.I. RTE. | SECTION | COUNTY | TOTAL SHEETS | SHEET NO. |
|-------------|---------|------------|--------------------|-----------|
| 55 | ** | LIVINGSTON | 16 | 1 |
| ILLINOIS | | | CONTRACT NO. 66A30 | |

** D3 PATCHING 2011-1

D-93-002-10

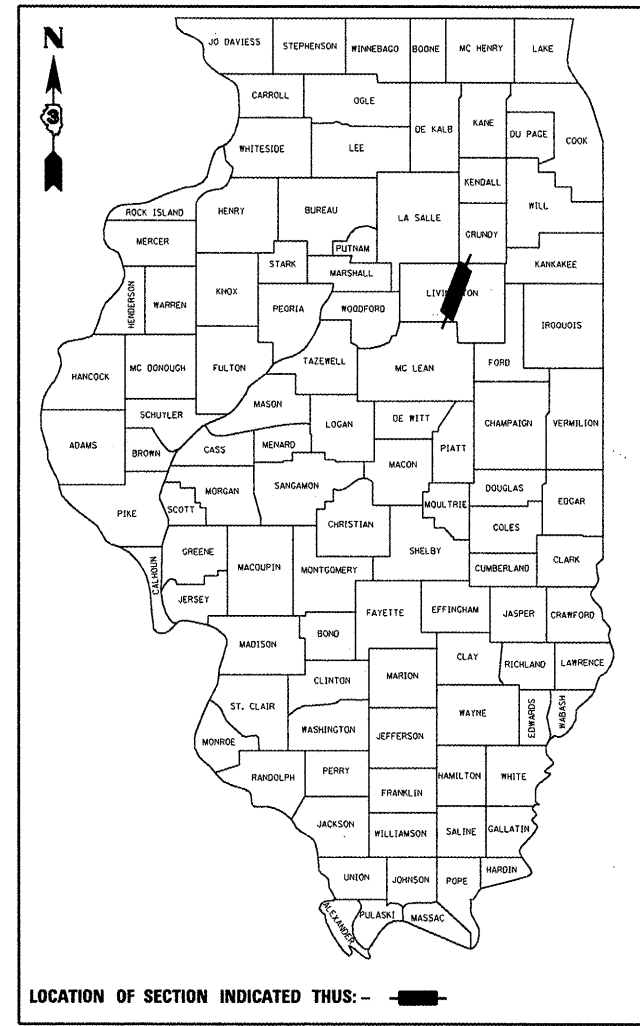

FUNCTIONAL CLASSIFICATION
RURAL: INTERSTATE
FAI ROUTE 55
2007 ADT = 15100
P.V = 73.8% M.U. = 22.6% S.U. = 3.6%

FUNCTIONAL CLASSIFICATION
RURAL: MINOR ARTERIAL
FAP 649 (IL 17)
2007 ADT = 5500
P.V = 78.2% M.U. = 11.8% S.U. = 10.0%

STATE OF ILLINOIS
DEPARTMENT OF TRANSPORTATION
DIVISION OF HIGHWAYS

SUBMITTED 4/1 2010
George F. Ryan
DEPUTY DIRECTOR OF HIGHWAYS, REGIONAL ENGINEER

May 7 2010
Scott E. Still P.E. I&E
acting ENGINEER OF DESIGN AND ENVIRONMENT

May 7 2010
Christine M. Reed/E
DIRECTOR OF HIGHWAYS, CHIEF ENGINEER

PRINTED BY THE AUTHORITY
OF THE STATE OF ILLINOIS

GENERAL NOTES

PLAN DIMENSIONS AND DETAILS RELATIVE TO EXISTING ROADWAY OR STRUCTURE HAVE BEEN TAKEN FROM EXISTING PLANS AND ARE SUBJECT TO NOMINAL CONSTRUCTION VARIATIONS. IT SHALL BE THE CONTRACTOR'S RESPONSIBILITY TO VERIFY SUCH DIMENSIONS AND DETAILS IN THE FIELD AND TO MAKE NECESSARY APPROVED ADJUSTMENTS PRIOR TO CONSTRUCTION OR ORDERING OF MATERIALS. SUCH VARIATIONS SHALL NOT BE CAUSE FOR ADDITIONAL COMPENSATION FOR A CHANGE IN THE SCOPE OF THE WORK, HOWEVER, THE CONTRACTOR WILL BE PAID FOR THE QUANTITY ACTUALLY FURNISHED AT THE UNIT BID FOR THE WORK.

FOR STABILIZATION, ALL TYPE III BARRICADES SHALL REQUIRE A MINIMUM OF FOUR SAND BAGS PER BARRICADE.

THE CONTRACTOR SHALL BE RESPONSIBLE FOR PROTECTING UTILITY PROPERTY FROM CONSTRUCTION OPERATIONS AS OUTLINED IN ARTICLE 107.31 OF THE STANDARD SPECIFICATIONS. THE "JULIE" NUMBER IS 1-800-892-0123. A MINIMUM OF FORTY-EIGHT (48) HOURS ADVANCE NOTICE IS REQUIRED.

WHERE SECTION OR SUBSECTION MONUMENTS ARE ENCOUNTERED, THE ENGINEER SHALL BE NOTIFIED BEFORE SUCH MONUMENTS ARE REMOVED. THE CONTRACTOR SHALL PROTECT AND CAREFULLY PRESERVE ALL MONUMENTS UNTIL AN AUTHORIZED SURVEYOR OR AGENT HAS WITNESSED OR OTHERWISE REFERENCED THEIR LOCATION. THE CONTRACTOR SHALL BE RESPONSIBLE FOR HAVING AN AUTHORIZED SURVEYOR REESTABLISH ANY SECTION OR SUBSECTION MONUMENTS DESTROYED BY HIS OPERATIONS.

ABANDONED UNDERGROUND UTILITIES THAT CONFLICT WITH CONSTRUCTION SHALL BE DISPOSED OF OUTSIDE THE LIMITS OF THE RIGHT OF WAY ACCORDING TO ARTICLE 202.03 OF THE STANDARD SPECIFICATIONS AND AS DIRECTED BY THE ENGINEER. THIS WORK WILL NOT BE PAID FOR SEPARATELY BUT SHALL BE INCLUDED IN THE COST OF CLASS A PATCHING.

ANY REFERENCE TO A STANDARD IN THESE PLANS SHALL BE INTERPRETED TO MEAN THE EDITION AS INDICATED BY THE SUBNUMBER LISTED ON THE INDEX OF SHEETS OR THE COPY OF THE STANDARD INCLUDED IN THESE PLANS.

EXISTING REINFORCEMENT BARS EXTENDING INTO REMOVAL AREA SHALL BE CLEANED, STRAIGHTENED AND INCORPORATED INTO THE NEW CONSTRUCTION. ANY REINFORCEMENT BARS THAT ARE DAMAGED DURING CONCRETE REMOVAL SHALL BE REPLACED WITH AN APPROVED BAR SPLICER OR ANCHORAGE SYSTEM. COST INCLUDED WITH CONCRETE REMOVAL.

DATE: 4/1/10

PREPARED BY: *Tom Brown*
DISTRICT STUDIES & PLANS ENGINEER

EXAMINED BY: *Hubert K. Ingos*
DISTRICT CONSTRUCTION ENGINEER

Wayne J. Phyllis
DISTRICT MATERIALS ENGINEER

Bruce A. Hudson
DISTRICT OPERATIONS ENGINEER

| | | | | | | | | | | |
|--|-------------------------|--------------------------|--------------------|---|----------------------|-------------------------|------------|--------------------------|--------------|-----------|
| FILE NAME = | USER NAME = woodshankr1 | DESIGNED - RON WOODSHANK | REVISED - | STATE OF ILLINOIS DEPARTMENT OF TRANSPORTATION | GENERAL NOTES | F.A.I. RTE. | SECTION | COUNTY | TOTAL SHEETS | SHEET NO. |
| cd:\pw_work\pwwidat\woodshankr1\d0143167\0366A30-details.dgn | DRAWN - RON WOODSHANK | REVISED - | 55 | | | D3 PATCHING 2011-1 | LIVINGSTON | 16 | 2 | |
| PLOT SCALE = 100.0000' / IN. | CHECKED - | REVISED - | CONTRACT NO. 66A30 | | | | | | | |
| PLOT DATE = Mar 31, 2010 - 10:26:04 AM | DATE - | REVISED - | ILLINOIS | | | | | | | |
| | | | | | SCALE: _____ | SHEET NO. 1 OF 1 SHEETS | | STA. _____ TO STA. _____ | | |

SUMMARY OF QUANTITIES

CONSTRUCTION CODE: J000

| CODE NO. | ITEM | UNIT | 100% STATE TOTAL QUANTITY |
|------------|---|--------|---------------------------|
| 20200500 | EARTH EXCAVATION (WIDENING) | CU YD | 14 |
| 35102000 | AGGREGATE BASE COURSE, TYPE B 8" | SQ YD | 257 |
| 44003500 | MEDIAN REMOVAL AND REPLACEMENT (SPECIAL) | SQ FT | 335 |
| 44200541 | CLASS A PATCHES, TYPE II, 9 INCH | SQ YD | 109 |
| 44200620 | CLASS A PATCHES, TYPE II, 14 INCH | SQ YD | 220 |
| 44200628 | CLASS A PATCHES, TYPE IV, 14 INCH | SQ YD | 107 |
| 44200934 | CLASS B PATCHES, TYPE II, 8 INCH | SQ YD | 288 |
| 44213000 | PATCHING REINFORCEMENT | SQ YD | 436 |
| 44213100 | PAVEMENT FABRIC | SQ YD | 327 |
| 44213200 | SAW CUTS | FOOT | 4064 |
| 67100100 | MOBILIZATION | L SUM | 1 |
| 70100420 | TRAFFIC CONTROL AND PROTECTION, STANDARD 701411 | EACH | 16 |
| 70100600 | TRAFFIC CONTROL AND PROTECTION, STANDARD 701336 | L SUM | 1 |
| 70103815 | TRAFFIC CONTROL SURVEILLANCE | CAL DA | 15 |
| * 78005110 | EPOXY PAVEMENT MARKING - LINE 4" | FOOT | 596 |
| * 78005130 | EPOXY PAVEMENT MARKING - LINE 6" | FOOT | 94 |
| X7010805 | TRAFFIC CONTROL AND PROTECTION, STANDARD 701401 (SPECIAL) | L SUM | 1 |
| Z0017202 | DOWEL BARS 1 1/2" | EACH | 280 |
| Z0075300 | TIE BARS 3/4" | EACH | 40 |

* SPECIALITY ITEM

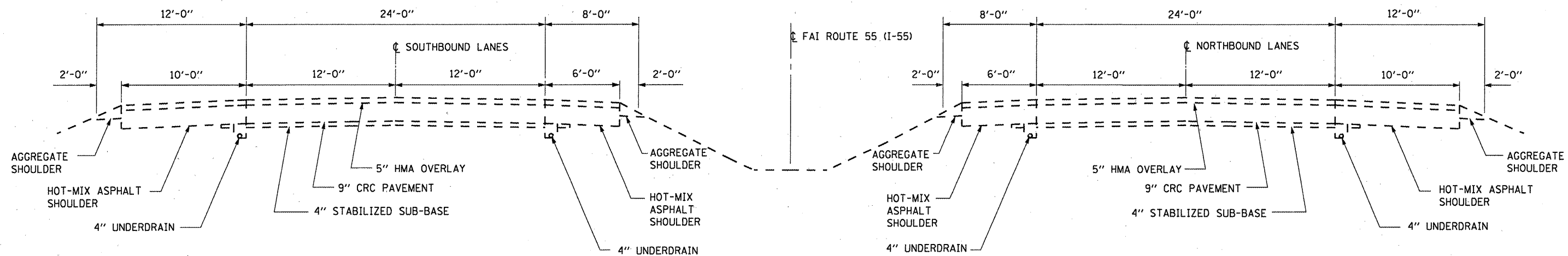

**TYPICAL SECTION
MAINLINE**
M.M. 187.70 TO M.M. 215.40

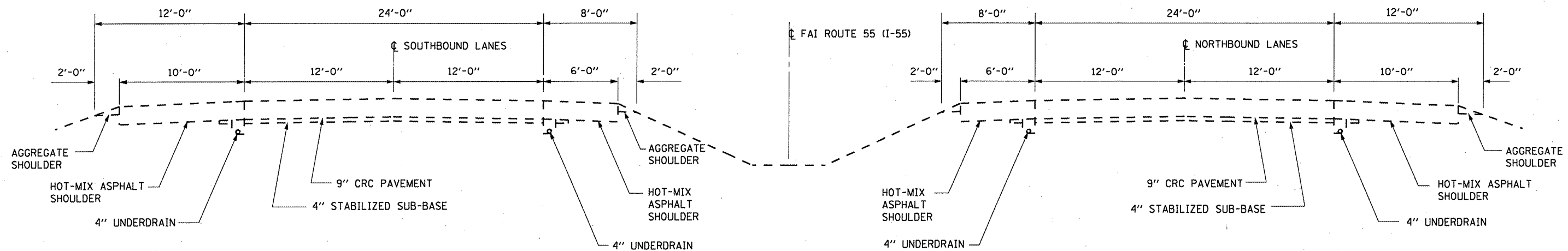

**TYPICAL SECTION
MAINLINE**
M.M. 215.40 TO M.M. 218.07

| | | | | | | | | | | |
|--|-------------------------|--------------------------|--------------------|---|----------------------------------|-------------------------|------------|--------------------------|--------------|-----------|
| FILE NAME = | USER NAME = woodshankr1 | DESIGNED - RON WOODSHANK | REVISED - | STATE OF ILLINOIS DEPARTMENT OF TRANSPORTATION | TYPICAL SECTIONS - FAI 55 | F.A.I. RTE. | SECTION | COUNTY | TOTAL SHEETS | SHEET NO. |
| ct:\pw\work\pwsdot\woodshankr1\d0143167\066A30-detai1s.dgn | DRAWN - RON WOODSHANK | REVISED - | 55 | | | D3 PATCHING 2011-1 | LIVINGSTON | 16 | 4 | |
| PLOT SCALE = 100.0000' / IN. | CHECKED - | REVISED - | CONTRACT NO. 66A30 | | | | | | | |
| PLOT DATE = Mar 31, 2010 - 10:26:13 AM | DATE - | REVISED - | ILLINOIS | | | | | | | |
| | | | | | SCALE: _____ | SHEET NO. 1 OF 1 SHEETS | | STA. _____ TO STA. _____ | | |

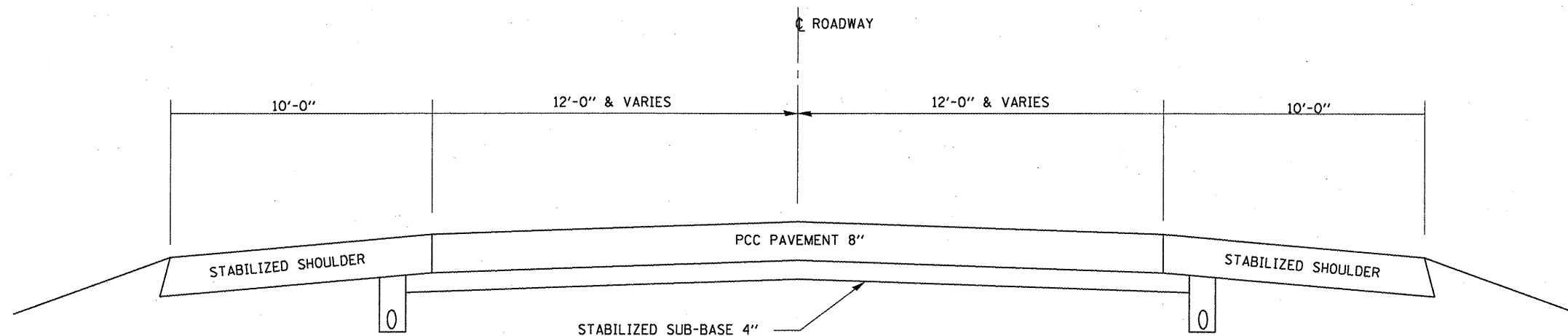

**TYPICAL SECTION
MAINLINE
(LOOKING WEST)
L.M. 0.00 - 0.09
L.M. 0.62 - 0.65**

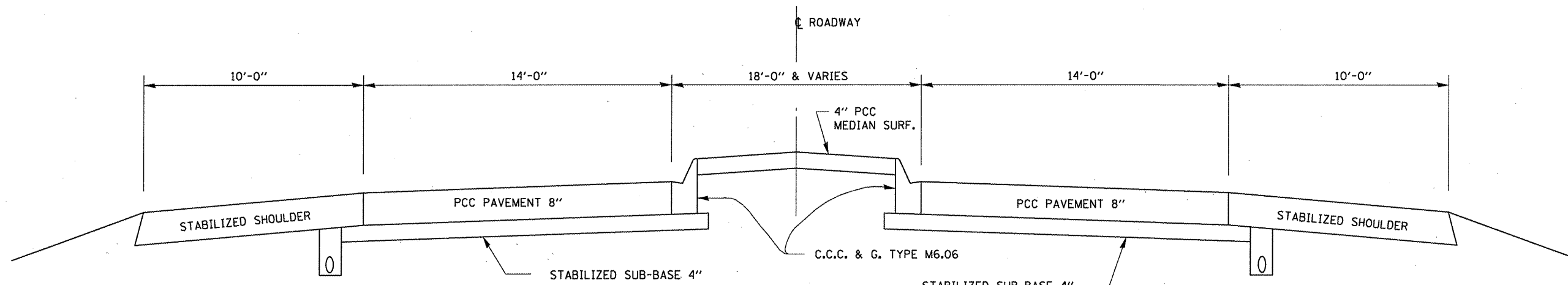

**TYPICAL SECTION
MAINLINE
(LOOKING WEST)
L.M. 0.09 - 0.60**

| | | | | | | | | | | |
|---|-------------------------|--------------------------|--------------------|---|------------------------------|--------------------|------------|--------|--------------|-----------|
| FILE NAME = | USER NAME = woodshankr1 | DESIGNED - RON WOODSHANK | REVISED - | STATE OF ILLINOIS DEPARTMENT OF TRANSPORTATION | TYPICAL SECTION IL 17 | F.A.I. RTE. | SECTION | COUNTY | TOTAL SHEETS | SHEET NO. |
| c:\pvt_work\pvt\dot\woodshankr1\d0143167\066A30-details.dgn | DRAWN - RON WOODSHANK | REVISED - | 55 | | | D3 PATCHING 2011-1 | LIVINGSTON | 16 | 5 | |
| PLOT SCALE = 1/8" = 1' IN. | CHECKED - | REVISED - | CONTRACT NO. 66A30 | | | | | | | |
| PLOT DATE = Mar 31, 2010 - 10:26:18 AM | DATE - | REVISED - | ILLINOIS | | | | | | | |
| | | | | SCALE: _____ SHEET NO. 1 OF 1 SHEETS STA. _____ TO STA. _____ | | | | | | |

PATCHING SCHEDULE - NBL

| LOCATION BY MILE POST | PASSING LANE | | | | | | | DRIVING LANE | | | | | | | REMARKS |
|--------------------------------|--------------------------|---------------------------|---------------------------|-----------------|-----------------|-------------|-------------|--------------------------|---------------------------|---------------------------|-----------------|-----------------|-------------|-------------|---|
| | CLASS A TYPE II 9" | CLASS A TYPE II 14" | CLASS A TYPE IV 14" | PATCH REINF. | PAV'T FABRIC | SAW CUTS | TIE BARS | CLASS A TYPE II 9" | CLASS A TYPE II 14" | CLASS A TYPE IV 14" | PATCH REINF. | PAV'T FABRIC | SAW CUTS | TIE BARS | |
| | SQ YD | SQ YD | SQ YD | SQ YD | SQ YD | FOOT | EACH | SQ YD | SQ YD | SQ YD | SQ YD | SQ YD | FOOT | EACH | |
| 187.70 | | | | | | | | | | | | | | | MCLEAN COUNTY LINE |
| 195.00 | | | | | | | | | 13 | | 13 | 13 | 68 | | |
| 195.50 | | | | | | | | | | 27 | 27 | 27 | 88 | 10 | |
| 196.30 | | | | | | | | | 8 | | 8 | 8 | 60 | | |
| 196.40 | | | | | | | | | | 80 | 80 | 80 | 168 | 30 | |
| 196.41 | | | | | | | | | 13 | | 13 | 13 | 68 | | |
| 202.10 | | | | | | | | | 8 | | 8 | 8 | 60 | | |
| 203.70 | | | | | | | | | 8 | | 8 | 8 | 60 | | |
| 203.80 | | | | | | | | | 8 | | 8 | 8 | 60 | | |
| 203.85 | | | | | | | | | 8 | | 8 | 8 | 60 | | |
| 203.89 | | | | | | | | | 8 | | 8 | 8 | 60 | | |
| 203.90 | | | | | | | | | 8 | | 8 | 8 | 60 | | |
| 204.10 | | | | | | | | | 8 | | 8 | 8 | 60 | | |
| 204.20 | | | | | | | | | 8 | | 8 | 8 | 60 | | |
| 212.30 | | | | | | | | | 8 | | 8 | 8 | 60 | | |
| 215.10 | | | | | | | | | 8 | | 8 | 8 | 60 | | |
| 215.20 | | | | | | | | | | | | | 0 | 0 | END HMA SECTION: BEGIN CONCRETE SECTION |
| 215.30 | | | | | | | | 8 | | | 8 | | 60 | | |
| 218.70 | | | | | | | | | | | | | | | GRUNDY COUNTY LINE |
| NBL TOTALS | | | | | | | | 8 | 114 | 107 | 229 | 221 | 1112 | 40 | |

| | | | |
|---|--|--------------------------|-----------------|
| FILE NAME = | USER NAME = woodshankr1 | DESIGNED - RON WOODSHANK | REVISED - ----- |
| c:\pwork\pwork\woodshankr1\20143167\66A30-deta1.dgn | | DRAWN - RON WOODSHANK | REVISED - ----- |
| | PLOT SCALE = 100.0000' / IN. | CHECKED - ----- | REVISED - ----- |
| | PLOT DATE = Mar 31, 2010 - 10:26:23 AM | DATE - ----- | REVISED - ----- |

**STATE OF ILLINOIS
DEPARTMENT OF TRANSPORTATION**

PATCHING SCHEDULE I-55 NB

SCALE: _____ SHEET NO. 1 OF 1 SHEETS STA. _____ TO STA. _____

| | | | | |
|----------------|--------------------|------------|--------------------|--------------|
| F.A.I. RTE. | SECTION | COUNTY | TOTAL SHEETS | SHEET NO. |
| 55 | D3 PATCHING 2011-1 | LIVINGSTON | 16 | 6 |
| ILLINOIS | | | CONTRACT NO. 66A30 | |

PATCHING SCHEDULE - SBL

| LOCATION BY MILE POST | PASSING LANE | | | | | | | DRIVING LANE | | | | | | | REMARKS | | |
|--------------------------------|--------------------------|---------------------------|-------|----------------|-----------------|-----------------|-------------|--------------|--------------------------|---------------------------|-------|----------------|-----------------|-----------------|------------|-------------|---|
| | CLASS A TYPE II 9" | CLASS A TYPE II 14" | | TYPE IV 14" | PATCH REINF. | PAV'T FABRIC | SAW CUTS | TIE BARS | CLASS A TYPE II 9" | CLASS A TYPE II 14" | | TYPE IV 14" | PATCH REINF. | PAV'T FABRIC | | SAW CUTS | TIE BARS |
| | SQ YD | SQ YD | SQ YD | SQ YD | SQ YD | FOOT | EACH | SQ YD | SQ YD | SQ YD | SQ YD | SQ YD | FOOT | EACH | | | |
| 218.07 | | | | | | | | | | | | | | | | | GRUNDY COUNTY LINE |
| 218.20 | | | | | | | | 8 | | | | | 8 | | 60 | | |
| 218.00 | 8 | | | | 8 | | | | | | | | 8 | | 60 | | |
| 216.90 | | | | | | | | 8 | | | | | 8 | | 60 | | |
| 216.60 | 8 | | | | 8 | | | | | | | | 8 | | 60 | | |
| 216.21 | | | | | | | | 11 | | | | | 11 | | 64 | | |
| 216.20 | | | | | | | | 8 | | | | | 8 | | 60 | | |
| 215.51 | 8 | | | | 8 | | | 8 | | | | | 8 | | 60 | | |
| 215.50 | 13 | | | | 13 | | | 13 | | | | | 13 | | 68 | | |
| 215.40 | | | | | | | | | | | | | | | | | END CONCRETE SECTION; BEGIN HMA OVERLAY |
| 213.80 | 8 | | | | 8 | | | | | | | | | | 60 | | |
| 209.10 | | | | | | | | | | | | | | | | | END HMA OVERLAY; BEGIN CONCRETE SECTION |
| 209.05 | | | | | | | | | | | | | | | | | FAS 348 (ODELL) |
| 209.00 | | | | | | | | | | | | | | | | | END CONCRETE SECTION; BEGIN HMA OVERLAY |
| 204.60 | | | | | | | | | 11 | | | | 11 | 11 | 64 | | |
| 203.60 | | | | | | | | 8 | | | | | 8 | 8 | 60 | | |
| 203.50 | | | | | | | | 8 | | | | | 8 | 8 | 60 | | |
| 200.60 | | | | | | | | | | | | | | | | | IL RTE. 23 |
| 199.80 | | | | | | | | 8 | | | | | 8 | 8 | 60 | | |
| 199.70 | | | | | | | | 8 | | | | | 8 | 8 | 60 | | |
| 199.60 | | | | | | | | 13 | | | | | 13 | 13 | 68 | | |
| 199.05 | | | | | | | | 13 | | | | | 13 | 13 | 68 | | |
| 198.90 | | | | | | | | 8 | | | | | 8 | 8 | 60 | | |
| 198.80 | | | | | | | | 8 | | | | | 8 | 8 | 60 | | |
| 198.10 | | | | | | | | 13 | | | | | 13 | 13 | 68 | | |
| 196.70 | | | | | | | | | | | | | | | | | IL RTE. 116 |
| 192.40 | | | | | | | | 8 | | | | | 8 | 8 | 60 | | |
| 187.70 | | | | | | | | | | | | | | | | | MCLEAN COUNTY LINE |
| SBL TOTALS | 45 | | | | 45 | | | | | | | | 56 | 106 | 162 | 1060 | |

| PATCHING SCHEDULE - IL 17 | | | |
|-----------------------------|------------------------|---------------|-------------|
| LOCATION WBL LOG MILE | CLASS B TYPE II | DOWEL BARS | SAW CUTS |
| | SQ YD | EACH | FOOT |
| 0.00 | BEGIN CONCRETE SECTION | | |
| 0.05 | 8 | 20 | 48 |
| 0.08 | 8 | 20 | 48 |
| 0.10 | 8 | 20 | 48 |
| 0.11 | 8 | 20 | 48 |
| 0.12 | 13 | 20 | 56 |
| 0.13 | 8 | 20 | 48 |
| 0.14 | 8 | 20 | 48 |
| 0.14 | 8 | 20 | 48 |
| 0.15 | 11 | 20 | 52 |
| 0.20 | 8 | 20 | 48 |
| 0.20 | 13 | 20 | 56 |
| 0.21 | 8 | 20 | 48 |
| 0.21 | 13 | 20 | 56 |
| 0.35 | 8 | 20 | 48 |
| 0.40 | 8 | 20 | 48 |
| 0.40 | 8 | 20 | 48 |
| 0.42 | 8 | 20 | 48 |
| 0.44 | 8 | 20 | 48 |
| 0.55 | 8 | 20 | 48 |
| 0.60 | 8 | 20 | 48 |
| 0.65 | END CONCRETE SECTION | | |
| WB TOTALS | 179 | 400 | 988 |

| PATCHING SCHEDULE - IL 17 | | | |
|-----------------------------|------------------------|---------------|-------------|
| LOCATION EBL LOG MILE | CLASS B TYPE II | DOWEL BARS | SAW CUTS |
| | SQ YD | EACH | FOOT |
| 0.65 | BEGIN CONCRETE SECTION | | |
| 0.55 | 8 | 20 | 48 |
| 0.50 | 8 | 20 | 48 |
| 0.48 | 8 | 20 | 48 |
| 0.45 | 8 | 20 | 48 |
| 0.35 | 13 | 20 | 56 |
| 0.36 | 8 | 20 | 48 |
| 0.30 | 8 | 20 | 48 |
| 0.29 | 8 | 20 | 48 |
| 0.25 | 11 | 20 | 52 |
| 0.21 | 8 | 20 | 48 |
| 0.15 | 13 | 20 | 56 |
| 0.08 | 8 | 20 | 12 |
| 0.00 | END CONCRETE SECTION | | |
| EB TOTALS | 109 | 240 | 596 |

| PAVEMENT MARKING SCHEDULE - FAI 55 | | | |
|------------------------------------|---|-------|------------------------------------|
| LOCATION NBL | EPOXY PAVEMENT MARKING, LINE 4" | | EPOXY PAVEMENT MARKING, LINE 6" |
| | FEET | | FEET |
| | YELLOW | WHITE | WHITE |
| LOG MILE | | | |
| 187.70 | McCLEAN COUNTY LINE | | |
| 195.00 | | 10 | 3 |
| 195.50 | | 20 | 5 |
| 196.30 | | 6 | 2 |
| 196.40 | | 60 | 15 |
| 196.41 | | 10 | 3 |
| 202.10 | | 6 | 2 |
| 203.70 | | 6 | 2 |
| 203.80 | | 6 | 2 |
| 203.85 | | 6 | 2 |
| 203.89 | | 6 | 2 |
| 203.90 | | 6 | 2 |
| 204.10 | | 6 | 2 |
| 204.20 | | 6 | 2 |
| 212.30 | | 6 | 2 |
| 215.10 | | 6 | 2 |
| 215.20 | END HMA OVERLAY; BEGIN CONCRETE SECTION | | |
| 215.30 | | 6 | 2 |
| 218.70 | GRUNDY COUNTY LINE | | |
| SUBTOTALS | | 172 | 50 |
| TOTAL | | 172 | 50 |

| PAVEMENT MARKING SCHEDULE - FAI 55 | | | |
|------------------------------------|---|-------|------------------------------------|
| LOCATION NBL | EPOXY PAVEMENT MARKING, LINE 4" | | EPOXY PAVEMENT MARKING, LINE 6" |
| | FEET | | FEET |
| | YELLOW | WHITE | WHITE |
| LOG MILE | | | |
| 218.07 | GRUNDY COUNTY LINE | | |
| 218.20 | | 6 | 2 |
| 218.00 | 6 | | 2 |
| 216.90 | | 6 | 2 |
| 216.60 | 6 | | 2 |
| 216.21 | | 8 | 2 |
| 216.20 | | 6 | 2 |
| 215.51 | 6 | 6 | 2 |
| 215.50 | 10 | 10 | 3 |
| 215.40 | END CONCRETE SECTION; BEGIN HMA OVERLAY | | |
| 213.80 | 6 | | 2 |
| 209.10 | END HMA OVERLAY; BEGIN CONCRETE SECTION | | |
| 209.05 | FAS 348 (ODELL) | | |
| 209.00 | END CONCRETE SECTION; BEGIN HMA OVERLAY | | |
| 204.60 | | 8 | 2 |
| 203.60 | | 6 | 2 |
| 203.50 | | 6 | 2 |
| 200.60 | IL RTE. 23 | | |
| 199.80 | | 6 | 2 |
| 199.70 | | 6 | 2 |
| 199.60 | | 10 | 3 |
| 199.05 | | 10 | 3 |
| 198.9 | | 6 | 2 |
| 198.8 | | 6 | 2 |
| 198.1 | | 10 | 3 |
| 196.7 | IL RTE. 116 | | |
| 192.4 | | 6 | 2 |
| 187.7 | McCLEAN COUNTY LINE | | |
| SUBTOTALS | 34 | 122 | 44 |
| TOTAL | | 156 | 44 |

| | | | |
|--|-------------------------|--------------------------|-----------------|
| FILE NAME = | USER NAME = woodshankr1 | DESIGNED - RON WOODSHANK | REVISED - ----- |
| c:\pwork\pwidot\woodshankr1\d0143167\0366A30-details.dgn | | DRAWN - RON WOODSHANK | REVISED - ----- |
| PLOT SCALE = 100.0000' / IN. | | CHECKED - --- | REVISED - ----- |
| PLOT DATE = Mar 31, 2010 - 10:26:39 AM | | DATE - ----- | REVISED - ----- |

STATE OF ILLINOIS
DEPARTMENT OF TRANSPORTATION

PAVEMENT MARKING SCHEDULE I-55

SCALE: ----- SHEET NO. 1 OF 1 SHEETS STA. ----- TO STA. -----

| F.A.I. RTE. | SECTION | COUNTY | TOTAL SHEETS | SHEET NO. |
|--------------------|--------------------|------------|-----------------|--------------|
| 55 | D3 PATCHING 2011-1 | LIVINGSTON | 16 | 9 |
| CONTRACT NO. 66A30 | | | ILLINOIS | |

| PAVEMENT MARKING SCHEDULE - IL 17 | | |
|-----------------------------------|------------------------------------|-------|
| LOCATION WBL | EPOXY PAVEMENT MARKING, LINE 4" | |
| | FEET | |
| LOG MILE | YELLOW | WHITE |
| 0.00 | BEGIN CONCRETE SECTION | |
| 0.05 | 6 | 6 |
| 0.08 | 6 | 6 |
| 0.10 | 6 | 6 |
| 0.11 | 6 | 6 |
| 0.12 | 10 | 10 |
| 0.13 | 6 | 6 |
| 0.14 | 6 | 6 |
| 0.14 | 6 | 6 |
| 0.15 | 8 | 8 |
| 0.20 | 6 | 6 |
| 0.20 | 10 | 10 |
| 0.21 | 6 | 6 |
| 0.21 | 10 | 10 |
| 0.35 | 6 | 6 |
| 0.40 | 6 | 6 |
| 0.40 | 6 | 6 |
| 0.42 | 6 | 6 |
| 0.44 | 6 | 6 |
| 0.55 | 6 | 6 |
| 0.60 | 6 | 6 |
| 0.65 | END CONCRETE SECTION | |
| SUBTOTALS | 134 | 134 |
| TOTAL | 268 | |

| PAVEMENT MARKING SCHEDULE - IL 17 | | |
|-----------------------------------|------------------------------------|-------|
| LOCATION EBL | EPOXY PAVEMENT MARKING, LINE 4" | |
| | FEET | |
| LOG MILE | YELLOW | WHITE |
| 0.65 | BEGIN CONCRETE SECTION | |
| 0.55 | 6 | 6 |
| 0.50 | 6 | 6 |
| 0.48 | 6 | 6 |
| 0.45 | 6 | 6 |
| 0.35 | 10 | 10 |
| 0.36 | 6 | 6 |
| 0.30 | 6 | 6 |
| 0.29 | 6 | 6 |
| 0.25 | 8 | 8 |
| 0.21 | 6 | 6 |
| 0.15 | 10 | 10 |
| 0.08 | 6 | 6 |
| 0.00 | 10 | 10 |
| SUBTOTALS | 92 | 92 |
| TOTAL | 184 | |

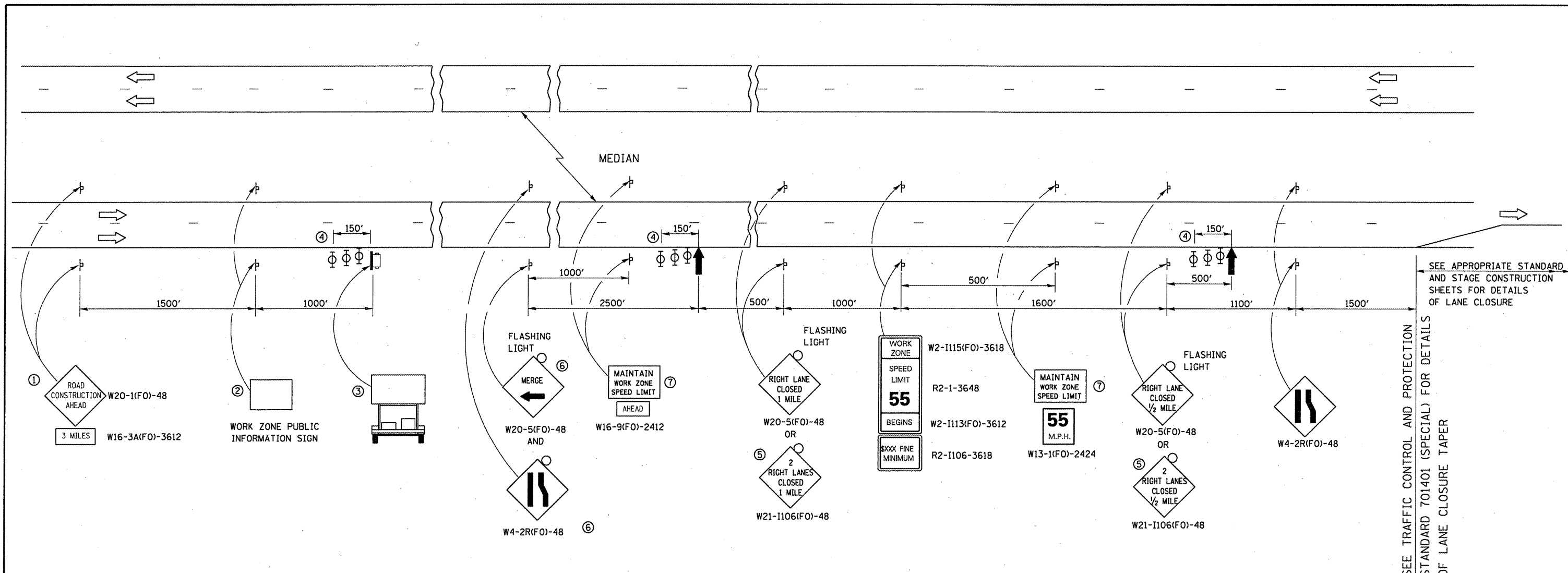

- ① THE ROAD CONSTRUCTION AHEAD SIGN SHALL BE LOCATED 3 MILES IN ADVANCE OF THE PROJECT LIMITS.
- ② THE MESSAGE AND SIZE OF THE WORK ZONE PUBLIC INFORMATION SIGN SHALL BE AS SPECIFIED BY THE DEPARTMENT.
- ③ TO BE PLACED IN THE MEDIAN WHEN FEASIBLE. THE MESSAGE BOARD SHALL BE USED TO DISPLAY STATUS OF LANES WITHIN THE PROJECT. THE PRIMARY MESSAGES SHALL BE:
"RIGHT LANE CLOSED" / " x MILES AHEAD"
"LEFT LANE CLOSED" / " x MILES AHEAD"
"ALL LANES OPEN"
- ④ THREE, TYPE II BARRICADES, DRUMS, OR VERTICAL BARRICADES AT 50' CENTERS.
- ⑤ THIS SIGN SHALL BE USED WHEN 2 LANES ARE CLOSED.
- ⑥ WHEN THE LEFT LANE IS CLOSED, SWITCH THESE TWO SIGNS AND THE DIRECTION OF THE MERGE ARROW.

⑦ 48"x36" FLUORESCENT ORANGE SIGN WITH BLACK LETTERS.

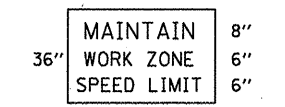

- ↑ ARROW BOARD
- ☐ PORTABLE CHANGEABLE MESSAGE SIGN
- ⊥ SIGN
- ⊕ TYPE II BARRICADE, DRUM, OR VERTICAL BARRICADE WITH MONODIRECTIONAL FLASHING LIGHT
- ↘ LANE DROP ARROW - SEE STANDARD 780001
- ▨ TEMPORARY THERMOPLASTIC RUMBLE STRIPS

GENERAL NOTE:

THIS STANDARD IS USED WHERE AT ANY TIME A LANE IS CLOSED ON A FREEWAY/EXPRESSWAY.

WHEN THE LEFT LANE IS CLOSED, LEFT LANE CLOSED SIGNS SHALL BE SUBSTITUTED FOR THE RIGHT LANE CLOSED SIGNS.

THE FIRST TWO SIGNS AND THE MESSAGE BOARD ARE STATIONARY. THE OTHER SIGNS AND ARROWBOARDS SHALL BE MOVED AS NECESSARY TO MAINTAIN THE REQUIRED DISTANCE FROM THE START OF THE LANE CLOSURE TAPER(S).





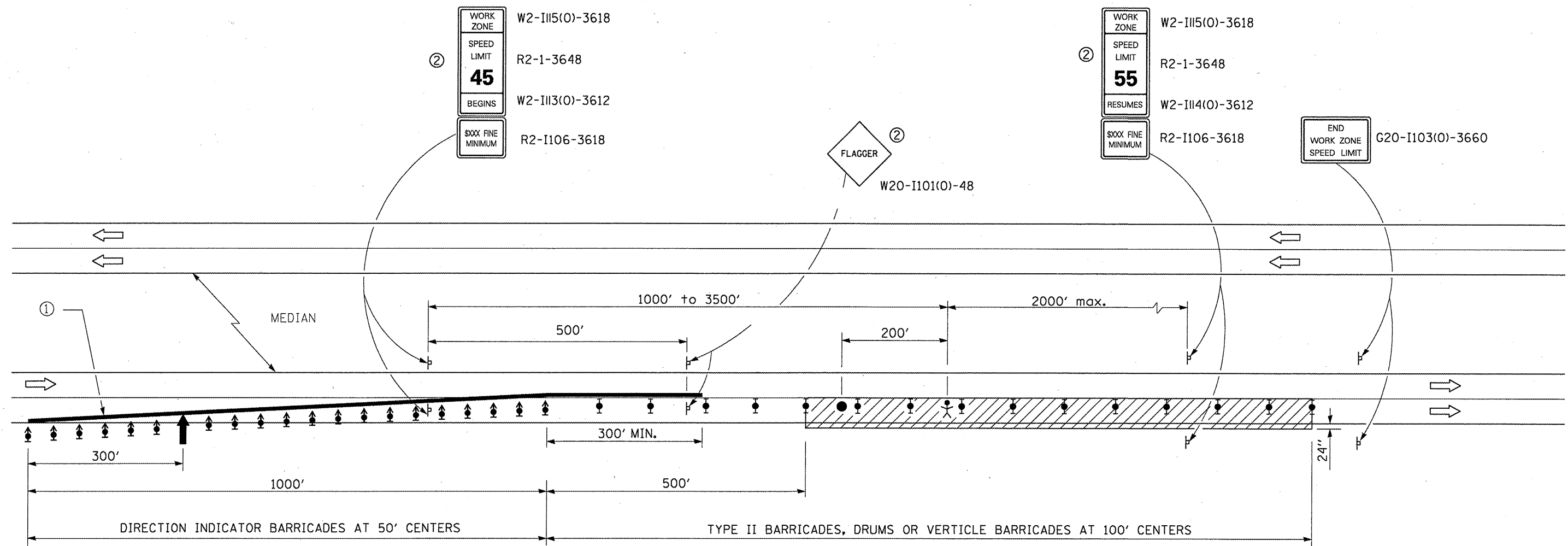

WHEN WORK OPERATIONS ARE NEAR MAJOR INTERCHANGES THE CONTRACTOR SHALL FURNISH ADDITIONAL MESSAGE BOARDS AND UTILIZED AT THE DIRECTION OF THE ENGINEER.

| | | | | | | | | | | |
|---|-------------------------|--------------------------|--------------------|---|---|-------------------------|------------|--------------------------|--------------|-----------|
| FILE NAME = | USER NAME = woodshankr1 | DESIGNED - RON WOODSHANK | REVISED - | STATE OF ILLINOIS DEPARTMENT OF TRANSPORTATION | TRAFFIC CONTROL AND PROTECTION STANDARD 701400 (SPECIAL) | F.A.I. RTE. | SECTION | COUNTY | TOTAL SHEETS | SHEET NO. |
| ct:\pw_vork\pwtid\woodshankr1\d0143167\066A30-details.dgn | DRAWN - RON WOODSHANK | REVISED - | 55 | | | D3 PATCHING 2011-1 | LIVINGSTON | 16 | 11 | |
| PLOT SCALE = 1/8" = 1' IN. | CHECKED - | REVISED - | CONTRACT NO. 66A30 | | | | | | | |
| PLOT DATE = Mar 31, 2010 - 10:26:52 AM | DATE - | REVISED - | ILLINOIS | | | | | | | |
| | | | | | SCALE: _____ | SHEET NO. 1 OF 1 SHEETS | | STA. _____ TO STA. _____ | | |

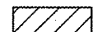

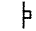
SEE TRAFFIC CONTROL AND PROTECTION STANDARD 701400 (SPECIAL) FOR APPROACH TO LANE CLOSURE DETAILS

SYMBOLS

-  ARROW BOARD
-  WORK AREA
-  WORKER
-  SIGN
-  DIRECTION INDICATOR BARRICADE WITH STEADY BURN MONODIRECTIONAL LIGHT
-  TYPE II BARRICADES, DRUM OR VERTICAL BARRICADE WITH STEADY BURN MONODIRECTIONAL LIGHT
-  Flagger with traffic control sign

- ① REFLECTORIZED TEMPORARY PAVEMENT MARKING TAPE SHALL BE PLACED THROUGHOUT THE TAPER AND FOR 300' ALONGSIDE THE WORK AREA WHEN THE CLOSURE TIME IS GREATER THAN FOURTEEN DAYS. THE EDGE LINE SHALL BE WHITE FOR RIGHT LANE CLOSURES AND YELLOW FOR LEFT LANE CLOSURES. TEMPORARY RAISED REFLECTORIZED PAVEMENT MARKERS AT 25' CENTERS SHALL BE USED TO SUPPLEMENT THE PAVEMENT MARKING TAPE.
- ② WORK ZONE SPEED LIMITS SIGNS AND FLAGGER SIGNS SHALL BE MOVED AS NECESSARY TO MAINTAIN THE REQUIRED SPACING BETWEEN THE SIGNS AND THE WORKERS IN EACH SEPARATE WORK ACTIVITY.

GENERAL NOTES

THIS STANDARD IS USED WHERE AT ANY TIME ANY VEHICLE, EQUIPMENT, WORKERS OR THEIR ACTIVITIES WILL ENCROACH ON THE LANE ADJACENT TO THE SHOULDER OR ON THE SHOULDER WITHIN 24" OF THE EDGE OF PAVEMENT.

THIS STANDARD MUST ALWAYS BE USED IN COMBINATION WITH TRAFFIC CONTROL AND PROTECTION DETAIL 701400 (SPECIAL).

THIS STANDARD ALSO APPLIES WHEN WORK IS BEING PERFORMED IN THE LEFT LANE. UNDER THESE CONDITIONS, THE SET UP WOULD BE A MIRROR IMAGE TO WHAT IS SHOWN.

A CHECK BARRICADE SHALL BE PLACED IN THE MIDDLE OF THE CLOSED LANE AND AT THE SHOULDER AT 1000' CENTER.

| | | | | | | | | | | |
|--|-------------------------|--------------------------|--------------------|---|---|-------------------------|------------|--------------------------|--------------|-----------|
| FILE NAME = | USER NAME = woodshankr1 | DESIGNED - RON WOODSHANK | REVISED - | STATE OF ILLINOIS DEPARTMENT OF TRANSPORTATION | TRAFFIC CONTROL AND PROTECTION STANDARD 701401 (SPECIAL) | F.A.I. RTE. | SECTION | COUNTY | TOTAL SHEETS | SHEET NO. |
| c:\pwwork\pwwork\woodshankr1\d0143167\066A30-details.dgn | DRAWN - RON WOODSHANK | REVISED - | 55 | | | D3 PATCHING 2011-1 | LIVINGSTON | 16 | 12 | |
| PLOT SCALE = 100.0000' / IN. | CHECKED - | REVISED - | CONTRACT NO. 66A30 | | | | | | | |
| PLOT DATE = Mar 31, 2010 - 10:26:57 AM | DATE - | REVISED - | ILLINOIS | | | | | | | |
| | | | | | SCALE: | SHEET NO. 1 OF 1 SHEETS | | STA. _____ TO STA. _____ | | |

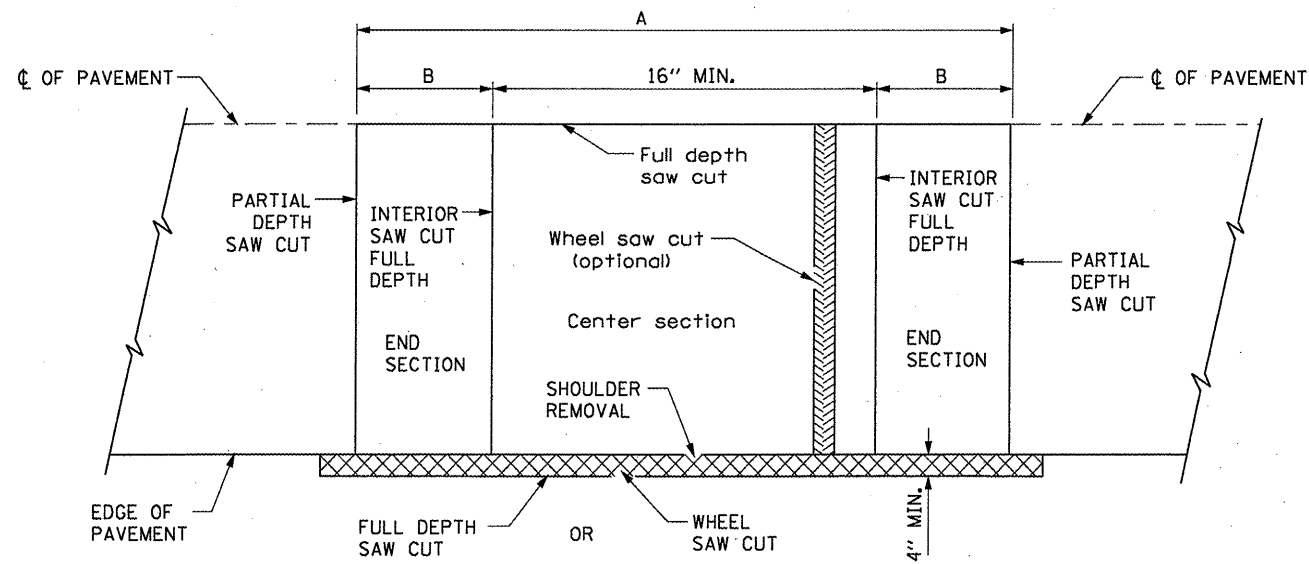

EXISTING PAVEMENT SAWING DETAIL
(AGAINST BITUMINOUS SHOULDER)

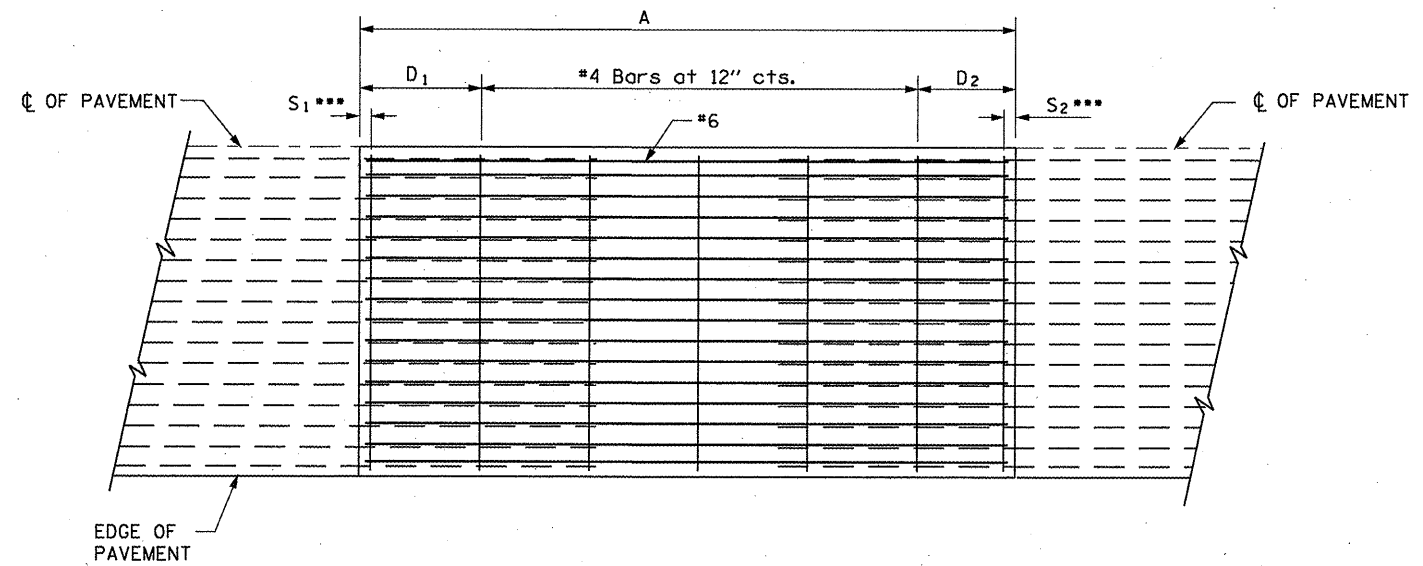

PROPOSED PAVEMENT DETAIL
(AGAINST CONCRETE SHOULDER)

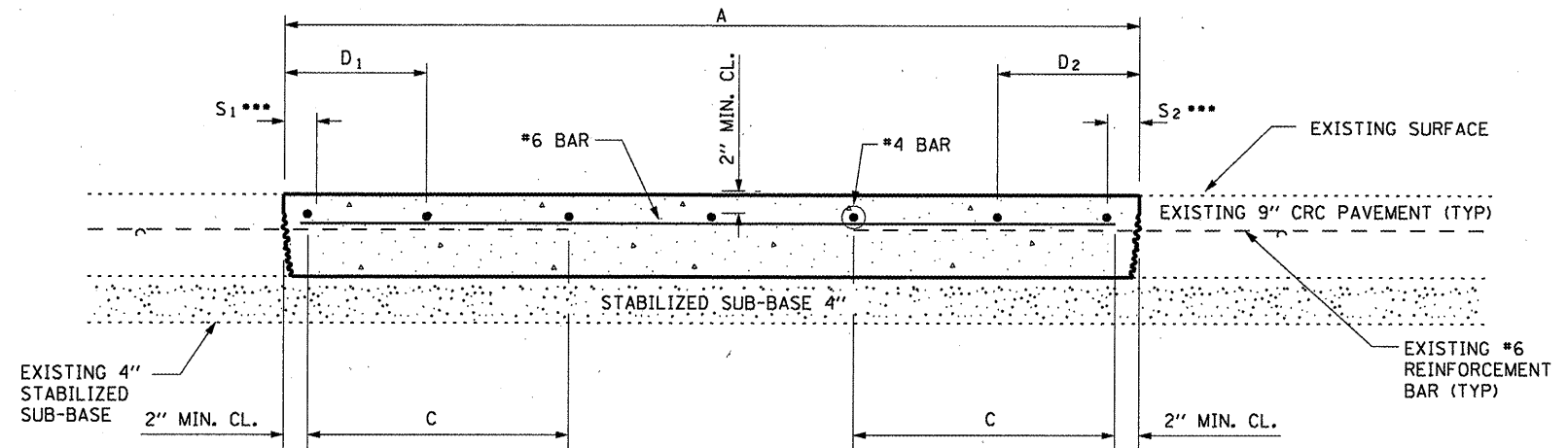

PROPOSED CLASS A PATCHING DETAIL

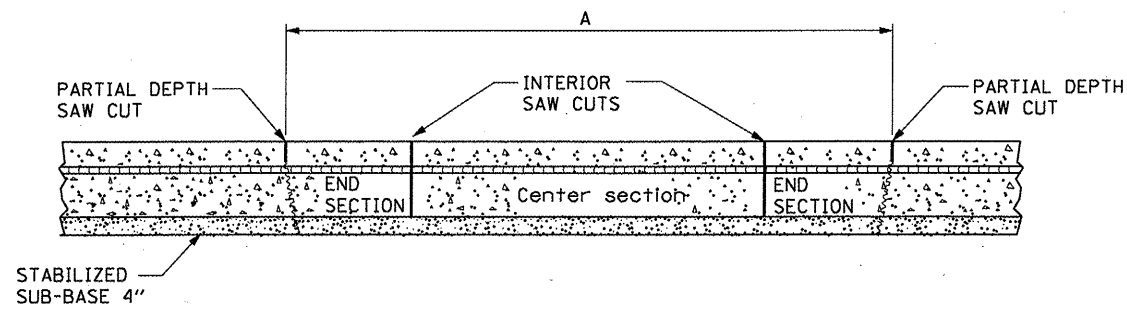

REMOVAL DETAIL

| EXISTING LONGITUDINAL REINFORCEMENT BARS | A (min.) | B (min.) | C (min.) |
|--|----------|----------|----------|
| No. 6 | 6'-0" | 21" | 19" |

NOTES:

- EVERY 3rd INTERSECTION MUST BE TIED
- LAP NEW REINFORCEMENT WITH EXISTING LONGITUDINAL REINFORCEMENT
- VARIABLES: WHERE S_1 AND S_2 ARE $2\frac{1}{2}$ " MIN. AND 12" MAX. $D_1 = 2(S_1)$ AND $D_2 = 2(S_2)$

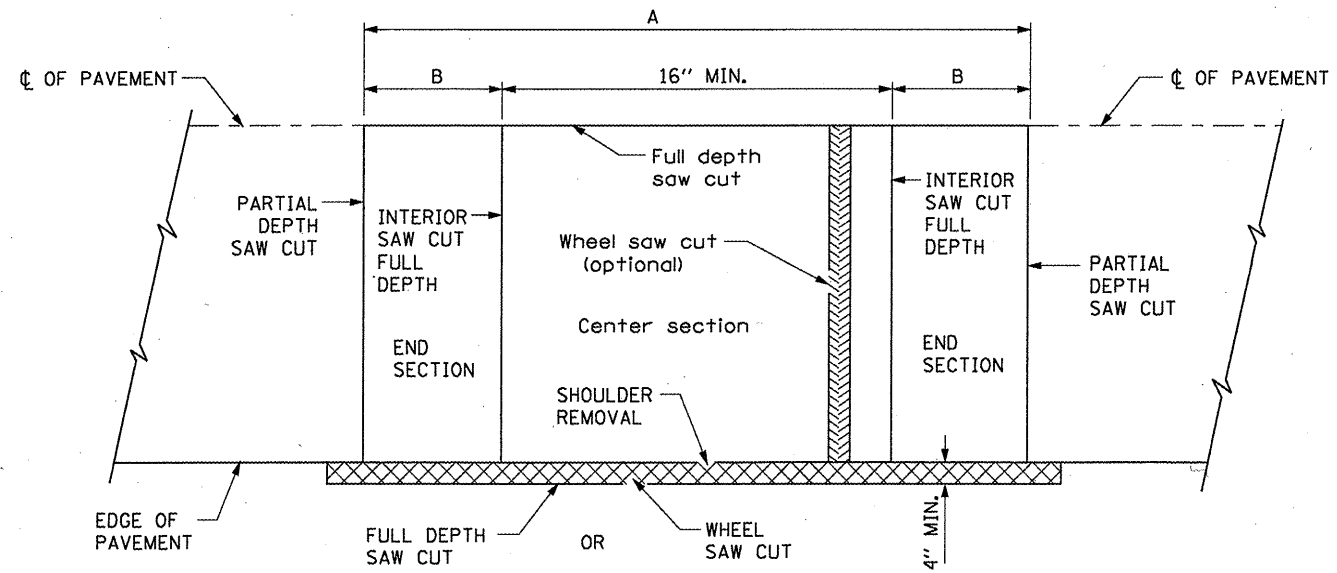

EXISTING PAVEMENT SAWING DETAIL
(AGAINST BITUMINOUS SHOULDER)

| EXISTING LONGITUDINAL REINFORCEMENT BARS | A (min.) | B (min.) | C (min.) |
|--|----------|----------|----------|
| No. 6 | 6'-0" | 24" | 19" |

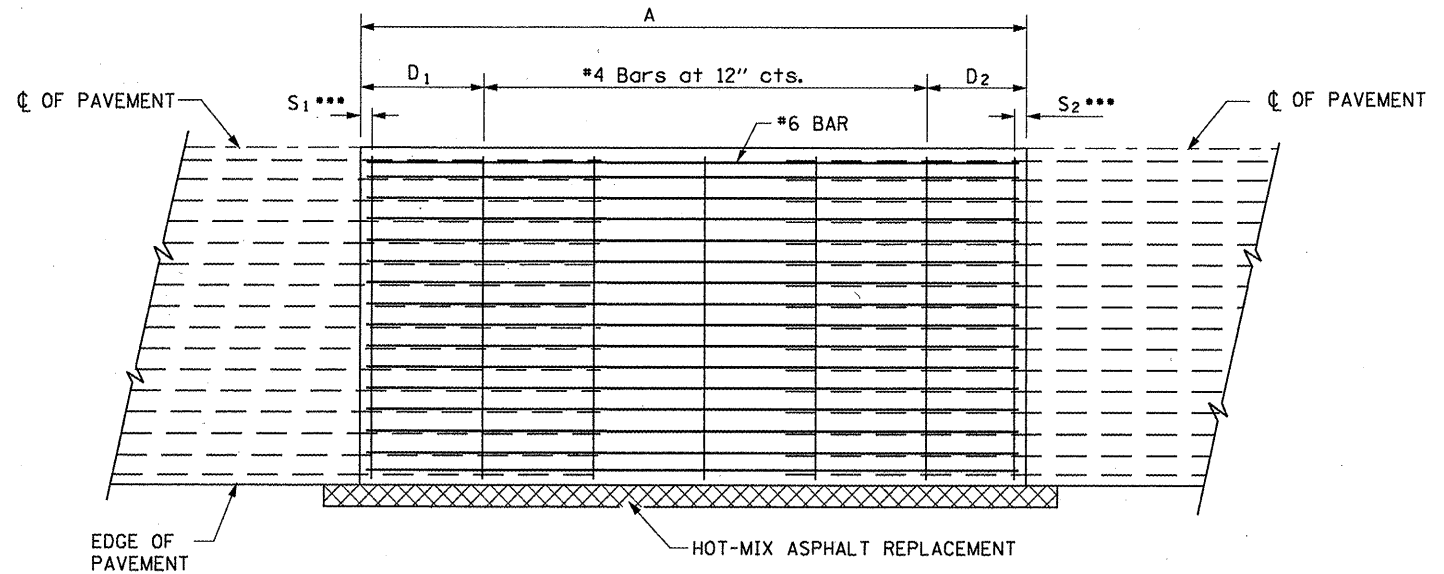

PROPOSED PAVEMENT DETAIL
(AGAINST BITUMINOUS SHOULDER)

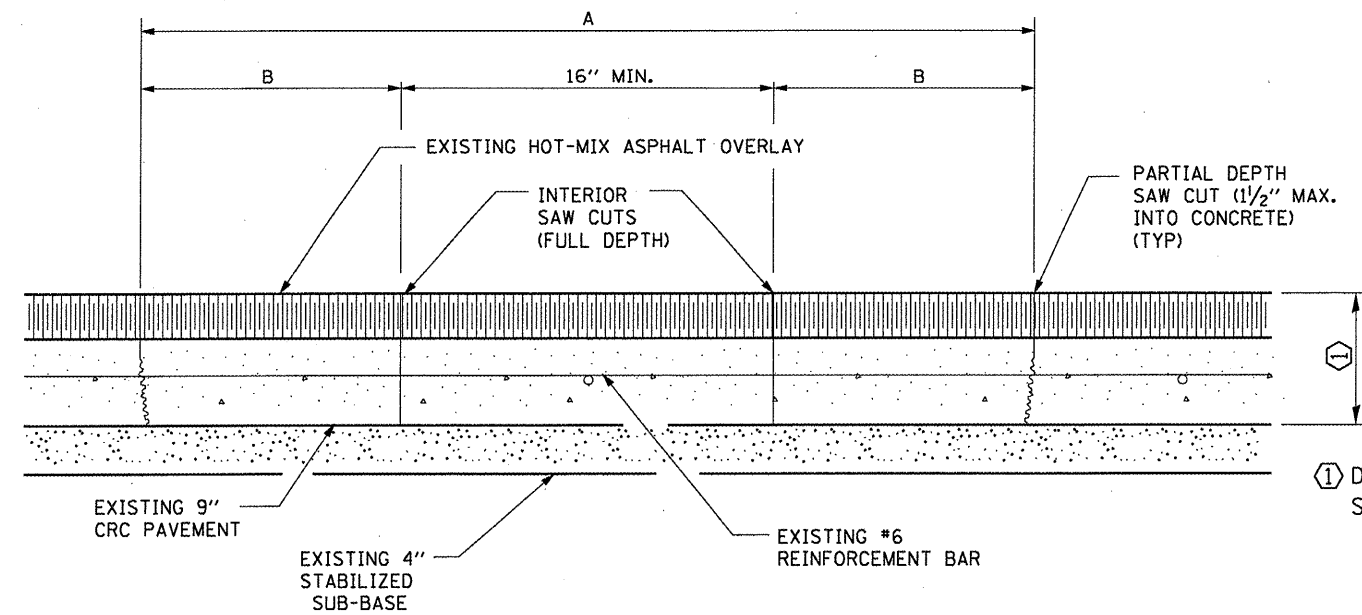

EXISTING PAVEMENT
SAW CUTTING DETAIL

① DEPTH VARIES
SEE TYPICAL SECTIONS

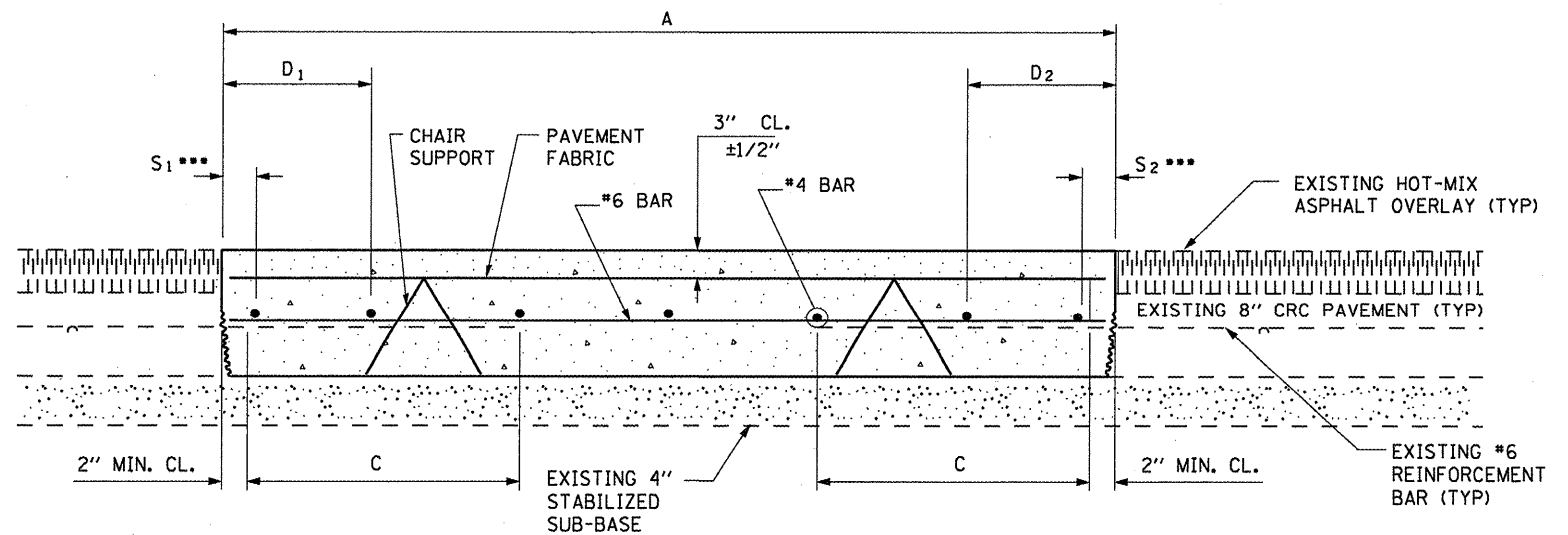

PROPOSED CLASS A PATCHING DETAIL

NOTES:

- EVERY 3rd INTERSECTION MUST BE TIED
- LAP NEW REINFORCEMENT WITH EXISTING LONGITUDINAL REINFORCEMENT
- VARIABLES: WHERE S₁ AND S₂ ARE 2 1/2" MIN. AND 12" MAX. D₁ = 2(S₁) AND D₂ = 2(S₂)

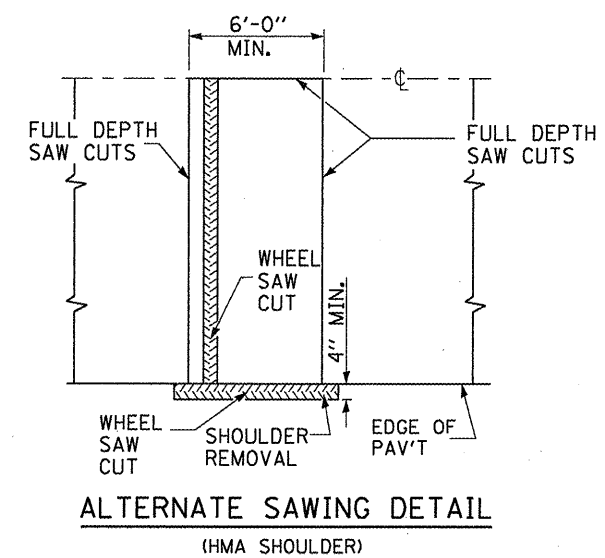
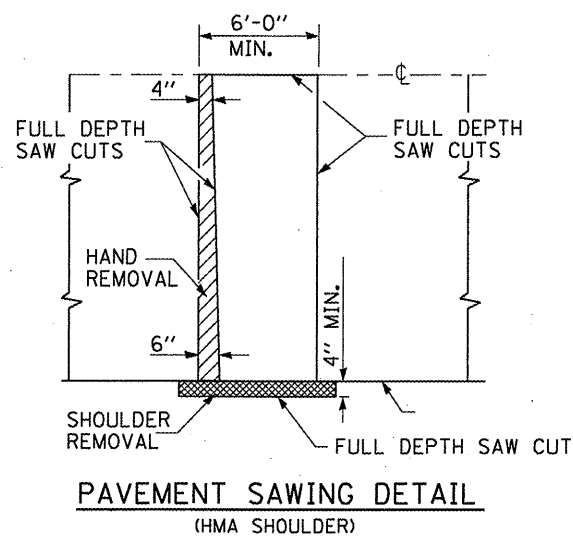
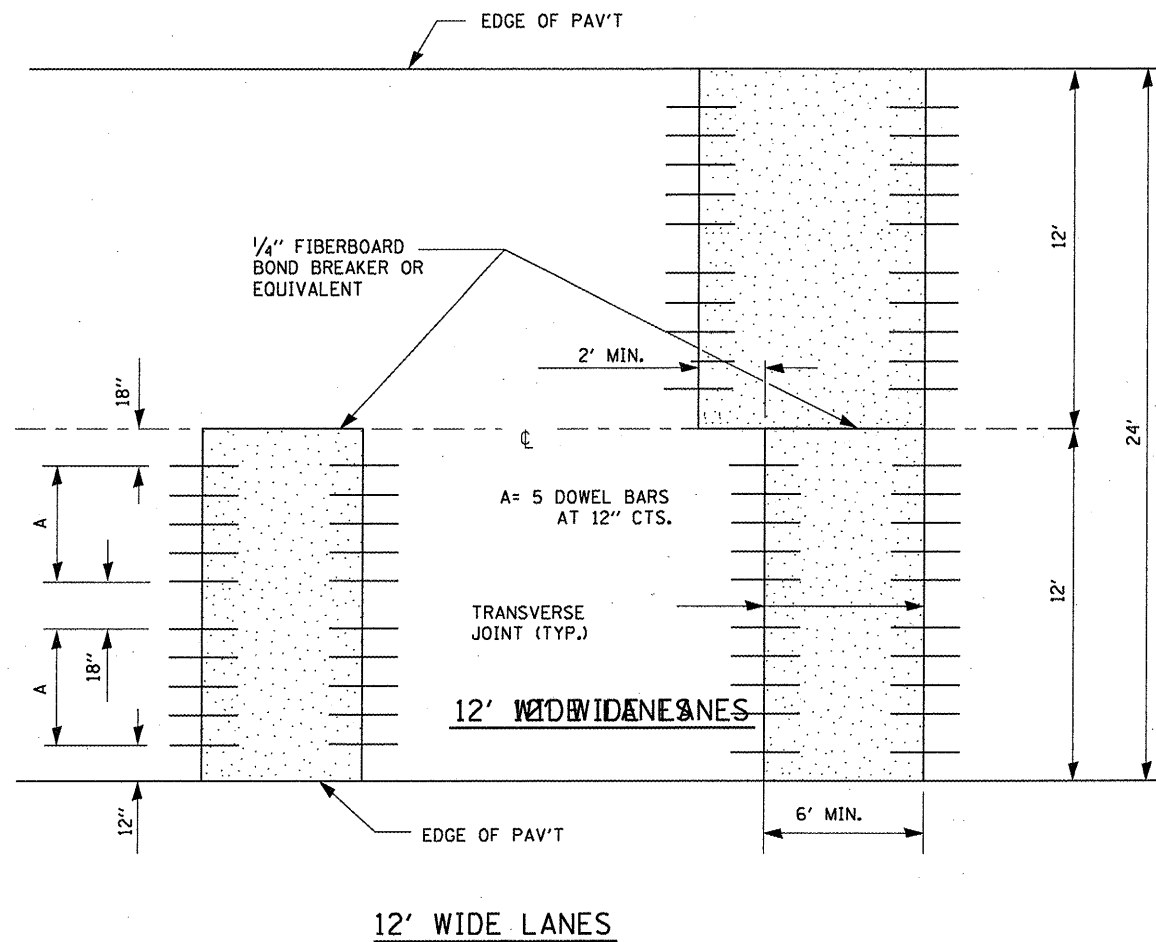

| DOWEL BAR TABLE | | |
|--------------------|--------------------|---------------|
| PAVEMENT THICKNESS | DOWEL BAR DIAMETER | HOLE DIAMETER |
| 8" OR GREATER | 1 1/2" | 1 5/8" |
| 7" THRU 7.99" | 1 1/4" | 1 3/8" |
| LESS THAN 7" | 1" | 1 1/8" |

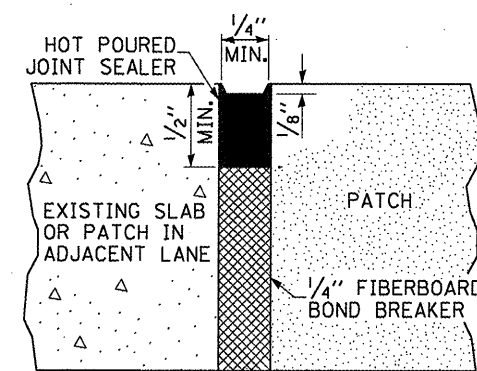

SEALING DETAIL
CENTERLINE JOINT

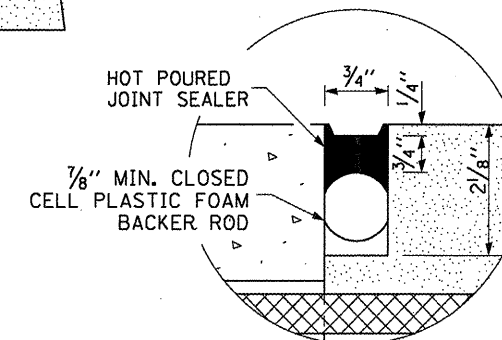

SEALING DETAIL
TRANSVERSE JOINT

GENERAL NOTES

THE TRANSVERSE JOINTS FOR CLASS B PATCHES SHALL ALIGN WITH JOINTS OR CRACKS IN THE ADJACENT LANE WHENEVER POSSIBLE.
SEE STANDARD 420701 FOR DETAILS OF PAVEMENT FABRIC.

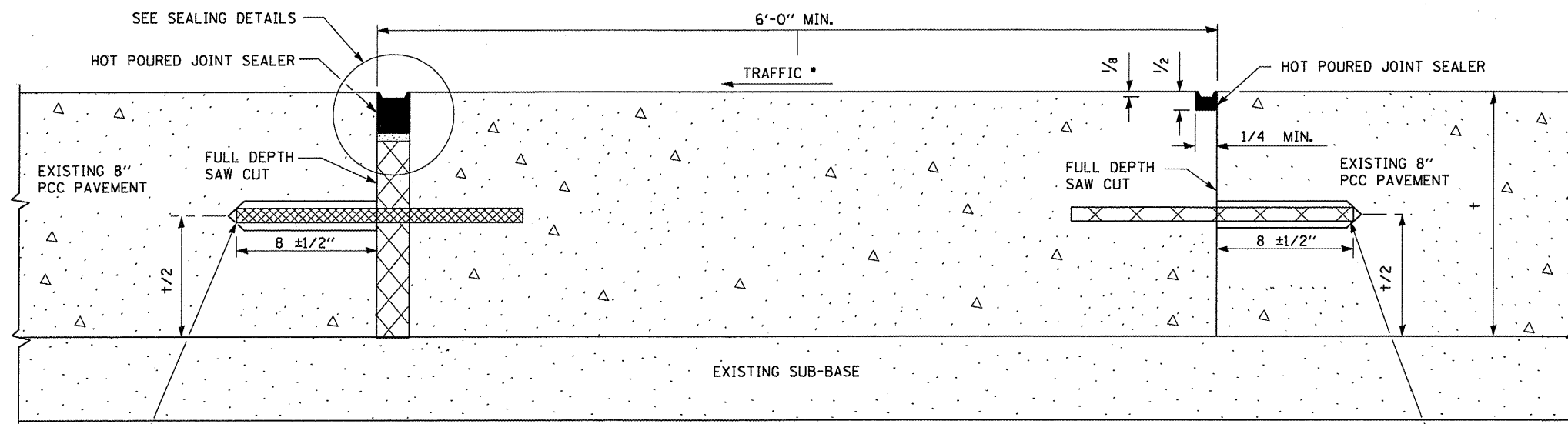

CLASS B PATCH

18 (450) Long dowel bars anchored into existing pavement at 12 (300) cts.

No. 10x18 (No. 32x450) Tie bars anchored into existing pavement at 12 (300) cts.

| | | | |
|---|-------------------------|--------------------------|-----------|
| FILE NAME = | USER NAME = woodshankr1 | DESIGNED - RON WOODSHANK | REVISED - |
| ct:\p\work\p\dot\woodshankr1\d0143167\0366A3B-details.dgn | | DRAWN - RON WOODSHANK | REVISED - |
| PLOT SCALE = 100.0000' / IN. | | CHECKED - | REVISED - |
| PLOT DATE = Mar 31, 2010 - 10:27:12 AM | | DATE - | REVISED - |

STATE OF ILLINOIS
DEPARTMENT OF TRANSPORTATION

CLASS B PATCHING DETAILS

SCALE: _____ SHEET NO. 1 OF 1 SHEETS STA. _____ TO STA. _____

| | | | | |
|-------------|--------------------|------------|--------------------|-----------|
| F.A.I. RTE. | SECTION | COUNTY | TOTAL SHEETS | SHEET NO. |
| 55 | D3 PATCHING 2011-1 | LIVINGSTON | 16 | 15 |
| ILLINOIS | | | CONTRACT NO. 66A30 | |

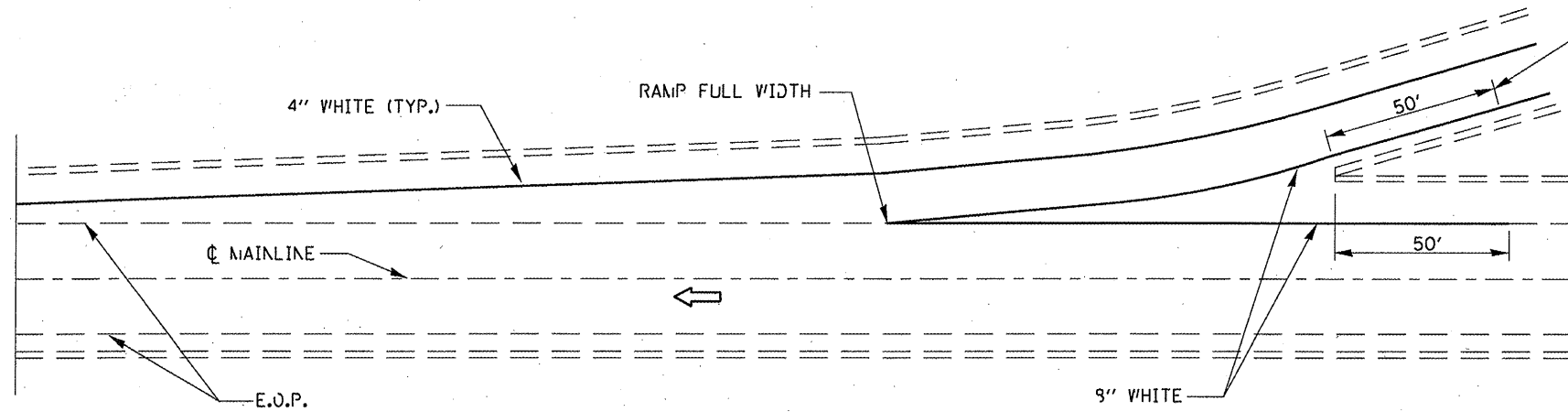

TYPICAL PAVEMENT MARKING FOR ENTRANCE RAMP TERMINALS

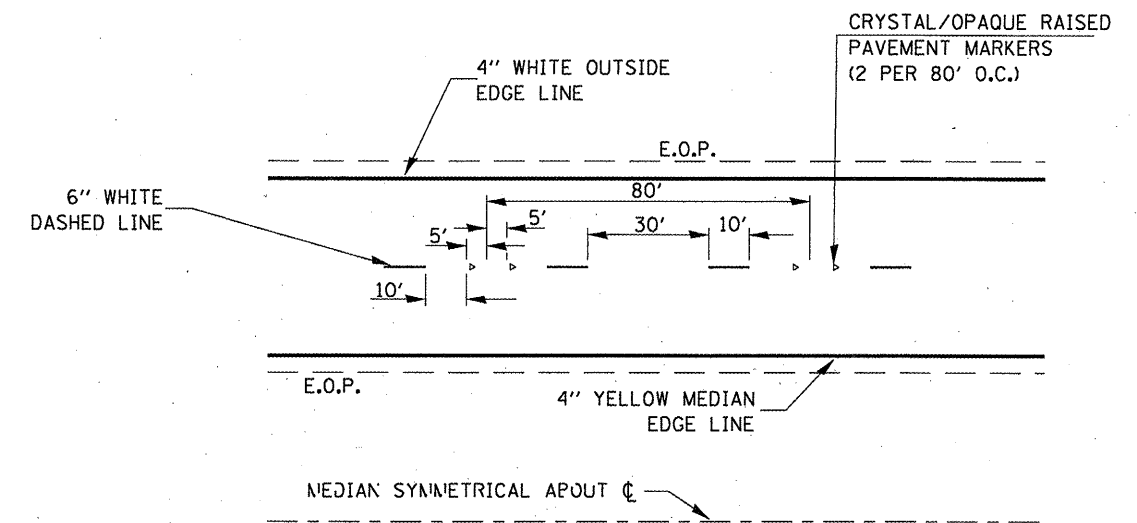

TYPICAL PAVEMENT MARKINGS

NOTE:
 WHEN PATCHING IS ADJACENT TO 8" PAVEMENT MARKING LINE THE 8" STRIP SHALL BE REPLACED WITH TWO 4" LINES.
 RAISED REFLECTIVE PAVEMENT MARKERS THAT FALL WITHIN PATCHED BOUNDARIES WILL NOT BE REPLACED.

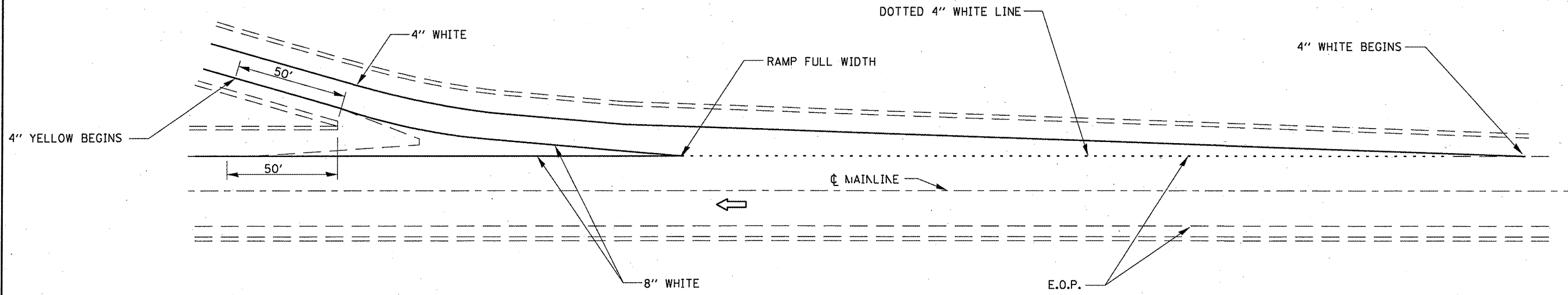

TYPICAL PAVEMENT MARKINGS FOR EXIT RAMP TERMINALS

| | | | | | | | | | | |
|---|-------------------------|--------------------------|--------------------|---|---------------------------------|--------------------|------------|--------|--------------|-----------|
| FILE NAME = | USER NAME = woodshankr1 | DESIGNED - RON WOODSHANK | REVISED - | STATE OF ILLINOIS DEPARTMENT OF TRANSPORTATION | TYPICAL PAVEMENT MARKING | F.A.I. RTE. | SECTION | COUNTY | TOTAL SHEETS | SHEET NO. |
| 02\pvt\work\pvt\dot\woodshankr1\d0143167\0366A30-details.dgn | DRAWN - RON WOODSHANK | REVISED - | 55 | | | D3 PATCHING 2011-1 | LIVINGSTON | 16 | 16 | |
| PLOT SCALE = 100.0000' / IN. | CHECKED - | REVISED - | CONTRACT NO. 66A30 | | | | | | | |
| PLOT DATE = Mar 31, 2010 - 10:27:17 AM | DATE - | REVISED - | ILLINOIS | | | | | | | |
| SCALE: _____ SHEET NO. 1 OF 1 SHEETS STA. _____ TO STA. _____ | | | | | | | | | | |