

F.A.P. RTE.	SECTION	COUNTY	TOTAL SHEETS	SHEET NO.
587	(22BR)I-1	BUREAU	6	1
FED. ROAD DIST. NO.	ILLINOIS	CONTRACT NO. 66A46		

INDEX OF SHEETS

1. COVER SHEET
2. GENERAL NOTES
3. SUMMARY OF QUANTITIES
4. TYPICAL SECTION
5. PLAN AND ELEVATION - SN 006-0147
6. REPAIR DETAILS

STANDARDS

- |           |  |
|-----------|--|
| 001006    | DECIMAL OF AN INCH AND OF A FOOT   |
| 701001-02 | OFF-ROAD OPERATIONS 2L, 2W, MORE THAN 4.5 m (15') AWAY                     |
| 701006-03 | OFF-ROAD OPERATIONS 2L, 2W, 4.5 m (15') TO 600 mm (24") FROM PAVEMENT EDGE |
| 701201-03 | LANE CLOSURE, 2L, 2W, DAY ONLY, FOR SPEEDS $\geq$ 45 MPH                   |
| 701301-03 | LANE CLOSURE, 2L, 2W, SHORT TIME OPERATIONS                                |
| 701901-01 | TRAFFIC CONTROL DEVICES  |

**STATE OF ILLINOIS**  
**DEPARTMENT OF TRANSPORTATION**  
**DIVISION OF HIGHWAYS**

**PROPOSED**  
**HIGHWAY PLANS**

**FAP ROUTE 587 (US 34)**  
**SECTION (22BR)I-1**

**BUREAU COUNTY**  
**C-93-133-10**  
**DECK SLAB SUPPORT**

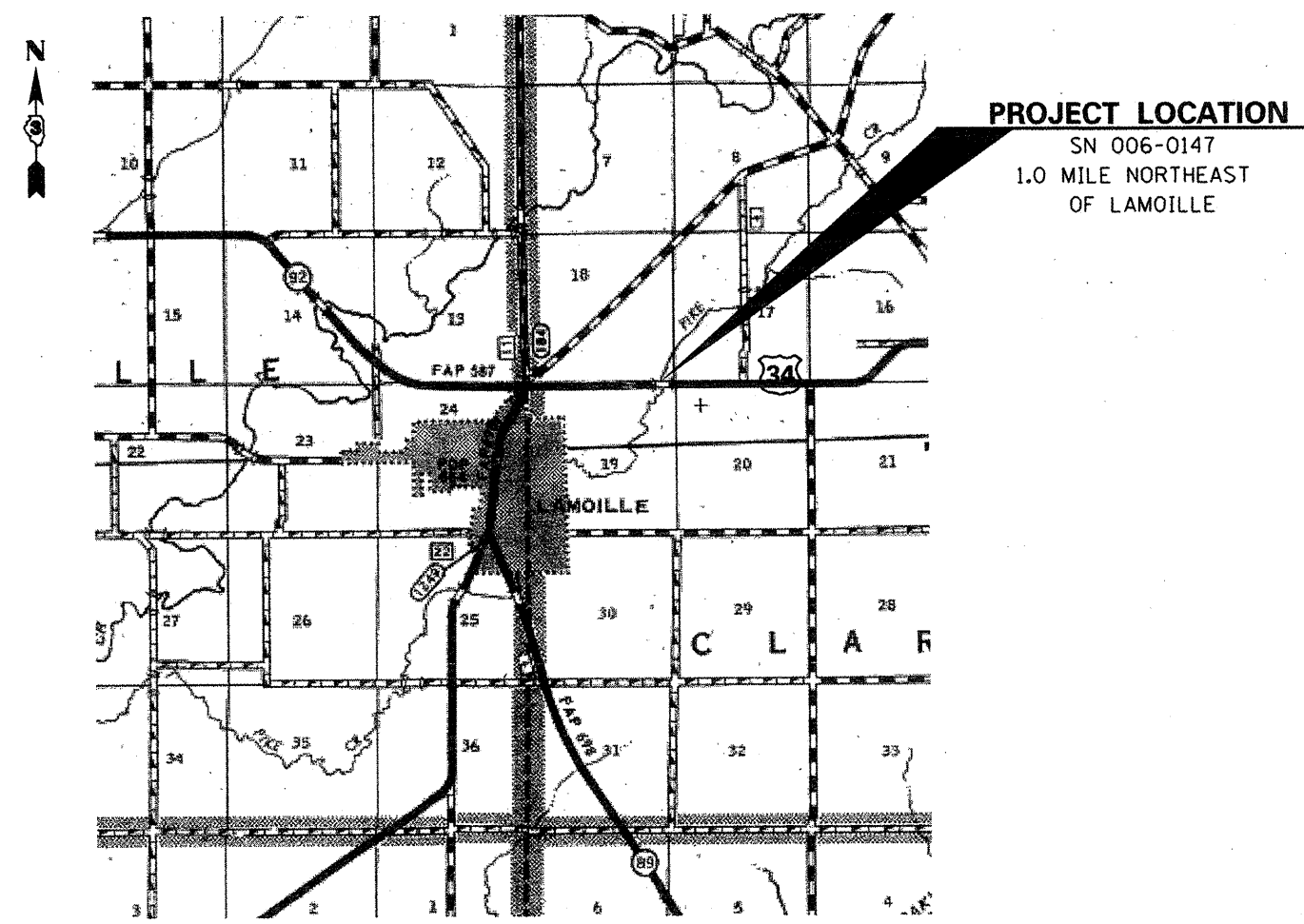
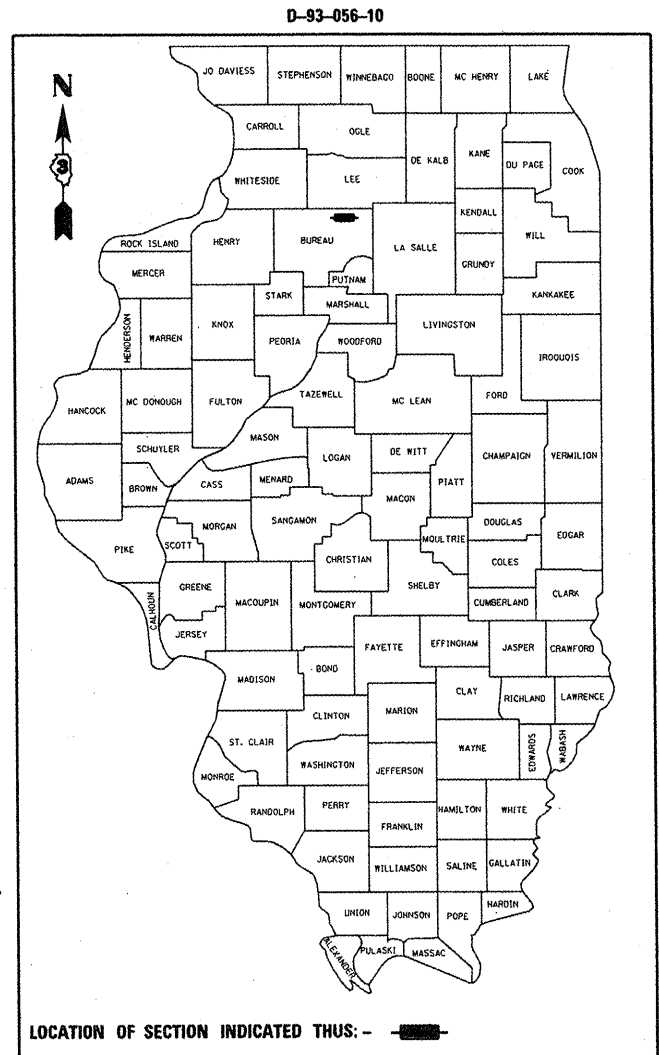

**FUNCTIONAL CLASSIFICATION**  
 RURAL - MINOR ARTERIAL  
 F.A.P. ROUTE 587 (US 34)  
 2007 ADT = 1850  
 P.V. = 89.2%    M.U. = 5.4%    S.U. = 5.4%

STATE OF ILLINOIS  
 DEPARTMENT OF TRANSPORTATION  
 DIVISION OF HIGHWAYS

SUBMITTED 4/11 2010  
  
 DEPUTY DIRECTOR OF HIGHWAYS, REGION ENGINEER  
May 7 2010  
 Scott E. Stich, P.E. /a  
 acting ENGINEER OF DESIGN AND ENVIRONMENT  
May 7 2010  
 Christene M. Reed, B.S.  
 DIRECTOR OF HIGHWAYS, CHIEF ENGINEER

**PRINTED BY THE AUTHORITY**  
**OF THE STATE OF ILLINOIS**

MICROFILMED \_\_\_\_\_  
 REEL NUMBER \_\_\_\_\_  
 AWARDED \_\_\_\_\_  
 RESIDENT ENGINEER \_\_\_\_\_  
 AS BUILT CHANGES WERE MADE  
 ON THE FOLLOWING SHEETS \_\_\_\_\_

J.U.L.I.E.  
 JOINT UTILITY LOCATION INFORMATION FOR EXCAVATION  
 1-800-892-0123

**PROJECT ENGINEER : JOE KANNEL**  
**UNIT CHIEF : RON WOODSHANK**  
**TOWNSHIP : CLARION**

**CONTRACT NO. 66A46**

**LOCATION MAP**  
 NOT TO SCALE  
 POINT LOCATION