

#4(#15) U BAR  
FOUR REQUIRED  
PER COLLAR

END VIEW

GENERAL NOTES

- The collar shall be constructed entirely of CLASS SI CONCRETE and in accordance with the applicable portions of section 503 of the Standard Specifications. REINFORCEMENT BARS shall conform to section 508.
- Expansion bolts shall consist of approved expansion anchors, and 3/4(M20) hook bolts which conform to Section 1006.09. These bolts shall extend at least 8(200) into the new concrete.

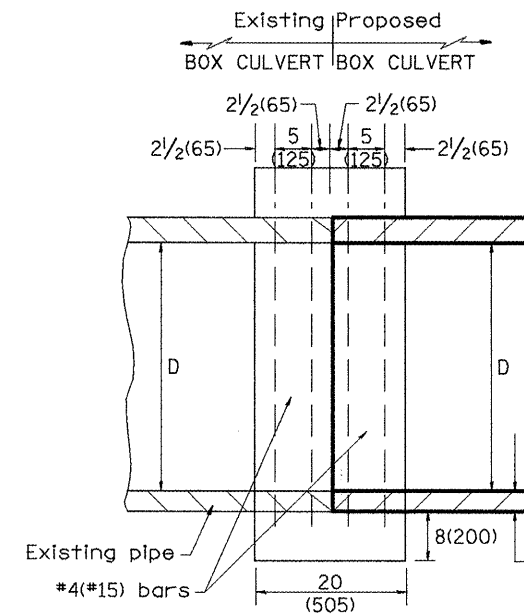

SECTION A - A

EXIST. BOX		PROP. BOX		CLASS SI CONCRETE			REBARS			EXPANSION BOLTS EACH	EXT. LENGTH		END SEC.
W	H	W'	H'	CU. YD. (m <sup>3</sup> )	A	B	T	X	Y		LBS. (kg)	LT.	
2	3	2	3	0.7	4'-4"	5'-4"	8"	3'-8"	3'-0"	26	N/A		

#4 BAR WEIGHT= 0.668LB/FT

FILE NAME = IL116CULCSAUG.dgn  
IL1165tAug.dgn

USER NAME = etc@horrntr  
PLOT SCALE = 20,0000' / IN.  
PLOT DATE = 4/21/2018

DESIGNED -  
DRAWN -  
CHECKED -  
DATE -

REVISED -  
REVISED -  
REVISED -  
REVISED -

STATE OF ILLINOIS  
DEPARTMENT OF TRANSPORTATION

CONCRETE COLLAR DETAIL  
NOT TO SCALE

SCALE: SHEET NO. OF SHEETS STA. TO STA.

F.A.P. RTE. 665 SECTION (140)I-1 COUNTY WARREN TOTAL SHEETS 18 SHEET NO. 11 CONTRACT NO. 68931 ILLINOIS FED. AID PROJECT