

F.A.P. RTE.	SECTION	COUNTY	TOTAL SHEETS	SHEET NO.
399	36N	TAZEWELL	9	1
ILLINOIS CONTRACT NO. 68937				

INDX

- 1 COVER SHEET
- 2-3 GENERAL NOTES
- 4 SUMMARY OF QUANTITIES
- 5 PLAN SHEET
- 6-7 TYPICAL SECTIONS
- 8 SCHEDULE OF QUANTITIES
- 9 TRAFFIC CONTROL PLAN SHEET
- HIGHWAY STANDARDS

STATE OF ILLINOIS
DEPARTMENT OF TRANSPORTATION
DIVISION OF HIGHWAYS

PROPOSED
HIGHWAY PLANS

FAP 399 BUSINESS ROUTE 24
SECTION 36N
TAZEWELL COUNTY

C94-002-10

R 3 W

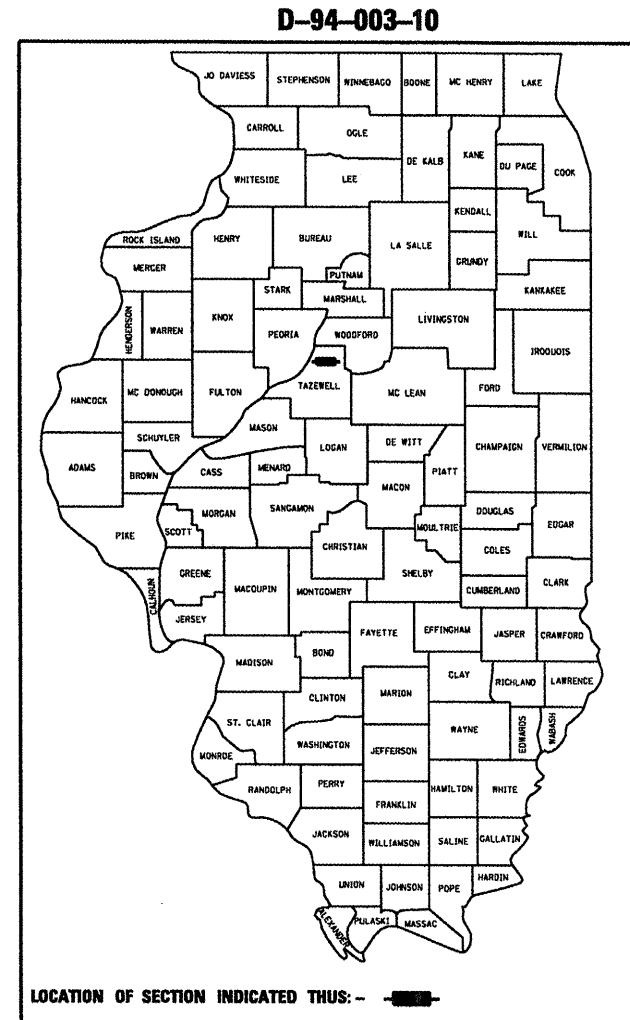

HIGHWAY STANDARDS

420001-07

606001-04

606301-04

701601-06

701701-06

701901-01

TRAFFIC DATA

ADT = 19500

SU = 550

MU = 250

GROSS LENGTH = 107 FT. = .002 MILE

J.U.L.I.E.
 JOINT UTILITY LOCATION INFORMATION FOR EXCAVATION
 1-800-892-0123
 OR 811

PROJECT ENGINEER RICH DOTSON 309-671-6455
PROJECT DESIGNER JOHN APPENZELLER 309-671-3481
CATALOG NO. 034330-00D
CONTRACT NO. 68937

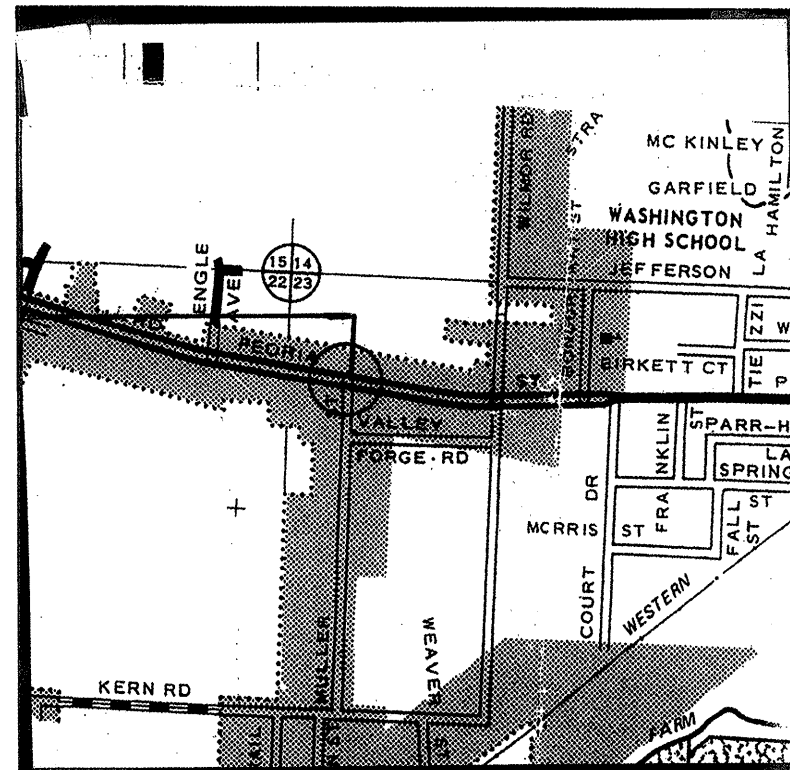
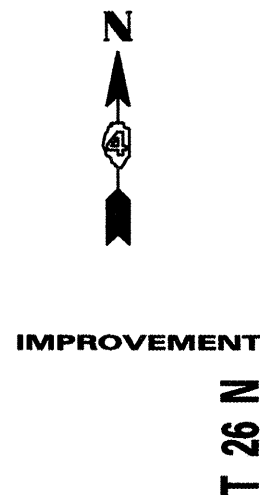

DESCRIPTION OF WORK

THIS PROJECT CONSISTS OF MEDIAN RECONSTRUCTION AT THE INTERSECTION OF BUS. 24 AND MULLER ROAD IN WASHINGTON. THE IMPROVEMENT WILL CONSIST OF PAVEMENT REMOVAL, CURB AND GUTTER REMOVAL, MEDIAN REMOVAL, NEW P.C.C. BASE COURSE, NEW CURB AND GUTTER, AND MEDIAN.

STATE OF ILLINOIS
 DEPARTMENT OF TRANSPORTATION
 DIVISION OF HIGHWAYS

SUBMITTED 3/26/10
[Signature]
 DEPUTY DIRECTOR OF HIGHWAYS, REGION ENGINEER

May 7 2010
 Scott E. Still, P.E.
 acting ENGINEER OF DESIGN AND ENVIRONMENT

May 7 2010
[Signature]
 CHRISTINE M. REEDER
 DIRECTOR OF HIGHWAYS, CHIEF ENGINEER

PRINTED BY THE AUTHORITY
OF THE STATE OF ILLINOIS

COMMITMENTS

THERE ARE NO COMMITMENTS FOR THIS PROJECT.

PROPERTY OWNER ACCESS REQUIREMENT

ACCESS MUST BE MAINTAINED TO ALL EXISTING PROPERTIES DURING CONSTRUCTION PER ARTICLE 107.09 UNLESS ARRANGEMENTS ARE MADE IN WRITING BY THE CONTRACTOR WITH THE PROPERTY OWNERS WITH A COPY TO THE ENGINEER FOR SHORT-TERM CLOSURES.

ENVIRONMENTAL REVIEWS

PRIOR TO THE USE OF ANY PROPOSED BORROW AREAS, USE AREAS (TEMPORARY ACCESS ROADS, DETOURS, RUN-AROUNDS, ETC.) AND OR WAST AREAS, THE CONTRACTOR SHALL FILE THE REQUIRED ENVIRONMENTAL RESOURCE REQUEST SURVEYS ACCORDING TO SECTION 107.22 OF THE STANDARD SPECIFICATIONS. THESE SURVEYS ARE REQUIRED IN ORDER FOR THE DEPARTMENT TO CONDUCT CULTURAL AND BIOLOGICAL RESOURCE SURVEYS FOR THE PROPOSED SITE.

PRIOR TO ANY WASTE MATERIALS BEING REMOVED FROM THE CONSTRUCTION SITE THE REQUIRED ENVIRONMENTAL RESOURCE SURVEYS WILL NEED TO BE OBTAINED AND FILED BY THE CONTRACTOR. EXCESS WASTE PRODUCTS REMOVED FROM THE CONSTRUCTION SITE SHALL BE DISPOSED OF AS REQUIRED IN SECTION 202.03 OF THE STANDARD SPECIFICATIONS.

ANY PROTRUDING METAL BARS SHALL BE REMOVED PRIOR TO THE DISPOSAL OF BROKEN CONCRETE AT APPROVED SITES.

THE REQUIRED ENVIRONMENTAL RESOURCE DOCUMENTATION SHALL INCLUDE THE FOLLOWING:

BDE FORM 2289 (ENVIRONMENTAL SURVEY REQUEST)
A LOCATION MAP SHOWING THE SIZE LIMITS AND LOCATION OF THE USE AREA
SIGNED PROPERTY OWNER AGREEMENT FORM - D4 PI0100
COLOR PHOTOGRAPHS DEPICTING THE USE AREA
BORROW AREA ENTRY AGREEMENT FORM - D4 PI0100

PLEASE NOTE THAT A MINIMUM OF TWO WEEKS SHALL BE ALLOWED FOR THE DISTRICT TO OBTAIN THE REQUIRED ENVIRONMENTAL CLEARANCES.

FILE NAME = us24bus_miller.dgn	USER NAME = eppenzeilerJJ	DESIGNED - DRAWN -	REVISED - REVISED -	STATE OF ILLINOIS DEPARTMENT OF TRANSPORTATION	GENERAL NOTES AND COMMITMENTS	F.A.P. RTE. 399	SECTION 36N	COUNTY TAZEWELL	TOTAL SHEETS 9	SHEET NO. 2	
PLOT SCALE = 1/4" = 1' / IN.	CHECKED -	REVISED -	SCALE:			SHEET NO.	OF	SHEETS	STA.	TO STA.	CONTRACT NO. 68937
PLOT DATE = 3/18/2010	DATE -	REVISED -	ILLINOIS FED. AID PROJECT								

MEDIAN AND ISLAND NOSES

WHEN CONSTRUCTING MEDIAN AND ISLAND NOSES THE FOLLOWING CRITERIA SHOULD BE FOLLOWED.

BARRIER CURB SHALL BE USED TO CONSTRUCT NOSES WHEN THE MEDIAN OR ISLAND SURROUNDS A MAST ARM OR OTHER NON-BREAKAWAY FOUNDATION.

RAMPED NOSES SHALL BE USED ON MEDIANS OR ISLANDS WITH BREAKAWAY POSTS.

TRANSITION PAYMENT METHOD - NEW/OLD CONSTRUCTION

TEN FEET (10 FT.) (3M) TRANSITIONS SHALL BE USED TO MATCH PORPOSED ITEMS OF WORK TO EXISTING ITEMS IN THE FIELD UNLESS OTHERWISE SHOWN. THE TRANSITION SHALL BE PAIDFOR AT THE CONTRACT UNIT PRICE FOR THE PROPOSED ITEM OF WORK SPECIFIED.

FILE NAME = us24bus_muller.dgn	USER NAME = eppenzellerjj	DESIGNED -	REVISED -	STATE OF ILLINOIS DEPARTMENT OF TRANSPORTATION	GENERAL NOTES AND COMMITMENTS	F.A.P. RTE.	SECTION	COUNTY	TOTAL SHEETS	SHEET NO.
	PLOT SCALE = 1/4" = 124.4573' / IN.	CHECKED -	REVISED -			399	36N	TAZEWELL	9	3
	PLOT DATE = 3/18/2010	DATE -	REVISED -			CONTRACT NO. 68937		ILLINOIS FED. AID PROJECT		
SCALE:						SHEET NO.	OF	SHEETS	STA.	TO STA.

Summary of Quantities

Code Order

ROUTE		SECTION	COUNTY	SHEET	
FAP	399	36N	TAZEWELL	TOTAL	NO.
BUS	24			9	4
			CONTRACT NO.	68937	

CONSTRUCTION TYPE CODE

100% STATE

URBAN

SFTY-2A

CODE No.	ITEM	UNIT	Tot.QTY		
20200100	EARTH EXCAVATION	CU YD	34.6	34.6	
35300610	PORTLAND CEMENT CONCRETE BASE COURSE 11 1/2"	SQ YD	202	202	
44000100	PAVEMENT REMOVAL	SQ YD	67	67	
44000500	COMBINATION CURB AND GUTTER REMOVAL	FOOT	156	156	
44003100	MEDIAN REMOVAL	SQ FT	160	160	
60605000	COMB. CONC. CURB AND GUTTER, TYPE B-6.24	FOOT	67	67	
60620000	CONCRETE MEDIAN, TYPE SB-6.24	SQ FT	66	66	
67100100	MOBILIZATION	L SUM	1	1	
70101800	TRAFFIC CONTROL AND PROTECTION (SPECIAL)	L SUM	1	1	
70103815	TRAFFIC CONTROL SURVEILLANCE	CAL DA	10	10	

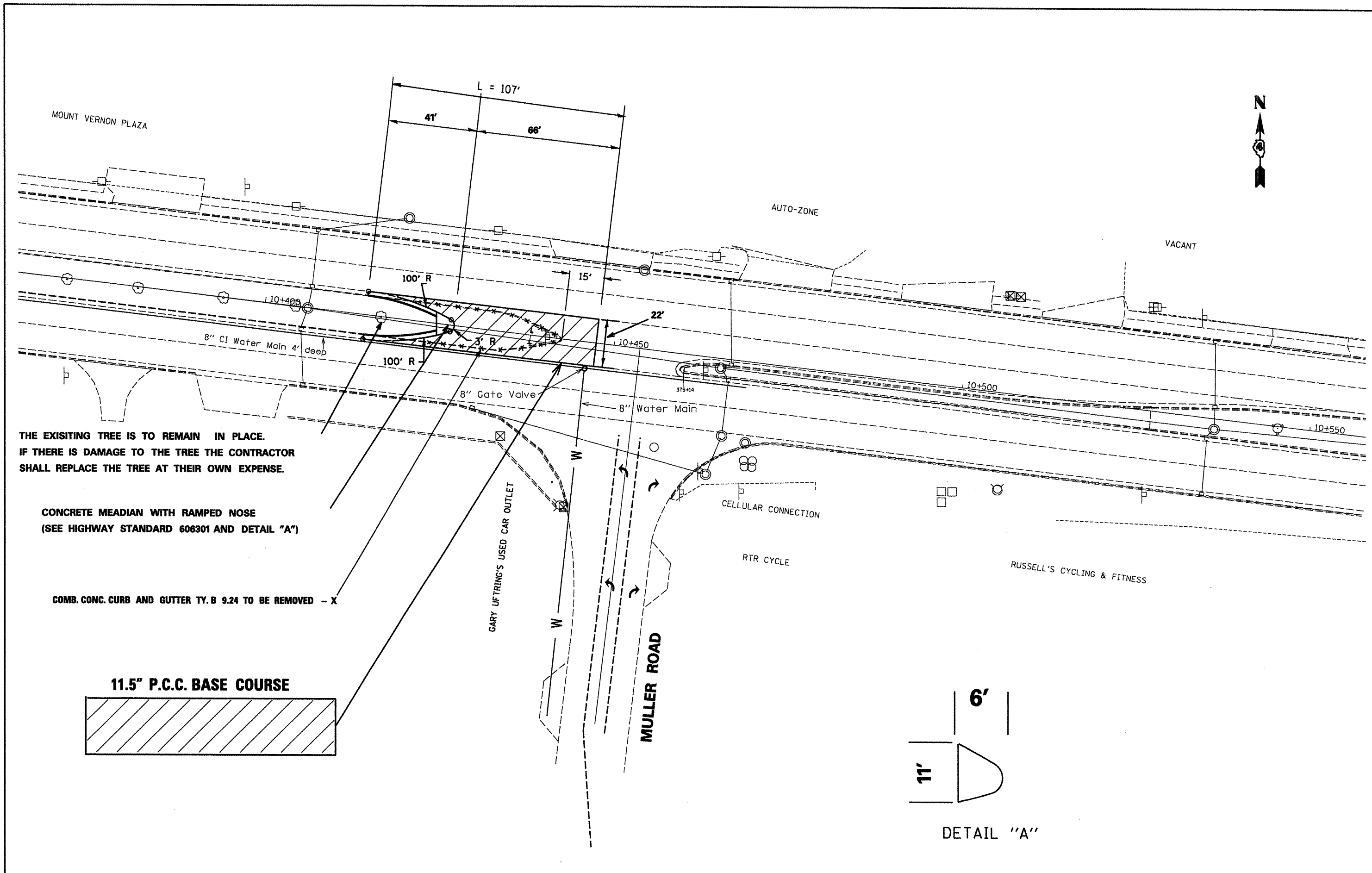

THE EXISTING TREE IS TO REMAIN IN PLACE.
 IF THERE IS DAMAGE TO THE TREE THE CONTRACTOR
 SHALL REPLACE THE TREE AT THEIR OWN EXPENSE.

CONCRETE MEADIAN WITH RAMPED NOSE
 (SEE HIGHWAY STANDARD 606301 AND DETAIL "A")

COMB. CONC. CURB AND GUTTER TY. B 9.24 TO BE REMOVED - X

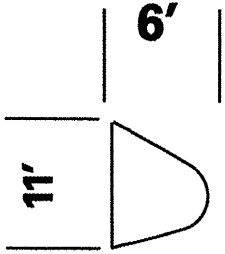
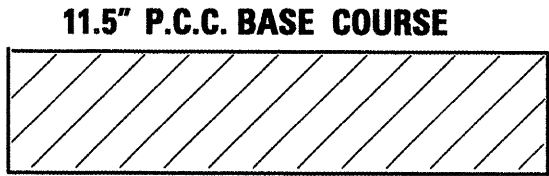

DETAIL "A"

FILE NAME = us24bus_muller.dgn

USER NAME = oppenzeller,jj	DESIGNED -	REVISED -
PLOT SCALE = 1/24.4573 ' / IN.	DRAWN -	REVISED -
PLOT DATE = 3/18/2010	CHECKED -	REVISED -
	DATE -	REVISED -

**STATE OF ILLINOIS
 DEPARTMENT OF TRANSPORTATION**

PLAN SHEET			
SCALE:	SHEET NO. OF SHEETS	STA.	TO STA.

F.A.P. RTE. 399	SECTION 36N	COUNTY TAZEWELL	TOTAL SHEETS 9	SHEET NO. 5
CONTRACT NO. 68937				
ILLINOIS FED. AID PROJECT				

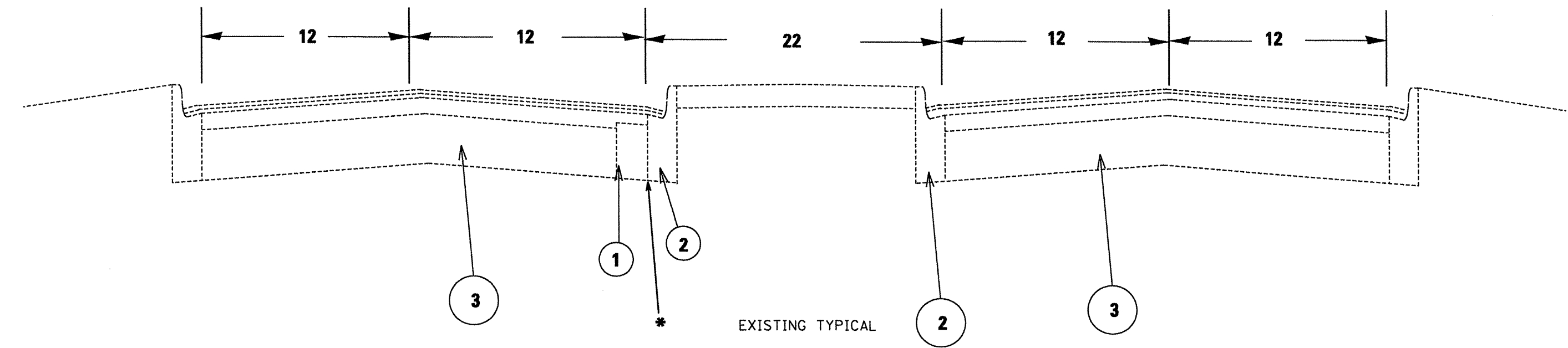

EXISTING TYPICAL

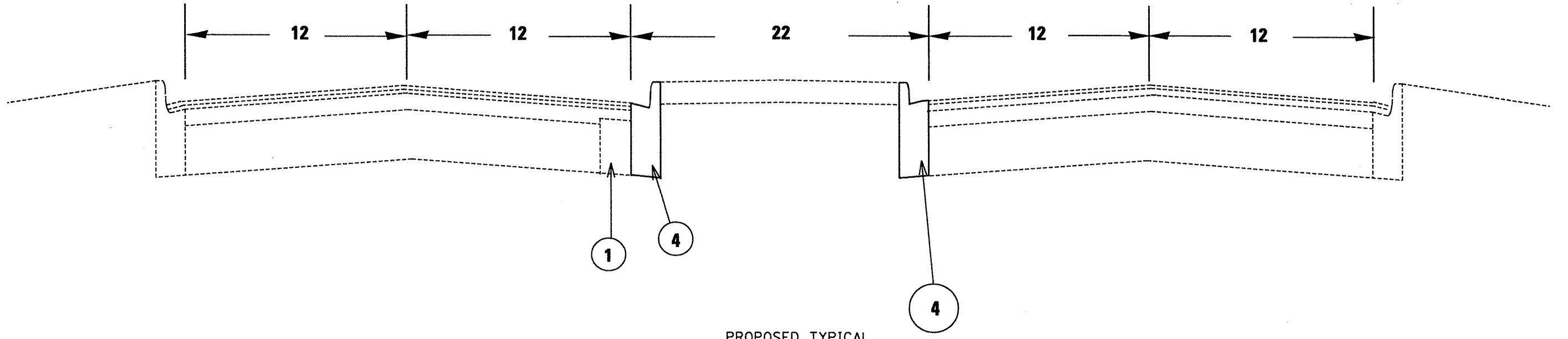

PROPOSED TYPICAL

* FULL DEPTH SAW CUT ALONG THE JOINT OF THE EXISTING WIDENING AND CURB AND GUTTER. INCLUDED IN THE COST OF CURB AND GUTTER REMOVAL.

- 1. EXISITING P.C.C. BASE COURSE WIDENING - 11.5 IN.
- 2. EXISTING COMB. CONC. CURB AND GUTTER TYPE B 9.24 TO BE REMOVED
- 3. EXISTING P.C.C. PAVEMENT
- 4. PROP. COMB. CONC. CURB AND GUTTER TYPE B 6.24
- 5. PROP. PCC BASE COURSE 11.5"

NOTE
SEEDING AND MULCH SHALL BE INCLUDED IN THE COST OF THE CURB AND GUTTER.

FILE NAME = us24bus_muller.dgn	USER NAME = appenzeller.jj	DESIGNED -	REVISED -	STATE OF ILLINOIS DEPARTMENT OF TRANSPORTATION	TYPICAL SECTION			F.A.P. RTE. 399	SECTION 36N	COUNTY TAZEWELL	TOTAL SHEETS 9	SHEET NO. 6
	PLOT SCALE = 1/4" = 1' IN.	CHECKED -	REVISED -					SCALE:	SHEET NO. OF SHEETS	STA. TO STA.	CONTRACT NO. 68937	
PLOT DATE = 3/18/2010	DATE -	REVISED -			ILLINOIS FED. AID PROJECT							

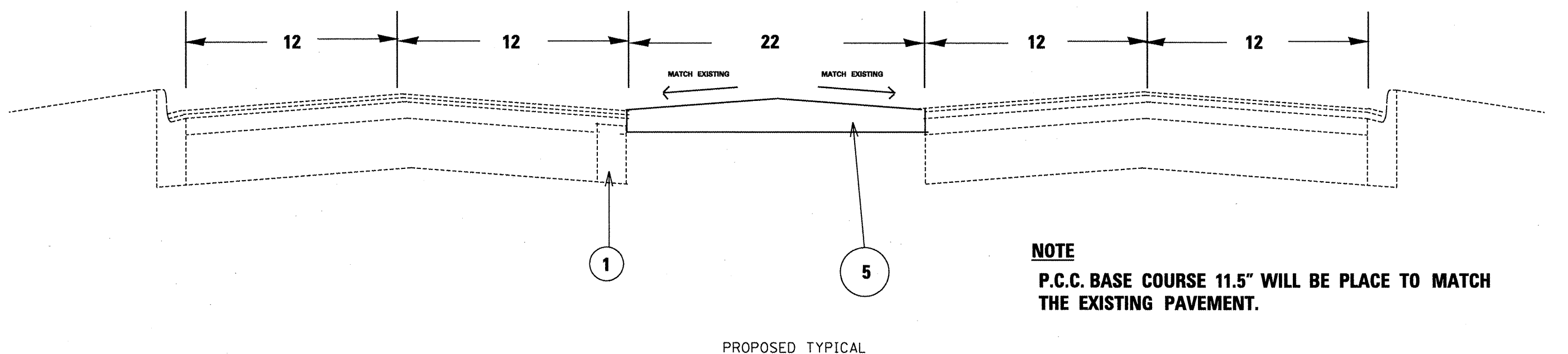
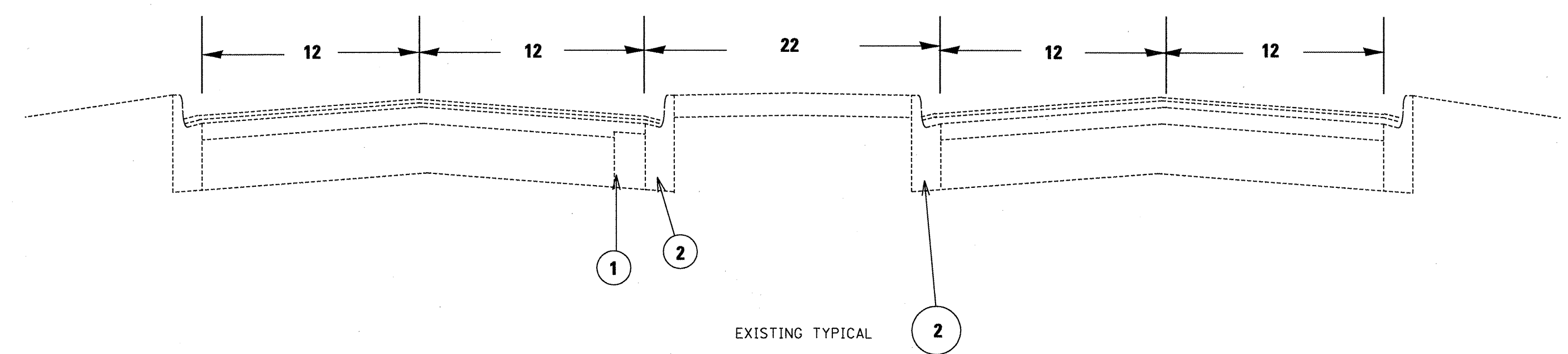

NOTE
P.C.C. BASE COURSE 11.5" WILL BE PLACE TO MATCH THE EXISTING PAVEMENT.

- 1. EXISITING P.C.C. BASE COURSE WIDENING – 11.5 IN.**
- 2. EXISTING COMB. CONC. CURB AND GUTTER TYPE B 9.24 TO BE REMOVED**
- 3. EXISTING P.C.C. PAVEMENT**
- 4. PROP. COMB. CONC. CURB AND GUTTER TYPE B 6.24**
- 5. PROP. PCC BASE COURSE 11.5"**

FILE NAME = us24bus.muller.dgn	USER NAME = appenzellerJJ	DESIGNED -	REVISED -	STATE OF ILLINOIS DEPARTMENT OF TRANSPORTATION	TYPICAL SECTION	F.A.P. RTE. 399	SECTION 36N	COUNTY TAZEWELL	TOTAL SHEETS 9	SHEET NO. 7		
	PLOT SCALE = 1/24.4298 ' / IN.	DRAWN -	REVISED -			SCALE:	SHEET NO. OF SHEETS	STA. TO STA.	CONTRACT NO. 68937			
	PLOT DATE = 3/26/2010	CHECKED -	REVISED -			ILLINOIS FED. AID PROJECT						
	DATE -	REVISED -										

EARTH EXCAVATION		
LOCATION	UNIT	QTY.
BUS. 24 AND MULLER ROAD	CU YD	34.6

PORTLAND CEMENT CONCRETE BASE COURSE 11.5"		
LOCATION	UNIT	QTY.
BUS. 24 AND MULLER ROAD	SQ YD	202

MEDIAN REMOVAL		
LOCATION	UNIT	QTY.
BUS. 24 AND MULLER ROAD	SQ FT	160

COMB. CONC. CURB AND GUTTER, TY B-6.24		
LOCATION	UNIT	QTY.
BUS. 24 AND MULLER ROAD	FOOT	67

TRAFFIC CONTROL AND PROTECTION (SPECIAL)		
LOCATION	UNIT	QTY.
BUS. 24 AND MULLER ROAD	L SUM	1

COMBINATION CURB AND GUTTER REMOVAL		
LOCATION	UNIT	QTY.
BUS. 24 AND MULLER ROAD	FOOT	156

CONCRETE MEDIAN, TY. SB-6.24		
LOCATION	UNIT	QTY.
BUS. 24 AND MULLER ROAD	SQ FT	66

PAVEMENT REMOVAL		
LOCATION	UNIT	QTY.
BUS. 24 AND MULLER ROAD	SQ YD	67

MOBILIZATION		
LOCATION	UNIT	QTY.
BUS. 24 AND MULLER ROAD	L SUM	1

TRAFFIC CONTROL SURVEILLANCE		
LOCATION	UNIT	QTY.
BUS. 24 AND MULLER ROAD	CAL DA	10

FILE NAME = us24bus.muller.dgn	USER NAME = eppenzeller.jj	DESIGNED - DRAWN -	REVISED - REVISED -
	PLDT SCALE = 1/24.4573' / IN.	CHECKED - DATE -	REVISED - REVISED -
	PLDT DATE = 3/18/2010		

STATE OF ILLINOIS
DEPARTMENT OF TRANSPORTATION

SCHEDULE OF QUANTITIES

SCALE: SHEET NO. OF SHEETS STA. TO STA.

F.A.P. RTE. 399	SECTION 36N	COUNTY TAZEWELL	TOTAL SHEETS 9	SHEET NO. 8
CONTRACT NO. 60937			ILLINOIS FED. AID PROJECT	



NO LEFT TURN
SIGNS R3-2

MOUNT VERNON PLAZA

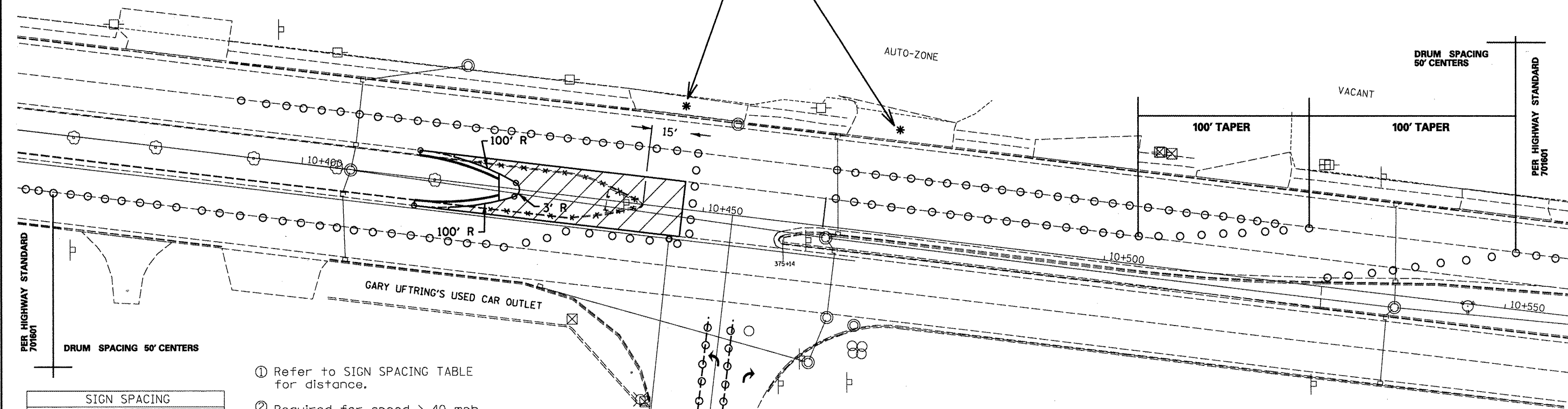

SIGN SPACING	
Posted Speed	Sign Spacing
55	500' (150 m)
50-45	350' (100 m)
<45	200' (60 m)

- ① Refer to SIGN SPACING TABLE for distance.
- ② Required for speed > 40 mph.
- ③ Cones at 25' (8 m) centers for 250' (75 m). Additional cones may be placed at 50' (15 m) centers. When drums or Type I or Type II barricades are used, the interval between devices may be doubled.
- ④ Use flagger sign only when flagger is present.
- ⑤ Omit this sign when median is less than 10' (3 m) or for bi-directional turn lanes.
- ⑥ Cones, drums or barricades at 20' (6 m) centers in taper.

SYMBOLS

- Work area
- Cone, drum or barricade
- Sign on portable or permanent support
- Arrow board
- Barricade or drum with flashing light
- Flagger with traffic control sign

NOTE

TRUCKS AND EQUIPMENT SHALL NOT BE PARK IN THE EASTBOUND LANE CLOSURE TO PROVIDE BETTER VISIBILITY FOR LEFT TURNING VEHICLES TO MULLER ROAD.
WHEN USING AN OVERNIGHT LANE CLOSURE LIGHTS WILL BE REQUIRED ON ALL DRUMS AND BARRICADES.

GENERAL NOTES

This Standard is used where at anytime, day or night, any vehicle, equipment, workers or their activities encroach on the pavement during shoulder operations or where construction requires lane closures in an urban area.

Calculate L as follows:

SPEED LIMIT	FORMULAS	
40 mph (70 km/h) or less:	English $L = \frac{WS^2}{60}$	(Metric) $L = \frac{WS^2}{150}$
45 mph (80 km/h) or greater:	$L = (W)(S)$	$L = 0.65(W)(S)$

W = Width of offset in feet (meters).
S = Normal posted speed mph (km/h).

All dimensions are in inches (millimeters) unless otherwise shown.