

STA. 2898+95.08 F.A.P. 332
 = STA. 50+00.00 CENTER ST.
 $\Delta = 103^{\circ}05'44''$ LT.

P.I. 2899+08.83 F.A.P. 332
 $\Delta = 0^{\circ}43'29.3''$ RT.

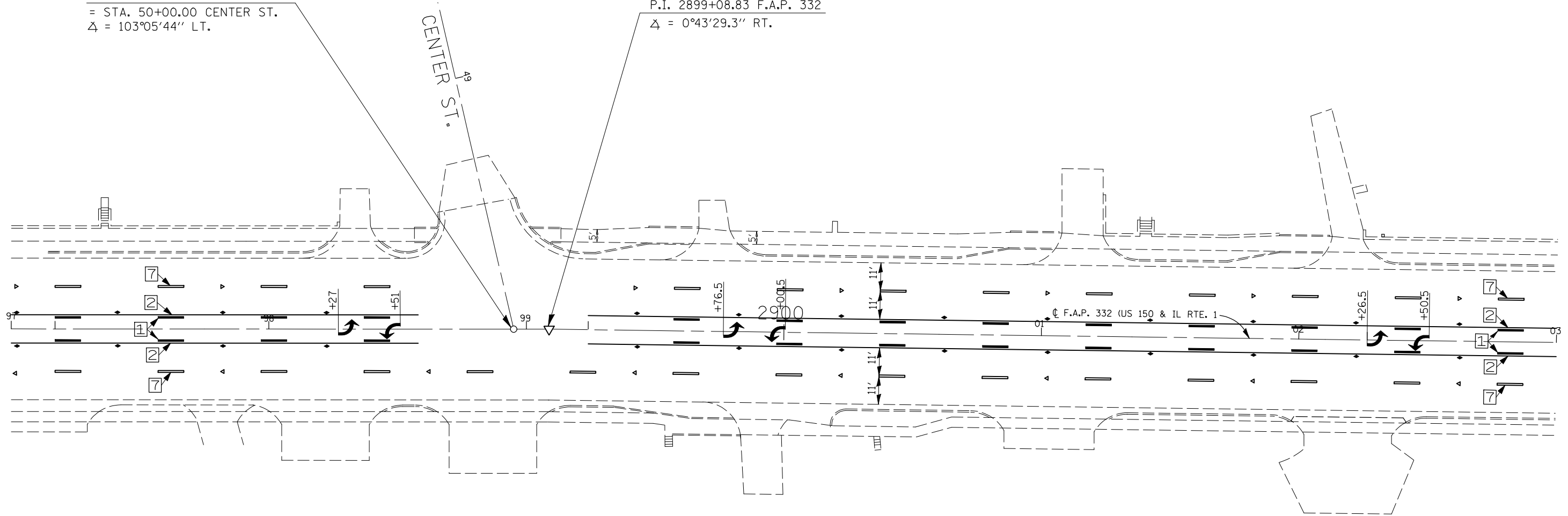

TYPICAL PAVEMENT MARKING LEGEND

- | | |
|-----------------------------|-------------------------|
| 1 4" SKIP-DASH (YELLOW) | 7 4" SKIP-DASH (WHITE) |
| 2 4" SOLID (YELLOW) | 8 4" SOLID (WHITE) |
| 3 12" DIAGONAL (YELLOW) | 9 12" DIAGONAL (WHITE) |
| 4 4" DOUBLE YELLOW (NARROW) | 10 6" SOLID (WHITE) |
| 5 4" DOUBLE YELLOW (WIDE) | 11 24" STOP BAR (WHITE) |
| 6 | 12 8" SOLID (WHITE) |
- ◆ AMBER TWO-WAY MARKER ◁ CRYSTAL ONE-WAY MARKER
 ▲ AMBER ONE-WAY MARKER

| | | | |
|---|---------------------|------------|-----------|
| FILE NAME = | USER NAME = hoganbj | DESIGNED - | REVISED - |
| et\pwork\pwork\HOGANBJ\d0185087\d570709.sht\pmk.dgn | | DRAWN - | REVISED - |
| | | CHECKED - | REVISED - |
| | | DATE - | REVISED - |

**STATE OF ILLINOIS
 DEPARTMENT OF TRANSPORTATION**

| | | |
|--------------------|---------------------------|------------------------------|
| PLAN SHEETS | | |
| SCALE: | SHEET NO. 27 OF 29 SHEETS | STA. 2897+00 TO STA. 2903+00 |

| | | | | |
|---------------------------|---------|-----------|--------------|-----------|
| F.A.P. RTE. | SECTION | COUNTY | TOTAL SHEETS | SHEET NO. |
| 332 | 47RS-11 | VERMILION | 56 | 46 |
| CONTRACT NO. 70709 | | | | |
| ILLINOIS FED. AID PROJECT | | | | |